



IM#: 09-0101925

Opus™
modular casegoods

Steelcase
HEALTH

Hosting Patients and Families

Opus™ modular casegoods define personal space and enhance the care experience. Open shelves keep personal belongings in sight. A mounting surface for technology and whiteboard options

encourages information sharing and learning. Lighting elements let clinicians and patients customize their surroundings.



IM#: 08-0003447



Maximum Flexibility

Opus combines the benefits of traditional freestanding casegoods with the flexibility of modular furniture. Components configure in multiple ways to create a consistent aesthetic across patient and exam rooms, consultation spaces and other settings – and to adapt as needs change over time.

Easy Access, Out of Sight

Technology routing behind the cabinets allows for easy wiring and access, keeping cords safely hidden.

STATEMENT OF LINE

CABINETS

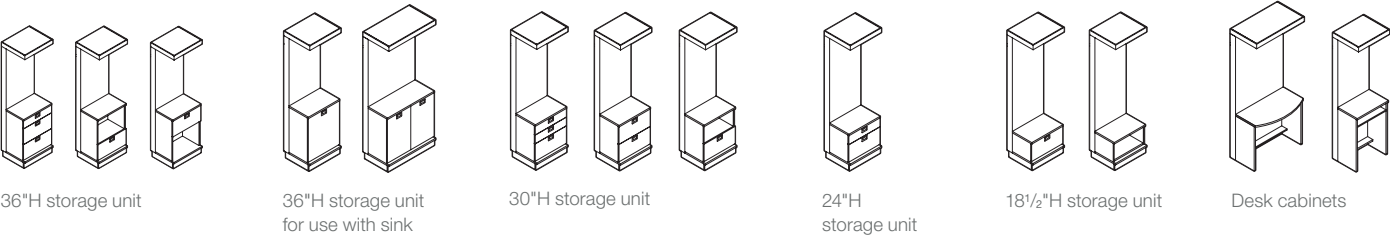

CABINETS (CONTINUED)

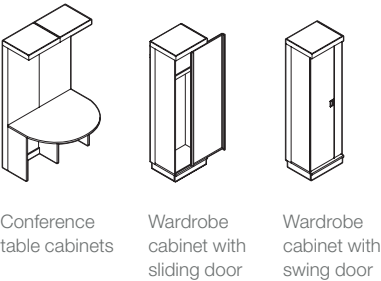

BEDSIDE TABLES

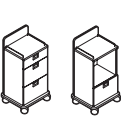

OVERHEAD SHELVES

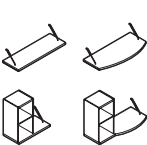

OVERHEAD STORAGE

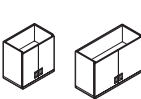

ACCESSORIES

See the *Specification Guide* for end panels, wall trim and fascia.

SURFACE MATERIALS

LAMINATE



Colors are representative and may vary slightly from actual material.

For more information on these and other finishes and options, including the full range of available laminates, visit us online and view our *Specification Guide*.

SUSTAINABILITY

PEOPLE. PLANET. PROFIT.

By rethinking our business systems and designing our products to avoid negative impacts on humans and the environment, we contribute to a sustainable future for the planet and its people. We commit to advance our practices through continuous learning and building partnerships with our customers, business partners and environmental thought leaders to optimize our performance and contribute to the science and practice of sustainability.

TO FIND OUT MORE VISIT
WWW.STEELCASE.COM/SUSTAINABILITY



Opus is made with 75% recycled content, is designed to withstand the demands of healthcare cleaning protocols and is 12% recyclable at the end of its long lifespan. It may contribute to LEED certification for recycled content, regional materials, indoor environmental air quality, furniture and medical furnishings, and sustainable purchasing.



Call 800.333.9939 or visit SteelcaseHealth.com

