

**WARNING:** All installation should be done by a qualified person in accordance with codes, ordinances and regulations applicable at the installation site.

**NOTE:** Locking doors ordered prior to May 21, 2007 must be updated with a lock conversion kit:  
Part number 24368901SR for a 66" door or  
Part number 24368902SR for a 72" door.

**NOTE:** Standard lock position shown. Door closes to right when viewed from outside.

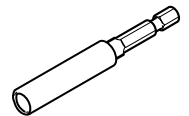
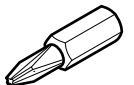
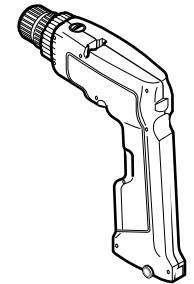
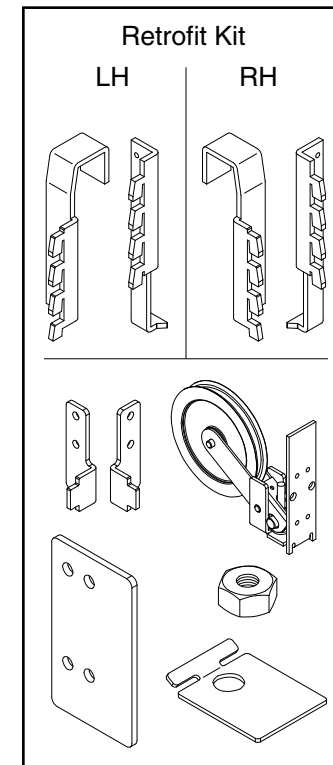
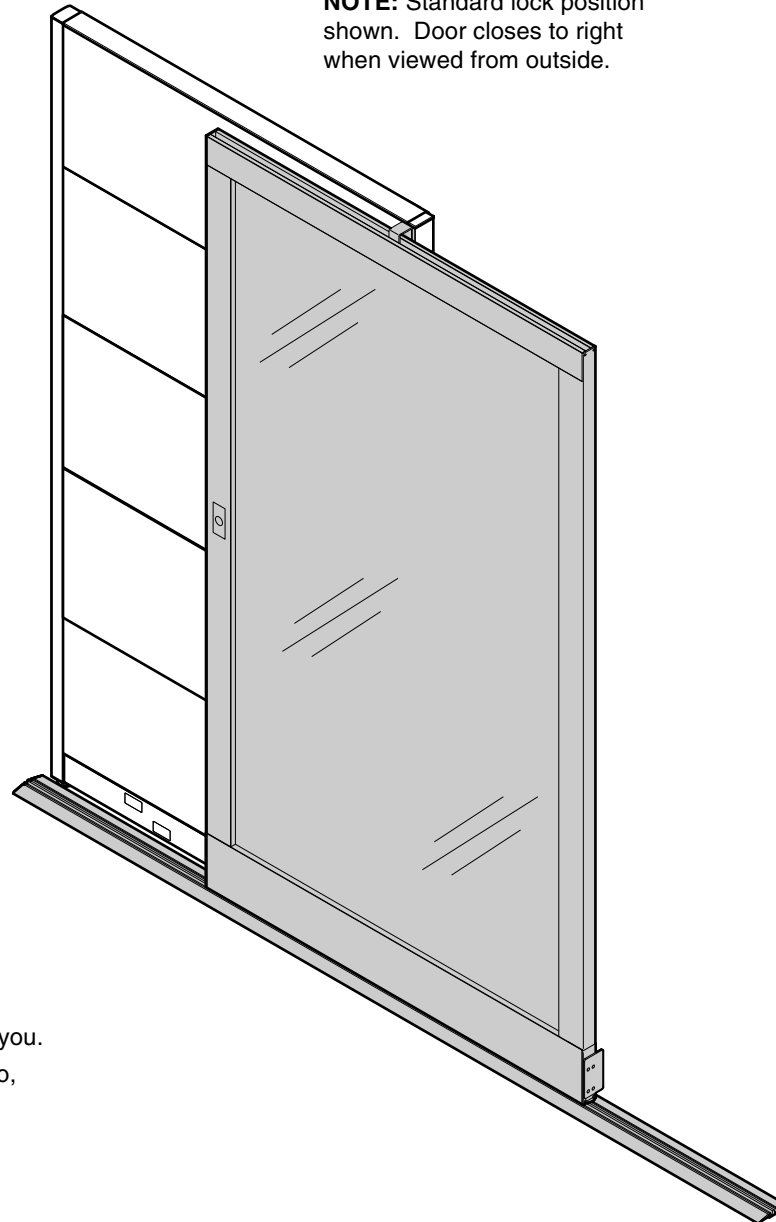

Bit Holder

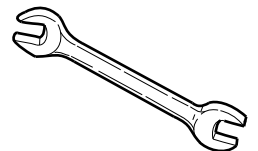
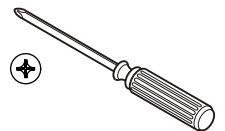

If you have a problem, question, or request, call your local dealer, or Steelcase Line 1 at **888.STEELCASE** (888.783.3522) for immediate action by people who want to help you. (Outside the U.S.A., Canada, Mexico, Puerto Rico, and the U.S. Virgin Islands, call: 1.616.247.2500) Or visit our website: [www.steelcase.com](http://www.steelcase.com)

© 2014 Steelcase Inc.  
Grand Rapids, MI 49501  
U.S.A.

Printed in U.S.A.

## 1. Mount floor track.

With panel system installed and adjusted level, take panel base trims off the panels. Hook clamp bracket around panel glides (1a), locate hole location to floor track. Pre-drill floor track with 9/64" diameter drill bit and attach to floor track with one (1) screw. Install jam nut to appropriate glide (1b) with floor track extending 1" further than the glide on the opposite panel (1c). Install base trim on panel.

### If applying to Answer with smaller glide disk:

Use alternate brackets provided and place the glides on top of bracket pocket (1d).

### If using a junction stabilizer bracket:

Use brackets included with that kit (1e).

### If door is locking:

Use track bracket adaptor plate as shown if necessary.

**NOTE:** Jam nut only required on this glide.

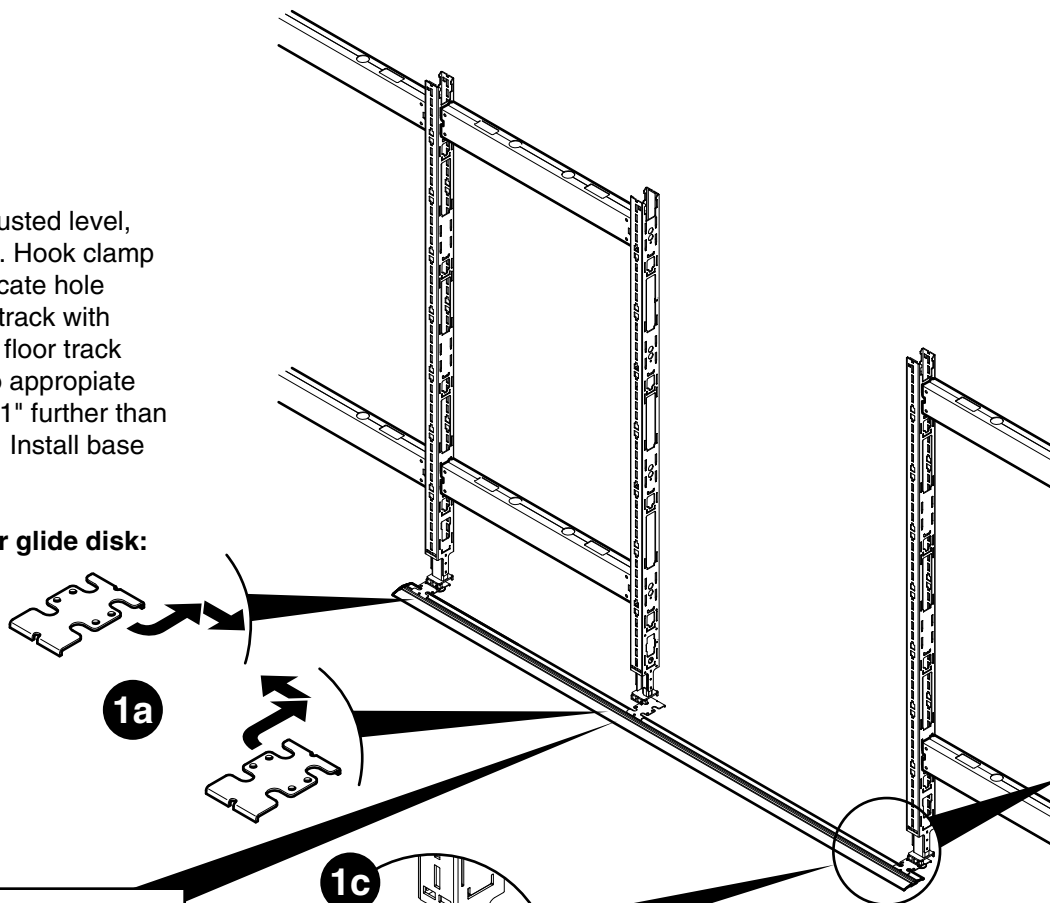
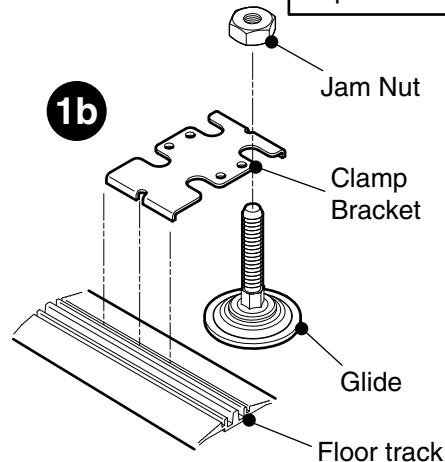

1a

1c

1d

1e

1"

Answer manufactured after October 10, 2011.

**NOTE:** Carpet gripping flange must be cut off or bent out of the way if applying to a hard surface.

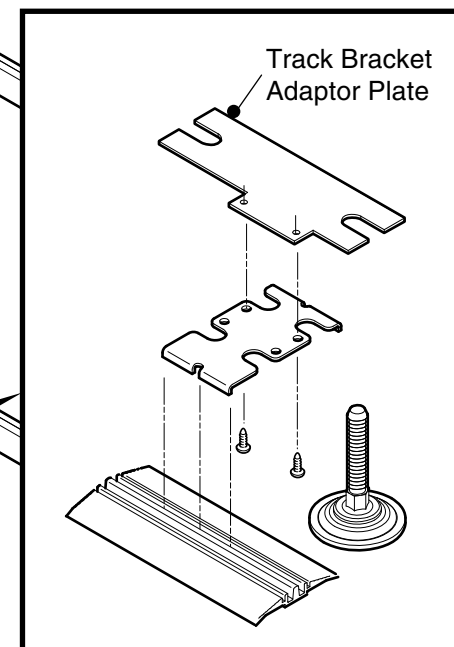

**If door is locking:**  
Use track bracket adaptor plate if clamp bracket interferes with locating hook receiver.

## 2. Install new wheel assemblies & acquire correct door height.

Remove two (2) screws and replace the old wheel assembly (2a) with the new wheel assembly using the same screws (2b). Repeat steps 2a & 2b for opposite end of door. Measure from top of fabric on panel to the top of the floor track (2c). Take that measurement and add 1/4". That is the distance needed from the top of the door, to the bottom of the wheel (2d). Adjust the wheel adjustment screws that are located on the bottom of the door next to each wheel until you have acquired the dimension required from step 2d (2e).

### OPTION:

You may install the stop plates (step 5c - page 6) at this time.

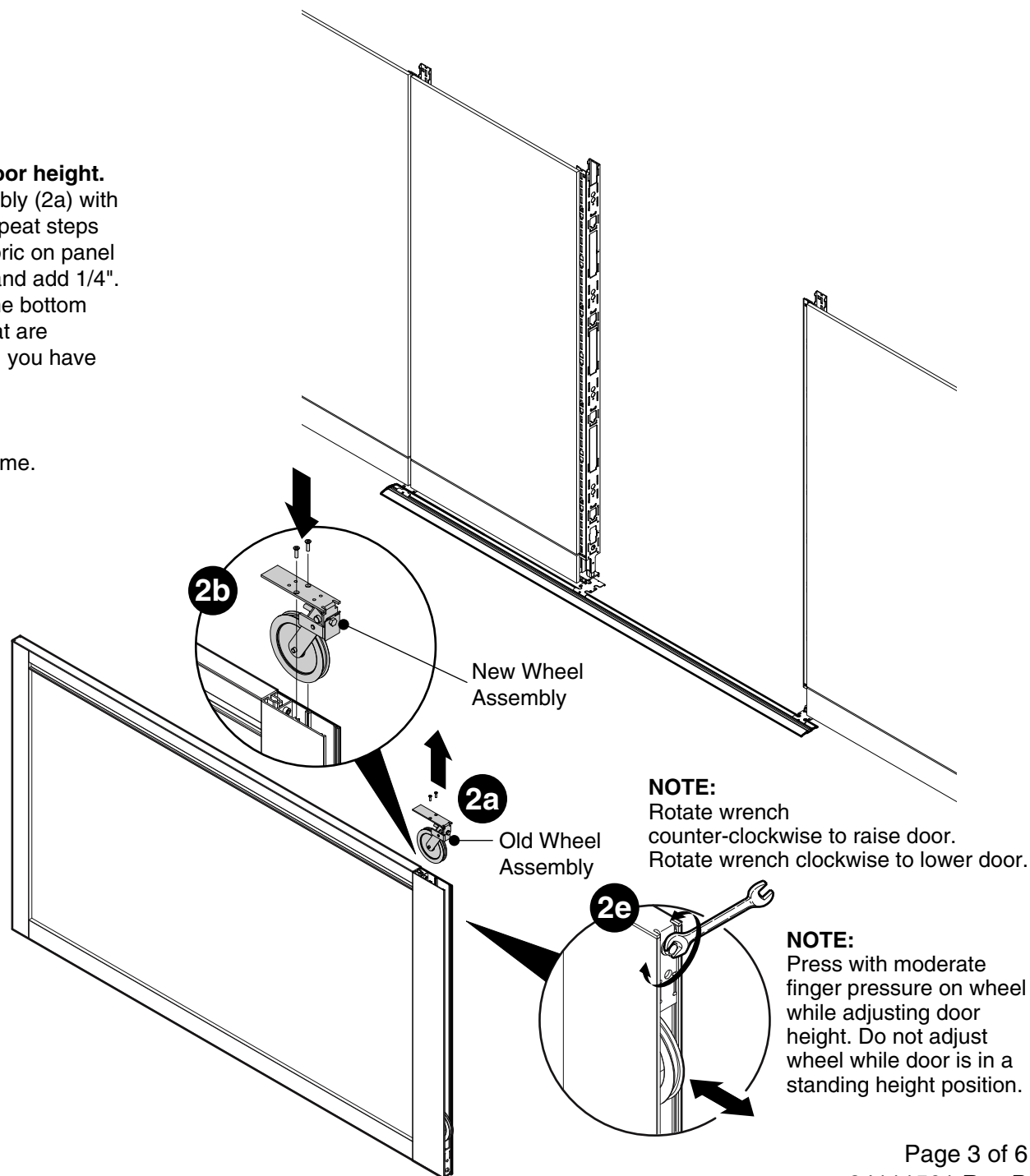
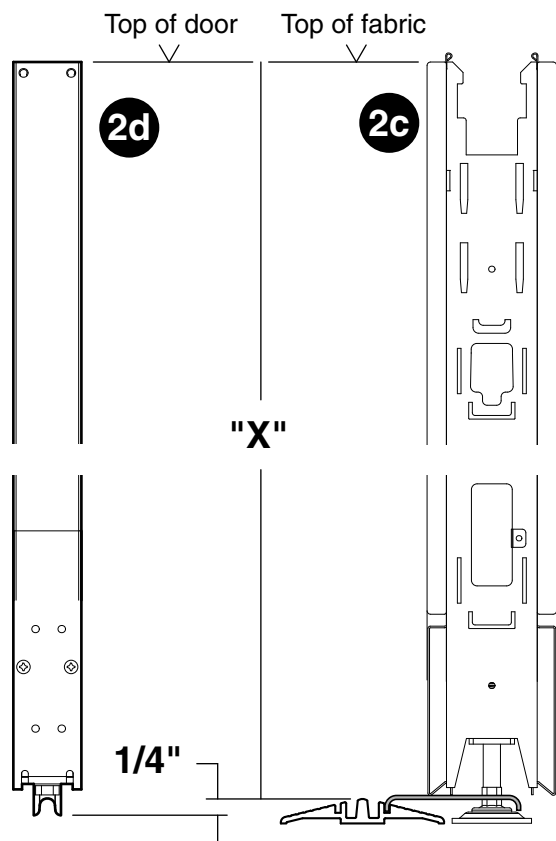

### 3. Install anti-rotation bracket around wheel adjustment screw.

Squeeze anti-rotation bracket onto flat of hex bolt with pliers (3a). Rotate side flange of anti-rotation bracket and squeeze onto flat of hex bolt with pliers (3b). Repeat for other side of hex bolt. Repeat all of step 3 for wheel adjustment screw on opposite side.

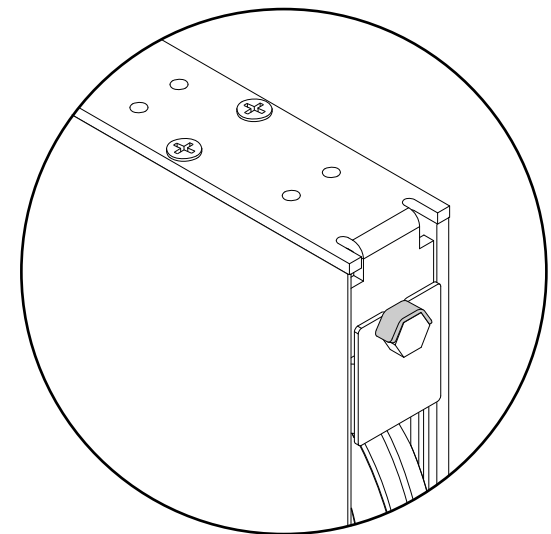
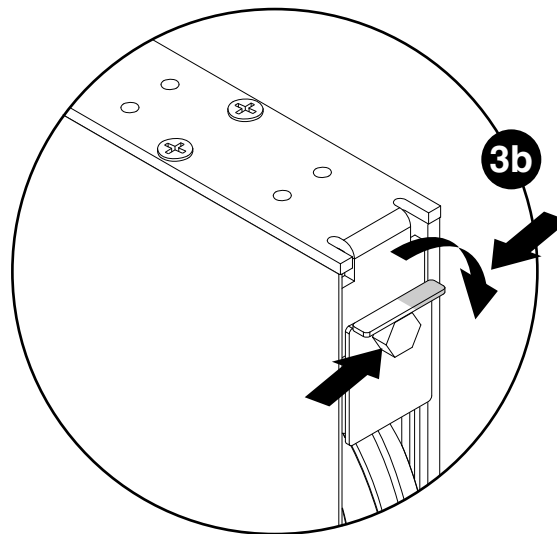
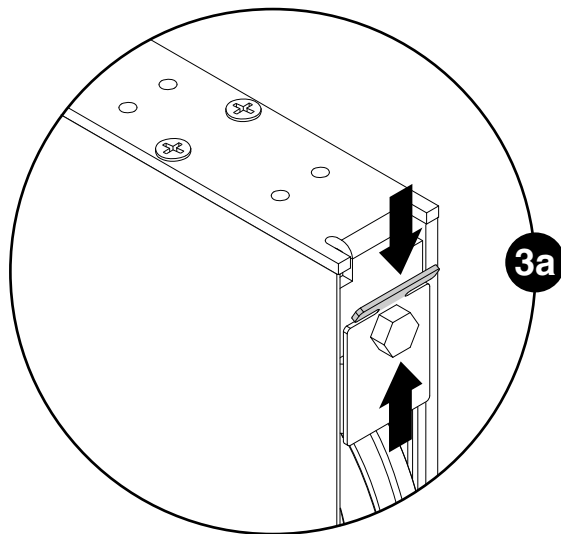

**COMPLETED  
ANTI-ROTATION BRACKET  
INSTALLATION**

## 4. Install top & bottom support brackets each with anti-dislodgement bracket.

Install top & bottom support brackets into Answer panel slots as shown. Install anti-dislodgement bracket onto each support bracket as shown with screws (provided).

**NOTE:** Depending on the installation, the installer will either use the left hand top & bottom support brackets or the right hand top & bottom support brackets.

**NOTE:** The installer will be using one (1) left hand anti-dislodgement bracket and one (1) right hand anti-dislodgement bracket for this installation.

**NOTE:** Make sure to apply plastic spacer slide blocks to both sides of top support bracket.

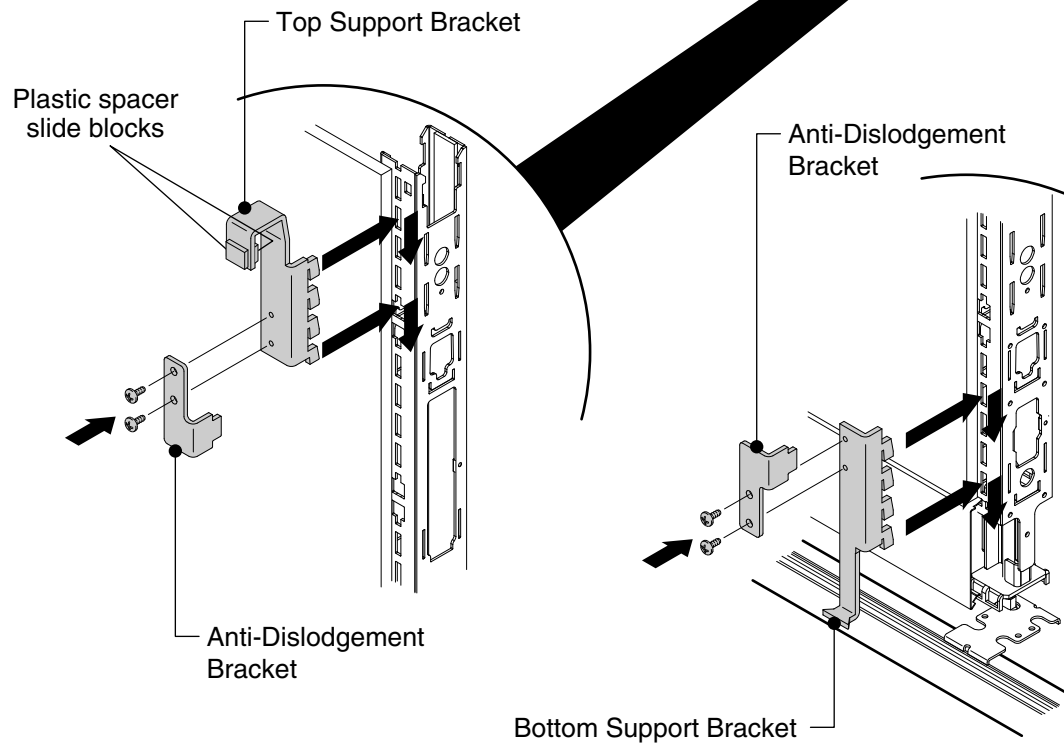

## 5. Mount Sliding Door.

Install the sliding door into the top support bracket within the middle of the sliding door (5a). Rotate the sliding door into its upright position and place the sliding door wheels onto the door track (5b).

Mount the stop plate to the bottom of the sliding door as shown with screws (provided) (5c). Repeat step 5c for opposite side of sliding door.

