

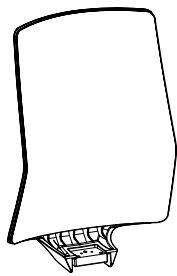

COMPONENTS

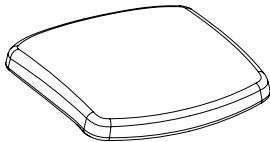

Backrest



Seat

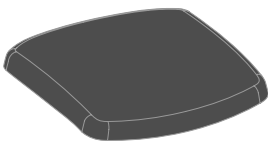

Seat Cover

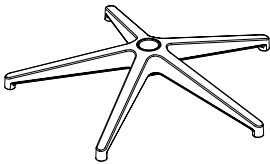

Base

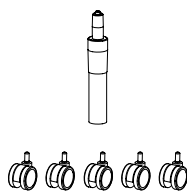

Gas Spindle/  
Castor

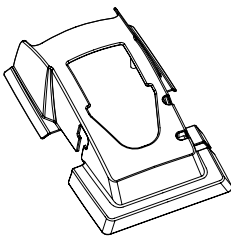

Mechanism Cover

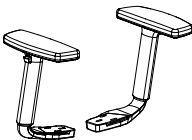

Armrest

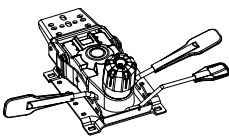

Mechanism

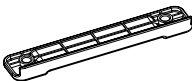

Mechanism Bar

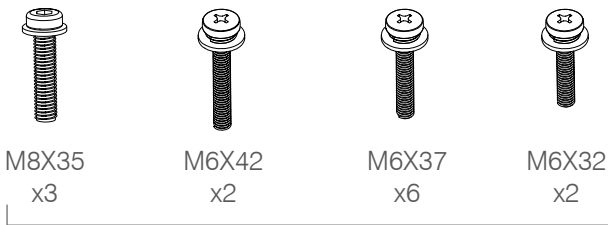

Bolt Kit

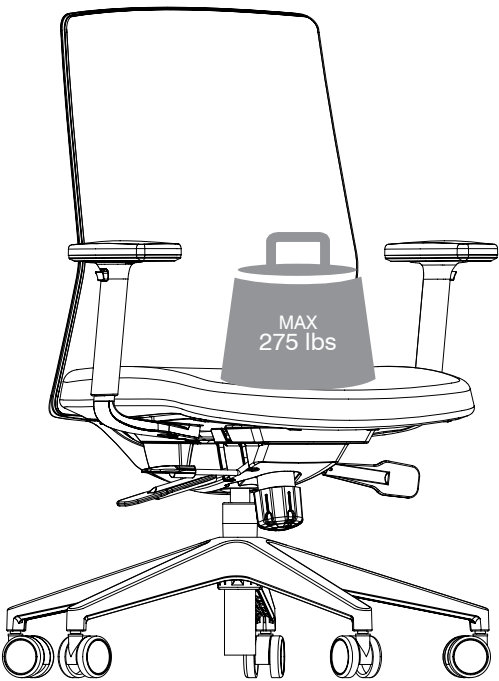

## INSTALLATION

### Step 1

Insert seat shell into cover and zip closed.

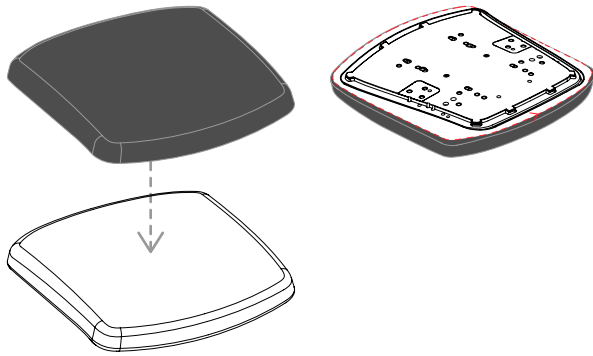

### Step 2

Attach the armrest to the seat shell using six M6X37 bolts and tighten the six M6X37 screws.

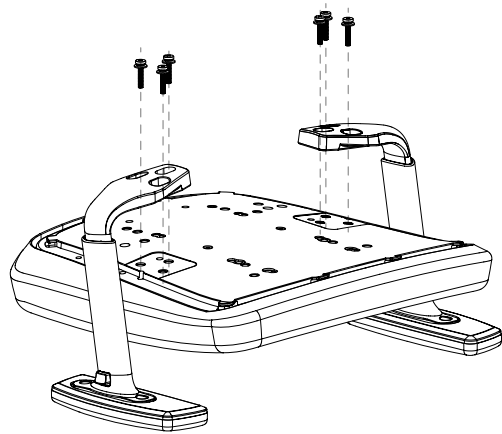

### Step 3

Attach mechanism to seat shell using two M6X42 bolts and two M6X32 bolts with the mechanism bar as indicated below. Tighten the bolts.

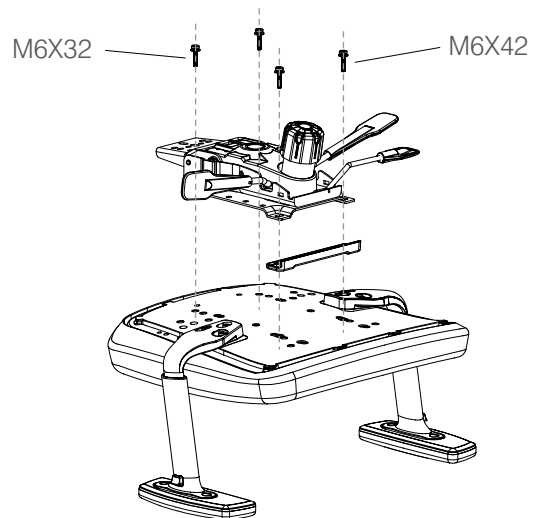

### Step 4

Attach backrest to seat shell using three M8X35 bolts and tighten the bolts.

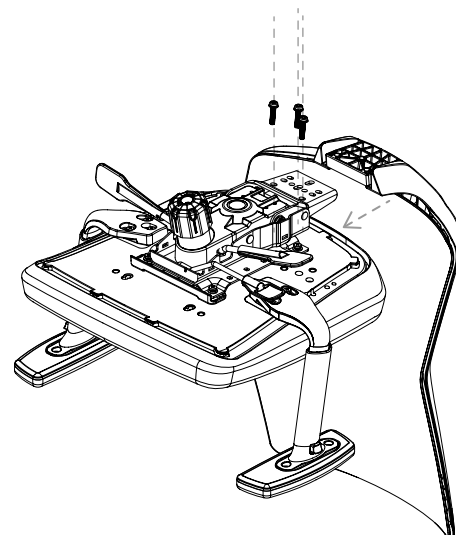

## INSTALLATION

### Step 5

Attach mechanism cover onto mechanism and make sure the four snaps indicated in red on mechanism cover fit into the four slots on mechanism.

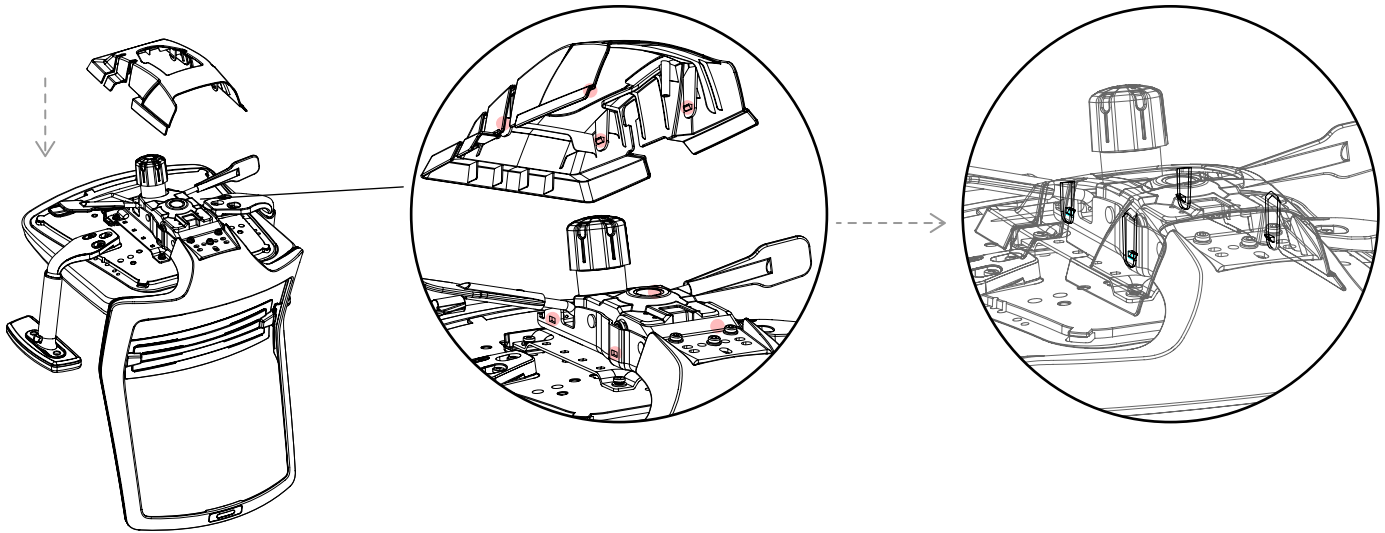

### Step 6

Insert the castors onto leg base, then insert gas lifter onto top of leg base.

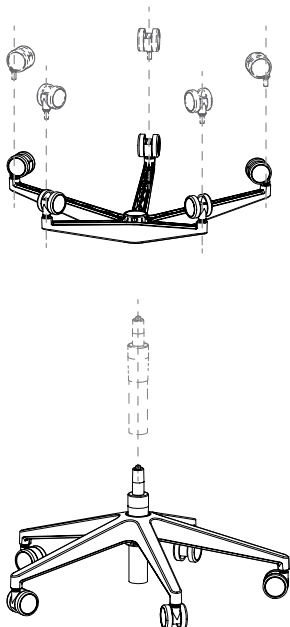

### Step 7

Combine chair body with gas lifter via hole in mechanism.

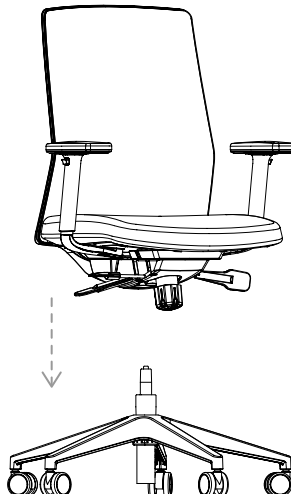

### Step 8

Your Bodi chair is now ready to use.

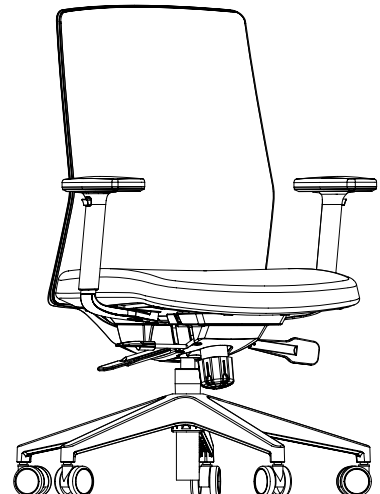

## CHANGING REMOVABLE SEAT COVERS

### Step 1

Pull the seat forward while pushing the lever under the seat.

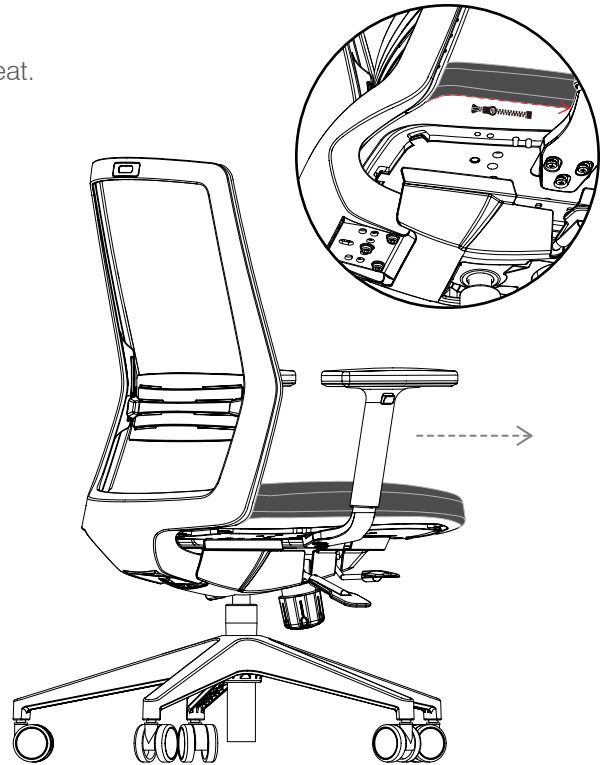

### Step 2

Unzip the zipper on the back side and remove seat cover from the seat shell. Install new seat cover and zip to close.

