

Solo Sit-to-Stand Desk

Quickstart Guide



Steelcase

What's included

Better work is just 4 steps away

Box 1

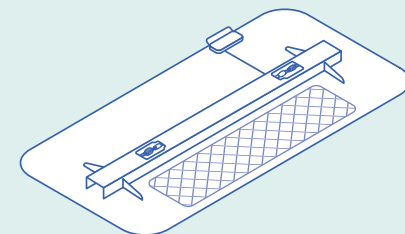

Worksurface (top and frame)

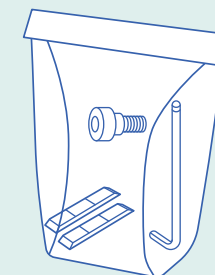

Bag with screws,
side covers and tool

Box 2

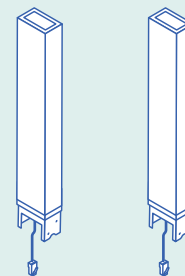

Columns

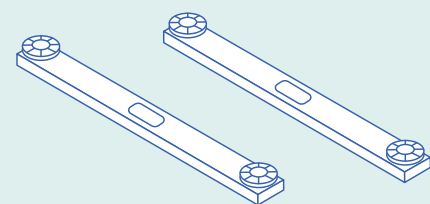

Feet

Some helpful tips

Pick a location where there is enough room between the desk and other nearby objects.

As you open the boxes, review the content and different elements. You can simply remove the cover off the large box and start the assembly process inside the open box.

Keep the worksurface adjustment range clear of obstructions.

Don't sit or stand all day. Both can take a toll on your body. Instead, try alternating between postures every 1-2 hours.

For additional details, please reference the Assembly Directions and User Guide that is also included in this box.

If you'd rather watch a video on how to assemble your new desk, scan the QR code below.



Enjoy your new Solo Sit-to-Stand Desk!

To find out more about solutions
for new ways of working,
visit [Steelcase.com](https://steelcase.com)

Steelcase

All rights reserved. All specifications subject to change without notice.

⚠ WARNING

Risk of Electrical Shock, Fire, Serious Injury or Death.
Raising or lowering the desk can crush or trap body parts. Read all instructions before using this furnishing. Do not allow use by children or untrained people.



+49 (0) 8031 405 111
[Steelcase.com](https://steelcase.com)

Attach the columns to the frame

Tip: Keep the top inside the packaging.
The right positioning of the columns is indicated through the little cut-outs on top of the column.

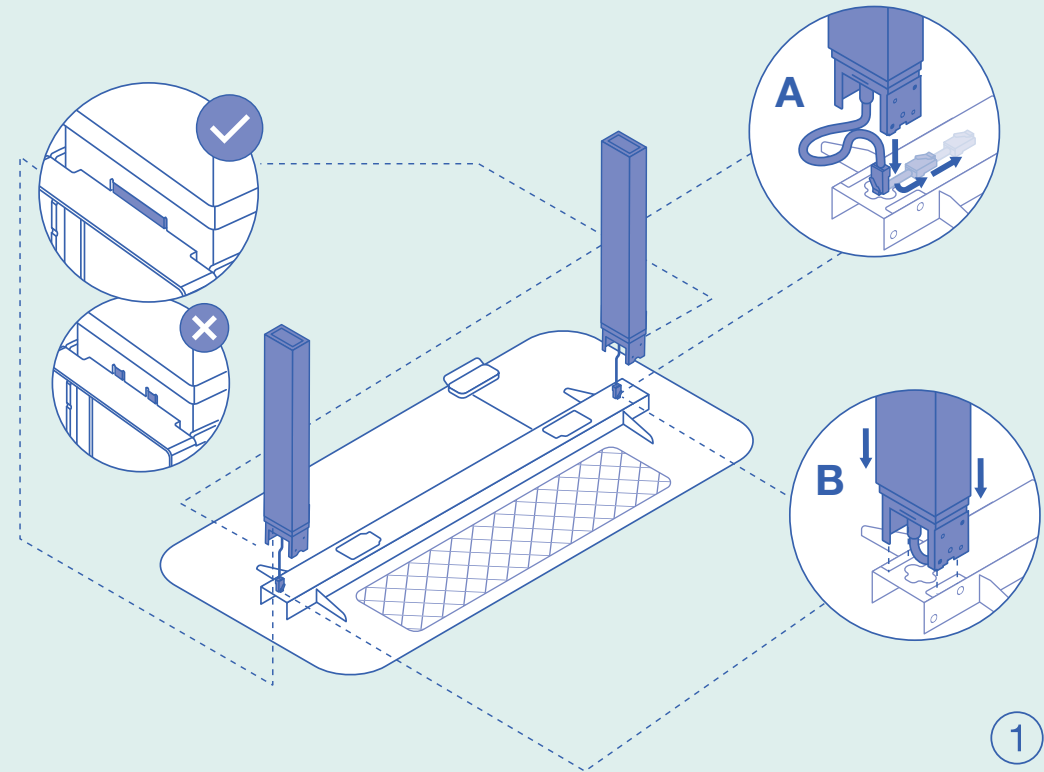

Connect the cables and tighten the screws

Tip: The cables are connected correctly when you hear a click sound. Make sure to tighten the screws tightly with the supplied tool, as that has a direct impact on the stability of the desk.

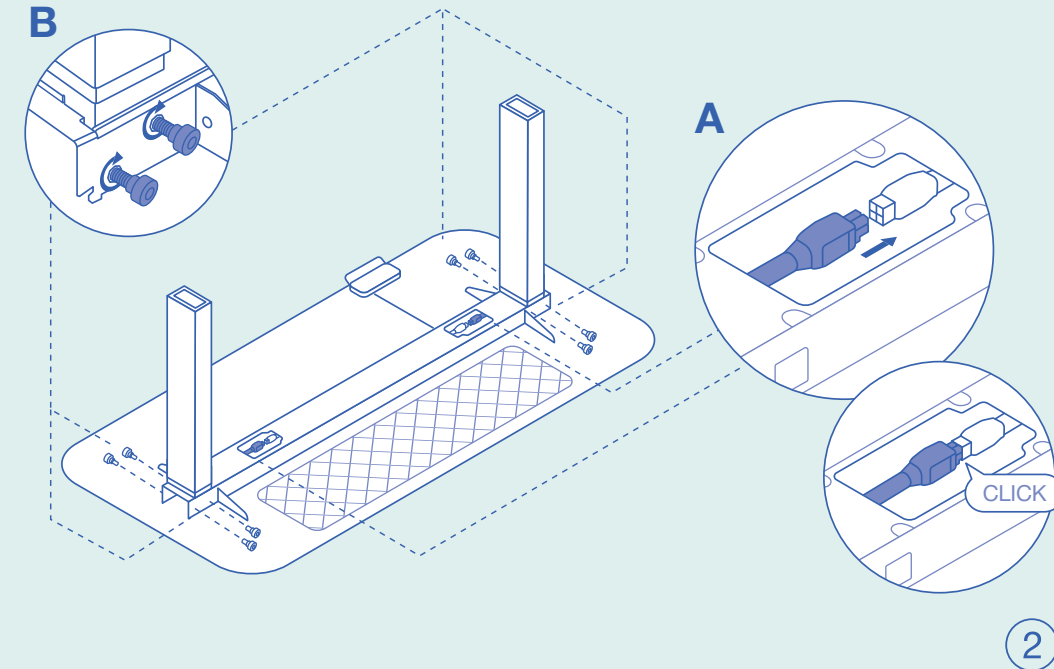

Assemble the feet

Tip: Remove the plastic screws (transportation lock) before tightening the metal screws.

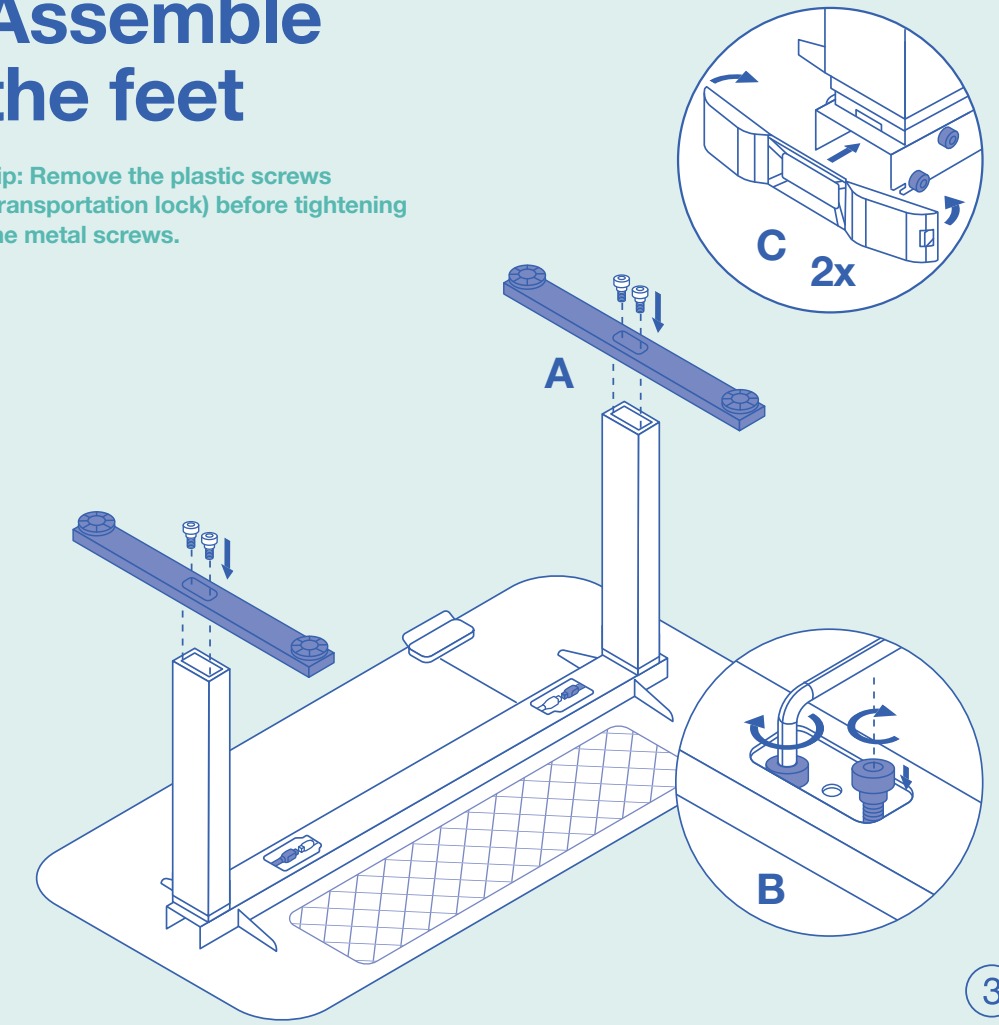

Get to work

Flip the desk over, being cautious of the mounted switch on the underside. Adjust the levelling glides if needed, connect to power and you're done!

