

Steelcase Flex Collection

A range of flexible workplace solutions
designed for dynamic team neighborhoods.

Table of Contents

The new era of hybrid work is here. Providing a new level of choice, control and flexibility in the workplace has never been more important. An ecosystem of compelling spaces will earn the commute and give people dynamic spaces where they can do their best work.

In this guide, see how the Steelcase Flex Collection supports people in the hybrid workplace.

03	Create an Ecosystem of Spaces
05	Settings
11	Products
12	Desks + Tables
18	Screens
21	Carts
24	Privacy + Space Division
27	Seating
29	Technology + Power
34	Markerboard Solutions
38	Accessories
40	Resources

Create an Ecosystem of Spaces

The best hybrid workplaces not only support collaborative work, but also the growing need for focus time. The Steelcase Flex Collection supports high-performing teams and individuals – and all the kinds of work they do. The broad product collection comes together to create a wide range of applications that allow people to focus, collaborate and connect, while giving them the flexibility to adapt their space to meet their rapidly changing work activities.

Steelcase Flex Principles



Adapt on Demand

With flexibility at the core of the design, the Steelcase Flex Collection empowers people to work their own way. A range of interconnected essentials with built-in mobility allows workspaces to adapt on demand for work that happens in the moment, and for whatever tomorrow brings.

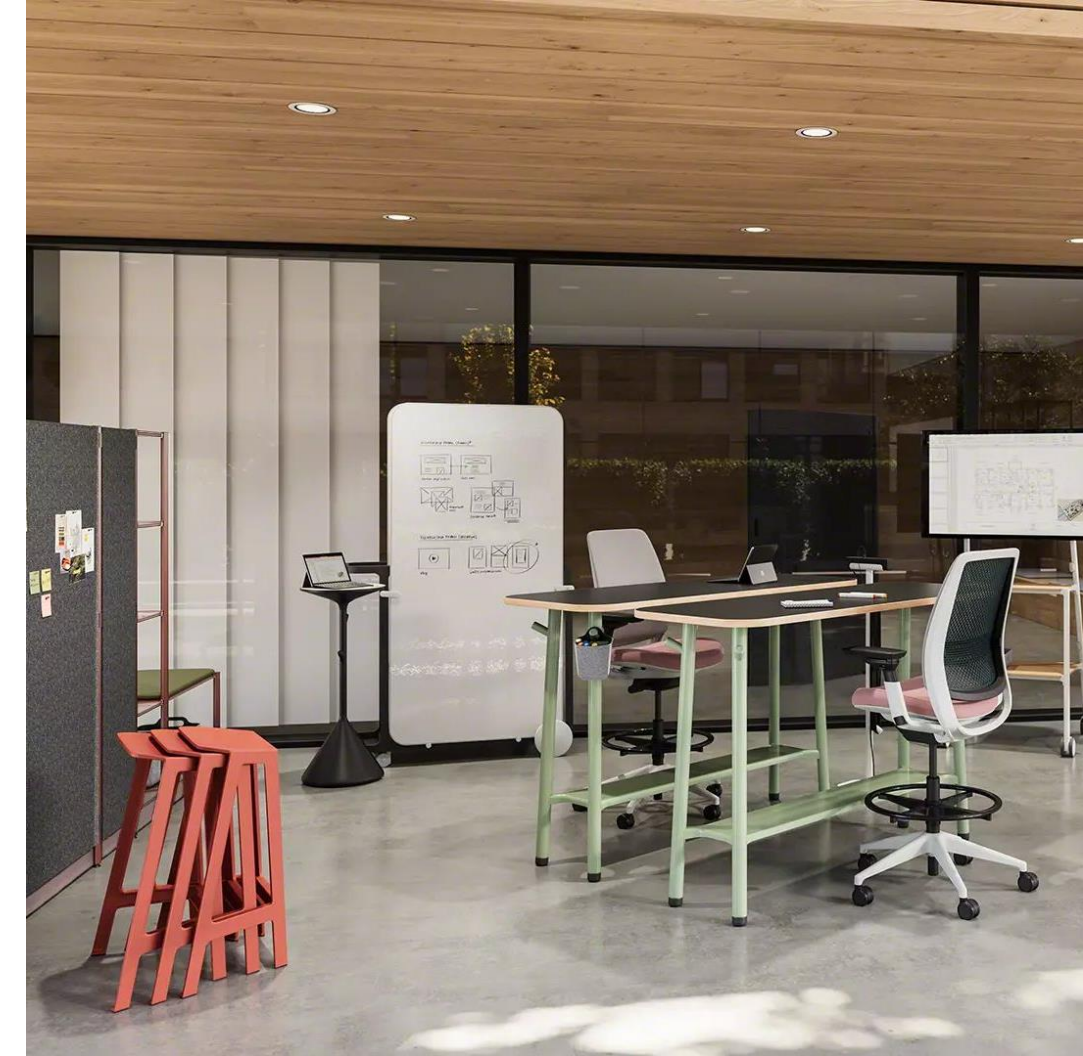

Community-Based Design

Just like city neighborhoods have homes and shared spaces, the hybrid workplace should support both individual work and teamwork. The Steelcase Flex collection gives people the spaces, tech and tools they need for focus time, collaboration and social connections - all while making it easy to shift between work modes.

Settings

Hybrid work is about options. Explore settings that allow for focus, collaboration and social connections in the hybrid workplace.

Featured Products

Kiosk
Perch Stool
Power Hanger
Team Cart
Acoustic Boundary

Great hybrid neighborhoods offer personal spaces that give people comfort and control, while supporting the ebb and flow between “me” and “we” work. This team space allows people to easily toggle between focus work and collaboration - all within the same team home.



Featured Products

Height Adjustable Desk

Active Frames

Board Cart

Slim Table

Provide a home for teams in a vibrant team neighborhood that provides spaces for focus work, collaboration and a place for people put their personal items and team resources. Teammates can focus on their work but don't have to go far to stay connected.



Featured Products

Kiosk

This on-demand privacy kiosk provides a convenient space for people to answer emails or join a short call during the brief moment of respite between two meetings. The open structure allows them to monitor the neighboring area while protecting them from visual distractions.



Featured Products

Steelcase Flex Active Frames

Steelcase Flex Media Cart

Viccarbe Burin Table

Viccarbe Maarten Bar Stool

A productive collaboration zone provides digital and analog tools for an active work session or brainstorm.

Whiteboards and screens keep work visible. Curtains act as a visual boundary, protecting the space from the surrounding area, and planters bring a touch of nature indoors. Technology allows for sharing of information or hybrid collaboration while power keeps people charged up.



Featured Products

Flex Active Frames Media Tower

Flex Active Frames

Ocular Table

Viccarbe Noha

BOLIA Mielo

Viccarbe Bamba

BOLIA Reflection

BOLIA Zen Series

This shared space supports hybrid collaboration. The mix between furniture and technology helps support the best possible meeting experience for in-person and remote users. Ingenious shelving and benches provide a soft transition to the neighboring area, offering a sense of privacy while keeping people connected and engaged.



Featured Products

Kiosk

Power Hanger

Well-designed social spaces offer a mix of rejuvenation, socialization, and quiet focus areas. A strategically placed privacy kiosk lets people answer spontaneous calls or brief tasks without leaving the space while being slightly removed from their surroundings. Additive power helps them keep their devices charged, providing extra piece of mind.



Featured Products

Flex Active Frames

Flex Media Cart

Flex Board Cart

Viccarbe Cambio

BOLIA Kimono

This collaborative space is particularly suited for impromptu meetings or daily stand-ups. Digital and analog tools keep work visible and allow remote participants to join in on a brainstorm, while strategically placed planters and curtains keep distractions at a minimum.



Products

The Steelcase Flex Collection provides a broad range of interconnected essentials for the hybrid workplace. From workstations to power to storage, each element was thoughtfully designed to work together to maximize space and human performance, with the freedom to easily switch between work modes.

Desks + Tables

A range of desks and tables gives people unparalleled control over their workspace. Easy movements accommodate impromptu changes in workstyle, orientation, and position, while providing support for both focus and collaborative activities throughout the day.

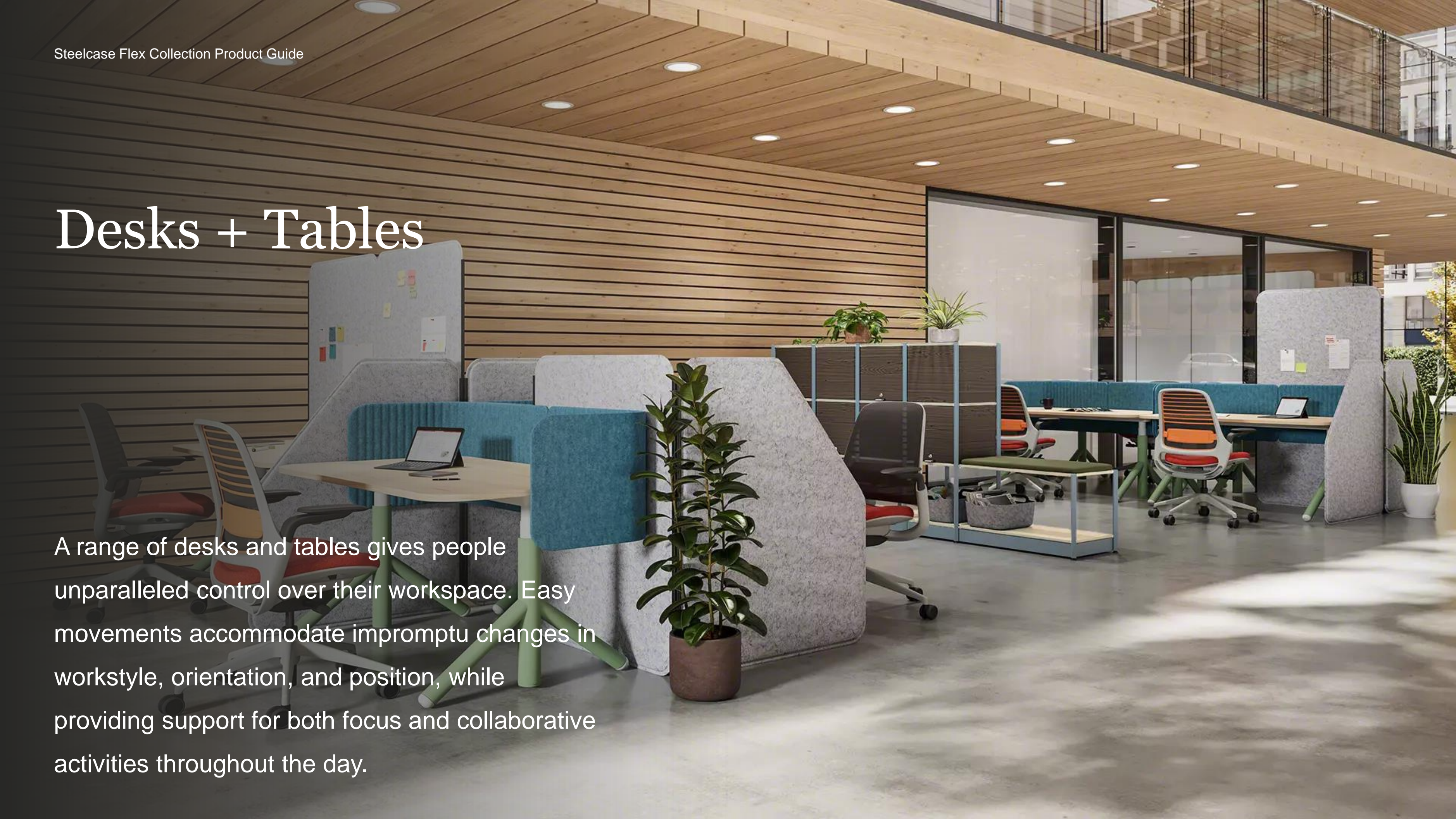

Height Adjustable Desk

The Height-Adjustable Desk gives people control over their workspaces. Easy movements accommodate quick changes in workstyle, orientation and position.

- Discrete, directional rollers for mobility
- Integrated power with one-cord out technology
- Basic and Extended Height options
- Optional desk top power hub
- Active touch controller

[VIEW PRODUCT](#)



Works Well With
Flex On Desk Screen

Seated Height Table

The Seated Height Table is a mobile, flexible solution for teamwork in open offices, meeting rooms or training spaces. Pull multiple tables together for a benching application—then separate them into solo workstations when needs change.

- Glides and optional wheels for easy mobility
- Integrated hooks for hanging personal items
- Optional cable catch for cord management
- Seated height posture

[VIEW PRODUCT](#)



Works Well With
Power Hanger
Cup

Standing Height Table

The Standing Height Table is a mobile, flexible solution for teamwork in open offices, meeting rooms or training spaces. Great on its own or joined with others when more project space is needed.

- Glides and optional wheels for easy mobility
- Hooks for hanging personal items
- Footrest for ergonomic support and good posture
- Optional cable catch for cord management
- Standing height posture

[VIEW PRODUCT](#)



Works Well With
Power Hanger
Cup

Slim Table

The Slim Table is an essential part of any collaborative setting. Great for a quick touch base or standing meeting.

- Integrated glides for mobility
- Integrated hooks for hanging personal items
- Footrest for ergonomic support and good posture
- Optional cable catch for cord management
- Standing height posture

[VIEW PRODUCT](#)



Works Well With
Power Hanger
Cup

Single Table

The Single Table is lightweight and easy to move, giving people flexibility at a moment's notice. With just enough room for a laptop and more, it's the perfect worksurface for collaborative spaces.

- Glides or casters for integrated mobility
- Standing and seated height for posture variation + pneumatic type for height adjustability
- Chevron or rectangle worksurface
- Ergonomic foot perch on standing height single table
- PET modesty panel for privacy

[VIEW PRODUCT](#)



Works Well With
Perch

Screens

A broad range of freestanding and desk-mounted screens give people control to adapt the amount of privacy they need for their various work activities.

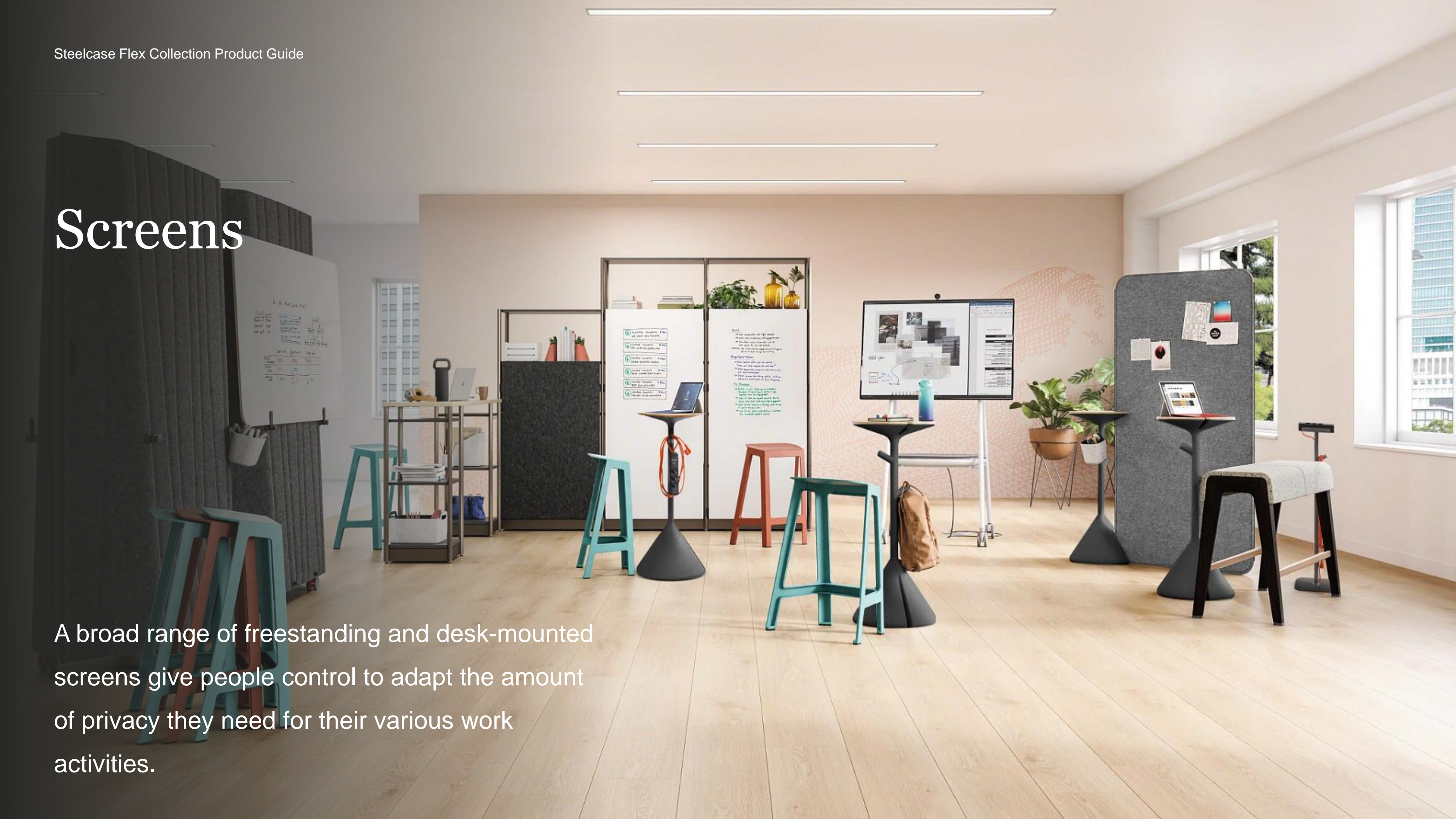

Freestanding Screens

Steelcase Flex Screens are user movable and offer infinite possibilities for space division, personal privacy and visual display.

- Magnetic edge links multiple screens together
- Pin-tackable for visual display
- Multiple sizes
- Available in three PET colours: Dark Grey, Light Grey and Blue

[VIEW PRODUCT](#)



Works Well With
Height Adjustable Desks
Board Cart
Stand
Wall Rail

On Desk Screens

The On Desk Screen adds privacy and modesty to the Height Adjustable Desk, giving people more control at their workspace.

- User movable
- Can be positioned in either privacy or modesty mode
- Magnetic attachment

[VIEW PRODUCT](#)



Works Well With
Height Adjustable Desk

Carts

Built to hold all the team's essentials, the Steelcase Flex Team Cart and Board Cart allow you to create, move and share information anywhere you want to work.



Team Cart

The Team Cart provides mobile storage for team tools and artifacts and allows you to roll your work with you – anywhere, anytime.

- Wheels for user mobility
- Clips allow display of whiteboards vertically or horizontally
- Doubles as movable boundary in the open office
- Endless paint options for customization

[VIEW PRODUCT](#)



Works Well With
Basket
Cup
Whiteboards

Board Cart

The Board Cart provides mobile storage for whiteboards and screens while allowing you to wheel and share your work anywhere you go.

- Wheels for user mobility
- Clips allow display of whiteboards vertically or horizontally
- Holds up to 8 whiteboards and/or screens
- Doubles as movable boundary in the open office
- Endless paint options for customization

[VIEW PRODUCT](#)



Works Well With
Whiteboards
Freestanding Screens
Cup

Privacy and Space Division

Built to create and define team spaces, the Steelcase Flex Collection solutions for privacy, space division and boundary shelter team spaces from busy corridors and neighboring spaces.



Active Frames

Steelcase Flex Active Frames are highly modular structures that shape space to your will. They adapt to a diverse range of needs, environments and aesthetic preferences, create flexible areas for teams to work alone or collaborate and provide soft boundaries between different neighborhoods.

- The Media Tower supports technology with internal or external mounted options
- curved and straight micro-architecture elements provide endless space planning possibilities
- Hard and soft infills can create open and enclosed shelving
- Lock option available
- Coat rod, cushion and other accessories provide further customization
- curtains provide soft visual boundaries for extra privacy
- organic design elements like curved shelves, benches, and infills help create semi-open spaces
- planters available, for a residential look and feel

[VIEW PRODUCT](#)



Works Well With
Whiteboards
Toolbox

Flex Kiosk

Steelcase Flex Kiosk is an on-demand office privacy pod that offers visual shelter during informative, spontaneous video calls and focus sessions under 45 minutes.

- Front and side panels for visual privacy
- Back panels provide a neutral background for video calls
- Open structure allows ambient light to pour in and indicate occupancy
- Foldable laptop support, fixed PET tray, footrest, and hook for optimal comfort
- Can be used with or without a stool
- Front Panel and Laptop Support available in PET Light Grey only
- Back Panels available in Renewed Loop screen size only
- All EMEA Standard and Select Surface 19mm Melamine finishes and Paints available

[VIEW PRODUCT](#)



Works Well With
Power Hanger
Power Stand

Acoustic Boundary

The multi-use acoustic boundary is a necessity in any busy team space. It provides acoustic performance, space division and a visual display area.

- Handle and wheels make it easy to roll and move
- Integrated clips for markerboard display, vertically or horizontally
- Available in Dark Grey PET

[VIEW PRODUCT](#)



Works Well With
Whiteboards

Seating

The Steelcase Flex Collection creates dynamic collaboration spaces that give people multiple posture options so they can sit, stand or perch.

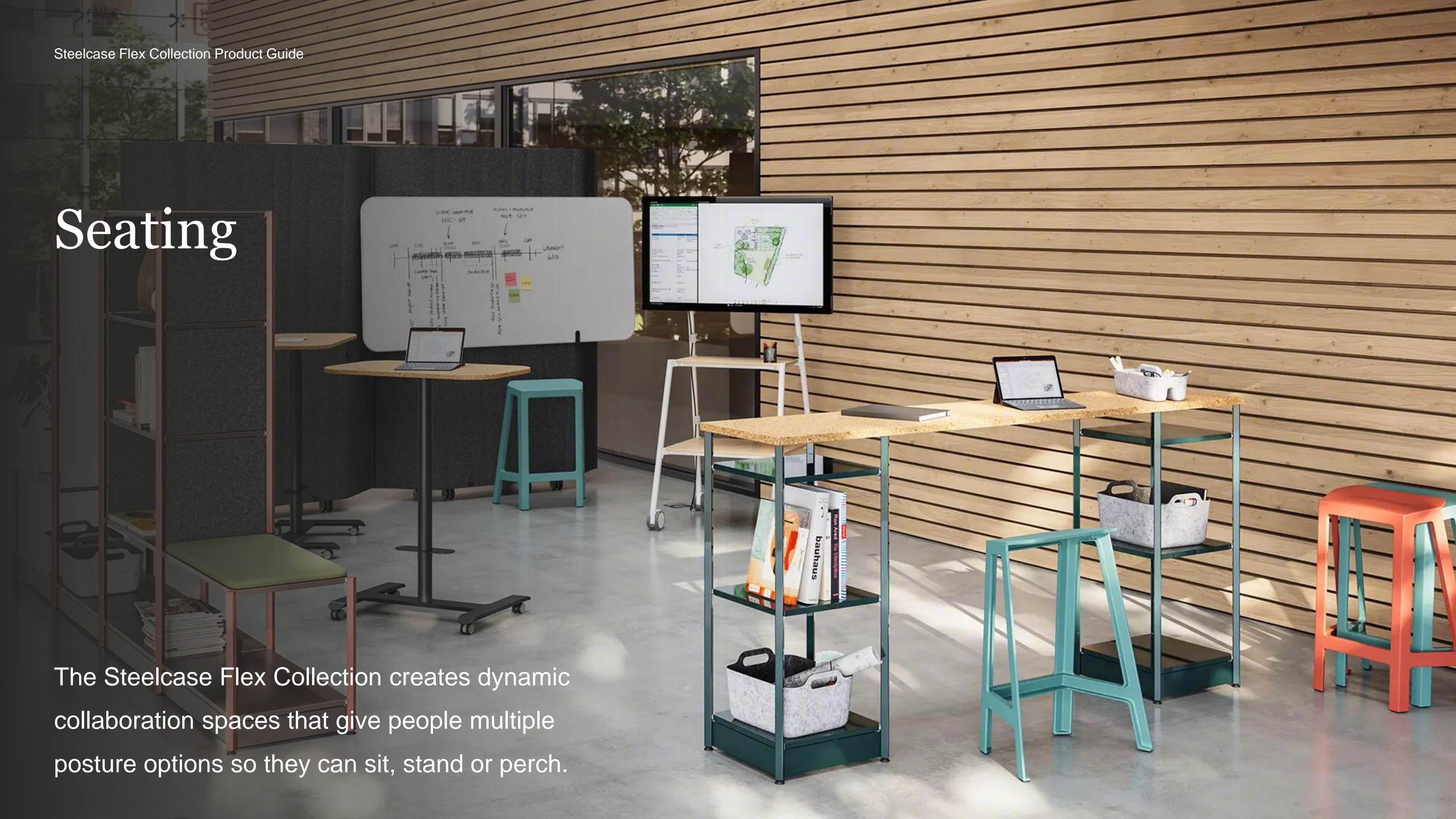

Perch Stool

Steelcase Flex Perch offers a quick place to sit – while staying fully engaged in mind, body and collaboration. Space-saving and sustainability-forward, this stool makes room for new possibilities.

- 100% Recyclable
- Nesting for space saving
- Lightweight
- 7,2° seat angle that encourages active engagement

[VIEW PRODUCT](#)



Works Well With
Stand
Acoustic Boundary
Active Frames
Whiteboards

Technology + Power

With all the tech essentials you need for hybrid work, the the Steelcase Flex Collection keeps you connected and powered-up so you stay productive through out the day.

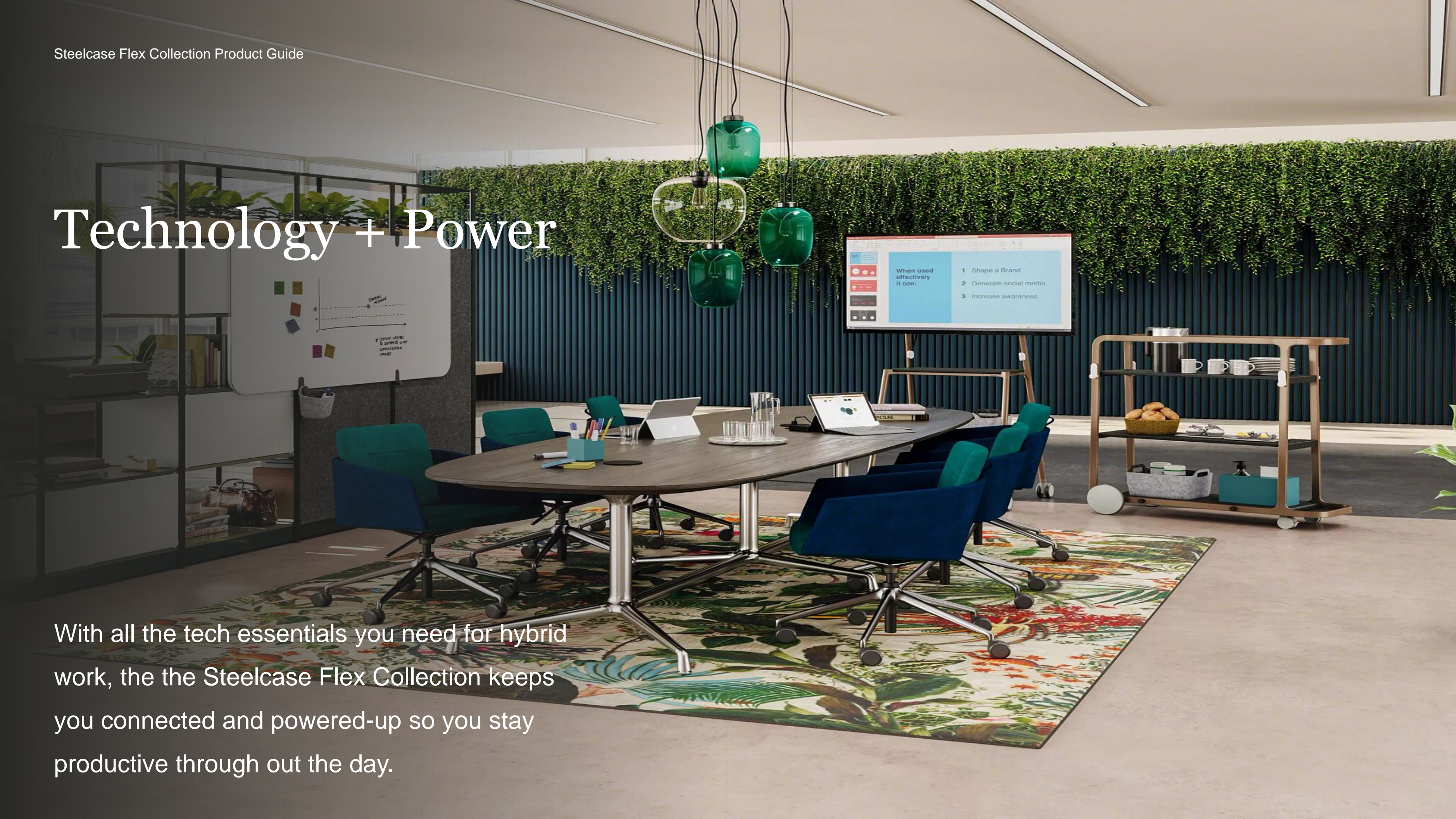

Media Cart

Technology-agnostic and effortlessly mobile, Steelcase Flex Media Cart keeps up with people, projects and organizations on the move.

- Holds any monitor up to 65 inches wide
- Wheels enable ease of movement
- Wide array of finish options for customization
- Optional power and tech basket

[VIEW PRODUCT](#)



Works Well With
Tables
Stand
Acoustic Boundary

Power Hanger

The Steelcase Flex Power Hanger is an ultra-mobile power solution that lets you connect to power at all times.

- Hangs on peg on the tables and stand
- Weighted structure with grip back keeps it in place on a flat surface
- Power options include three power sockets plus two USB-A 15.5W, available in Schuko, FR, UK, and CH

[VIEW PRODUCT](#)



Works Well With
Tables

Power Stand

Light weight and easy to move around to home bases and to communal spaces, the power stand has a sleek design to fit any space and an attractive color selection to match the orange cable.

- Versatility – 2 heights (for lounge and standing height applications)
- Power options include three power sockets plus two USB-A 15.5W, available in Schuko, FR, UK, and CH

[VIEW PRODUCT](#)



Works Well With
Tables

Markerboard Solutions

Steelcase Flex Whiteboard Solutions allow you to create, share and move your work wherever you go.



Whiteboards

Steelcase Flex Whiteboards are lightweight and portable, allowing you to take your work with you wherever you go.

- Dual-sided writing surface
- Lightweight and easy to move (under 4kg)

[VIEW PRODUCT](#)



Works Well With
Board Cart
Acoustic Boundary
Wall Rail
Stand

Stand

The Steelcase Flex Stand is a multi-purpose essential for collaboration providing a place to prop up whiteboards for a presentation, or a surface to hold your laptop.

- Hold whiteboards and screens
- Ideal for pitching and sharing
- Integrated peg hold a cup
- Available with clear plywood/linoleum surface and Merle or Seagull base

[VIEW PRODUCT](#)



Works Well With
Whiteboards
Freestanding Screens
Cup

Wall Rail

The Wall Rail is a hanging system for whiteboards and screens allowing people to collaborate quickly and take their work with them.

- Wall-Mounted and attaches to building walls
- Two tracks for layering whiteboards and screens



Works Well With
Whiteboards
Freestanding Screens

[VIEW PRODUCT](#)

Accessories

Steelcase Flex Accessories keeps your tools organized and readily available and allow you to customize your space.



Basket, Cup + Toolbox

The Steelcase Flex Basket, Cup and Toolbox are the perfect accessories to hold all your team's essentials, providing functionality, utility and personalization.

- Cup hangs on the table or stand peg or the cart clips
- Roomy to hold team tools and markers
- Formed and felted PET in two colors

[VIEW PRODUCT](#)



Works Well With

Team Cart

Tables

Active Frames

Let's Get in Touch

Find out more about new solutions
for new ways of working.

<https://www.steelcase.com/eu-en/products/desks-benches/steelcase-flex-collection/>