

FrameOne Plus

User Manual



Translation of the original user manual

Legal notice

Manufacturer

Steelcase AG

Brienner Strasse 42

80333 Munich

Germany

Phone: +49 89 2488146 2000

E-mail: info@steelcase.de

www.steelcase.de

Copyright

Extracts or copies may not be disclosed to third parties or used in any other journalistic form without the prior written consent of Steelcase.

As part of a technical documentation, the user manual is subject to German copyright law.

Liability

Under one or more of the following conditions Steelcase's disclaimer of liability may apply:

- Improper use of the product.
- Use of the product that goes beyond the scope of sensible use as office furniture.
- Operating the product with defective or non-functioning safety and protection devices.
- Improper assembly by unauthorised personnel.
- Use of components and adaptations that do not originate from Steelcase. Third-party parts are not guaranteed to be designed and manufactured to meet the requirements of stress and safety.
- Plans from third party suppliers that have been proven to lead to misuse of the product.
- Unauthorised modifications of the product in its construction and design.
- Loads on the product exceeding the load limits specified by the manufacturer.
- Improper maintenance, maintenance by third parties and unqualified personnel.
- Inadequate monitoring of the product components (function checks).
- Improper disposal and return of the product or packaging to the recycling cycle.
- Resale to a third party without including the user manual.
- Disasters caused by foreign bodies and force majeure.

Check all components regularly and contact authorised specialist personnel or our service hotline in case of damage (see *Repairs and spare parts* on Page 29).

Consult specialist personnel qualified for extensive assembly, maintenance and disposal work.

Further information and instruction are available under the respective topics in the following chapters of this user manual.

Product

The office furniture line **FrameOne Plus** by Steelcase is subject to continuous quality control during manufacture and distribution. This ensures fault-free functionality.

The products are designed and manufactured according to the state of the art (in Germany at the time of construction) and recognised safety rules; however, hazards may still arise. Please observe the respective safety instructions! Malfunctions that could impair safety must be eliminated immediately. We reserve the right to make technical changes to the products for technical reasons.

Steelcase applies a quality management system that meets the requirements of DIN EN ISO 9001.

Steelcase has the right to use the GS Mark for the product line **FrameOne Plus**.

Steelcase carries the eco-audit seal of the "Eco Management and Audit Scheme".

Table of contents

	Page
Copyright	2
Liability	2
Product.....	3
About this user manual	6
Purpose of the user manual	6
Text design	6
Safety instructions and warnings	7
Safety.....	8
Intended use	8
Foreseeable misuse	8
Safety instructions	8
Product description	9
Technical data	9
Factory setting on delivery.....	9
Components	10
Accessories	10
Overview of <i>FrameOne Plus</i> desk.....	11
Transport and storage.....	12
Safety instructions	12
Interim storage.....	12
Installation and assembly.....	13
Safety instructions	13
Checking the delivery contents.....	13
Disposing of the packaging material.....	13
Installing the desk	13
Assembling the desk.....	13
Height compensation	13
Disassembling and reassembling the desk temporarily	15
Disassembling the desk.....	15
Reassembling the desk	15

Operation and settings	16
Safety instructions	16
Optimum desk height.....	16
Carrying out height compensation.....	17
Height adjustment.....	18
Type 10 Standard <i>Loop</i>	18
Variant <i>Telescope</i>	18
Sliding top (optional)	19
Opening sliding desktop by user	19
Closing the sliding desktop by user	20
Opening sliding desktop by Facility Manager	21
Closing sliding desktop by Facility Manager	22
Faults and malfunctions	24
Maintenance	25
Safety instructions	25
Functional checks	25
Table for functional checks.....	25
Maintenance work.....	26
Disclaimer of liability	26
Cleaning and care	27
Disposal of the desk	28
Customer Service	29
Delivery, installation, instruction	29
Repairs and spare parts	29

About this user manual

Steelcase makes this user manual available on the Internet at the following address:

www.steelcase.com/FrameOne Plus

Purpose of the user manual

This user manual provides information on the components, function, operation and maintenance of the **FrameOne Plus** desk and its components.

In case of malfunctions, it serves as an aid in troubleshooting.

The safety instructions are intended to prevent personal injury and material damage.

The user of the desk **FrameOne Plus** commit to read and follow these safety instructions.

Steelcase assumes no liability and no warranty for damage or malfunctions resulting from non-compliance with the user manual.

This user manual is part of the **FrameOne Plus** desk. It is only valid as a complete document. Even when reselling the desk, this user manual is part of the delivery contents.

Text design



- Bulleted list
 - Bulleted list within a list of action steps
- ⇒ Action step
- ⇓ Consequence of the action



Here are tips and helpful information.

Safety instructions and warnings

To prevent personal injury and damage to property, this user manual contains warnings at the appropriate locations. The symbols and signal words have the following meaning:

 DANGER	
	Danger Source of danger ⇒ Prevention measures

Indicates an imminent danger situation leading to death or severe injury if the safety precautions are not followed.

 WARNING	
	Danger Source of danger ⇒ Prevention measures

Indicates a potential danger situation that may result in death or severe injury if the safety precautions are not followed.

 CAUTION	
	Danger Source of danger ⇒ Prevention measures

Indicates a potential danger situation that may result in minor injuries if the safety precautions are not followed.

NOTICE	
	Danger Source of danger ⇒ Prevention measures

Warning of property damage or malfunction if safety precautions are not followed.

Safety

Intended use

The desk **FrameOne Plus** is designed exclusively for use as office furniture. Any other or extended use is considered improper.

Intended use also includes compliance with all instructions in the user manual.

Foreseeable misuse

Improper use of the product may result in dangers to life and limb as well as property damage. For this reason, improper use is prohibited. In case of improper use, Steelcase assumes no liability for any damage that may occur and does not guarantee that the components will function properly.

Improper use includes:

- Use as a climbing aid.
- Permanent storage surface for objects with a total weight of more than approx. 75 kg.
- Outdoor use.
- Use in damp rooms.

The list does not claim to be exhaustive.

Safety instructions

The desk **FrameOne Plus** may be used and operated only in perfect technical condition and in compliance with the user manual.

The user of the **FrameOne Plus** desk commits to follow the safety instructions and warnings in this user manual.

In addition to the user manual, the general and local regulations on accident prevention and environmental protection must be made available and followed.

Product description

Technical data

The nameplate is located on the underside of the desktop.

FrameOne Plus

Dimensions	see delivery note
Weight	see delivery note

Type 10 Standard / Type 10 Eco / Type 16

Temperature range at the installation site:	+5 °C to +35 °C
Maximum load capacity:	Approx. 75 kg / 750 N
Maximum adjustment range:	
- Base	680 mm to 760 mm
- Telescope part	640 mm to 920 mm

Type 10 Loop

Temperature range at the installation site:	+5 °C to +35 °C
Maximum load capacity:	Approx. 75 kg / 750 N
Height:	740 mm

Factory setting on delivery

The desk reference height is on delivery:

- Variant Type 10 Standard Fixed Top 740 mm
- Variant Type 10 Standard Sliding Top (Facility Manager) 740 mm
- Variant Type 10 Standard User Slide 740 mm
- Variant Type 10 Loop Fixed Top 740 mm
- Variant Type 10 Loop Sliding Top (Facility Manager) 740 mm
- Variant Type 10 Loop User Slide 740 mm
- Variant Type 10 EcoPack 740 mm
- Variant Type 16 740 mm



For the **Telescope** variants, you can change these settings according to your needs. The corresponding descriptions are available under **Operation and settings**.

Components

The **FrameOne Plus** desk consists mainly of the following components (description of the variants are available under the respective chapter):

- Desktop with plastic parts for plate mounting
- Optional: sliding top
- Side panels
- Modesty panels
- Type 10 Standard: columns made of sheet steel, welded, including adjusting screw to compensate for uneven floors
- Type 10 Loop: closed rectangular frame per side (fixed height, adjusting screw to compensate for uneven floors)
- Type 10 EcoPack: columns made of sheet steel, welded, including adjusting screw to compensate for uneven floors
- Type 16: columns made of sheet steel, welded, including adjusting screw to compensate for uneven floors
- Top cantilever left/right
- Support cantilever
- Manual height adjustment (telescopic)

All available components are specified in the separate technical description and in the price list.

Accessories

A wide range of accessories is available in various materials, surface treatments and dimensions. Please follow the instructions for using components and accessories (see *Operation and settings* on Page 16).

For detailed information on available system components and for additional orders and subsequent deliveries, please contact our Customer Service (see *Customer Service* on Page 29).

Overview of *FrameOne Plus* desk

Each illustration shows one of many design variants of the **FrameOne Plus** desk. The illustrations merely serve to demonstrate the desk components.

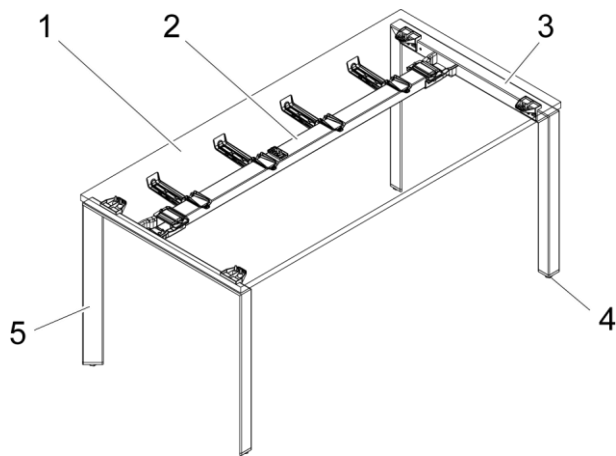

Fig. 1 Type 10 Standard Fixed Top

- 1 Sliding desktop (closed)
- 2 Support cantilever
- 3 Cantilever
- 4 Adjusting screw for height compensation
- 5 Column

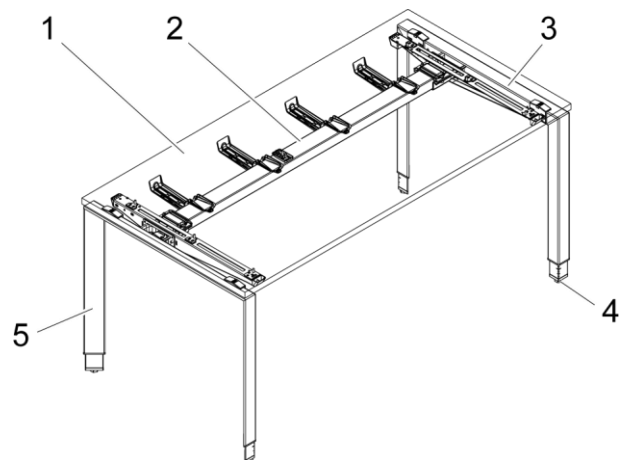

Fig. 2 Type 10 Standard Sliding Top, Variant Telescope

- 1 Sliding desktop (closed)
- 2 Support cantilever
- 3 Cantilever
- 4 Adjusting screw for height compensation
- 5 Telescopic column

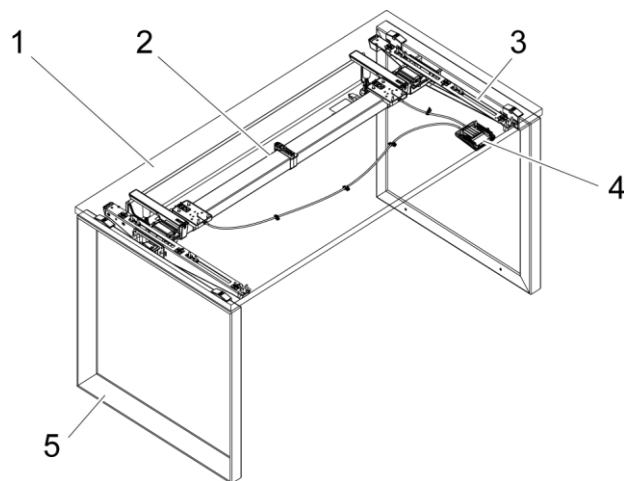

Fig. 3 Type 10 Loop User Slide



- 1 Sliding desktop (closed), user-operated
- 2 Support cantilever
- 3 Cantilever
- 4 Sliding device
- 5 Rectangular frame with adjusting screw for height compensation



Adjusting the desk height is described under **Operation and settings**.

Transport and storage

Safety instructions

 WARNING	
	<p>Injuries and damage are possible!</p> <p>When lifting on the desktop or attached components, the fastening screws may tear.</p> <p>⇒ Transport or move the desk only by grabbing the base frame.</p>



Interim storage

If you want to store the desk temporarily before installation, the following conditions must be met:

- The transport packaging must be intact.
- Sufficient carrying capacity of the floor.
- Dry floor.
- Horizontal storage surface.
- Temperature range +5 °C to +40 °C.

Installation and assembly

Safety instructions

 WARNING	
	<p>Danger of injury and damage!</p> <p>When lifting on the desktop or attached components, the fastening screws may tear.</p> <p>⇒ Transport or move the desk only by grabbing the base frame.</p>

Checking the delivery contents

After unpacking, the product must be checked immediately for transport damage and for completeness. Any damage must be reported to the manufacturer as soon as possible.

Disposing of the packaging material

The packaging includes the following:

- Outer packaging made of cardboard.
- Polyethylene (PE) foil.
- Bubble wrap made of polyethylene (PE).
- Edge protectors made of cardboard or polyethylene (PE).
- Corner protectors made of polyethylene (PE).

These materials are recyclable. When the product is assembled by Steelcase or an authorised installer, the packaging is disposed of by the manufacturer. If you install yourself, please ensure sorted separation and return to the recycling cycle.

Installing the desk

Installation and use of the product requires detailed planning. For this purpose, Steelcase offers its own planning department.

The partially assembled components of the **FrameOne Plus** desk are usually delivered by specialist dealers or directly from the manufacturer.

The installation location must meet the following requirements:

- Sufficient carrying capacity of the floor.
- Horizontal storage surface.

Assembling the desk

Steelcase recommends assembly by a specialist dealer or an assembly company.

Height compensation

To compensate for uneven ground, you can raise each foot by up to 1.0 cm with an adjusting screw.

For a desk that has already been assembled: before levelling, remove any objects from the desk top.

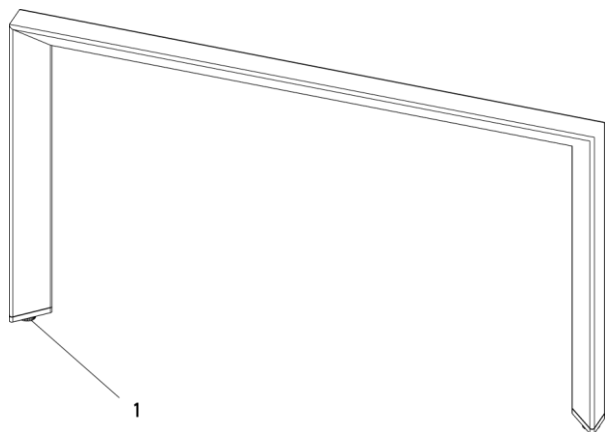

Fig. 4 **FrameOne Plus Standard** height compensation

1 Adjusting screw

Procedure:

⇒ Turn adjusting screw (1) until the height adjustment is complete.

Disassembling and reassembling the desk temporarily

If you want to disassemble, temporarily store and reassemble the desk, for example for a move, see sections *Transport and storage* and *Installation and assembly*.

Disassembling the desk

The desk can be disassembled into its partially assembled components. Disassembly should be carried out by qualified personnel. Follow the separate assembly instructions.

If you want to disassemble the desk for good and dispose of it, follow the instructions under *Disposal of the desk*.

Reassembling the desk

For reassembly, see *Installation and assembly* on Page 13



Operation and settings



Safety instructions



The desk **FrameOne Plus** may be used and operated only in perfect technical condition and in compliance with the user manual.

Before you change the desk height, make sure of the following:

- The desktop must be horizontal. In case of uneven floors, you can adjust the height using the adjusting screws on the feet.
- Nobody should be on the desktop.
- The maximum permissible carrying capacity of the desk must not be exceeded.

 DANGER	
	<p>Danger from electrical voltage!</p> <p>Metal parts of the desk may be under electrical voltage in case of damage to live cables and connections.</p> <p>⇒ Do not earth electrical devices on the desk frame!</p>

 WARNING	
	<p>Danger of injury and damage!</p> <p>When lifting on the desktop or attached components, the fastening screws may tear.</p> <p>⇒ Transport or move the desk only by grabbing the base frame.</p>

 WARNING	
	<p>Danger of injury!</p> <p>Climbing on the desk leads to risk of falling.</p> <p>⇒ Do not use the desk as climbing aid.</p>



Ensure that the connecting cables of devices on the desk are long enough.

Optimum desk height

FrameOne Plus Type 10 Standard, Type 10 EcoPack and Type 16: Setting the optimum desk height (seat height) is crucial for the correct sitting position at the workplace. The desk height to be set for the workplace can be taken from the workplace analysis (for example, according to the German Occupational Safety and Health Act, the German VDU Ordinance, accident prevention regulations). See also BGI 650: Screen and office workstations. Design guidelines.

Carrying out height compensation

You can carry out height compensation on all desks except for **Type 10 Loop**. You can adjust the height by a maximum of 10 mm for uneven floors with an adjusting screw on each desk foot.



Fig. 5 Type 10 Standard height compensation

1 Adjusting screw

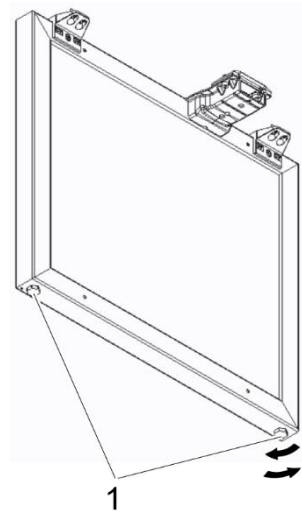

Fig. 6 Type 10 Loop height compensation

1 Adjusting screw

Procedure:

- ⇒ Remove all objects from the desk.
- ⇒ Turn adjusting screw (1) until the height adjustment is complete.

Height adjustment

Height adjustment is only possible on variants *Telescope*. Height adjustment of the **FrameOne Plus Type 10 Standard, Type 10 EcoPack and Type 16** desks is done in the same way. Type 10 Standard, variant Telescope was used for the illustration.

Type 10 Standard *Loop*

The desk has a fixed height of 740 mm. The desk height is not adjustable.

Variant *Telescope*

The desk can be adjusted continuously to a height between 640 and 920 mm.

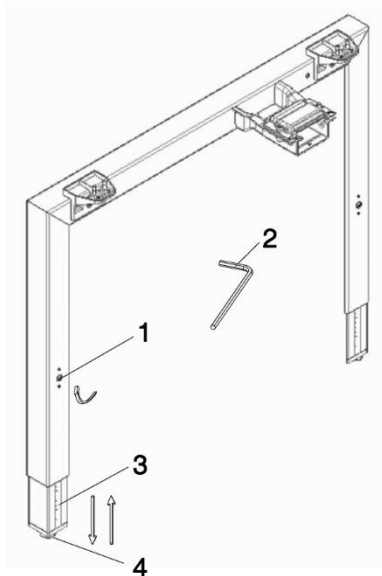

Fig. 7 Type 10 Standard, variant Telescope: Adjusting the desk height

- 1 Fastening screw
- 2 Allen key
- 3 Scale
- 4 Adjusting screw for height compensation

Procedure:

- ⇒ Remove all objects from the desk.
- ⇒ Loosen the fastening screw (1) with an Allen key (2).
- ⇒ Pull up or slide down the telescopic column to the desired length; see scale (3).
 - Hold the desk top while doing so!
 - Do not stay under the desk while adjusting the height!
- ⇒ Tighten the fastening screw (1) to a maximum of 3.5 Nm.
- ⇒ Set all columns to the same height
- ⇒ If necessary, adjust the height with the adjusting screw (4) afterwards.

Sliding top (optional)

The **FrameOne Plus** desk is available with a sliding desktop (not for depth 600). The sliding top allows you to reach the cable duct even if the rear of the desk is not accessible.



Ensure that the connecting cables of devices on the desk are long enough.



WARNING



Danger of injury!

If the extended sliding desktop is under load, the desk may tip!

⇒ Do not load the extended top.

NOTICE



Damage to the desk and objects is possible!

⇒ Keep the slide path clear.

Opening sliding desktop by user

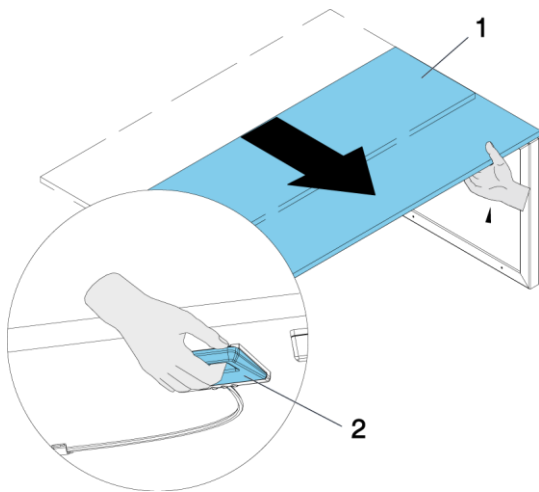



Fig. 8 Opening sliding desktop (user)

- 1 Sliding desktop
- 2 Handle of desktop locking mechanism; user-operated

Procedure:

- ⇒ Open desktop locking mechanism: pull handle (2).
- ⇒ Pull out the sliding desktop (1) up to the stop.

Closing the sliding desktop by user

⚠ WARNING	
	<p>Danger of crushing!</p> <p>During the sliding process, hands and fingers can be crushed between the sliding desktop and the following parts of the table components:</p> <ul style="list-style-type: none">• Fixed parts of the desk.• Attachments, such as modesty panels and cable openings.• Cut-outs at the back of the desktop. <p>⇒ Keep hands and fingers away from moving parts.</p>

NOTICE	
	<p>Closed desktop locking mechanism may damage the sliding desktop when closing!</p> <p>⇒ To close the sliding desktop, the desktop locking mechanism must be open.</p>

Procedure:

- ⇒ Push the sliding desktop (1) in until it reaches the stop at the safety lock.
- ⇒ Closing the desktop locking mechanism: pull handle (2), slide in sliding desktop (1) to the stop and allow the lock to engage, unload handle (2).

Opening sliding desktop by Facility Manager

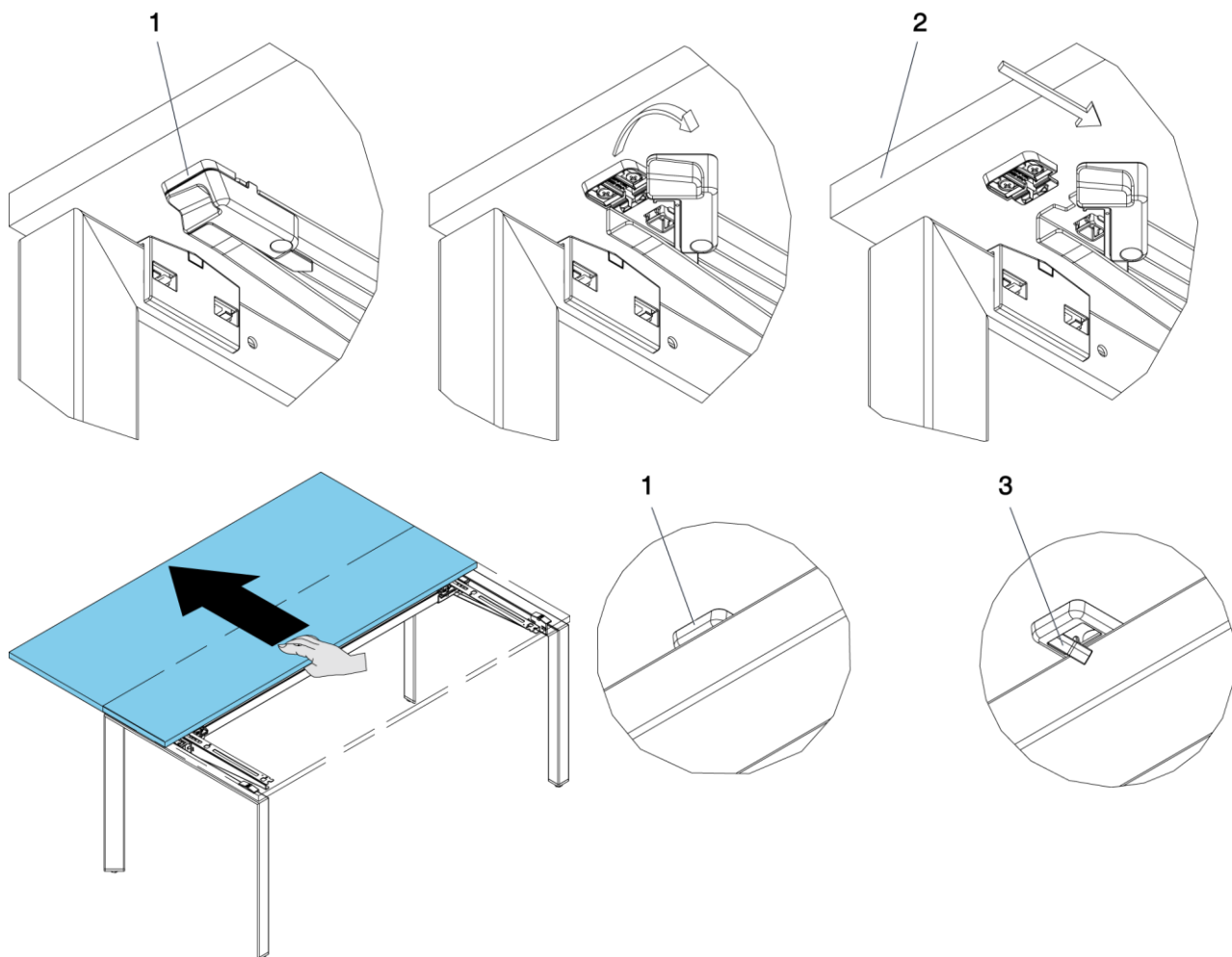



Fig. 9 Opening sliding desktop (Facility Manager)

- 1 Safety lock of the desktop locking mechanism
- 2 Sliding desktop
- 3 Locking bolt 25mm

Procedure:

- ⇒ Opening desktop locking mechanism: open the movable part of the safety lock (1) sideways on both sides in the direction of the centre of the panel.
- ⇒ Pull out the sliding desktop (2) up to the stop.

Closing sliding desktop by Facility Manager

⚠ WARNING	
	<p>Danger of crushing!</p> <p>During the sliding process, hands and fingers can be crushed between the sliding desktop and the following parts of the table components:</p> <ul style="list-style-type: none">• Fixed parts of the desk.• Attachments, such as modesty panels and cable openings.• Cut-outs at the back of the desktop. <p>⇒ Keep hands and fingers away from moving parts.</p>

NOTICE	
	<p>Closed desktop locking mechanism may damage the sliding desktop when closing!</p> <p>⇒ To close the sliding desktop, the desktop locking mechanism must be open.</p>

(For procedure, see next page)

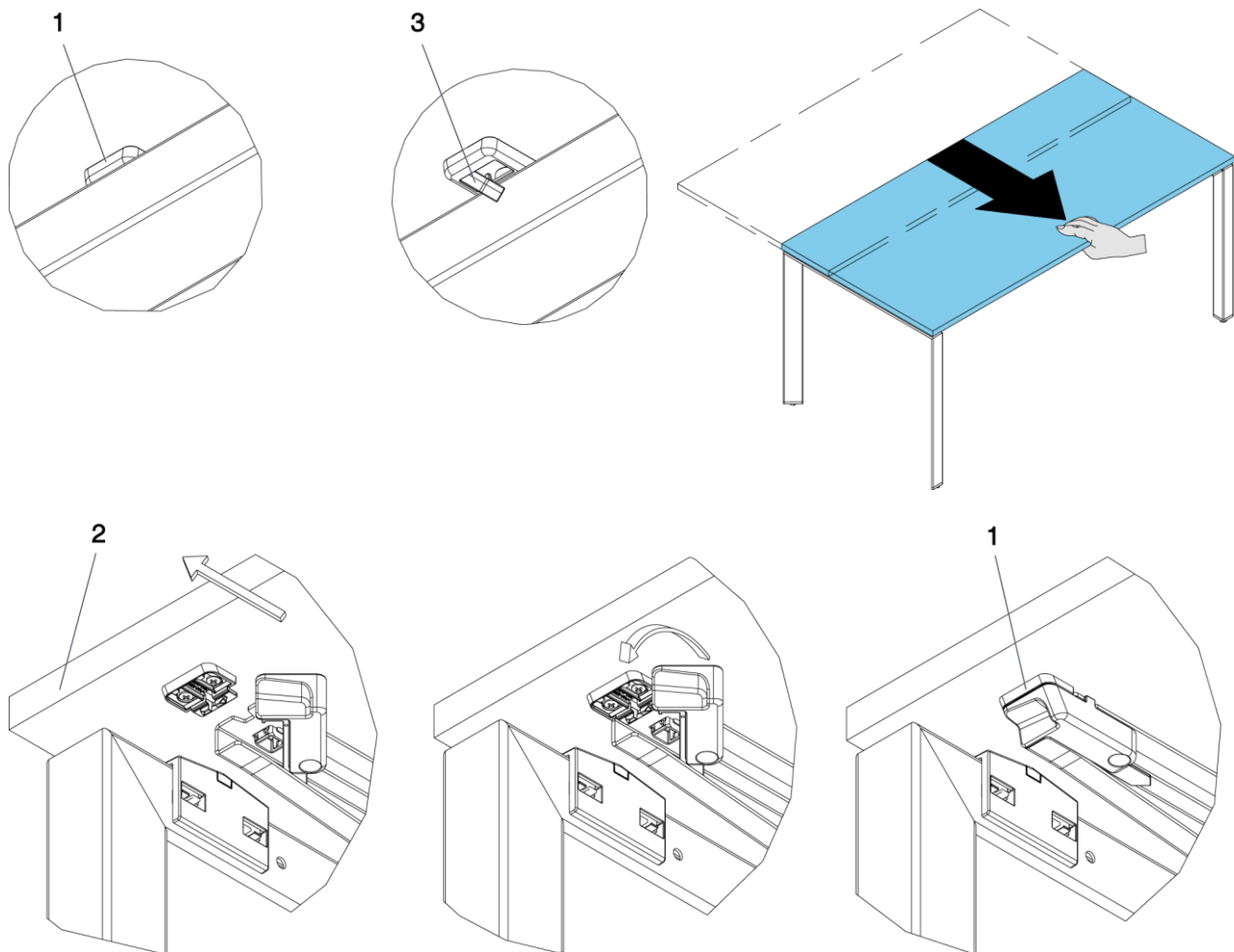

Fig. 10 Closing the sliding desktop

- 1 Safety lock of the desktop locking mechanism
- 2 Sliding desktop
- 3 Locking bolt 25mm

Procedure:

- ⇒ Unlock safety lock (1): swivel in locking bolt 25 mm (3).
- ⇒ Push the sliding desktop (2) in until it reaches the stop at the safety lock (1).
- ⇒ Opening desktop locking mechanism: turn in the movable part of the safety lock (1) sideways and engage using the safety lock.

Faults and malfunctions

If malfunctions occur during operation, please check whether the FrameOne Plus desk has been handled according to the user manual. In most cases, this will help you find and eliminate the problem.

If it is not possible to eliminate fault or malfunctions, please contact our Customer Service Department (see *Repairs and spare parts* on Page 29).

Maintenance

Safety instructions

- ⇒ Only appropriately qualified and authorised personnel may carry out maintenance and repair work.
- ⇒ Only use suitable tools for these operations!

Functional checks

The components of the **FrameOne Plus** desk should be checked for their functionality at regular intervals.

Table for functional checks

Interval	Inspection point	Functional check	Permitted value	Act if necessary
During assembly	Frame parts	Position of the desktop cross-member	Desktop cross-member completely inserted into the guides and screwed tight.	⇒ Loosen the screws, insert the desktop cross-member correctly and tighten the screws.
Before each height adjustment	Immediate environment of the desk	Check safety distances.	No objects in the lifting range.	⇒ Remove objects.
	Desktop	Check for horizontal alignment.	Horizontal	⇒ Align using the adjusting screws on the feet.

Maintenance work

Only authorised specialist personnel may carry out maintenance work. Please contact our Customer Service Department for assistance (see *Repairs and spare parts* on Page 29).

Before adjusting the height of the desk, make sure that the desktop is horizontal. If the floor is uneven, align the desktop with the adjusting screws on the feet.

⚠ WARNING	
	<p>Danger of injury and damage!</p> <p>When lifting on the desktop or attached components, the fastening screws may tear.</p> <p>⇒ Transport or move the desk only by grabbing the base frame.</p>

NOTICE	
	<p>Damage to the desktop is possible!</p> <p>After disassembling the desk, for example for transport reasons:</p> <p>⇒ Reassemble the two side frames only with the appropriate desktop cross-member of the same desk.</p> <p>⇒ Follow the separate assembly instructions.</p>

NOTICE	
	<p>Using unapproved spare parts may cause damage to the desk.</p> <p>⇒ Only components provided by Steelcase may be used as spare parts. Coordinate the installation of other parts with Steelcase.</p> <p>⇒ Observe the specified maintenance and inspection intervals.</p>

Disclaimer of liability

Steelcase assumes no liability or warranty in the following cases (see *Liability* on Page 2).

- Inadequate monitoring of the product components (function checks).
- Improper maintenance.
- Maintenance through a third party.
- Maintenance by unqualified and unauthorised personnel.
- Use of components and adaptations that do not originate from Steelcase.
- Unauthorised modifications of the product in its construction and design.
- Intentional misuse.
- Improper use.

Cleaning and care

You can use commercial cleaning agents to clean the surfaces of the desk.

NOTICE



Material damage due to unsuitable care measures is possible!

⇒ Only use care and cleaning agents that are suitable for the appropriate materials (plastic, metal).

Disposal of the desk

Disassembly should be carried out by qualified personnel.

Follow these steps to disassemble and dispose of the **FrameOne Plus** desk

⇒ Disassemble the desk into its components.

⇒ Separate the resulting parts into:

- reusable components,
- material groups to dispose of (chipboard, metal, plastic, etc.),

and return them to the recycling cycle. Follow all applicable regional regulations.

Customer Service

Delivery, installation, instruction

The manufacturer or a specialist retailer usually deliver, assemble and set up the desk.

The Manufacturer or a specialist retailer will instruct the users.

Repairs and spare parts

Original spare parts and accessories are available from the manufacturer.

If it is not possible to eliminate faults or malfunctions, please contact the Customer Service Department:

Steelcase Werndl AG
Georg-Aicher-Strasse 7
D-83026 Rosenheim, Germany
Phone: +49 80 31 405 – 377
Fax: +49 80 31 405 - 378
E-mail: support@steelcase.com

Country	Customer Service Hotline
France	+33 (0) 3 88 13 37 96
Great Britain	+44 (0) 17 53 68 02 00
Spain	+34 914 759 000 241
Italy	+39 (051) 65 00 708
The Netherlands Belgium Luxembourg Scandinavia Baltic states Poznań Czech Republic Slovakia	+31 30 634 62 41
other	+33 (0) 3 88 13 37 96