

Category 5

Ancillary and Lighting Products

E60PQ-140003/041/PQ

FYI monitor arms by Steelcase



According to a 2013 Microsoft survey, workers spend seven hours each day in front of computers, often leading to eyestrain, back pain and fatigue. Designed to display screens at optimal heights, FYI monitor arms adjust quickly and easily to accommodate any posture, increasing comfort and wellbeing in the workplace.

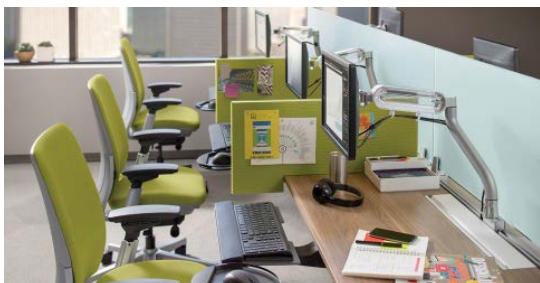

Category 5

Ancillary and Lighting Products

E60PQ-140003/041/PQ

Keyboard trays by Steelcase



Employee wellbeing is vital for maximizing individual and organizational potential. Workspace and worktools have a profound impact on overall health. Steelcase keyboards and mechanisms prioritize comfort and customization, offering well-designed office solutions to support a healthy, productive workforce.



Category 5

Ancillary and Lighting Products

E60PQ-140003/041/PQ

Computer support tools by Steelcase



Computers are getting smaller every day. Unless CPUs are stored properly, they can be difficult to access and can take up valuable floor or worksurface space. CPU holders securely store CPUs within reach, yet out of the way.



Description

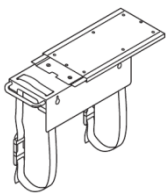

work surface mounted

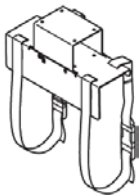

stand alone – fixed

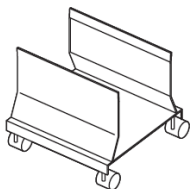

stand alone – mobile

Category 5

Ancillary and Lighting Products

E60PQ-140003/041/PQ

Revo task light by Steelcase



Revo LED personal task light is an attractive addition to any workspace. Dimmable, with a fully articulating body, Revo LED easily adjusts to provide precise lighting where it's needed. The soft, blended light pattern ensures visual comfort, while a touch pad under the head allows you to control power with a single touch.

Mounting Types



desk base

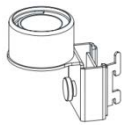

grommet mount



clamped to worksurface



system slat wall mounted