

Series 7 - Adjustable Height Tables

Installation Instructions 005255D Rev D

Tools required:

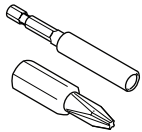

#2 Phillips Bit
with Extension

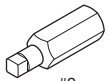

#2
Square Drive Bit

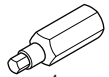

4mm
Hex Drive Bit

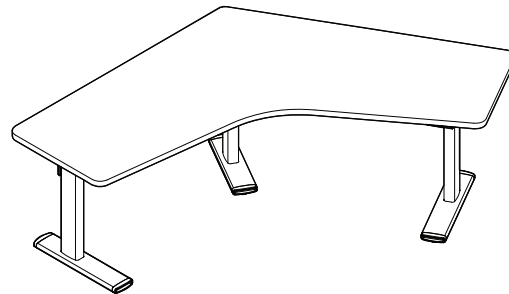
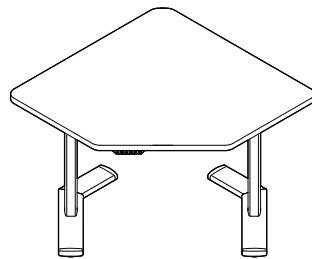
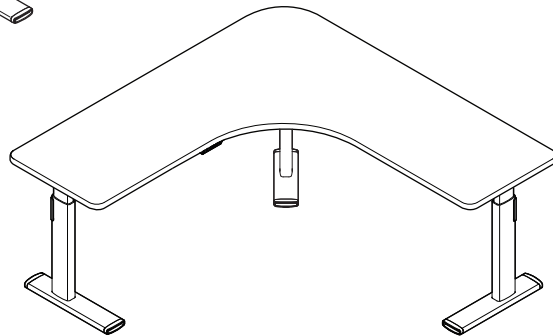
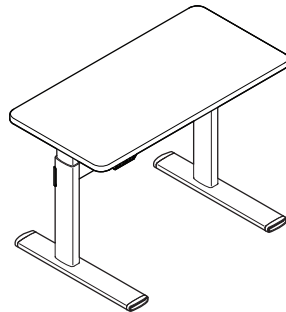
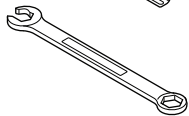
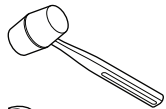

005255D Rev D

IMPORTANT SAFETY INSTRUCTIONS

When using an electrical furnishing, basic precautions should always be followed, including the following:

Read all instructions before using (this furnishing).

DANGER - To reduce the risk of electric shock:

1. Always unplug this furnishing from the electrical outlet before cleaning.

WARNING - To reduce the risk of burns, fire, electric shock, or injury to persons:

1. Unplug from outlet before putting on or taking off parts.
2. Close supervision is necessary when this furnishing is used by, or near children, invalids, or disabled persons.
3. Use this table only for its intended use as described in these instructions. Do not use attachments not recommended by the manufacturer.
4. Never operate this table if it has a damaged cord or plug, if it is not working properly, if it has been dropped or damaged, or dropped into water.
5. Keep the cord away from heated surfaces.
6. Never drop or insert any object into any opening.
7. Do not use outdoors.
8. Do not operate where aerosol (spray) products are being used or where oxygen is being administered.
9. For loading always put heavier items at the bottom and not near the top in order to help prevent the possibility of the furnishing tipping over.

SAVE THESE INSTRUCTIONS

The power socket/outlet shall be installed near the equipment and shall be easily accessible.

TABLE OF CONTENTS:	PAGE(S):
Lets Get Started!.....	4
Attaching Stretchers.....	5
Attaching Mounting Plate to Legs.....	6 & 7
Mounting Legs to Worksurface.....	8 & 9
Attaching Control Box & Wire Managers.....	10 & 11
Connecting & Routing Cables.....	12 & 13
Attaching the Controller.....	14 & 15
Finishing the Leg Installation.....	16
Finishing the Table Assembly.....	17 & 18
Guidelines on Moving the Table.....	19
Wiring Guide.....	20
Appendix A: 2-Piece Worksurface Assembly.....	21 & 22

Overview of Assembly Process

- 1) Determine the table configuration.
- 2) Assemble 2-piece worksurface (if applicable).
- 3) Assemble and attach stretchers.
- 4) Attach legs to worksurface (with worksurface upside-down).
- 5) Attach control box and wire managers.
- 6) Connect and route cables.
- 7) Attach the controller.
- 8) Check for binding and finish leg attachment.
- 9) Flip table upright and test function.
- 10) Level and clean it up.
- 11)

**PLEASE LEAVE THESE INSTRUCTIONS, AND
THE USER GUIDE, IN AN OBVIOUS PLACE
FOR THE END USER AFTER ASSEMBLY.**

Let's Get Started!

- 1 Prepare a large open space to assemble the table.
 - Sweep the floor! Screws and small parts can damage the worksurface.
 - Put down a CLEAN shipping blanket to protect the worksurface.



- 2 Unpack the worksurface and place on the shipping blanket upside-down.
 - REMEMBER - You're looking at the UNDERSIDE of the worksurface. Are you sure which side is left or right?

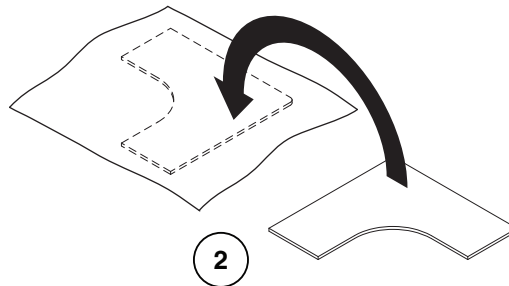

- 3 Assembling a 90° corner table with a 2-piece worksurface? Jump to Appendix 'A' now.

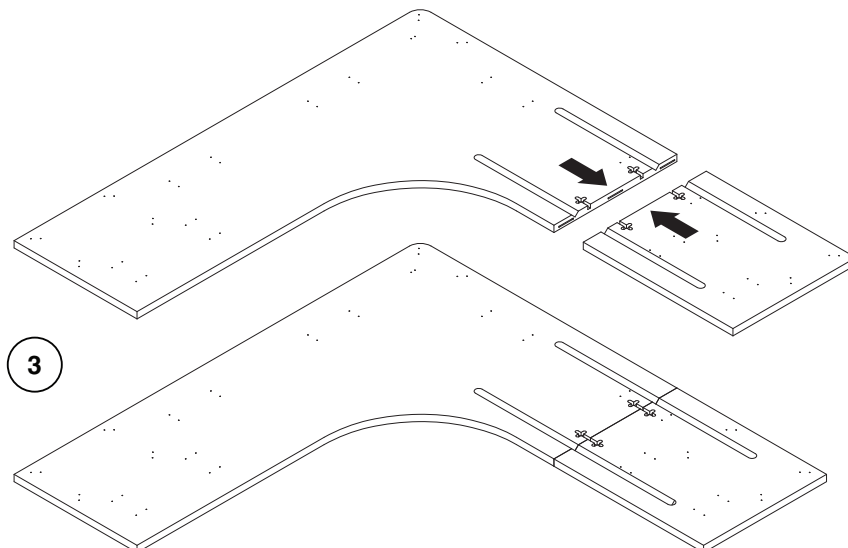

Attaching Stretchers

- 4** Layout the left and right stretcher assembly and the center connector with the dovetails pointing down. Loosely install the center connector to the left and right stretcher using two (2) 1/4-20 type F flat head screws with phillips #3 drive...do not tighten. (Left and right is determined when the table is standing on the base and is viewed from the front.)

NOTE:

A clean, abrasion free surface will be necessary for table assembly.

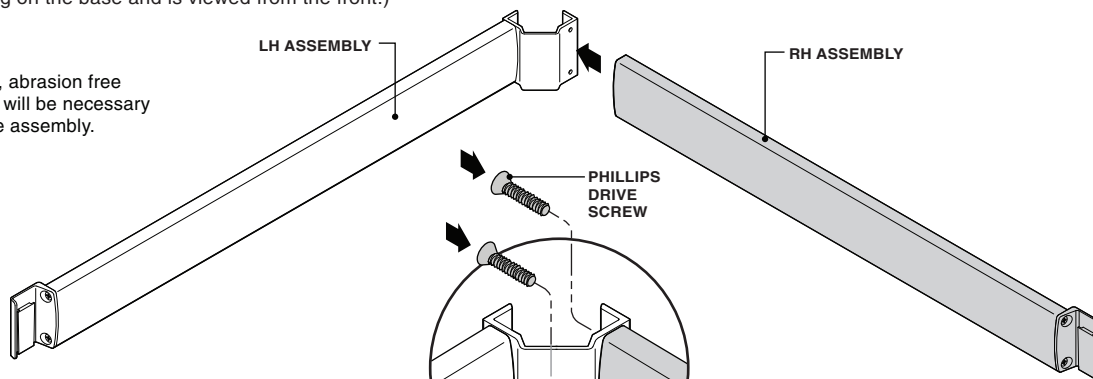

- 5** Layout the left, right and center lift columns, place the stretcher into each dovetail, connect loosely.

NOTE:

On 90° or 120° tables, a 21" foot is required when the side of the worksurface is greater than 46". If the worksurface side is less than 46", a 18" foot is required.

- 6** Once each lift column has been engaged, lightly tap each connection point with a rubber mallet 1/8-1/4 inch at a time, until completely seated. Do not completely install one lift column at a time...they must be installed incrementally.

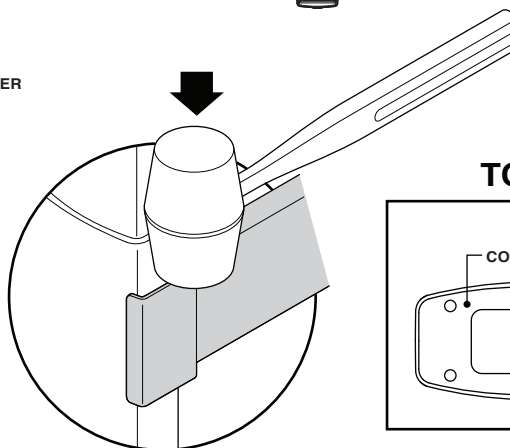
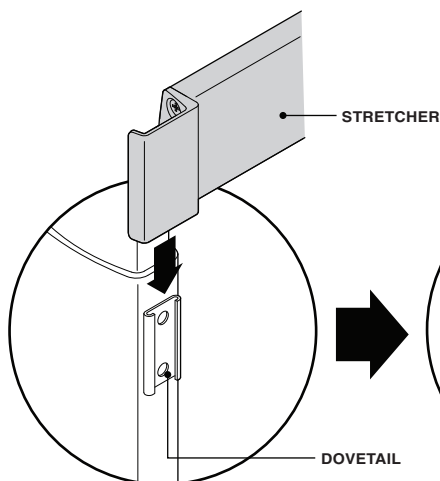
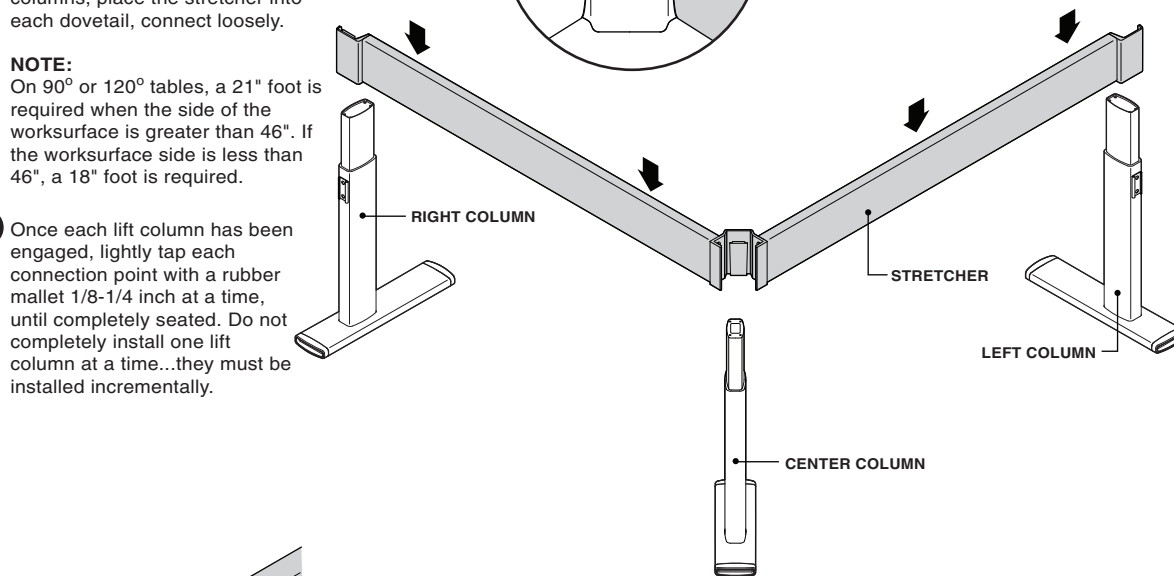

TOP VIEW

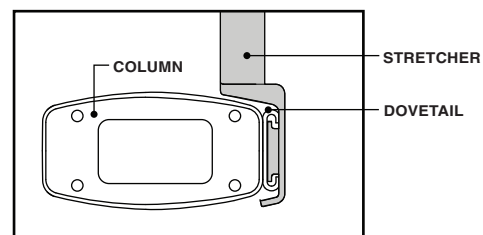

005255D Rev D

Attaching Mounting Plate to Legs

For 2-Leg Tables:

- 7 For each lift column, fold the electrical 'pig-tail' towards the center of the surface. Secure in the notch provided in each lift column.

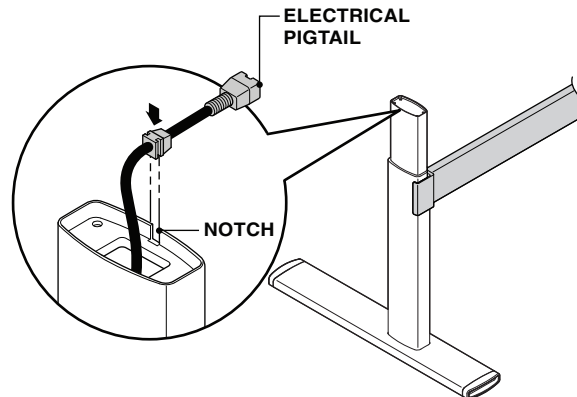

- 8 Locate and install each mounting plate using 4mm hex head fasteners provided. Tighten securely.

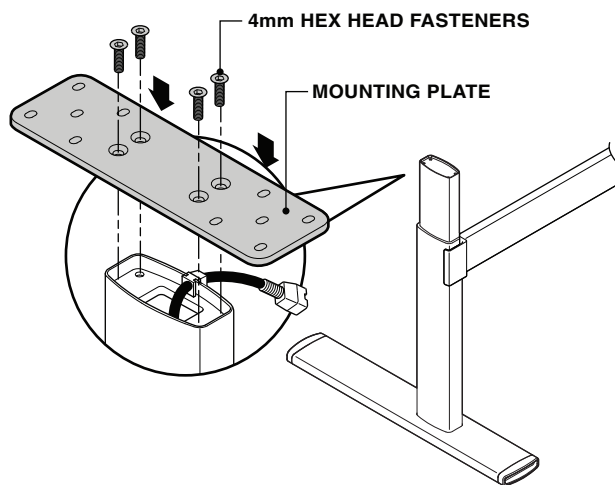

005255D Rev D

Attaching Mounting Plate to Legs (cont.)

For 3-Leg Tables:

- 7 For the left and right lift columns, fold the electrical 'pig-tail' towards the center lift column using the notch provided in each lift column to secure. The center lift column 'pig-tail' can be folded in either direction.

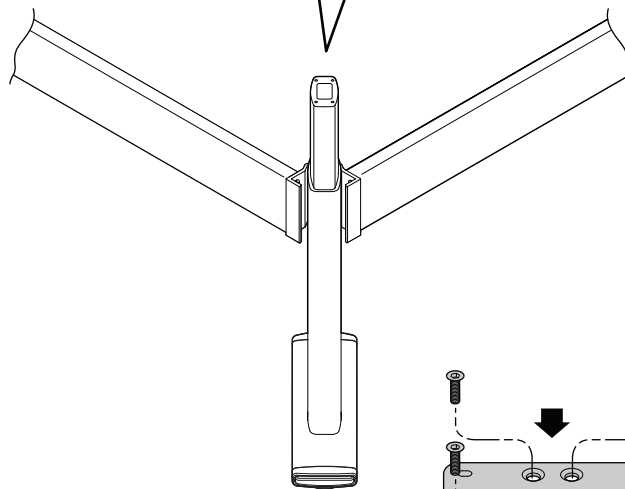
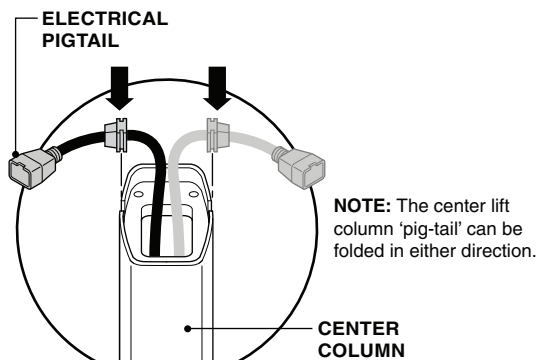

4mm HEX HEAD FASTENERS

MOUNTING PLATE

- 8 Locate and install each mounting plate using 4mm hex head fasteners provided. Tighten securely.

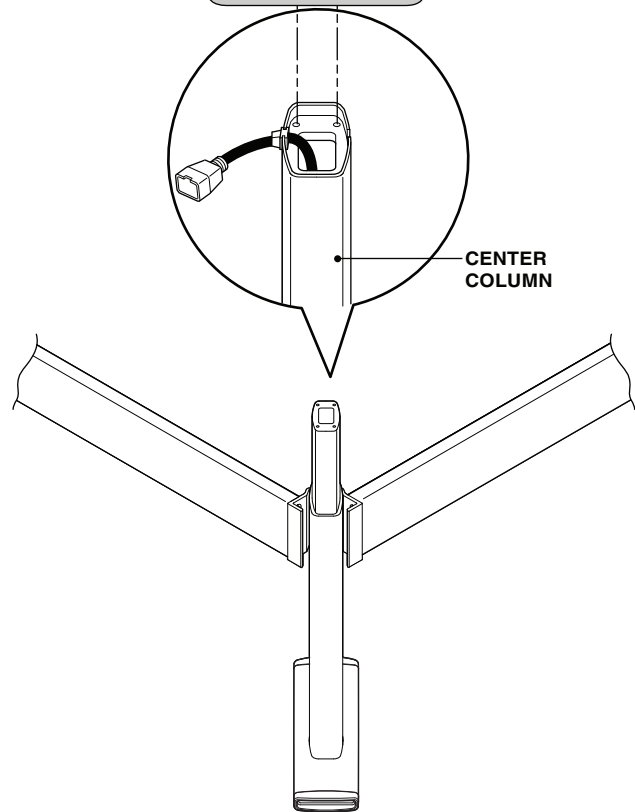

005255D Rev D

Mounting Legs to Worksurfaces

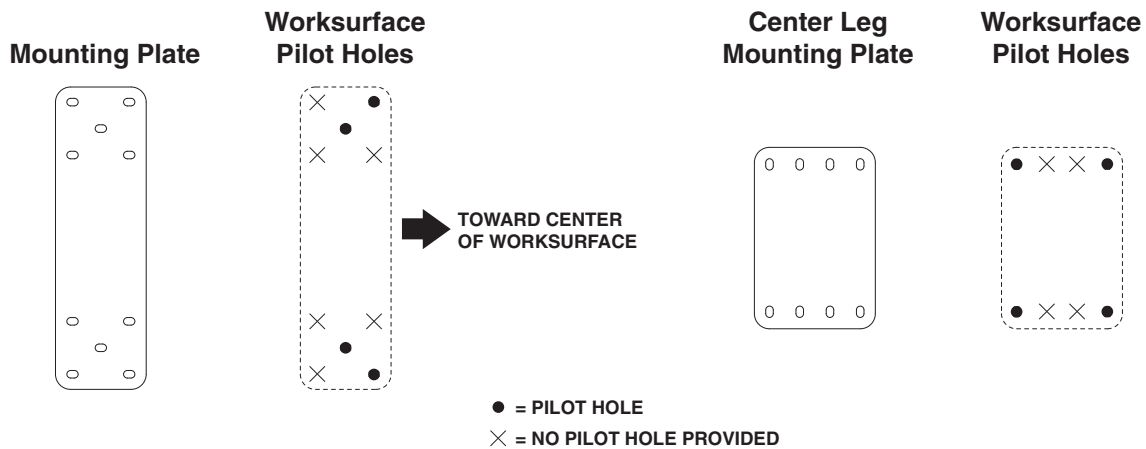

For 2-Leg Tables:

- 9 With the top still upside down on the floor, turn the base over (flipping is a 2 person job), and align the attachment plates to the pre-drilled holes in the top.

Loosely install one fastener in each of the pre-drilled pilot holes.

Don't install all fasteners until the unit has been operated through one cycle (Step 15).

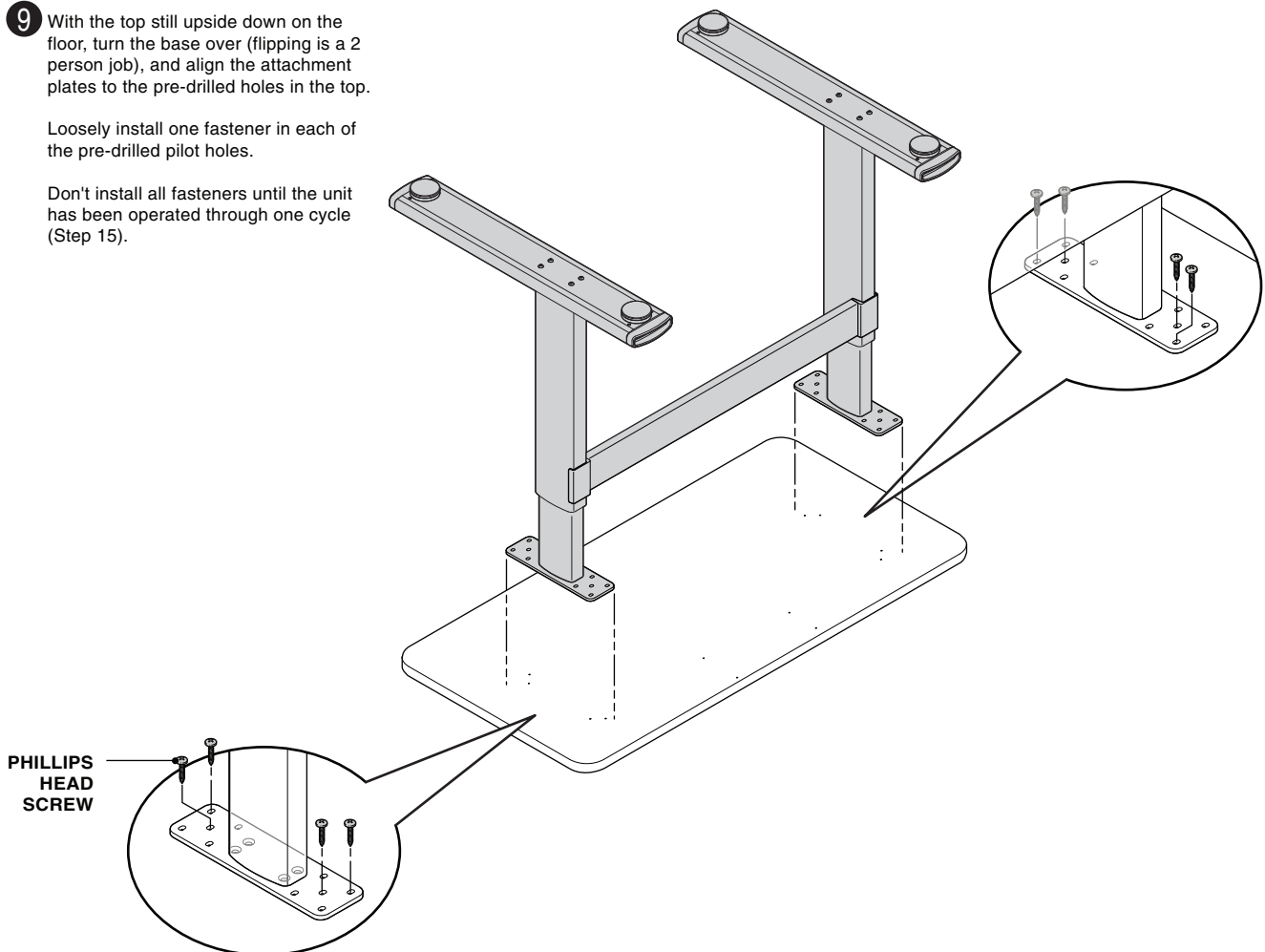

Mounting Legs to Worksurfaces (cont.)

For 3-Leg Tables:

- 9 With the top still upside down on the floor, turn the base over (flipping is a 2 person job), and align the attachment plates to the pre-drilled holes in the top. Align the center lifting column first.

Center each pre-drilled hole in the top to the slot in the attachment plate. Loosely install one fastener in each of the pre-drilled pilot holes.

Once the center lifting column is secured, align the left and right lifting columns in a similar fashion by moving the plate so that all pre-drilled holes are visible.

Don't install all fasteners until the unit has been operated through one cycle (Step 15).

NOTE: Do not force the left or right lifting columns to perfectly fit the attachment mounting holes. This can cause binding during articulation.

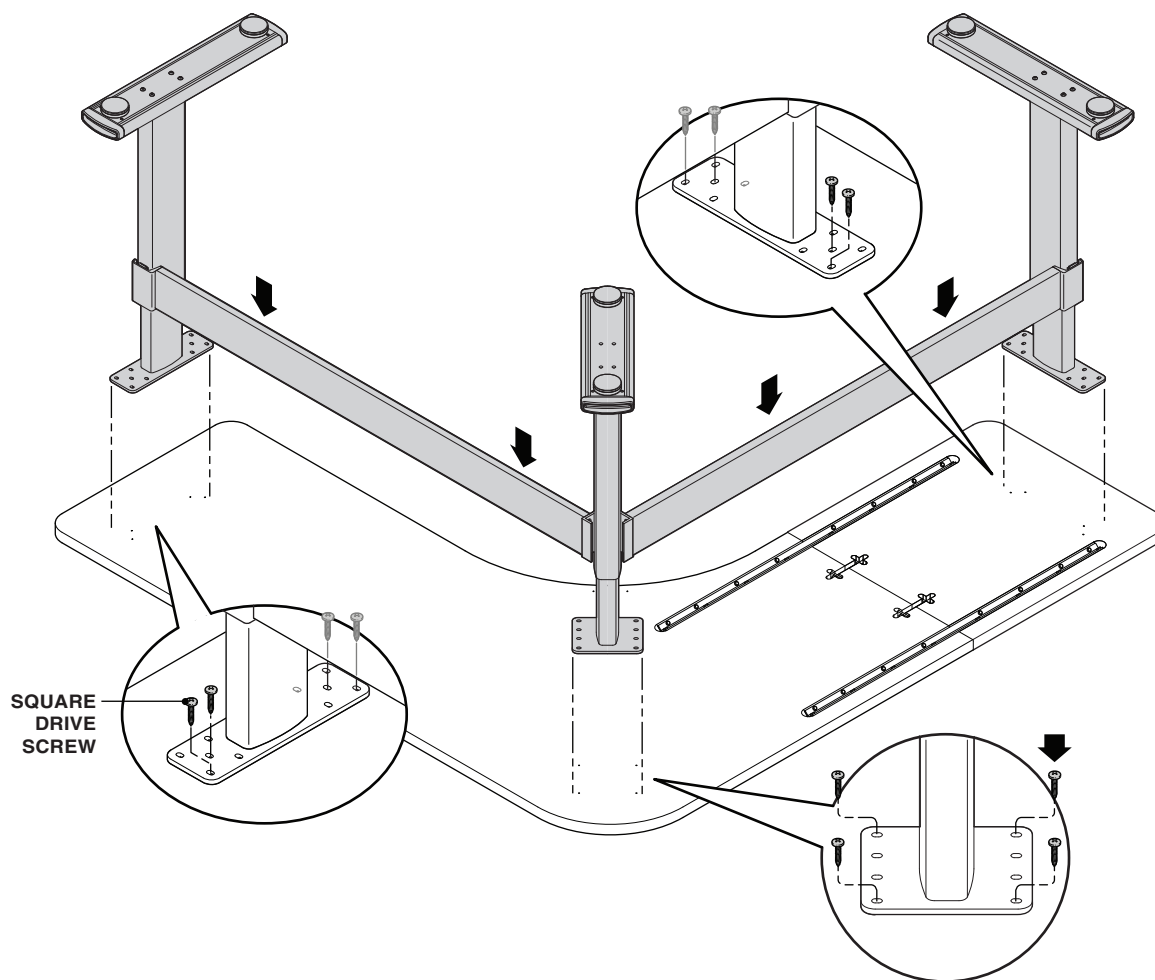

005255D Rev D

Attaching Control Box & Wire Managers

- 10** Install control box in the predetermined location, using pre-drilled holes.

CONTROL BOX

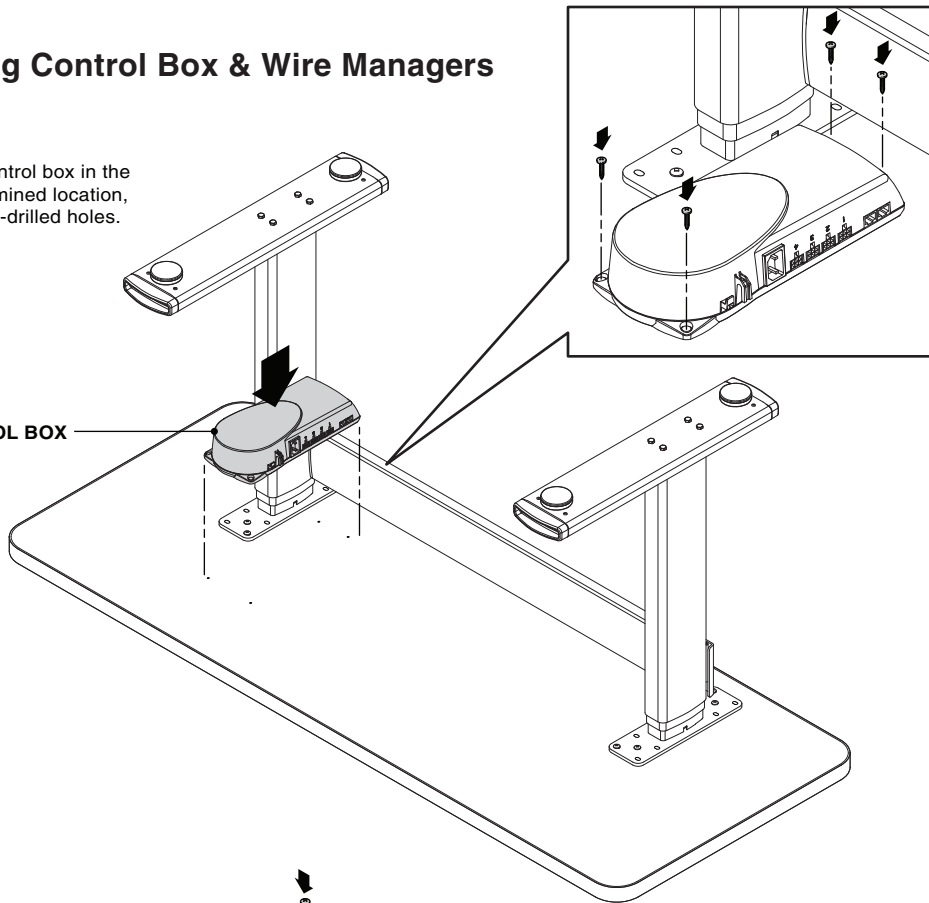

- 11** Install the wire management cableway on the underside of the work surface at the rear.

WIRE MANAGER

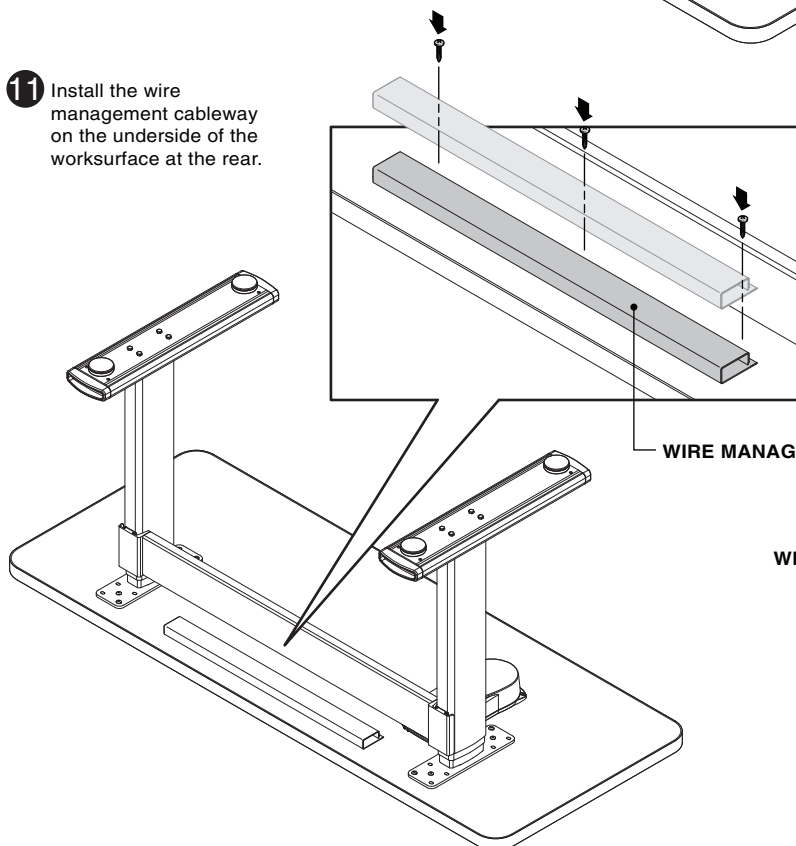

WIRE MANAGER

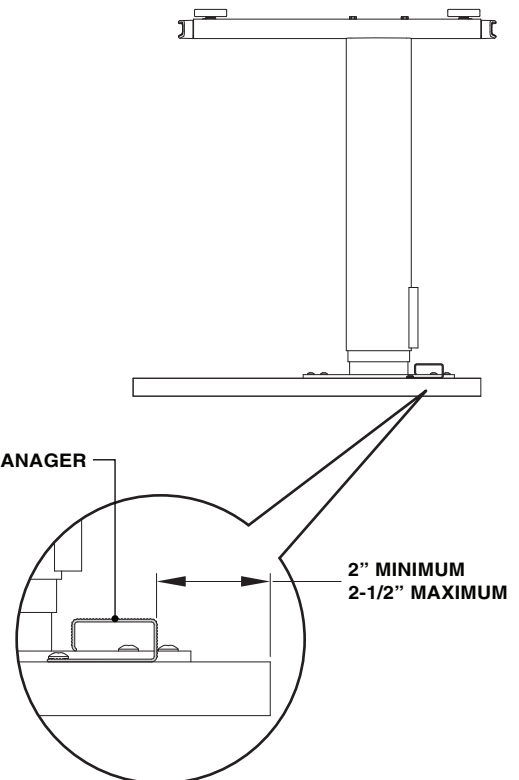

2" MINIMUM
2-1/2" MAXIMUM

005255D Rev D

Attaching Control Box & Wire Managers (cont.)

- 11** Install the wire management cableways onto the underside of the worksurface as shown.

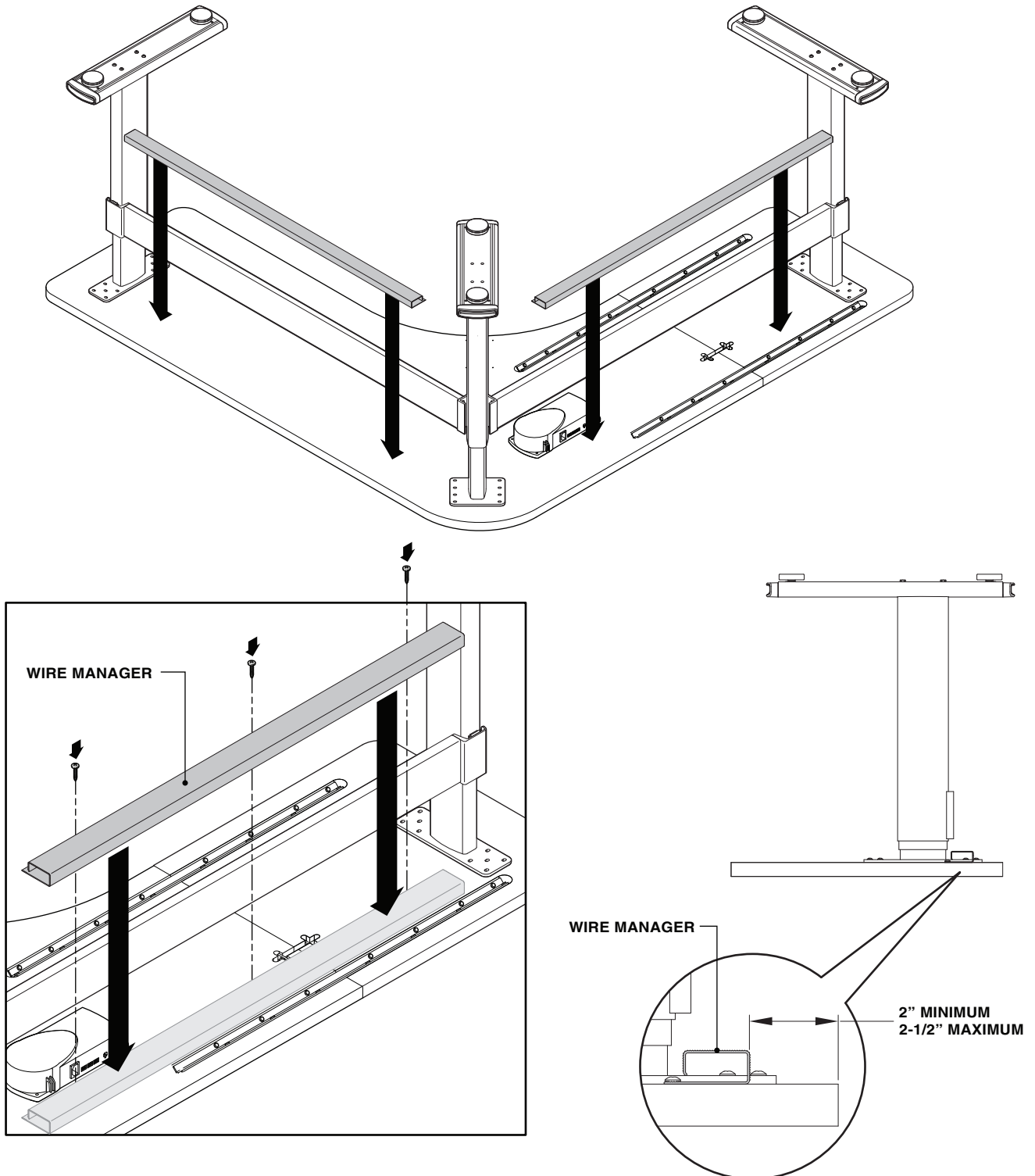

005255D Rev D

Connecting & Routing Cables

For 2-Leg Tables:

- 12** Connect the cables to each lifting column and connect the terminal end to the control box. Route these cables in the wire management cableway provided. Refer to the Wiring Guide for more information on page 20.

For optimal wire management, connect lifting columns to the closest port on the control box.

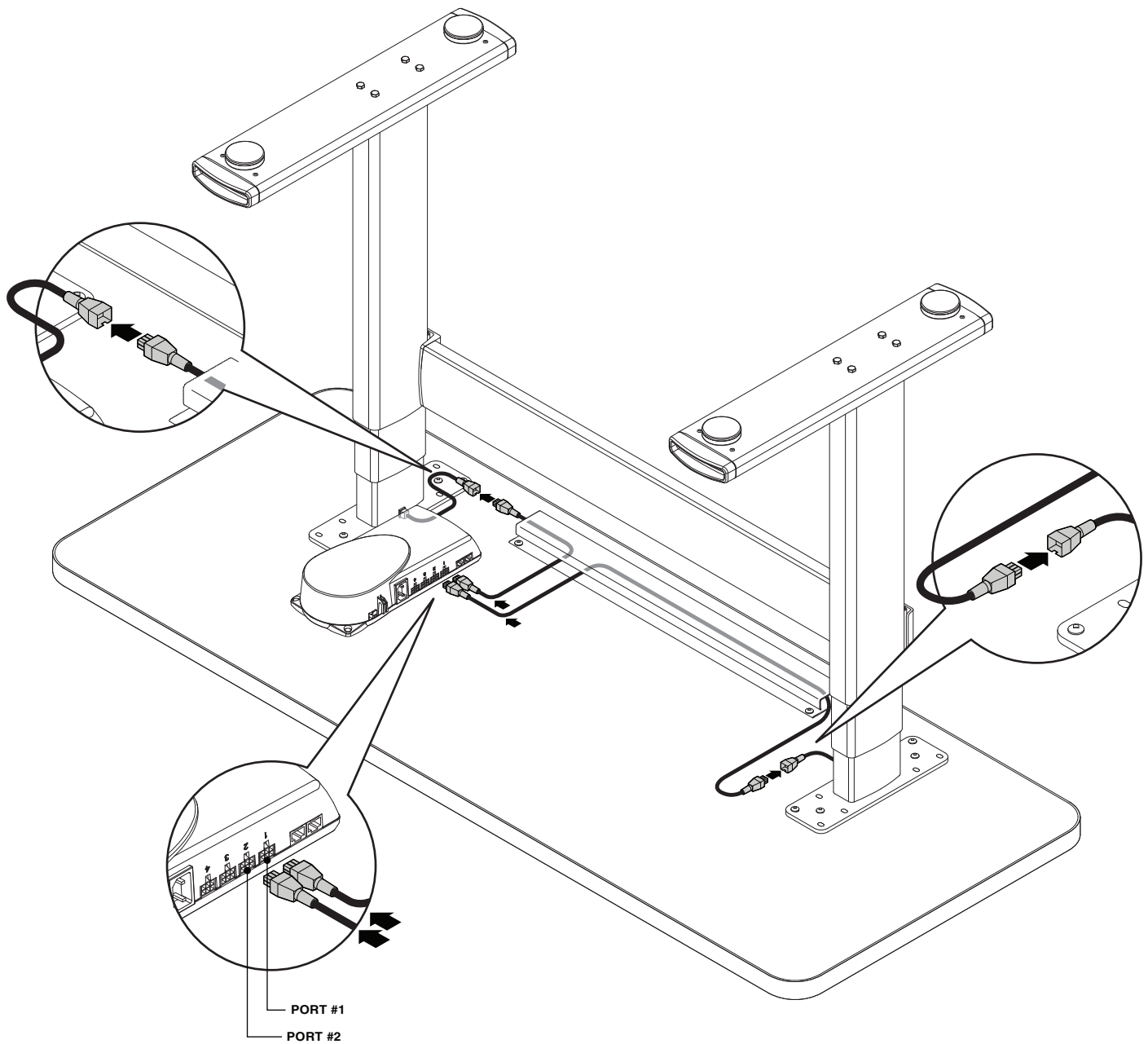

005255D Rev D

Connecting & Routing Cables (cont.)

For 3-Leg Tables:

- 12 Connect the cables to each of the three lifting columns and connect the terminal end to the control box. Route these cables in the wire management cableway provided. (2000mm cables to the left and right lifting columns & 1000mm cable to the center lift column.) Refer to the Wiring Guide on page 20 for more information.

For best wire management, connect lifting columns to the closest port on the control box.

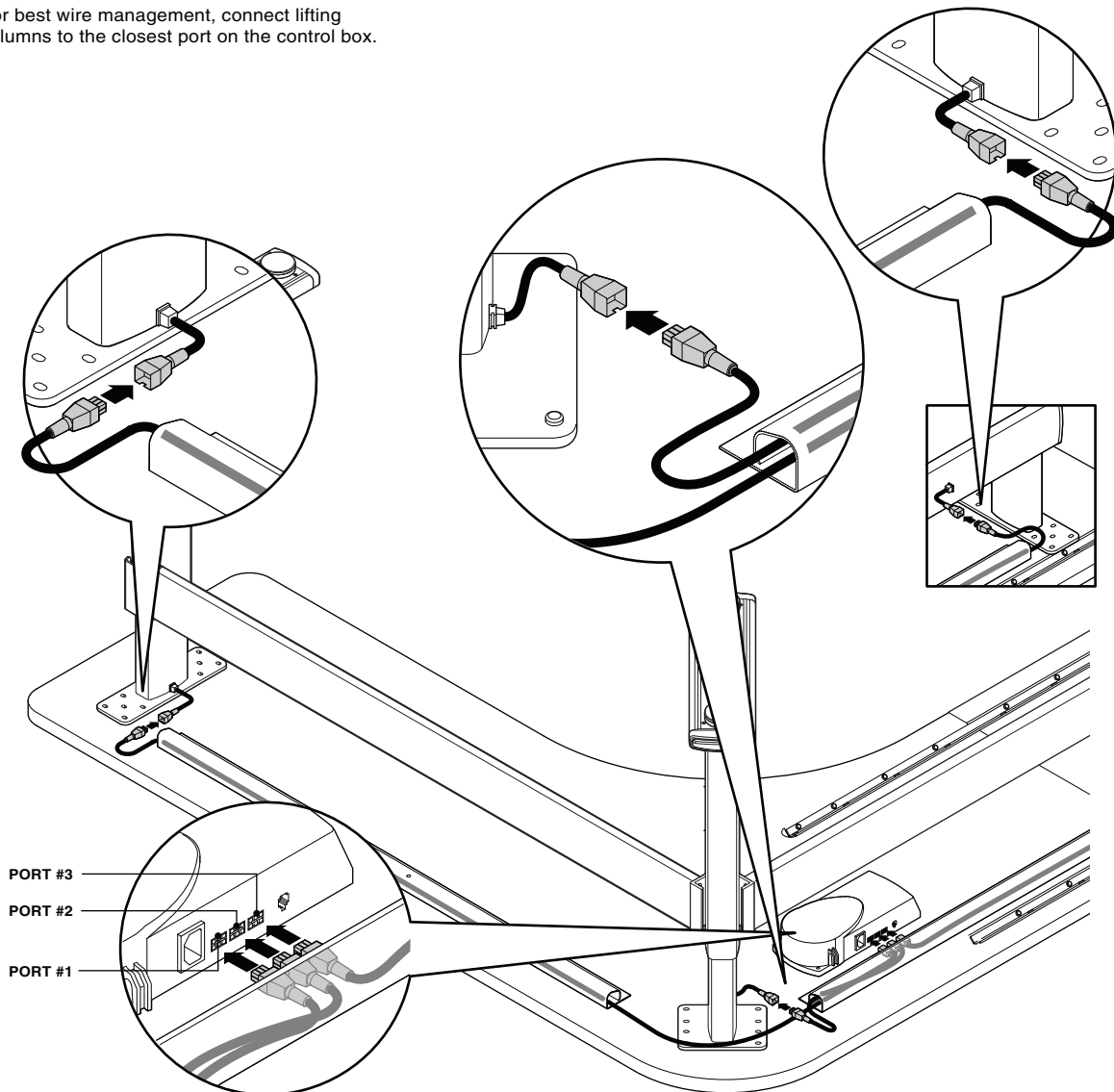

005255D Rev D

Attaching the Controller

- 13** Install the controller to the underside of the worksurface on the side preferred by the user. (We recommend it be placed toward the outside of the table to avoid interference in the workspace.)

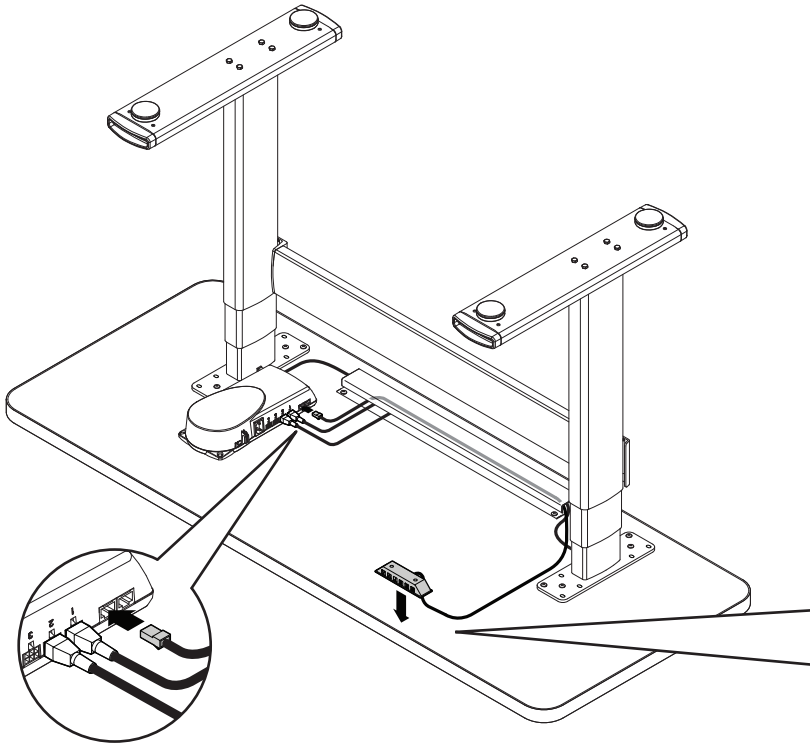

Push Button Stick-On Controller

NOTE: Push button stick-on controller installation is shown here. However, the controller cannot be installed until the worksurface is flipped over. Once step 18 is performed, the controller may then be installed.

NOTE: Remove paper backing from controller before installation.

Standard Controller

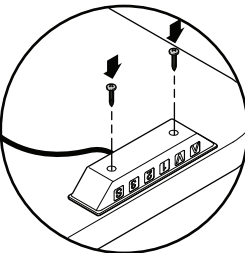
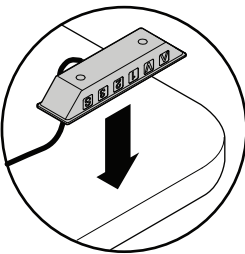

Digital Desk Panel Controller

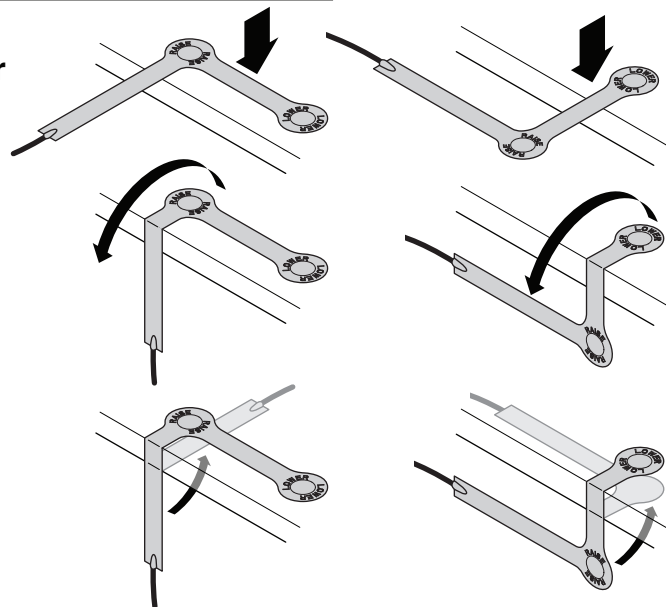
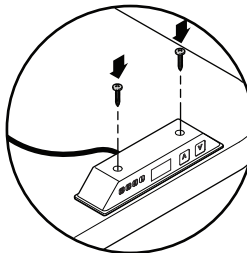
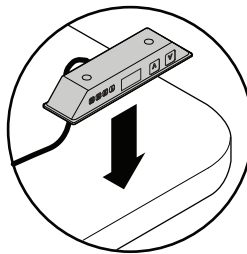

005255D Rev D

Attaching the Controller (cont.)

- 14 Install the wire keepers for the control wire. Peel off paper backing and stick to worksurface. Place wire into each wire keeper.

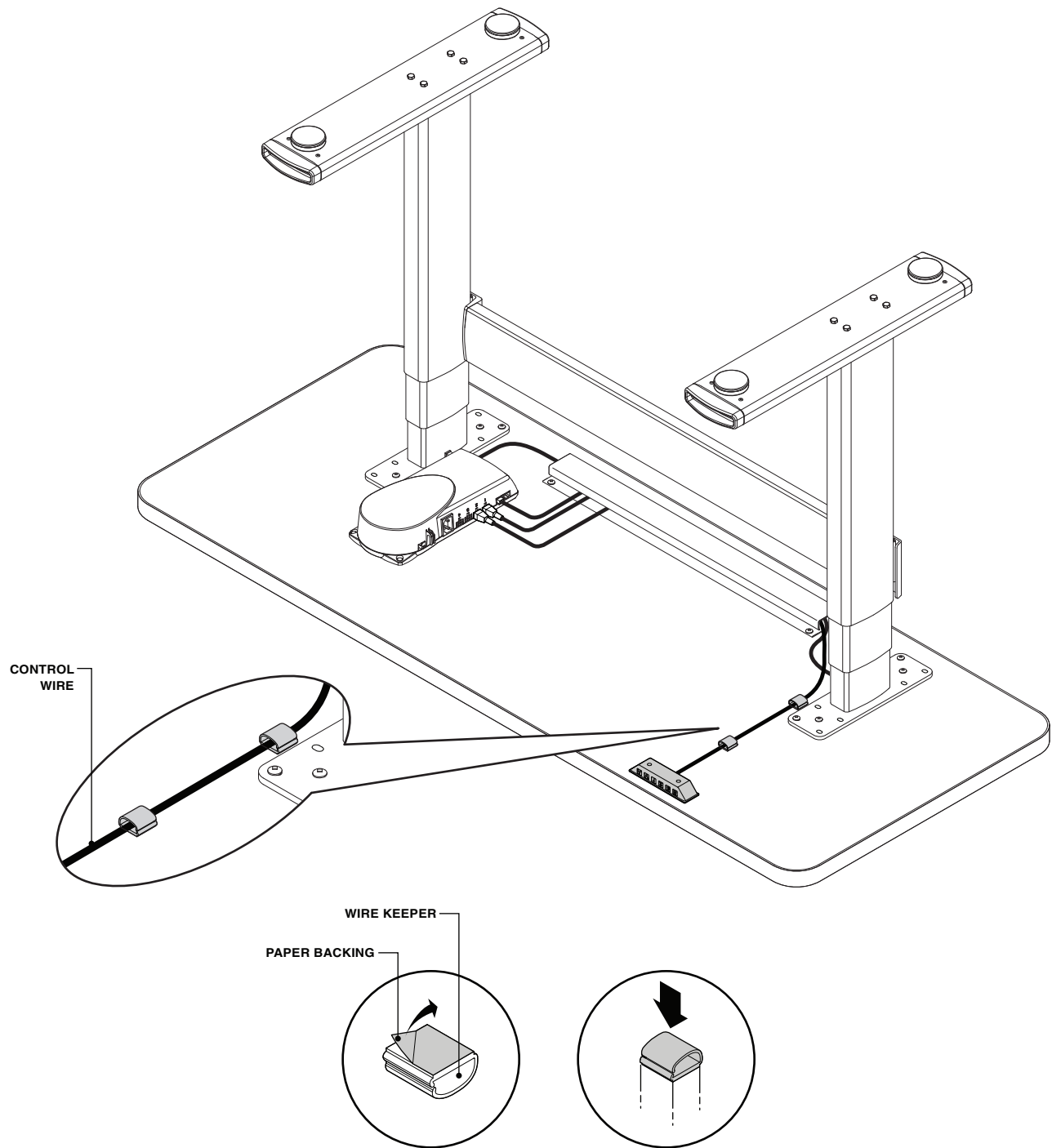

005255D Rev D

Finishing the Leg Installation

- 15** Plug unit in and check for binding, by running the table base all the way through its range of motion and back again, then lower to bottom and unplug unit. Install the remaining fasteners in each of the remaining holes and tighten **ALL** screws securely. **Do not over tighten.**

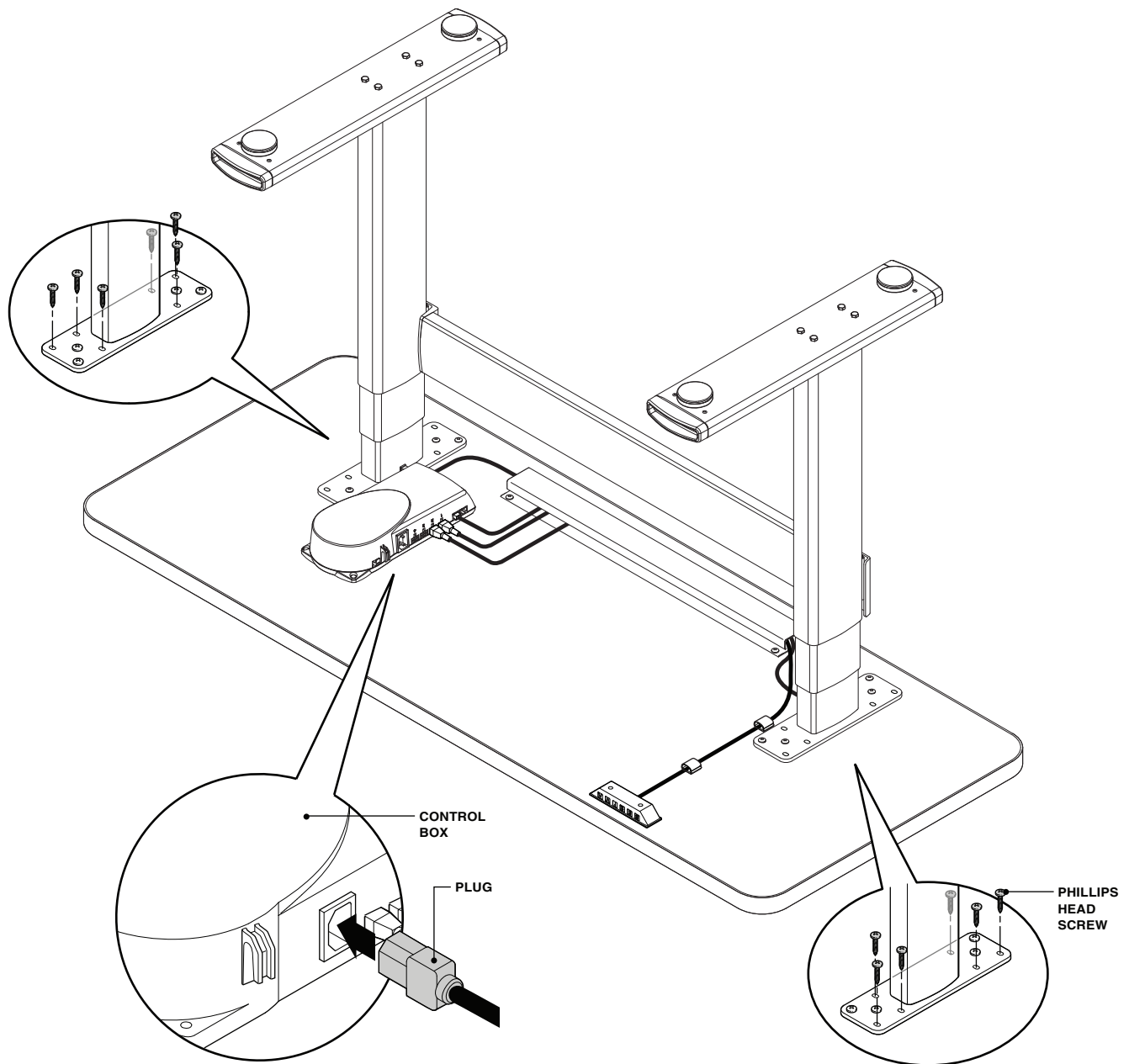

005255D Rev D

Finishing the Table Assembly

- 16** Carefully turn the table over (2 person operation).

NOTE: Do NOT use either lifting column as a brace when turning the table over, as this may cause binding. The top must be lifted free, rotated, and set down carefully.

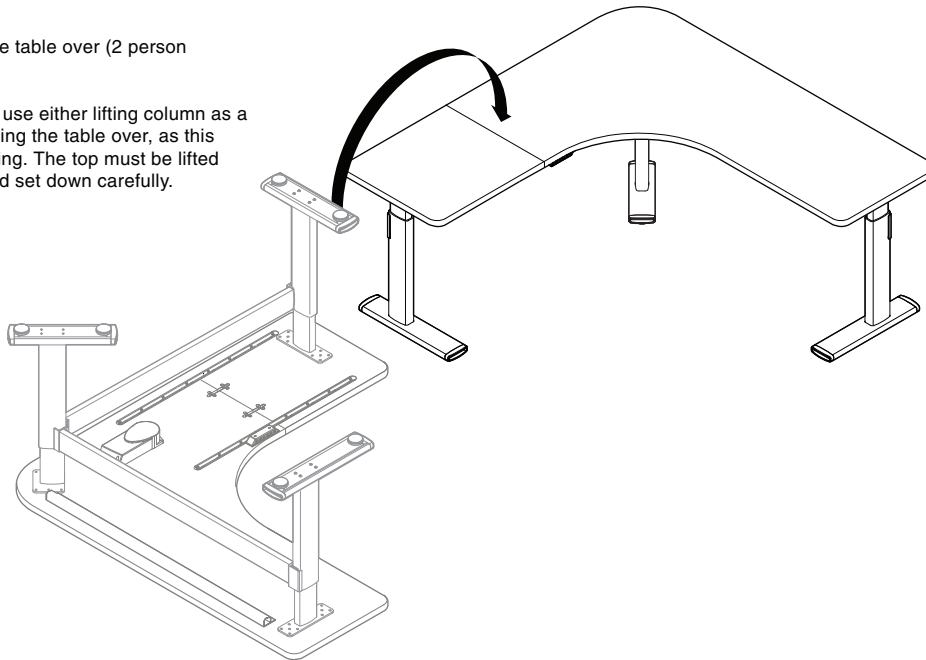

- 17** After the table is in place, install the 120v plug into the control box. Secure the cord to the control box using the molded-in clip. Plug the cord into an outlet.

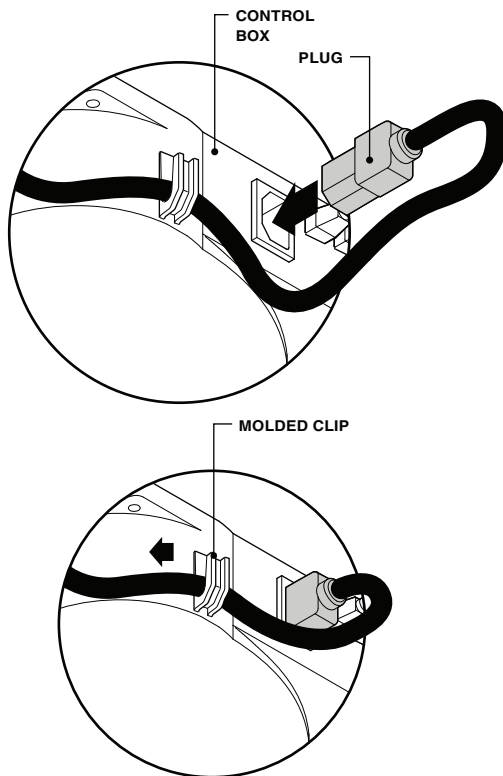

- 18** Connect power cord to power supply.

CAUTION: Be sure to create a 'drip loop' in the power cord before making the connection to a live wall socket, to prevent electric shock if liquids spill on power cord.

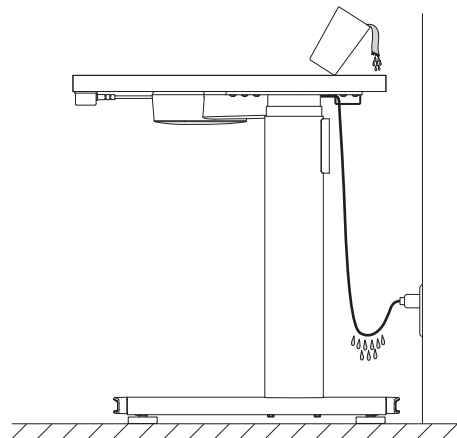

- 19** Route all cables through wire managers. Keep all cables clear of moving parts!

Finishing the Table Assembly (cont.)

- 20** Before use, the table must be completely leveled, front-to-back and side-to-side using the height adjustable glides. Failure to do this could cause the lifting columns to bind.

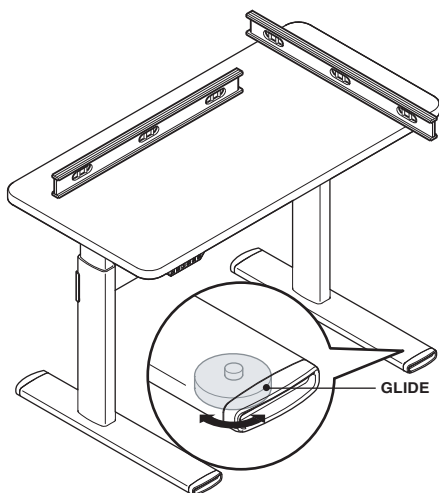

Synchronizing the Lifting Columns

Prior to initial use of the height adjustment function you must "synchronize the system".

- Press the Down arrow until the worksurface comes to a stop at the lowest position.
- Release the Down arrow.
- Press and hold the down arrow for approximately 5 seconds while the table synchronizes itself. The surface will quickly lower itself approximately 5mm, then rise approximately 5mm and finally settle back to its lowest position.

After performing this function, the movement of all lifting columns is synchronized by software inside the control box.

In the unlikely event that an error occurs, reset the control unit by pressing the Up and Down buttons at the same time for 5 seconds. Then repeat the synchronizing sequence as previously outlined above.

- 21** Before articulation, you must synchronize the lifting columns as outlined below.

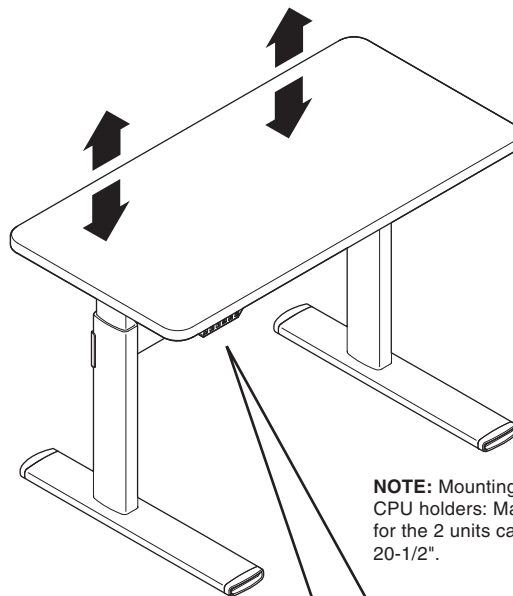

NOTE: Mounting of CPU and CPU holders: Maximum height for the 2 units cannot exceed 20-1/2".

Standard Controller

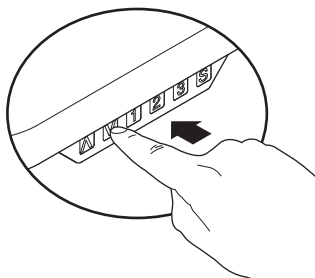

Digital Desk Panel Controller

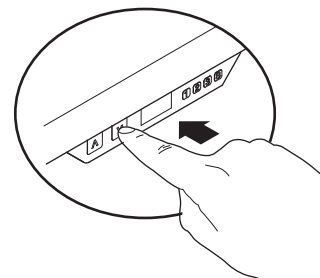

Push Button Stick-On Controller

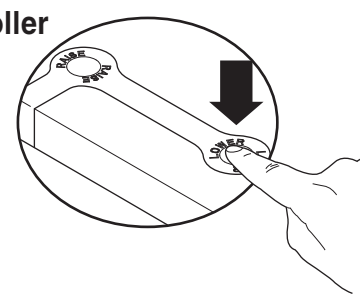
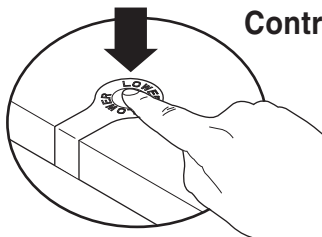

Guidelines on Moving the Table

- 1 When possible, the table should be moved in a horizontal (flat) position.
- 2 If the table must be moved vertically (i.e. standing on a pallet), care must be taken to ensure no side pressure is placed on any of the lifting columns as it is tipped into position, during transport, and when tipped off the pallet at the new location.
- 3 Before in use in the location, the table must again be completely leveled side-to-side and front-to-back. Failure to do so may cause binding of the lifting columns and failure to operate properly.
- 4 After moving, the lifting columns must be re-synchronized by holding 'down' arrow on the Controller while the lifting columns seek to level themselves.

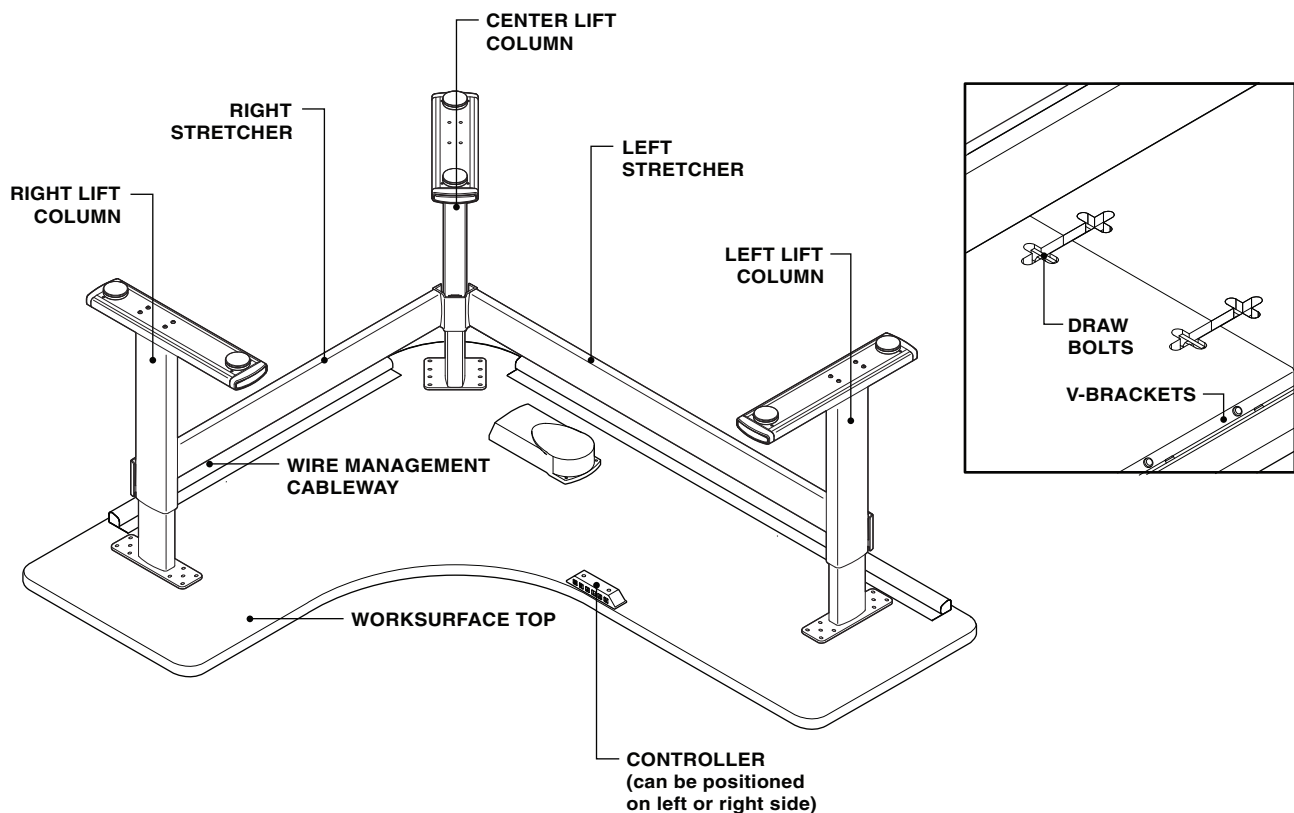

Wiring Guide

- 1 When connecting cables as stated in Step 12, use this guide as a reference.
- 2 Connect the cables from the Lifting Columns to the cables provided. The other end should be connected to the Control Box. Repeat this for each leg.
- 3 Connect the end of the Controller cable into the Control Box.
- 4 Follow Steps 13 - 15 to complete the wiring installation.
- 5 Once you have completed the wiring, use the Wire Managers to hold all the cables and minimize possible entanglements.

NOTE: Vertical wire management solutions are also available from Details. Contact your local dealer or Steelcase.com for more information.

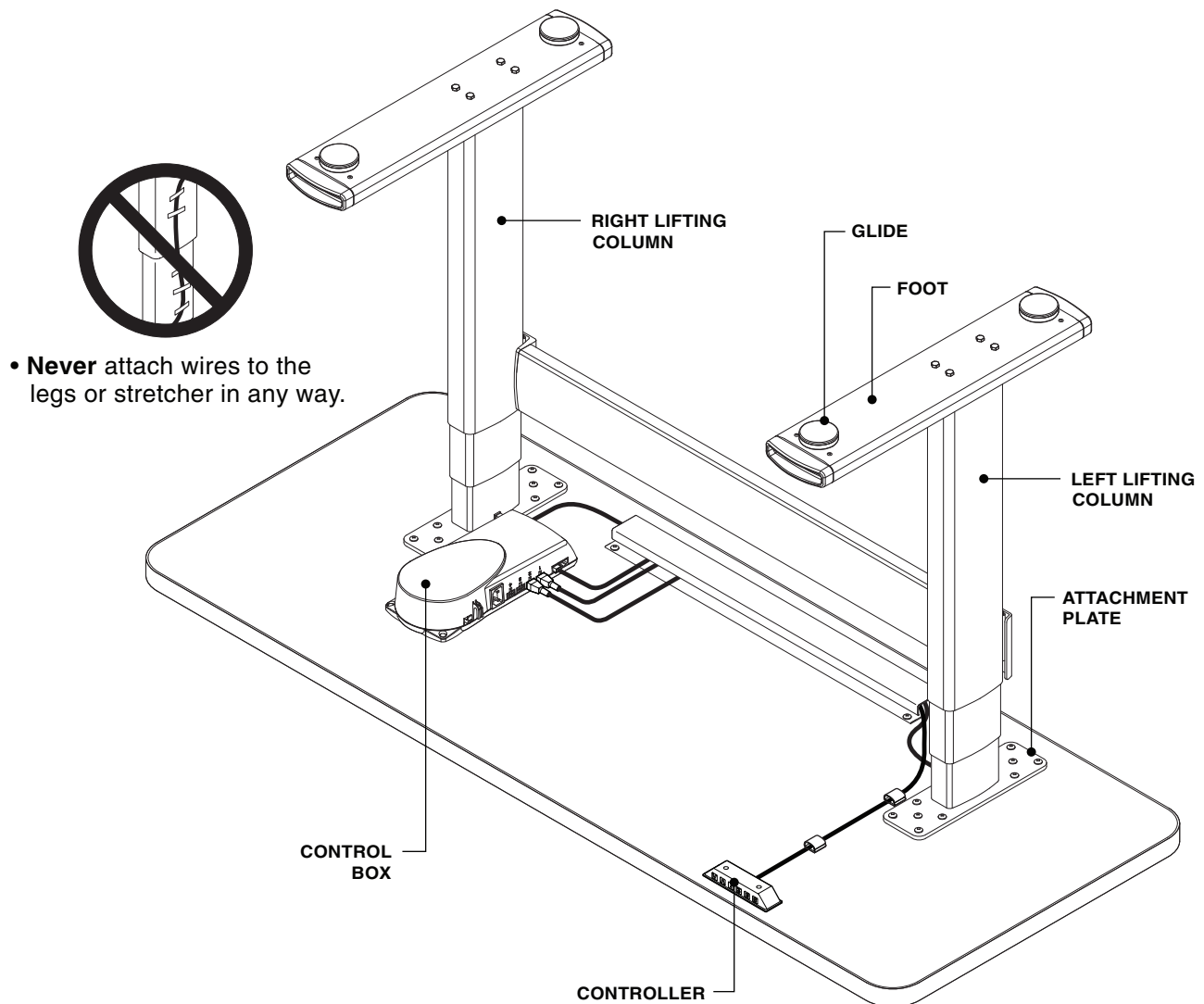

005255D Rev D

Appendix A: 2-Piece Worksurface Assembly

- 1 Position top pieces upside down on the assembly surface and align with wood spline (or biscuits) provided.

Optional Biscuits

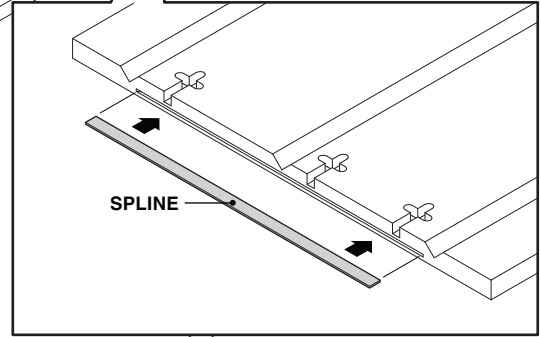
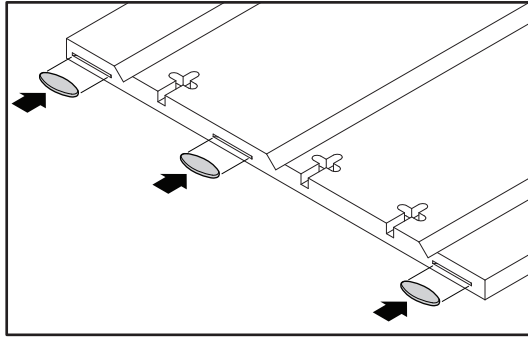

- 2 Install draw bolts and tighten with 5/16" or 7/16" open end wrench. Attach two (2) v-channels using sixteen (16) screws per channel.

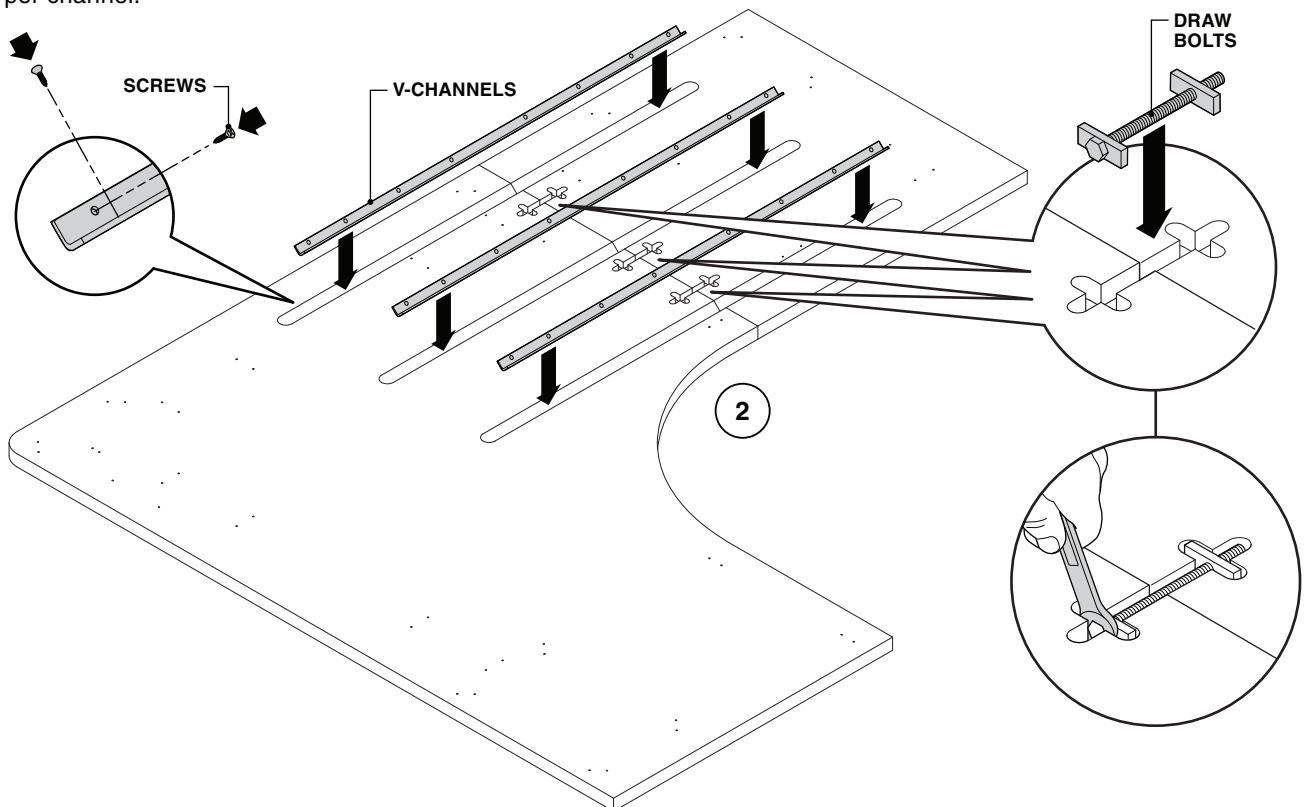

Appendix A: 2-Piece Worksurface Assembly (cont.)

Special Notes on 2-Piece Worksurfaces

Overhangs:

- The extension portion of 2-piece worksurfaces may not completely overhang the supporting leg!
- One leg must always be fully mounted to the extension portion.

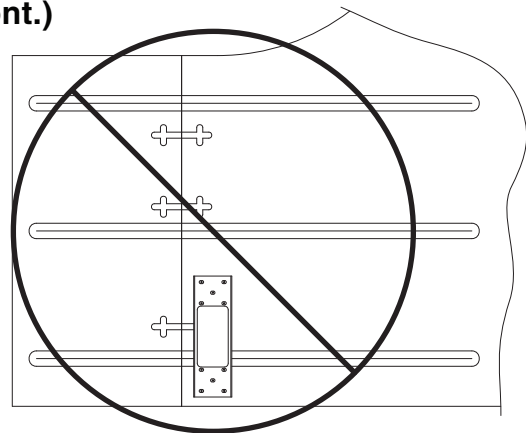

WRONG!
THIS CONDITION
IS NOT ALLOWED!

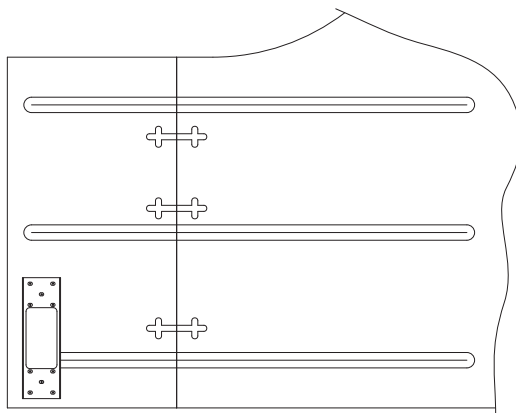

CORRECT!

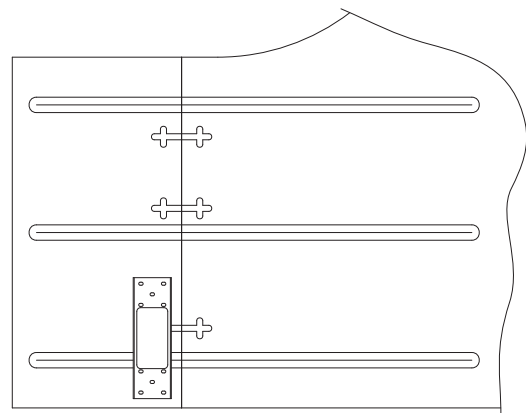

CORRECT!

Planar Alignment:

- The spline or biscuits between the primary and extension portions act to keep the worksurface halves aligned on the top surface.
- If these parts fit loosely, shim them using pieces of paper as shown.

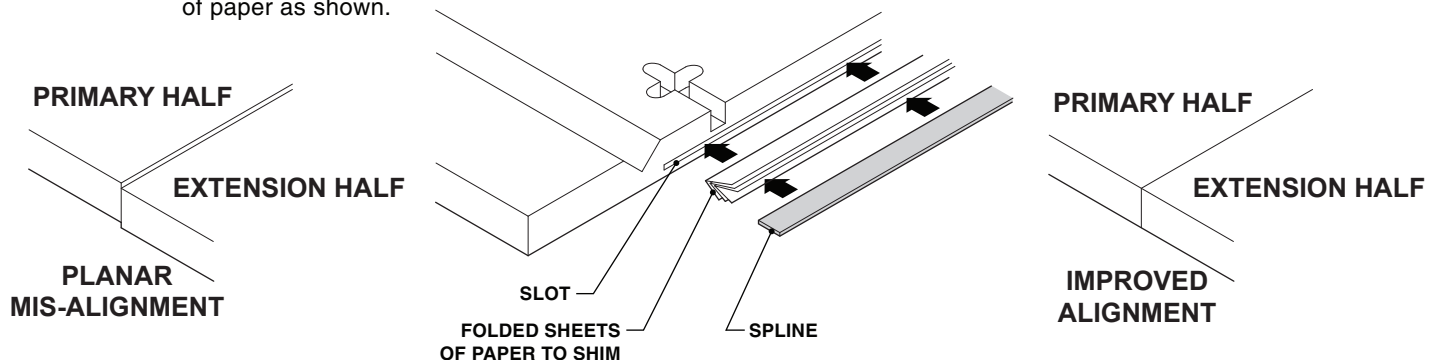

Call 888.783.3522 or visit www.steelcase.com/details

P.O. Box 1967 Grand Rapids, MI 49501-1967

©2013 Steelcase Inc. All rights reserved. 4/13