

Eyesite™ Replacement of an Eyesite Dual Monitor Mount with a Laptop Mount

Installation Instructions 20467301 Rev A

FPCL

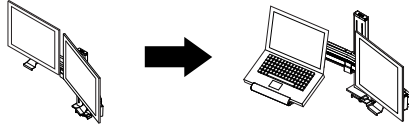

Tools required:

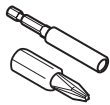

#2 Phillips
Screwdriver



Power Drill



5/32" Allen Wrench
(provided)
1/16" Allen Wrench
(not provided)



5/32"
HEX DRIVE

- 1 With monitor tilted back 90 degrees, remove all necessary cables from monitor. Once all cables are removed from monitor, tilt monitor back to original position.

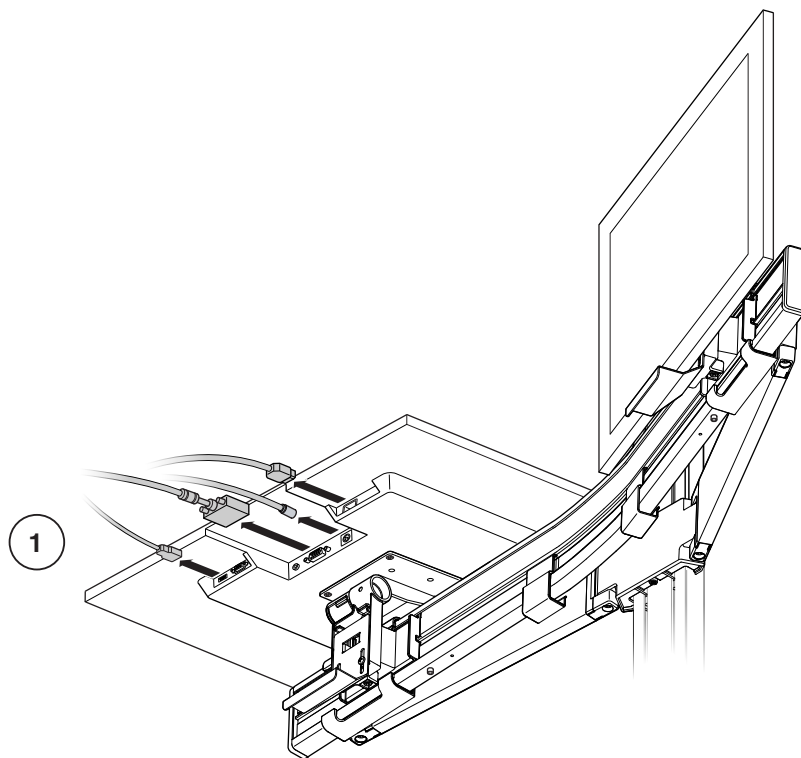

20467301 Rev A

- 2 Open monitor mount bracket assembly cover (2a).

To release monitor mount, you must turn set screw to the left and loosen using a 1/16" Allen wrench (2b).

- 3 Slide monitor mount assembly from monitor mount bracket assembly.

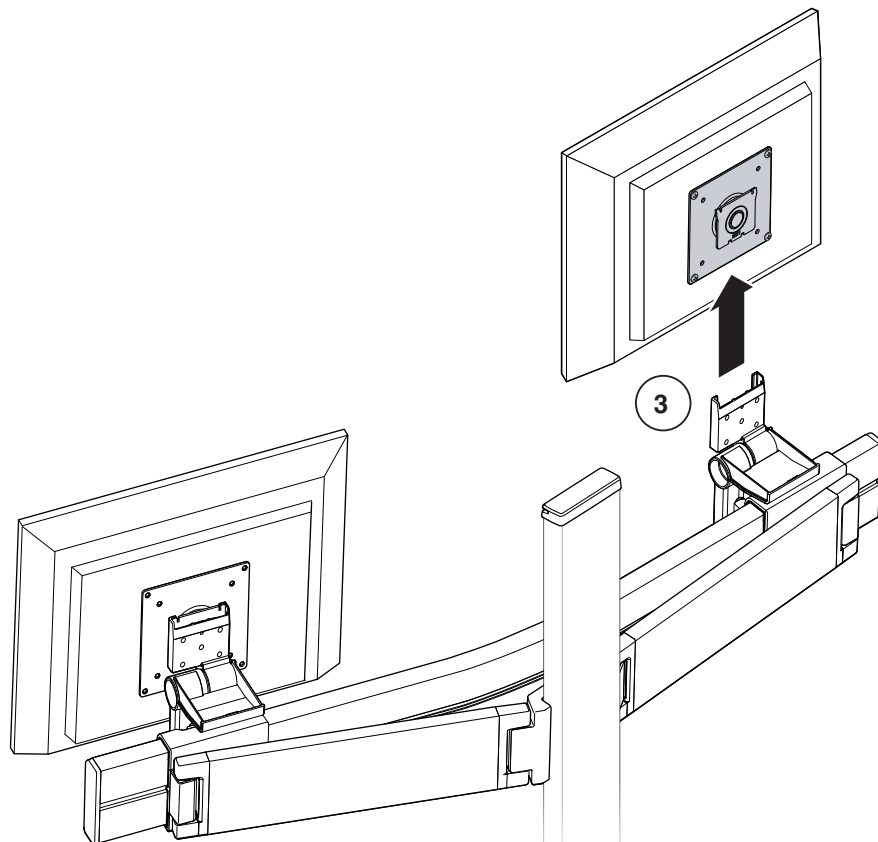
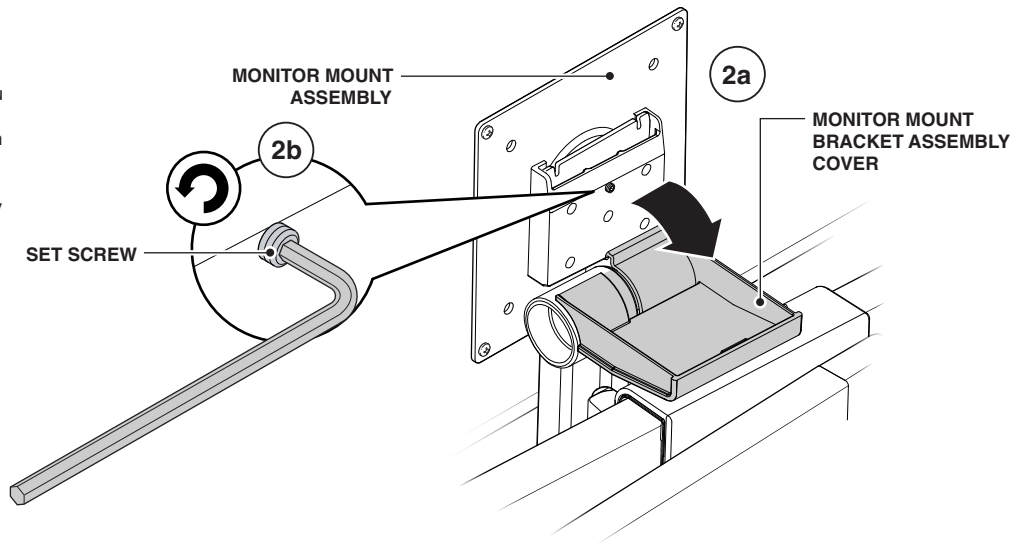

20467301 Rev A

- 4** Remove components as shown (4a) Remove existing monitor mount rail assembly (4b). Slide tray assembly into rail (4c).

Re-install plate, screws and cap (4d). When installing the screws, insert screws oblong holes in plate making sure the screws are against the bottom of the oblong holes instead of the top.

This will ensure that the rectangular tabs on the inside of cap will fit properly into the rail.

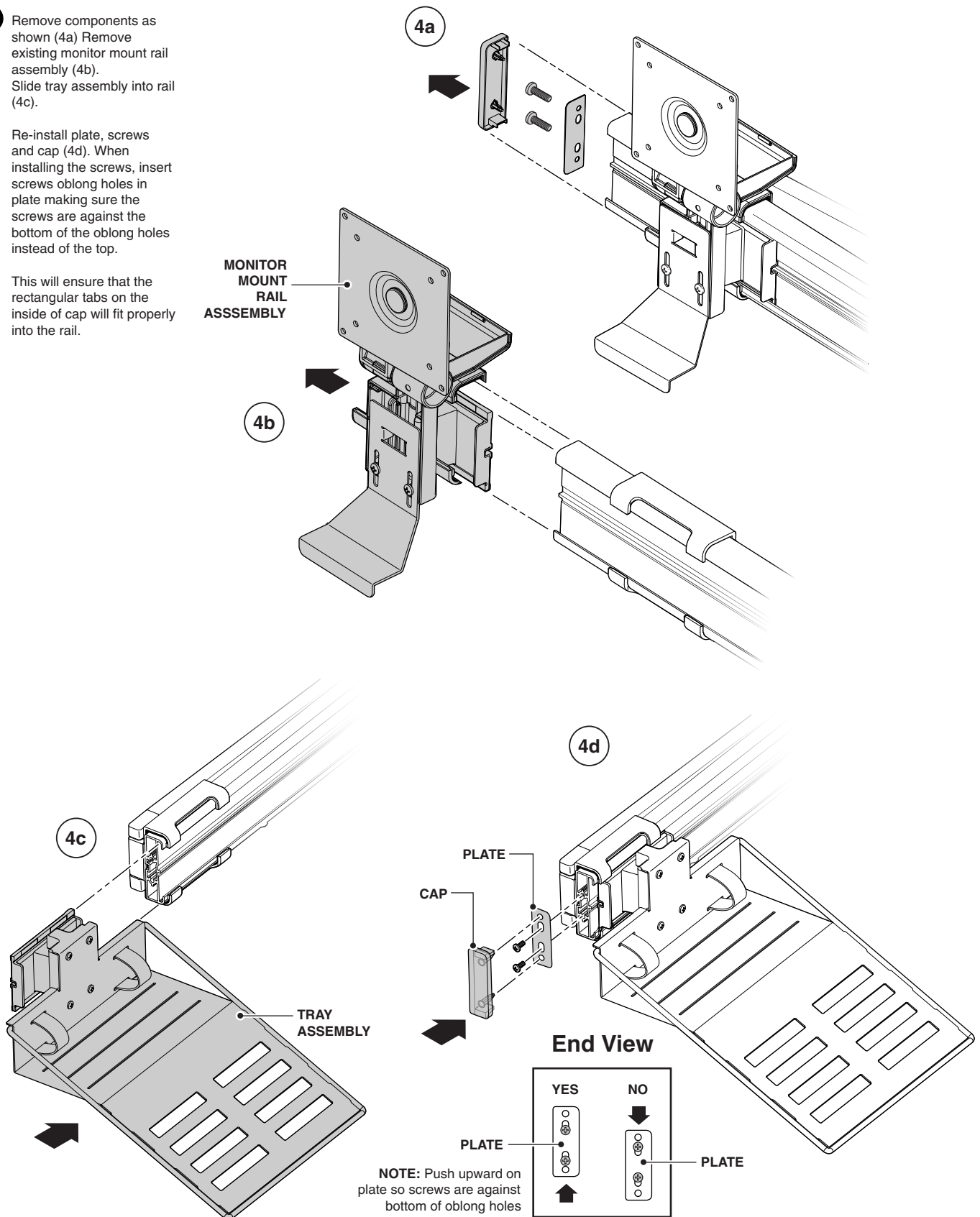

20467301 Rev A

- 5 Place rubber mat onto tray and position accordingly.

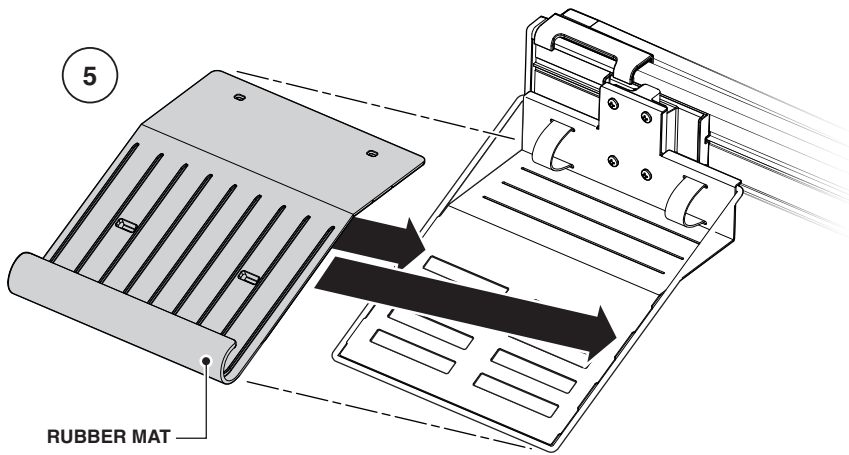

SIDE VIEW

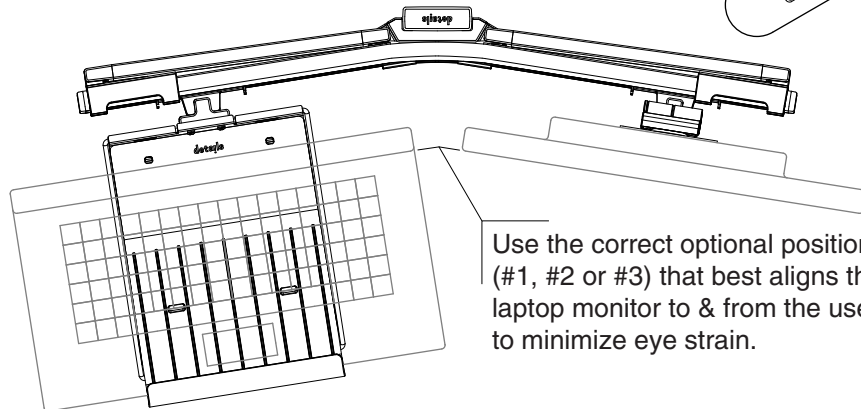
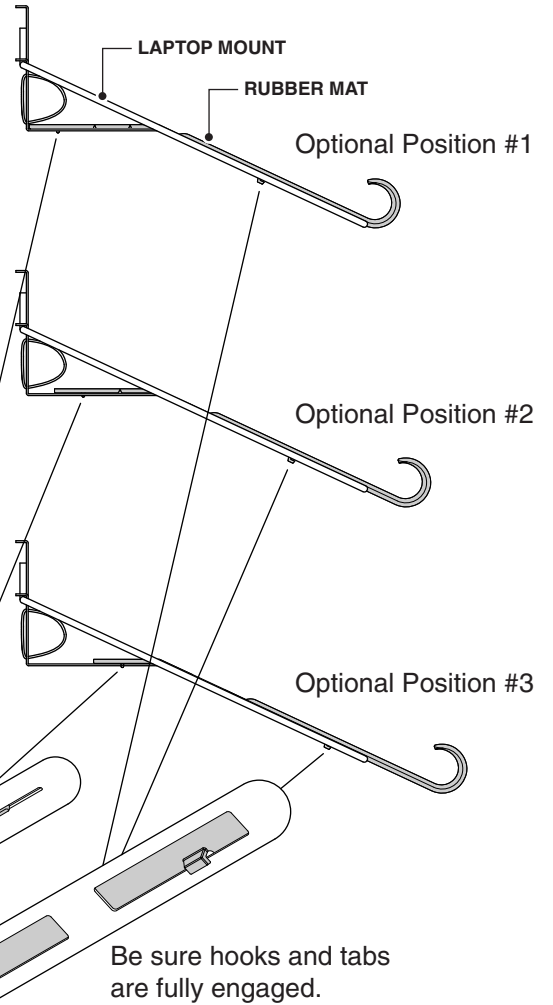

For further information, please go to the Details website details-worktools.com or call 800.833.0411

P.O. Box 1967 / CD-5E Grand Rapids, MI 49501-1967

©2010 Steelcase Inc. All rights reserved. 6/10