

Eyesite™ Bar Attachment

Installation Instructions 23125101 Rev A

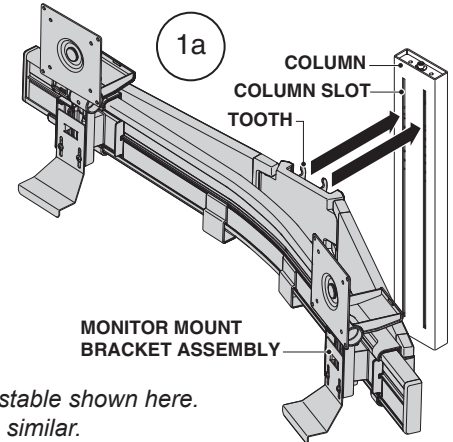

Tools required:

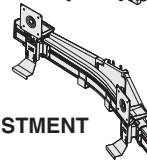

5/32" Allen Wrench
(provided)

Static Bar Mounting, Dual and Triple Non-Focal Adjustment

- 1 Determine in advance where you want to position your monitor.

Align teeth of monitor mount bracket assembly with slots located in the column (1a). Angle the teeth into the slots (1b) and swing monitor mount bracket assembly inward (1c). With teeth engaged in slots, press downward onto the monitor mount rail assembly (1d).

Note: Dual Focal Adjustable shown here. Other applications are similar.

Side Views

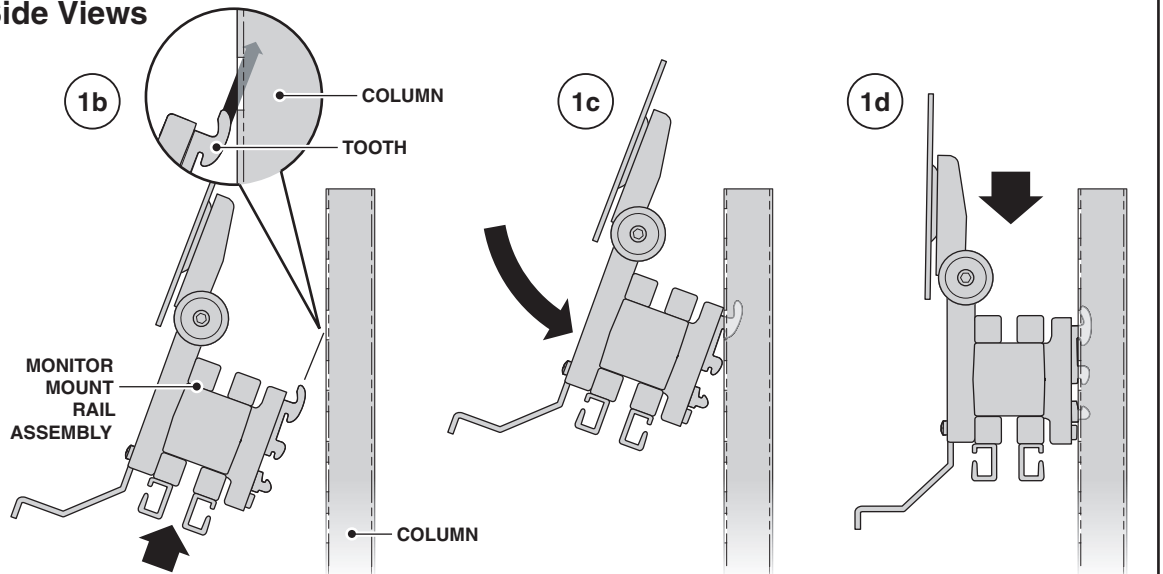

- 2 Locate the locking screw under the monitor mount bracket assembly and tighten using the "ball end" of the supplied Allen wrench (2a). As you tighten the locking screw, the tooth of the monitor mount bracket assembly will begin to move upward inside the column and tighten against the wall of the column locking the monitor mount bracket.

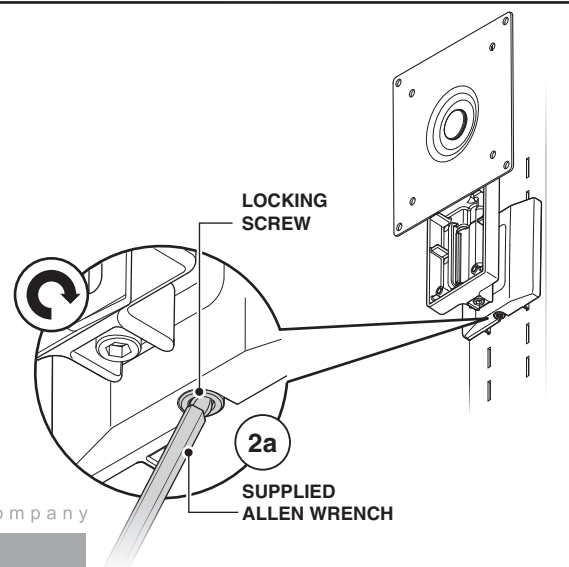

A Steelcase Company

details

23125101 Rev A

- 3** Determine in advance where you want to position your two (or 3) monitors.

Align teeth of monitor mount bracket assembly with slots located in the column (3a). Angle the teeth into the slots (3b) and swing monitor mount bracket assembly inward (3c). With teeth engaged into slots, press downward onto the monitor mount rail assembly (3d).

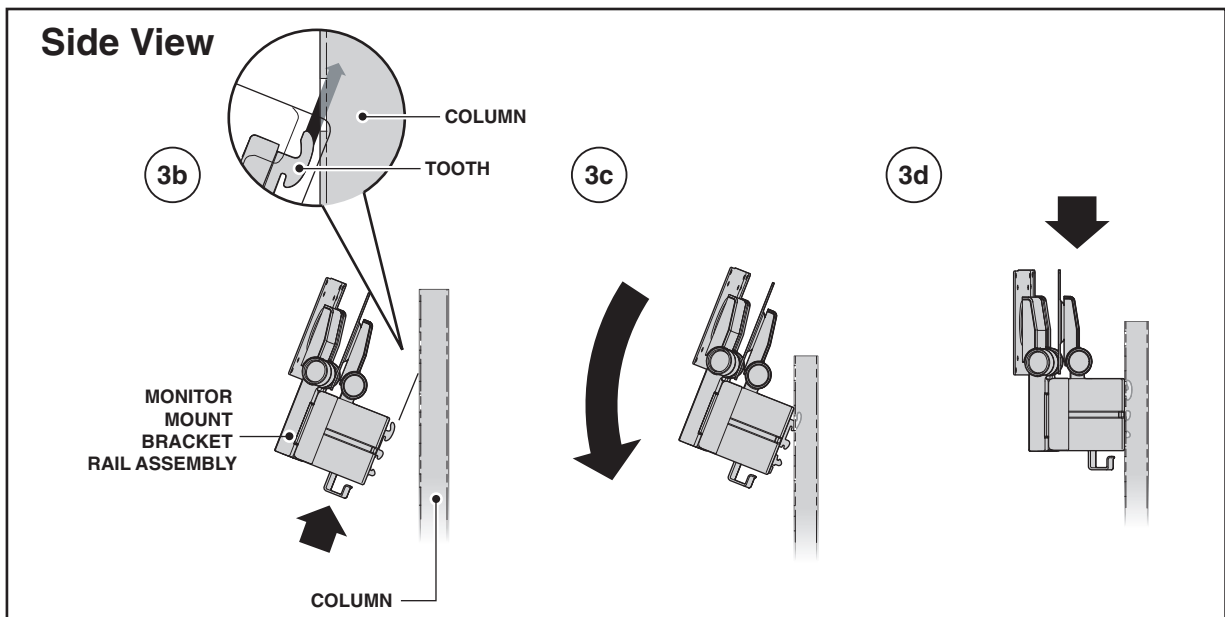
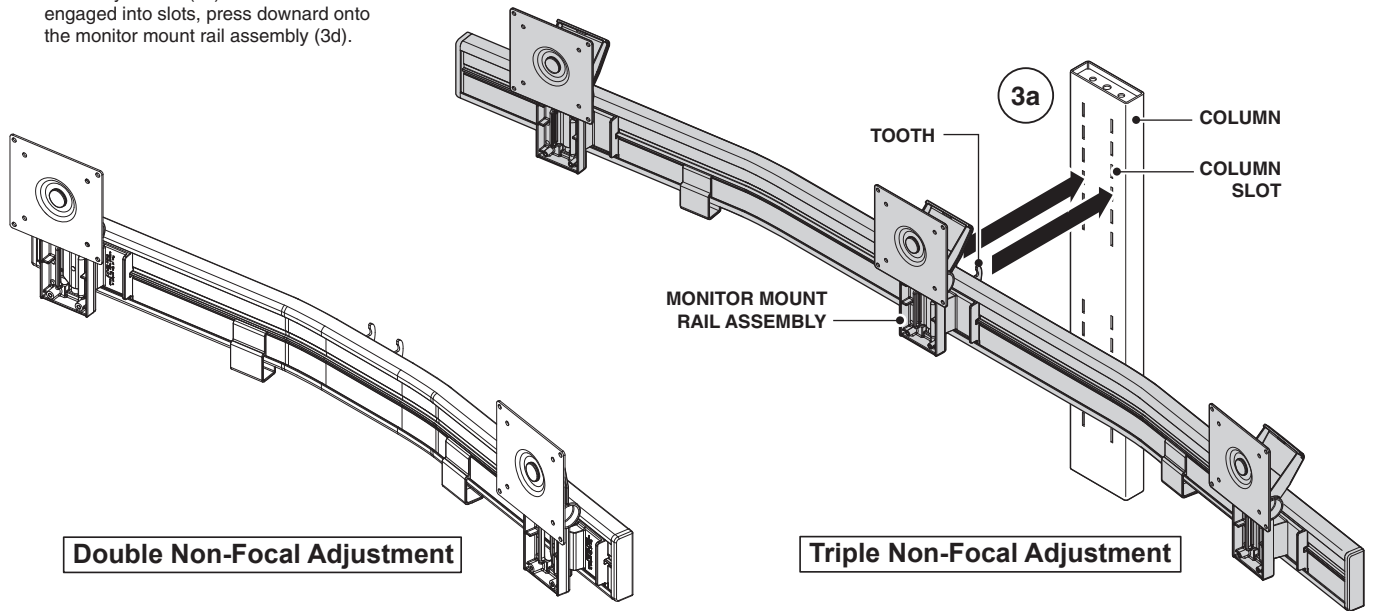

Call 888.783.3522 or visit www.steelcase.com/details

P.O. Box 1967 / CD-5E Grand Rapids, MI 49501-1967

©2013 Steelcase Inc. All rights reserved. 3/13