

#2 PHILLIPS BIT

or

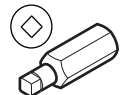

SQUARE DRIVE BIT

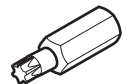

T-20 TORX BIT

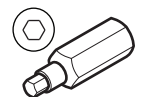

5mm HEX DRIVE BIT

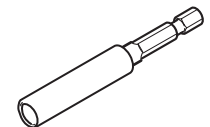

BIT HOLDER

If you have a problem, question, or request, call
your local dealer, or Coalesse at 1.800.627.6770
Or visit our website: www.coalesse.com

© 2016 Coalesse
San Francisco, California U.S.A.
Printed in U.S.A.

TOP PLATE REPLACEMENT:

CAUTION: Table assemblies are heavy. Use assistance when lifting and inverting the table. Do not attempt to lift by the top.

1. Place table, face down, on a clean scratch resistant surface.
2. Remove all eight (8) square drive screws and remove base assembly from table top.
3. Rotate base assembly back to upright and remove five (5) hex drive flat head screws, securing top plate to base assembly. Discard top plate and screws.
4. Orient replacement top plate onto support column with the countersink taper of the mounting holes facing up.
5. Reverse steps 3 - 1 to complete the procedure. Tighten screws to 177 in-lbs (20Nm).

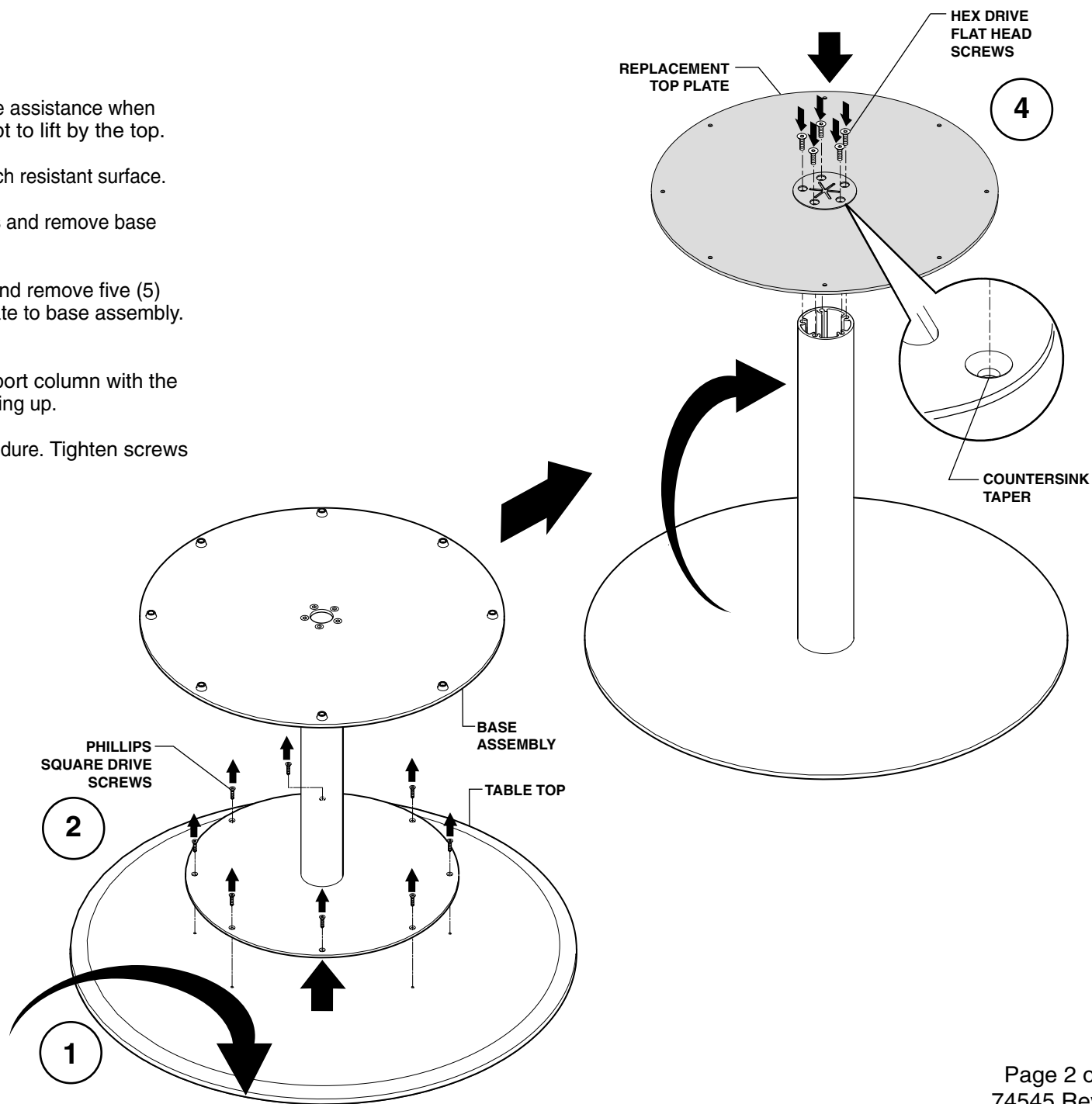

BASE PLATE REPLACEMENT:

CAUTION: Table assemblies are heavy. Use assistance when lifting and inverting the table. Do not attempt to lift by the top.

1. Place table, face down, on a clean scratch resistant surface.
2. Remove and discard all five (5) hex drive flat head screws, securing base plate to column. Discard base plate with glides.
3. Orient replacement base plate onto support column with the countersink taper of the five (5) mounting holes facing up. Install the five (5) supplied hex drive flat head screws and tighten screws to 177 in-lbs (20 Nm).
4. Install the eight (8) supplied glides to the base plate with the T-20 Torx head screws provided. Tighten screws to 44 in-lbs (5Nm).

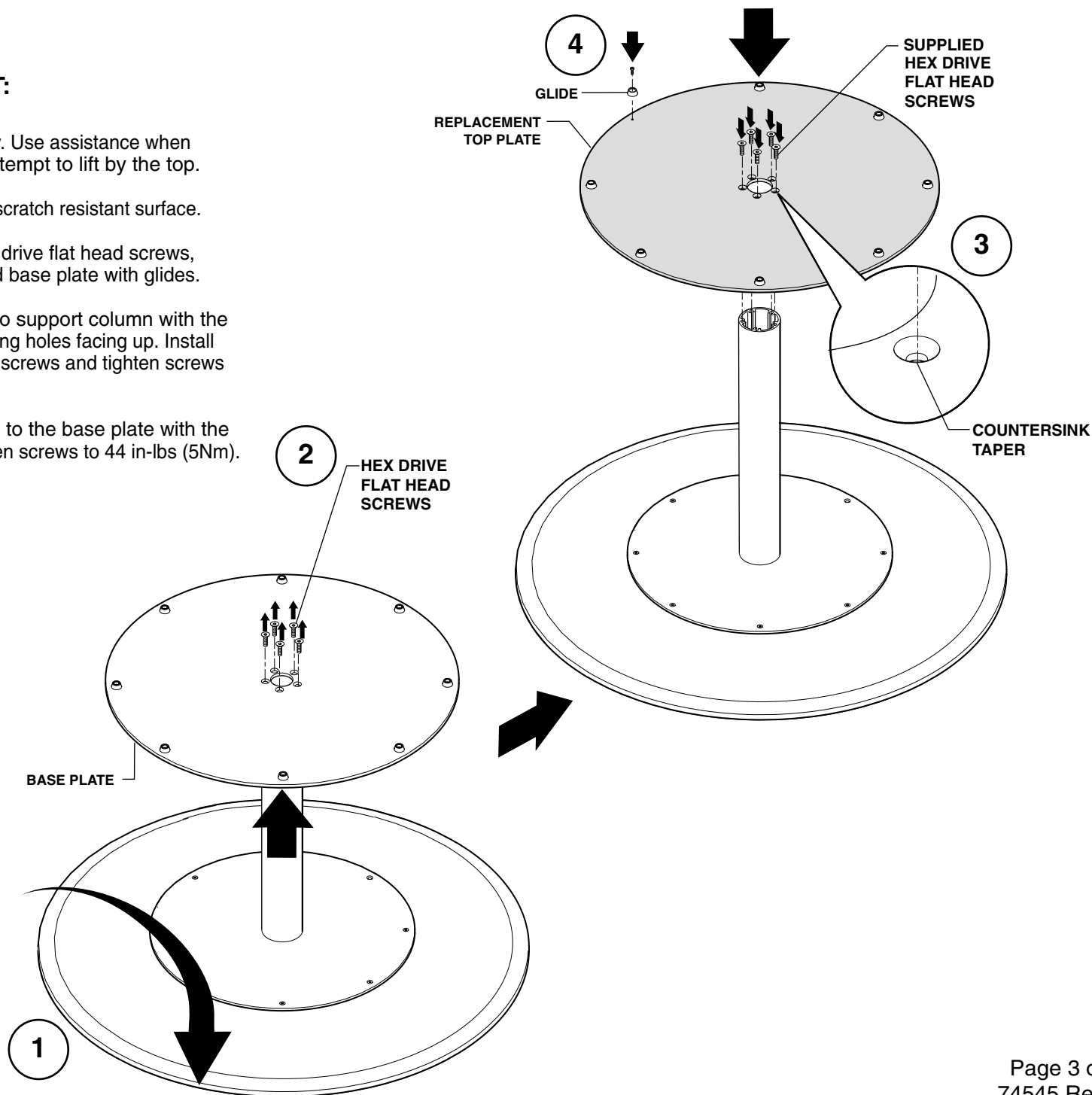

SUPPORT COLUMN REPLACEMENT:

CAUTION: Table assemblies are heavy. Use assistance when lifting and inverting the table. Do not attempt to lift by the top.

1. Place table, face down, on a clean scratch resistant surface.
2. Remove all five (5) hex drive flat head screws, securing base plate to support column. Discard screws and set base plate aside.
3. Remove and save all eight (8) Phillips square drive screws, securing top plate to table top. Remove support column with top plate.
4. Invert support column with top plate. Remove and discard the five (5) hex drive flat head screws securing the top plate. Set top plate aside and discard support column.
5. Install top plate onto support column with the countersink taper of the mounting holes facing away from the support column. install the five (5) supplied hex drive flat head screws.
6. Reverse steps 4 - 1 to complete the procedure. Tighten all (10) hex drive flat head screws to 177 in-lbs (20Nm).

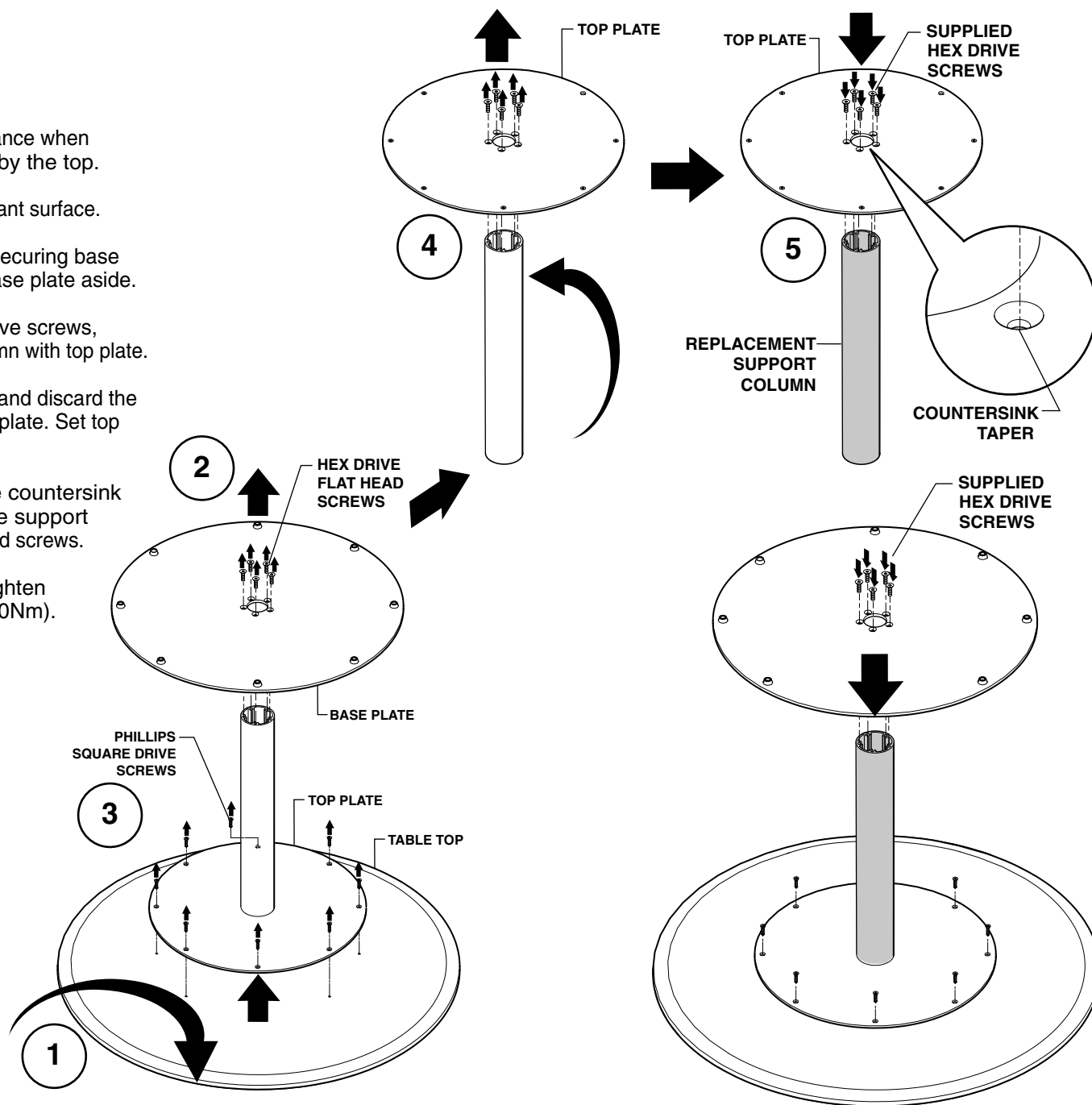

GLIDE REPLACEMENT:

CAUTION: Table assemblies are heavy. Use assistance when lifting and inverting the table. Do not attempt to lift by the top.

1. Place table, face down, on a clean scratch resistant surface.
2. Using T-20 Torx bit, remove screw securing glide to base plate. Discard screw and glide.
3. Install replacement glide onto base plate and secure glide with supplied screw. Tighten screw to 44 in-lbs (5Nm)
4. Repeat steps 2 & 3 as needed.

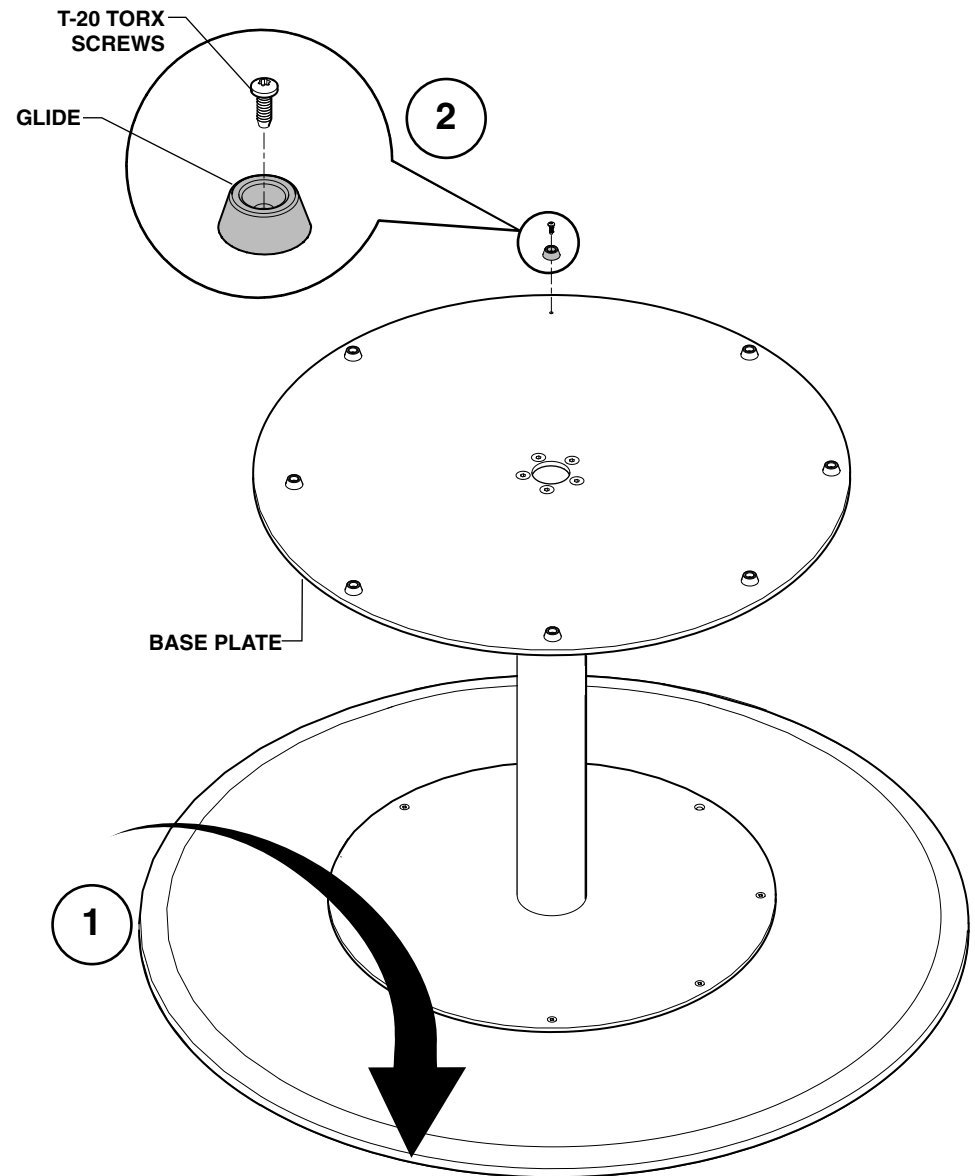

TOP GROMMET REPLACEMENT (ASSEMBLED BASE):

CAUTION: Table assemblies are heavy. Use assistance when lifting and inverting the table. Do not attempt to lift by the top.

1. Place table, face down, on a clean scratch resistant surface.
2. Remove and save all twelve (12) Phillips square drive screws securing base assembly to table top. Rotate base assembly back to upright.
3. Using a utility blade, remove top grommet from top plate. Discard grommet and remove any remaining adhesive with cleaning solution or utility blade.
4. Remove adhesive backing from replacement grommet (4a). Center the replacement grommet over the top plate and apply pressure to adhere grommet properly (4b).
5. Reverse steps 2 - 1 to complete the procedure, making sure to align the base orientation slot with the extra pilot hole to properly align the base to the top.

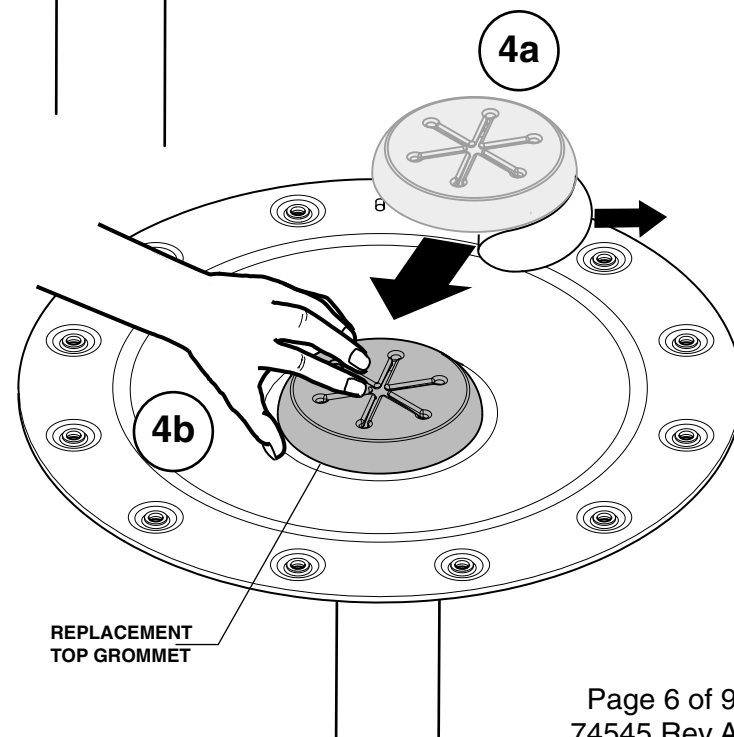
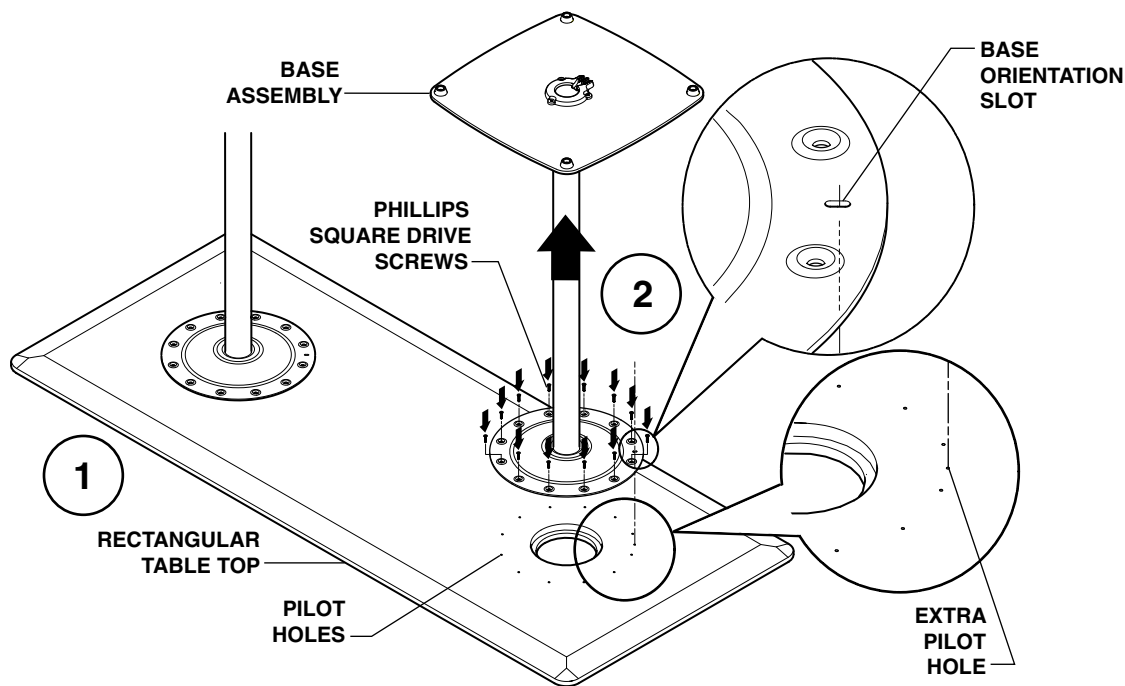
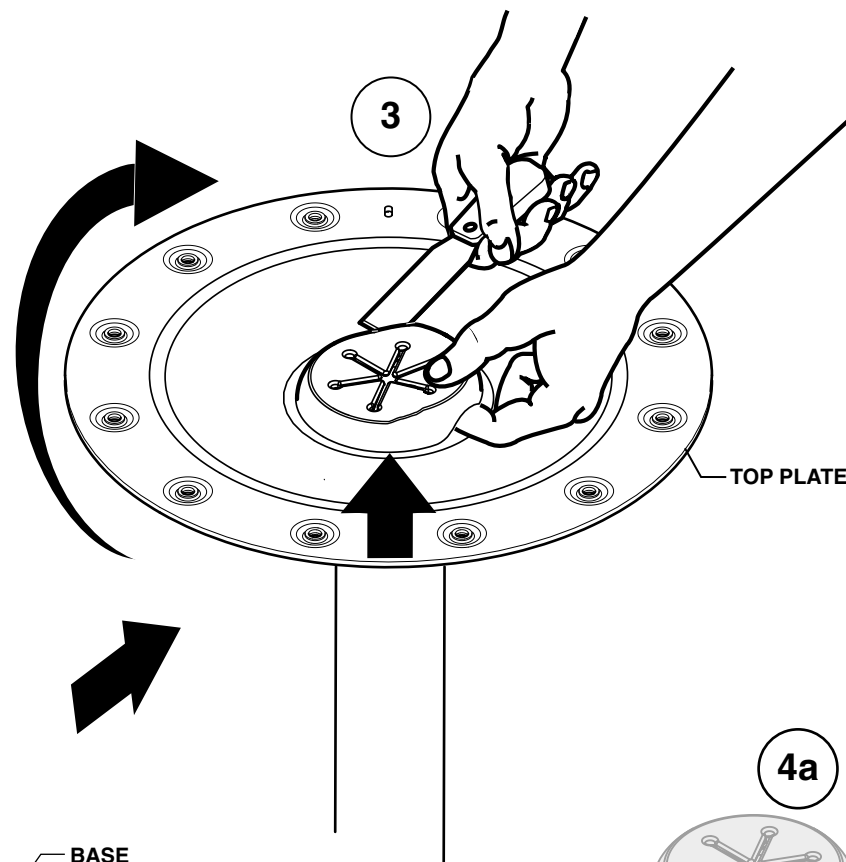

POWER POD GROMMET REPLACEMENT:

1. Remove grommet from grommet collar by rotating grommet counter-clockwise, as shown, approximately 25 degrees. Discard grommet.

2. Install replacement grommet into table top. Engage grommet tabs into grommet collar and rotate grommet clockwise, as shown, until grommet is secured to grommet collar.

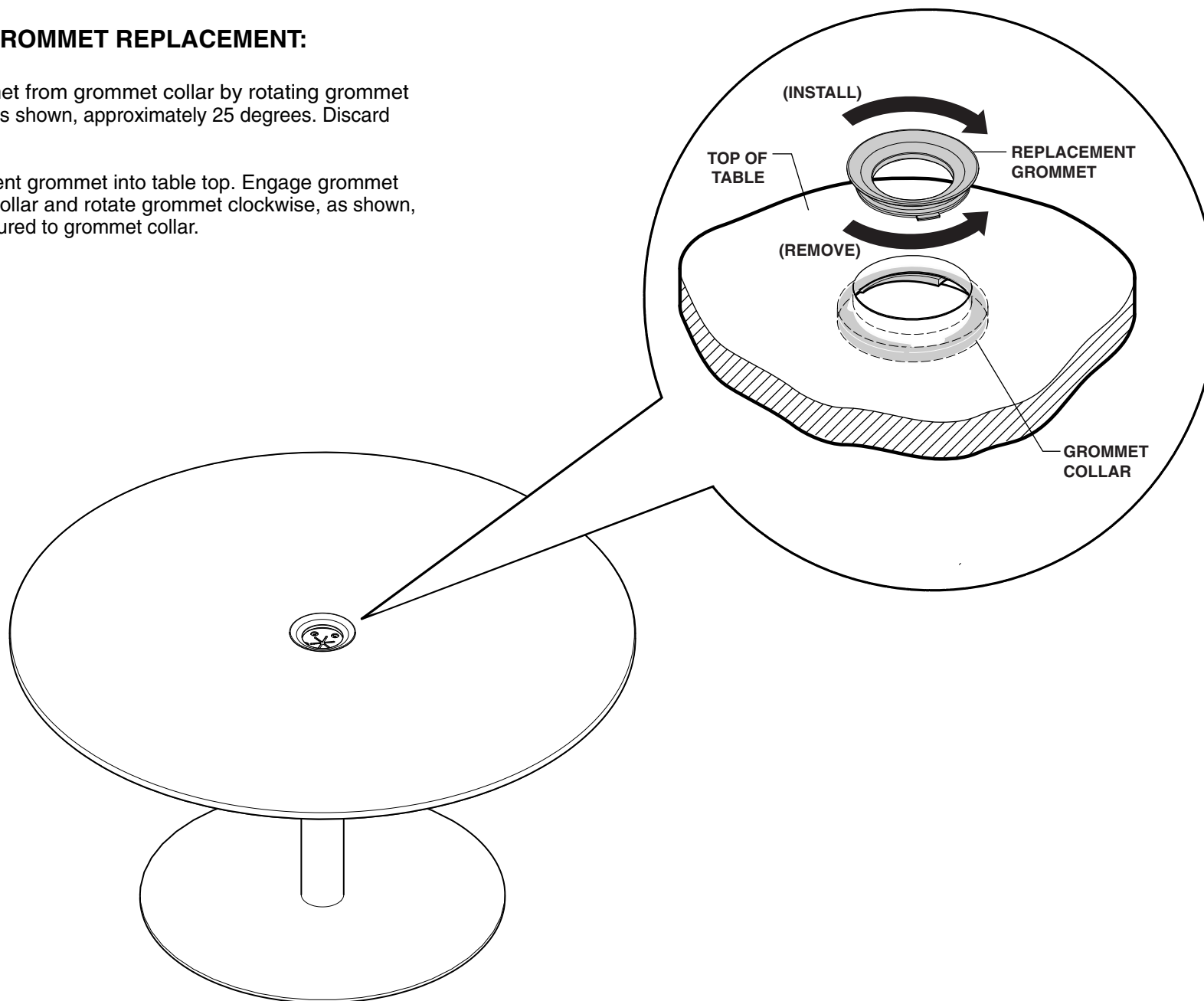

BOTTOM GROMMET REPLACEMENT:

CAUTION: Table assemblies are heavy. Use assistance when lifting and inverting the table. Do not attempt to lift by the top.

- 1.** Place table, face down, on a clean scratch resistant surface. Remove any power cables routed through grommet.
- 2.** Remove the three (3) T-20 Torx screws securing the bottom grommet to the table base plate. Discard grommet and screws.
- 3.** Align replacement bottom grommet over mounting holes and install the three (3) T-20 Torx screws provided. Torque screws to 44 in-lbs (5Nm).
- 4.** Reinstall any power cables, that were previously in place, ensuring proper cable routing through grommet. Return table to upright position.

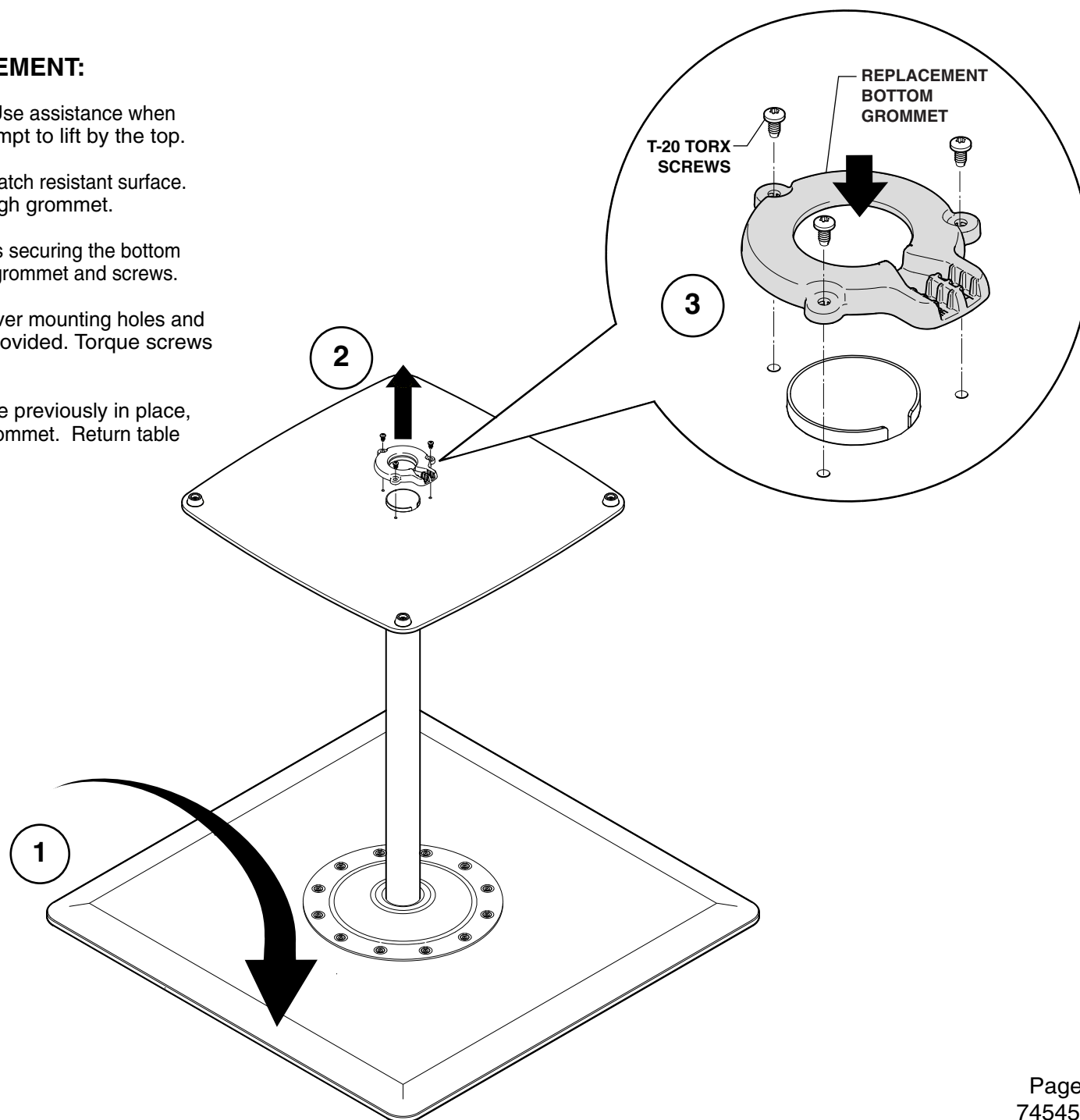

TOP GROMMET REPLACEMENT (KNOCKED DOWN BASE):

1. Using a utility blade, remove top grommet from top plate. Discard grommet and remove any remaining adhesive with cleaning solution or utility blade.

2. Remove adhesive backing from replacement grommet (2a). Orient replacement grommet over the top plate mounting holes and apply pressure to adhere grommet properly (2b).

