

# TS312 Shortcut® Seat Cushion Installation for All Shortcut® Chairs and Stools

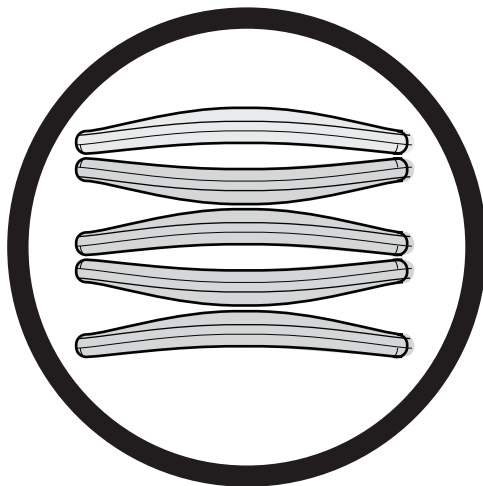

**YES**

**CAUTION**  
If stacking several cushions,  
avoid damaging them by  
stacking plastic to plastic  
and fabric to fabric.  
Do not stack in a  
nested arrangement

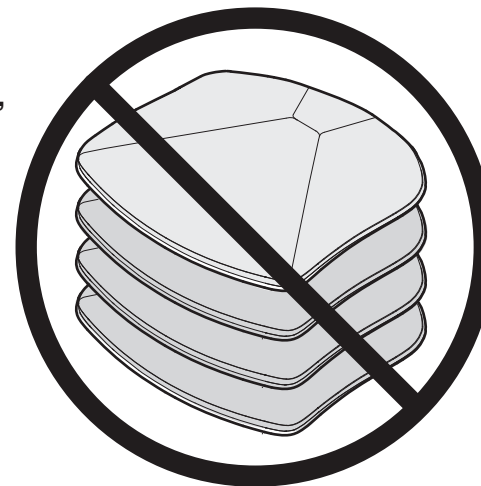

**NO**

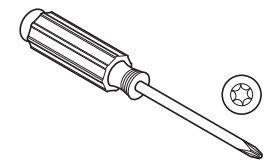
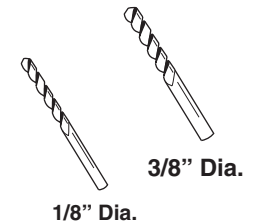
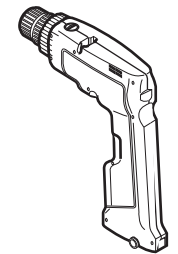

**T-30  
SCREWDRIVER**

**1.** Extend height of chair and place it upside-down on a support surface that will not scratch the shell (such as a desk).

**2.** Drill pilot hole at each pilot point (6X) with an approximately 1/8" drill bit.

**3.** Use a 3/8" bit to enlarge hole to proper diameter.

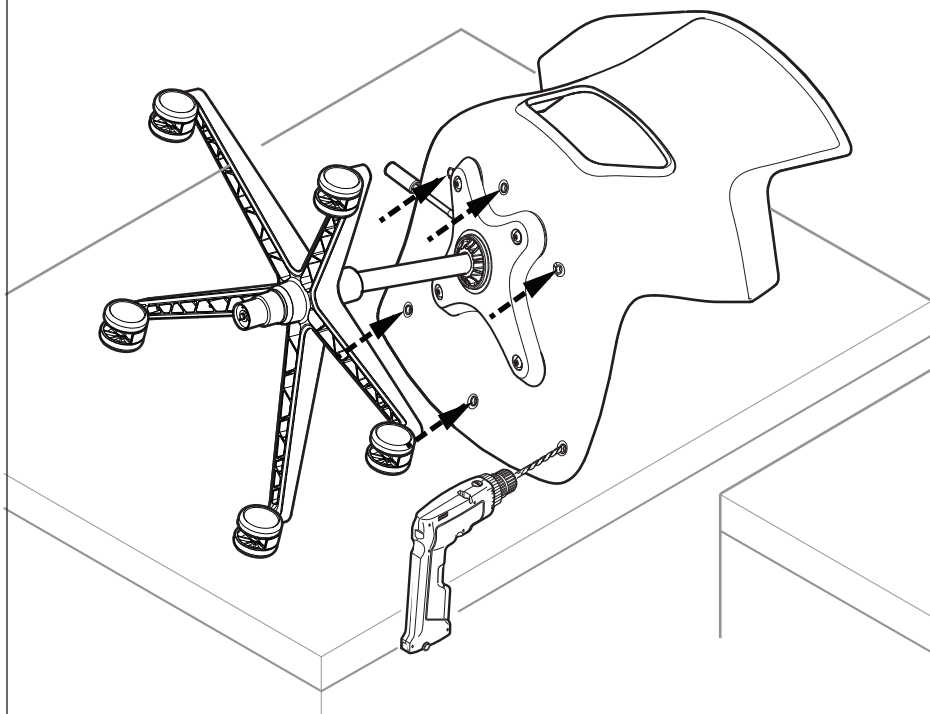

**CAUTION:**  
Do not drill into (or damage)  
your support surface.

**4.** Align cushion to chair shell so that the bosses of the cushion fit inside the holes of the chair shell.

**5.** With a T-30 hand driver, loose secure the cushion in one of the corners.

**6.** Tightly secure (16 in-lbs) a screw in the opposite corner. If power drill is used, do not have your drive in "drill" mode.

**7.** Secure all other screws, including the loose screw from Step 5.

**8.** Return chair to upright position on floor.

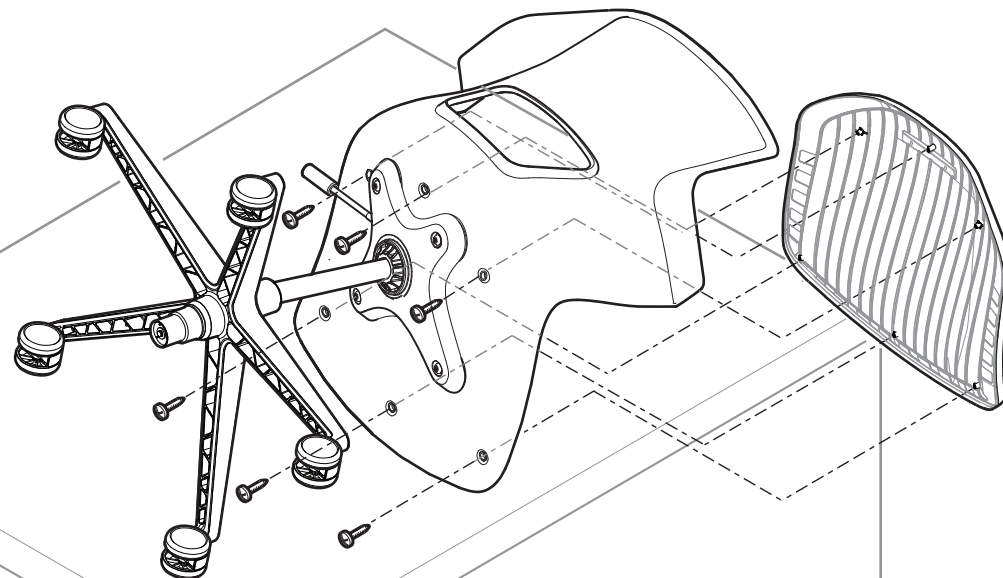

**CAUTION:**  
Torque screws to 16 in-lbs. Hand  
driver recommended. If power driver  
is used, do not use "drill" mode.