

T-30 Torx Bit with  
Extension

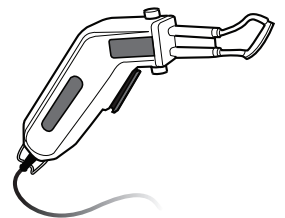

Hot Knife

If you have a problem, question, or request, call  
your local dealer, or Coalesse at 1.800.627.6770  
Or visit our website: [www.coalesse.com](http://www.coalesse.com)

© 2016 Coalesse  
San Francisco, California U.S.A.  
Printed in U.S.A.

## FABRIC SCREEN GANGING CLIP INSTALLATION

(The instructions on this page only apply if your unit has upholstered screens. If your unit has mesh screens, please continue to page 3)

**WARNING:** Ganging units using the screen ganging clip will require creating a hole in the upholstery. This hole is only visible if the units are separated.

**NOTE:** The screen ganging clip can only be used if the adjoining screens are the same height.

1. Locate the end of the unit you wish to gang.
2. Measure down from the top of the screen and place a mark on the welt cord at 4 inches.
3. Using pliers, carefully grab the welt cord and pull it slightly out of the channel.
4. Using a hot knife, carefully melt the welt cord at the line you've marked in step 2. **BE CAREFUL NOT TO CUT THE FABRIC ON THE SCREEN!** After cutting the welt cord, you should see a hole in the screen. Trim a 1/2 inch from the welt cord, making sure the hole will be accessible when the welt cord is tucked back into the channel. **NOTE:** If the hole in the screen is covered by fabric, trim the fabric away with scissors, so it doesn't prevent the ganging clip from functioning properly.
5. Install the screen ganging clip (with the overlapping joint on top) until a 'click' is heard and ensure the clip can't be pulled out from the screen.

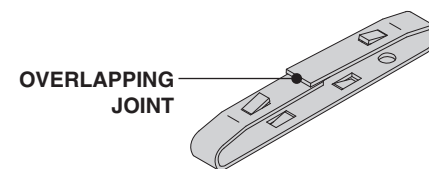
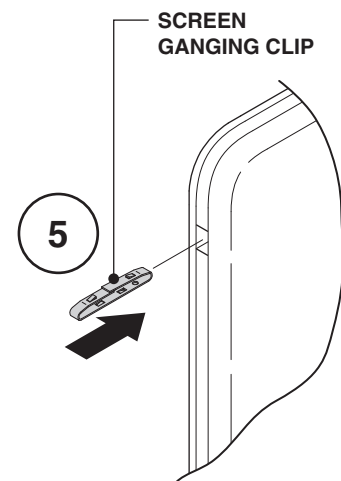
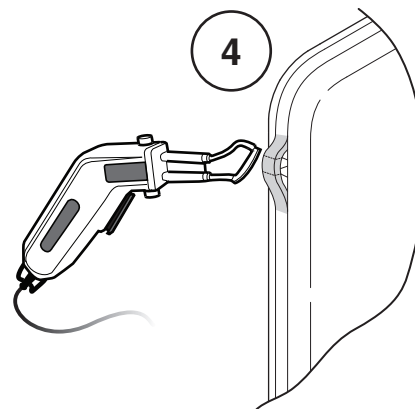
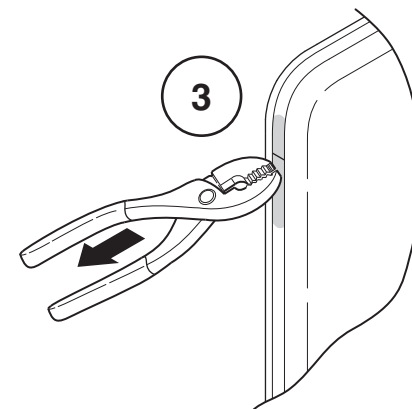
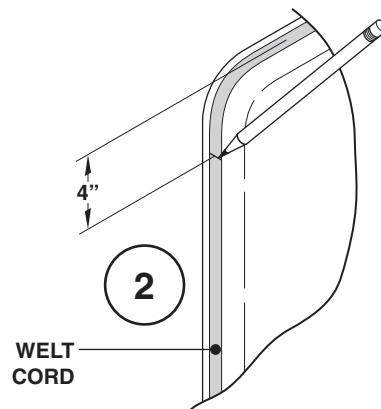

## MESH SCREEN GANGING CLIP INSTALLATION:

**WARNING:** Ganging units using the screen ganging clip will require creating a hole in the upholstery. This hole is only visible if the units are separated.

**NOTE:** The screen ganging clip can only be used if the adjoining screens are the same height.

**1.** Determine assembled configuration of your screens to confirm where screen ganging clips must be applied. Locate the hole in the frame on the side of the screen (approximately 4 inches down from the top) by pressing your finger along the seam (you will feel the indentation). Place a mark on the fabric mesh at the hole location. Repeat at all points where ganging clips must be used.

**2.** Using a hot knife, carefully melt the mesh approximately 1/2" long. A small hole will now be visible in the knit /mesh material. Repeat at all points where ganging clips will be used.

**3.** Install screen ganging clips (with the overlapping joint on top) until a 'click' is heard. Pull on the clip to ensure the clip is engaged in the screen frame and can't be pulled out from the screen.

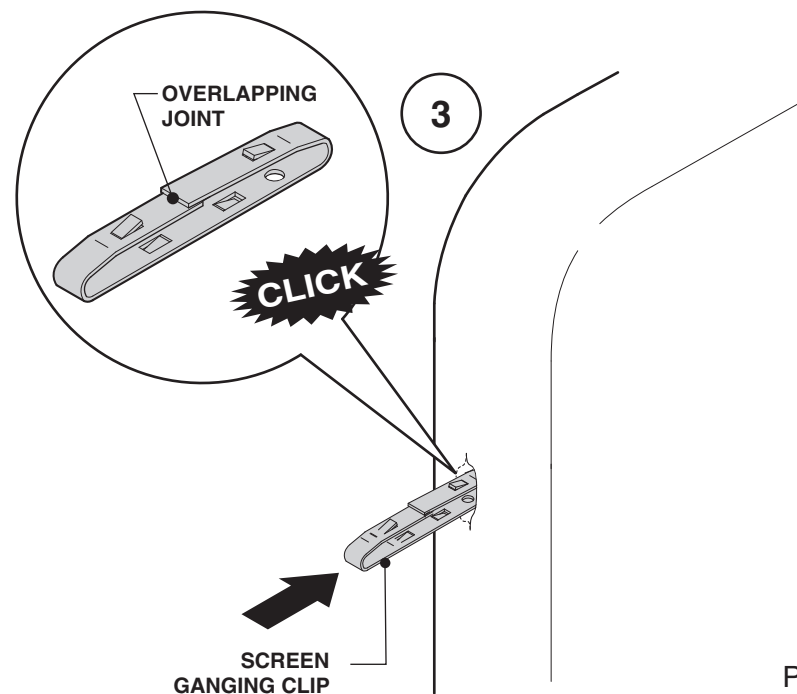
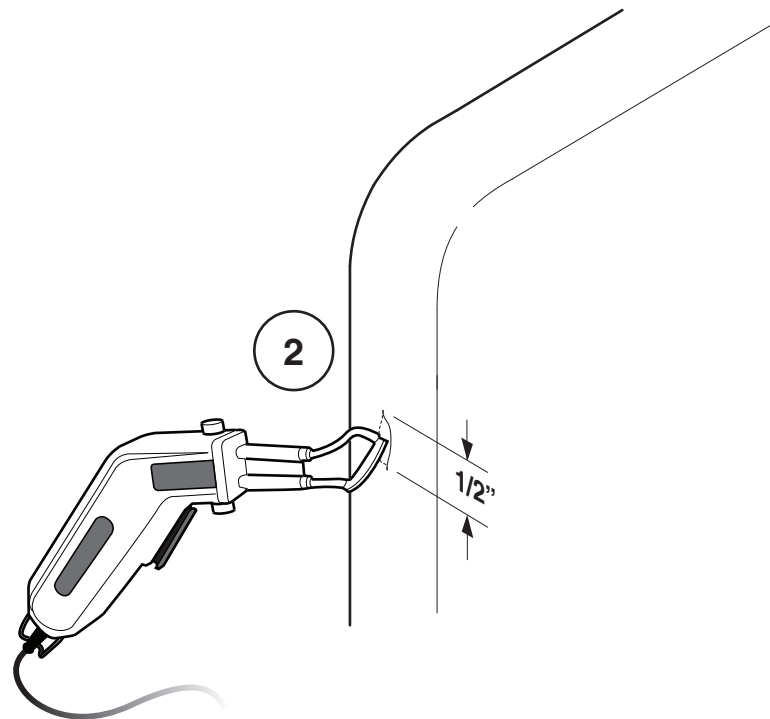
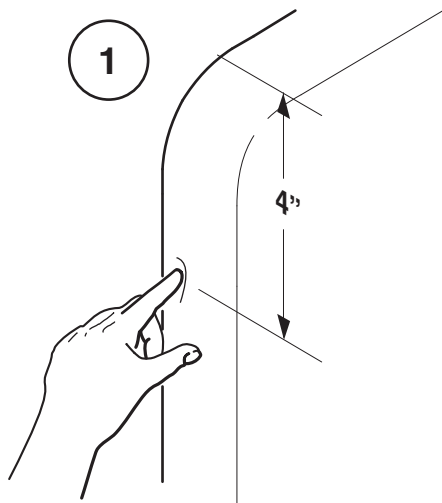

## MESH AND FABRIC SCREEN BOTTOM GANGING BRACKET INSTALLATION AND GANGING:

**WARNING:** To avoid damage to product it is recommended that two (2) persons, minimum, are present to safely complete this installation.

**NOTE:** This procedure outlines connecting two lounge units using the booth screen **COLAGLBS**, resulting in an enclosed booth screen application. Complete lounge units are not shown to allow for a detailed view.

**1.** Mark a line on bottom 4 inches from side of screen. Pull out the welt cord and using a hot knife, melt the welt cord to reveal the screw hole.

**2.** On the center screen, remove both panel glides. Place a bottom ganging bracket over one of the glide mounting holes, as shown. Install one (1) supplied screw and reinstall one (1) glide to attach the bottom ganging bracket to the bottom of the screen. Repeat for the opposite side of the screen.

**3.** Place center screen, with all ganging hardware installed, upright onto a pallet or suitable supporting object. Remove glide from adjoining screen. Engage one (1) adjoining screen onto screen ganging clip in center screen, until an audible click is heard (3a). Reinstall glide to secure adjoining screen to bottom ganging bracket on center screen (3b).

**NOTE:** Ensure that all screen ganging clips are engaged and all screens are aligned and supported until all ganging connections are complete.

**4.** Repeat step 1 to install remaining adjoining screen.

**5.** Remove assembled screens from supports and adjust all glides.

