

### ⚠ 注意 CAUTION



压倒受伤的危险! **CRUSH HAZARD!**

如果柜子不正确安装固定, 可导致人身伤亡。  
**FAILURE TO PROPERLY SECURE CABINET  
COULD RESULT IN PERSONAL INJURY**

安装前请仔细阅读安装说明书。

**Read the entire assembly direction before beginning installation.**

建筑结构复杂多变。具备资质的建筑工程师需对固定柜子的墙面设计承担责任, 必须在固定柜子前确认核实安装配件是否充足, 即便配件是由Steelcase提供。

Building construction varies greatly. The Building's Engineer of Record is responsible for the design of building walls which the cabinets are attached to and must verify the adequacy of the mounting hardware, even if provided by Steelcase.

建筑物的拥有人或指定的管理者须负责该产品的安装符合国家和地方法律法规的规定。

The building owner or designated agent is responsible for verifying that the installation is in compliance with all local codes and regulations.

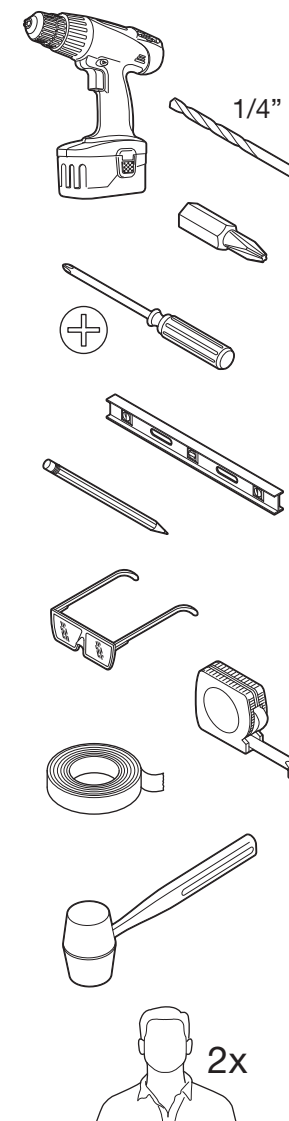

W900

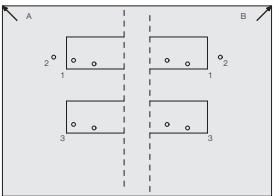
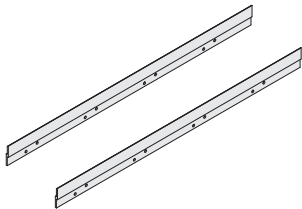
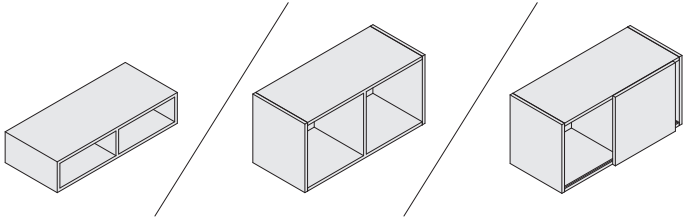

200H

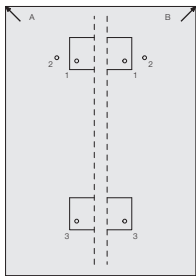

445H

W1800

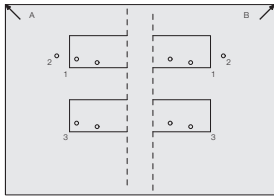
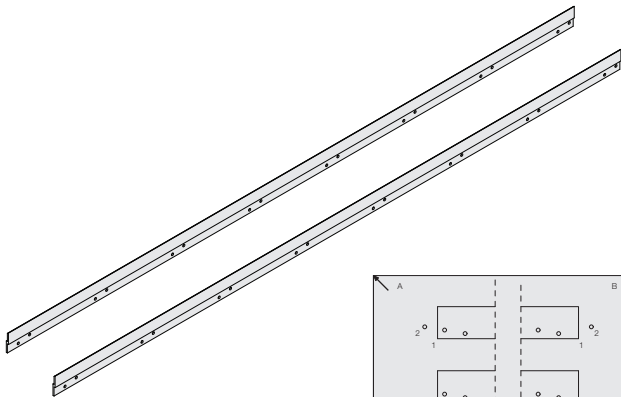
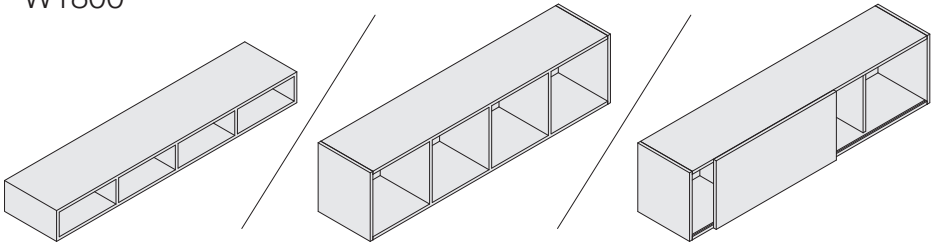

200H

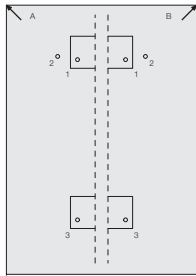

445H

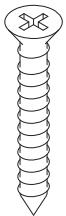

18x

Ø5 x 40mm



2x



18x

NOT PROVIDED

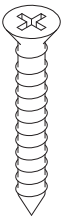

30x

Ø5 x 40mm



2x



30x

NOT PROVIDED

1

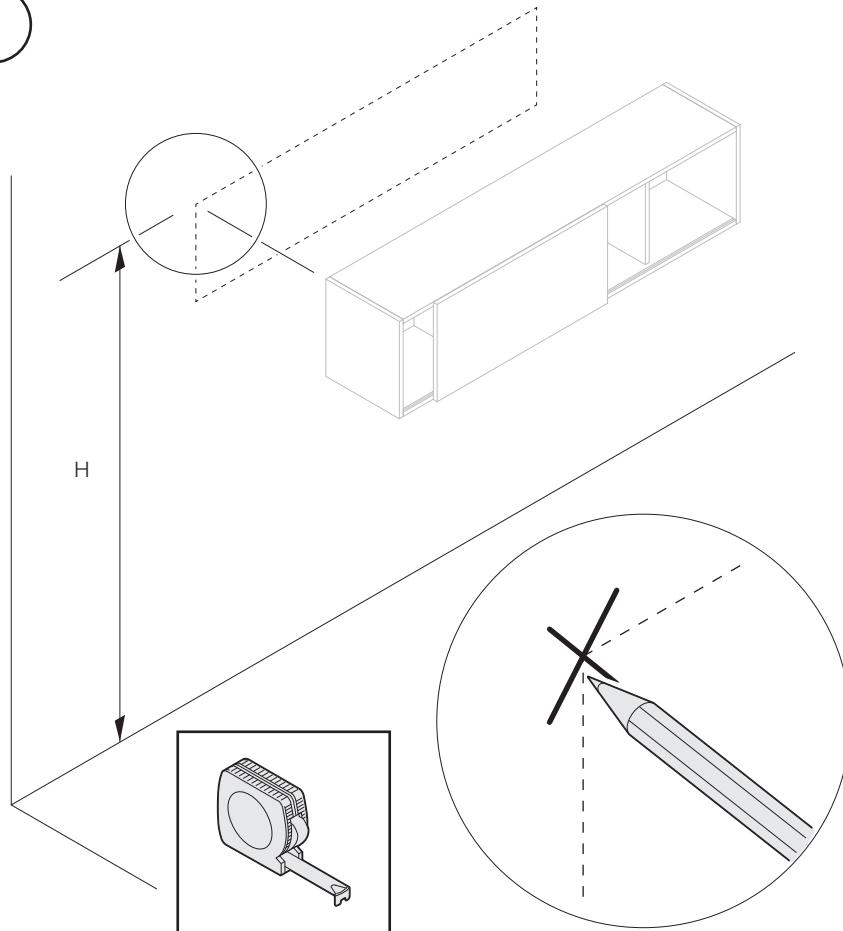

2

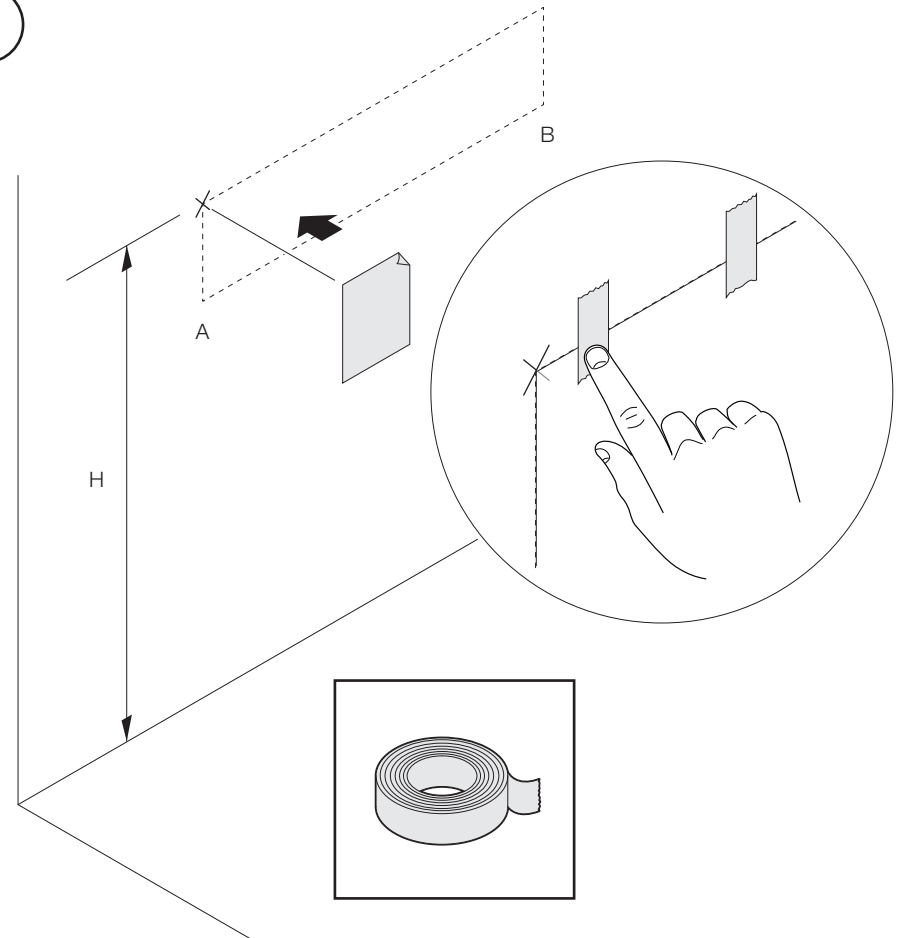

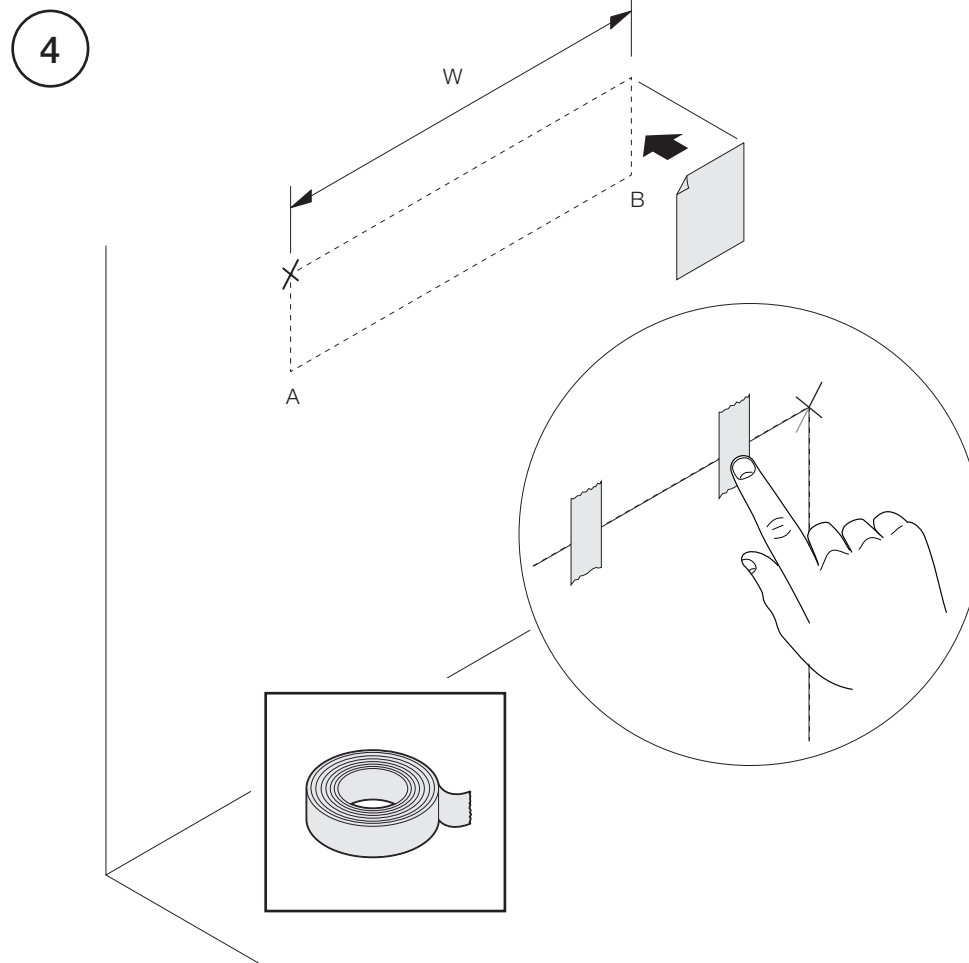

5

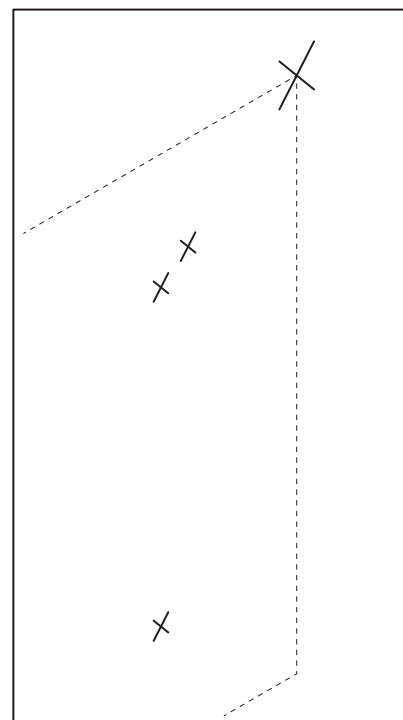
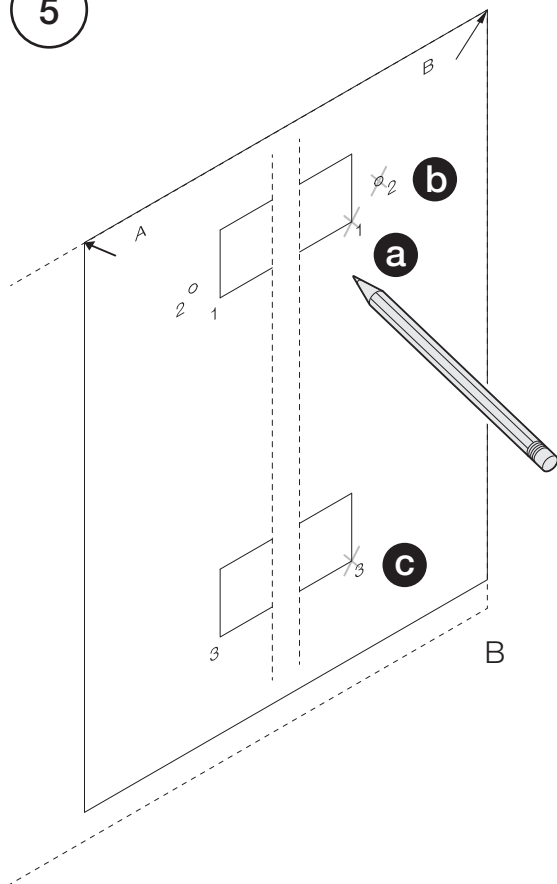

B

6

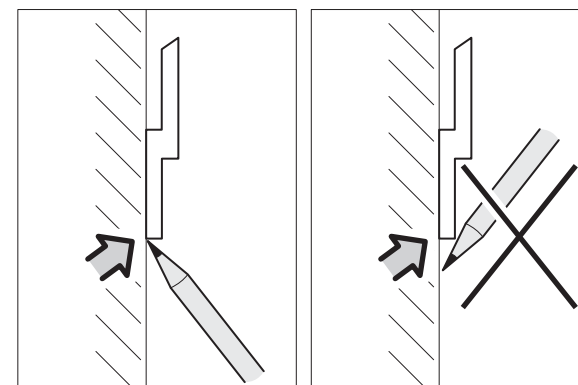
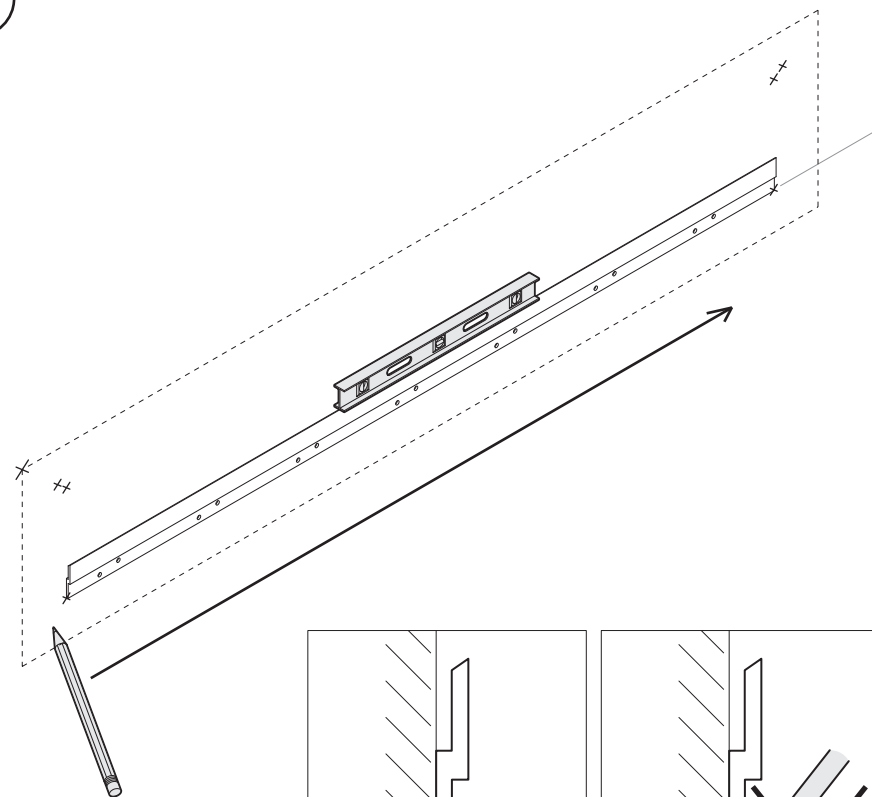

7

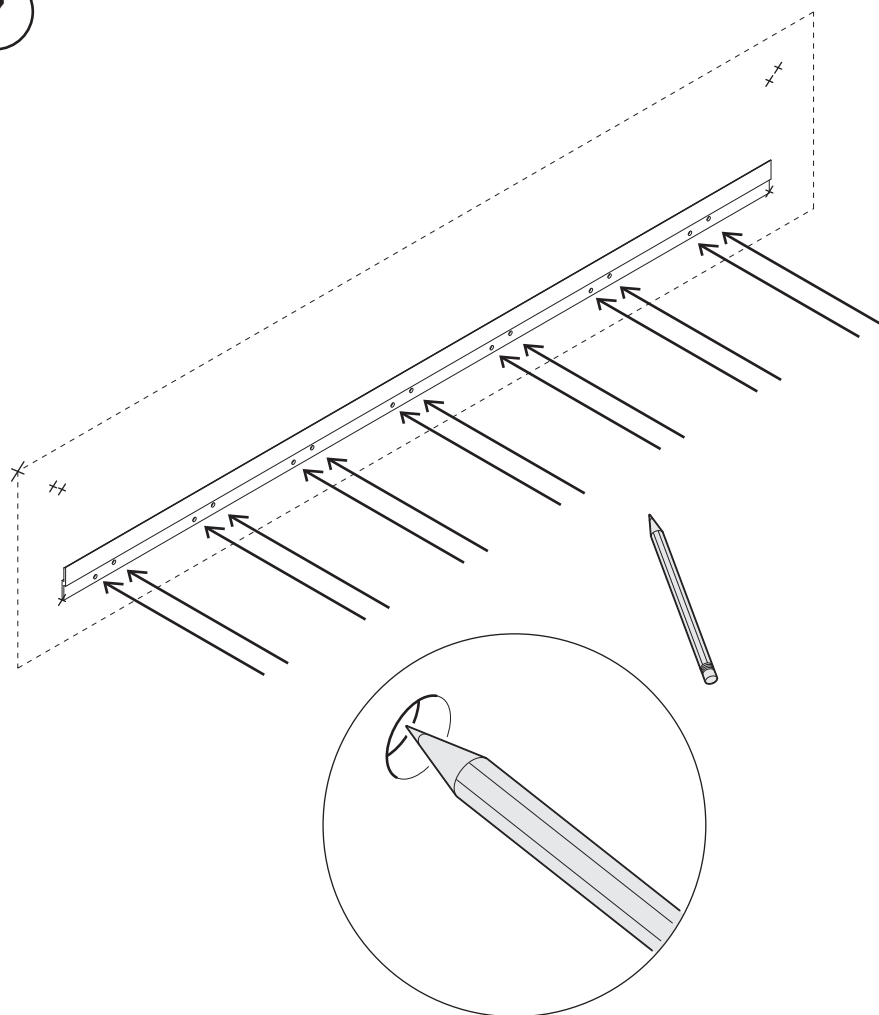

8

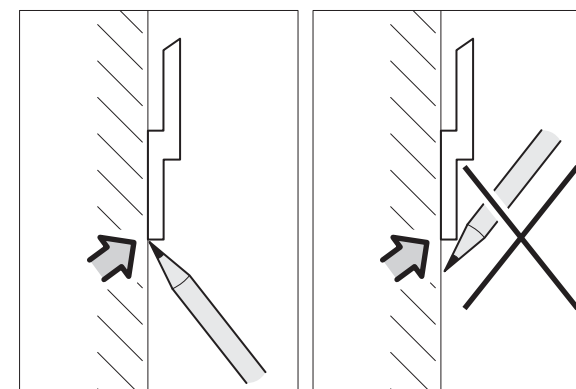
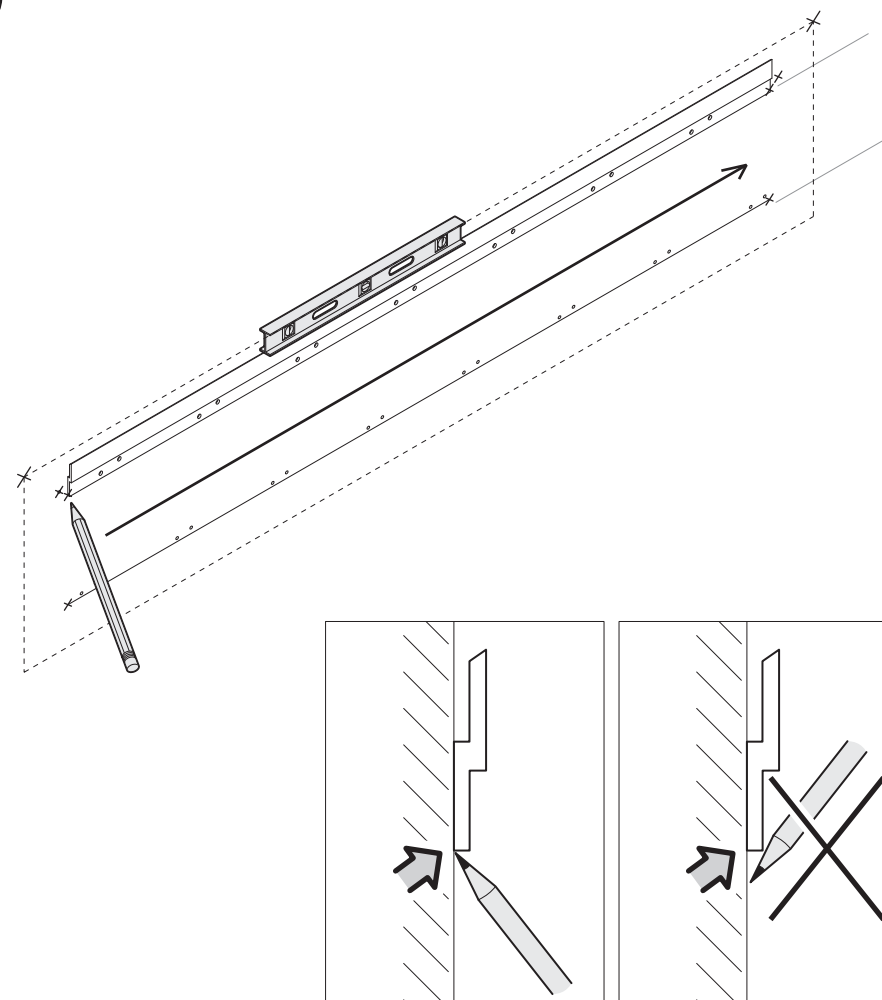

9

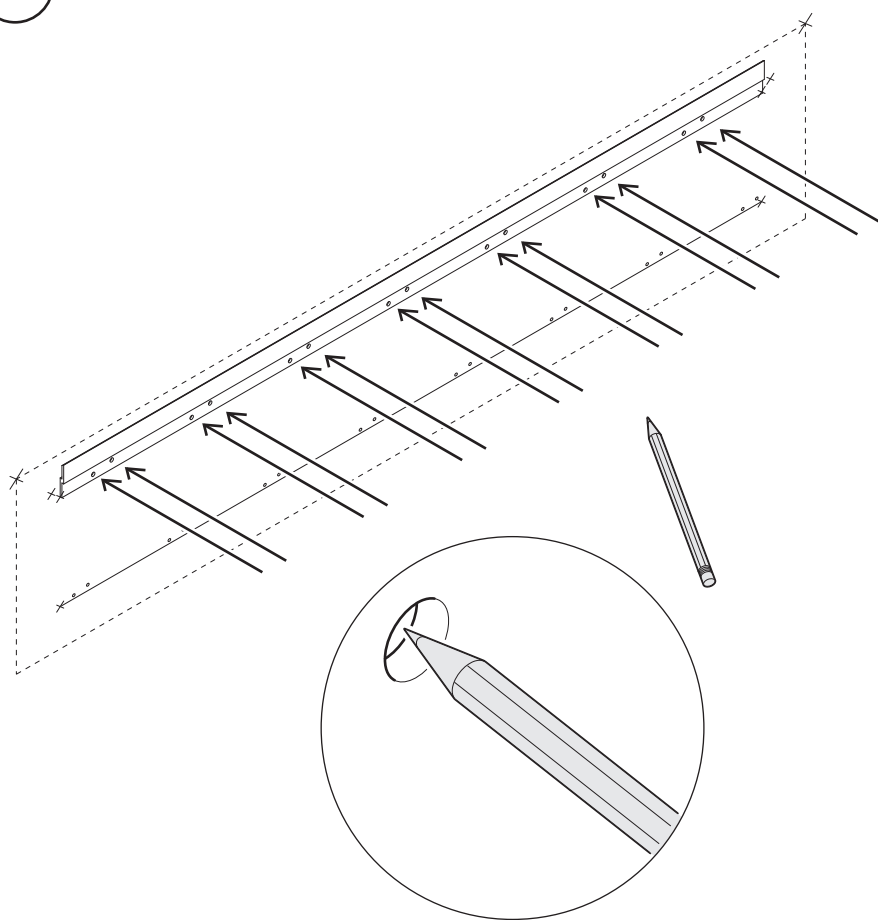

10

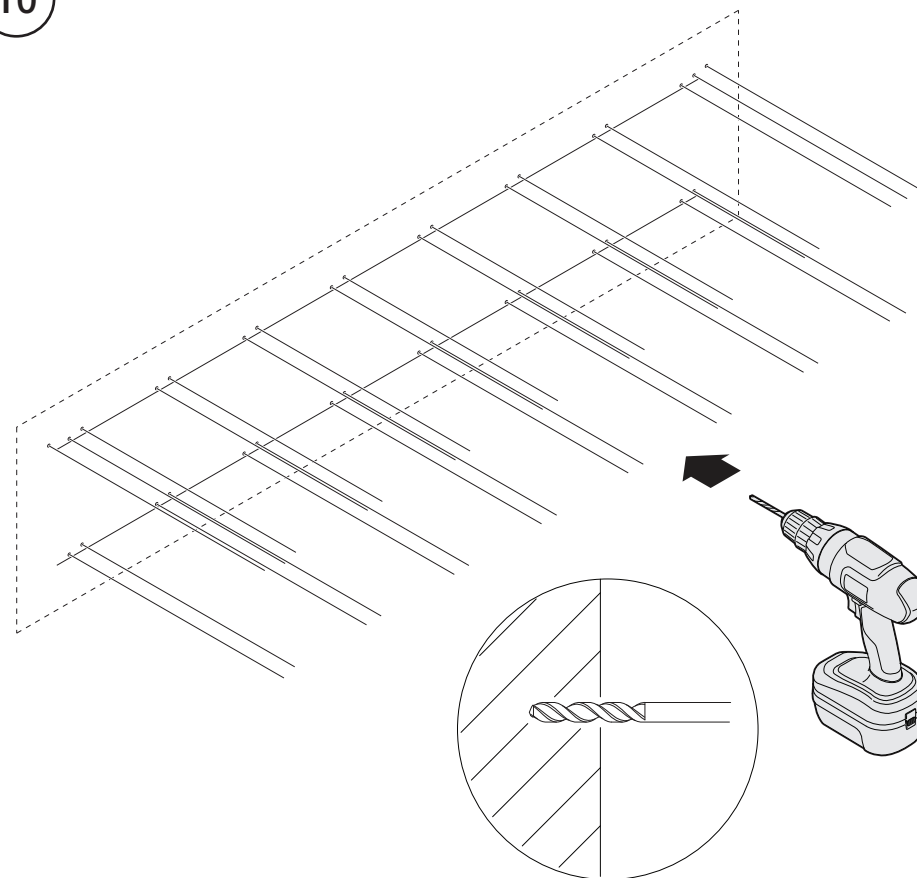

11

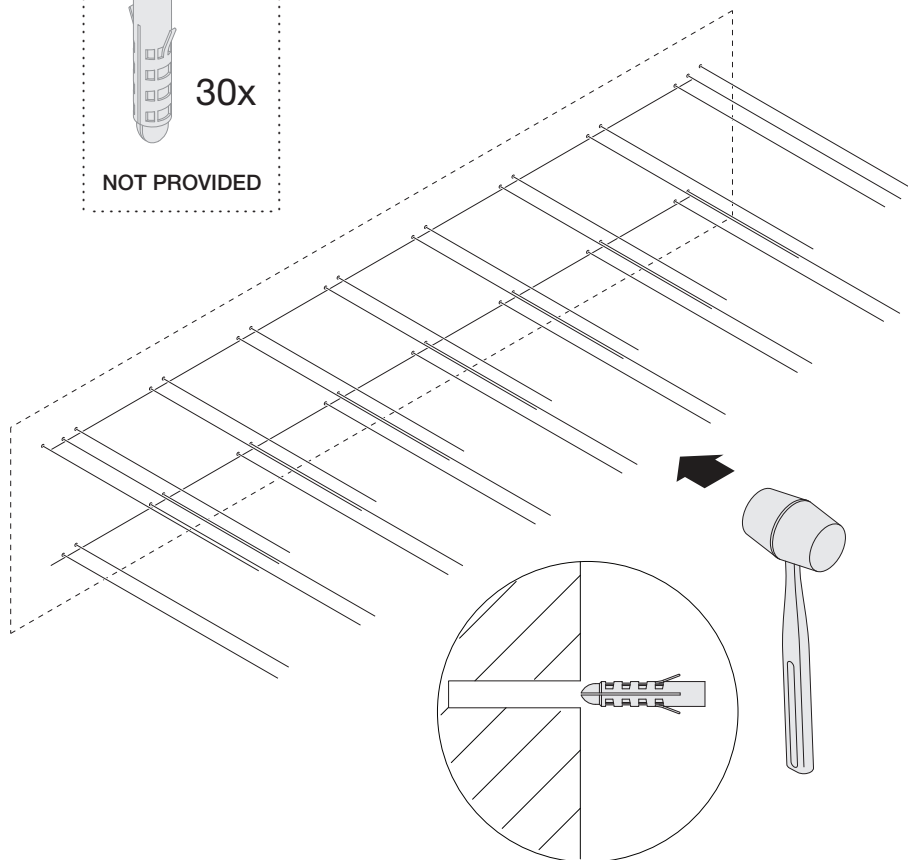
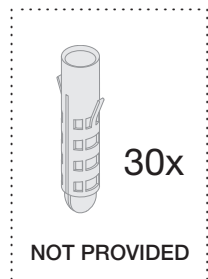

12

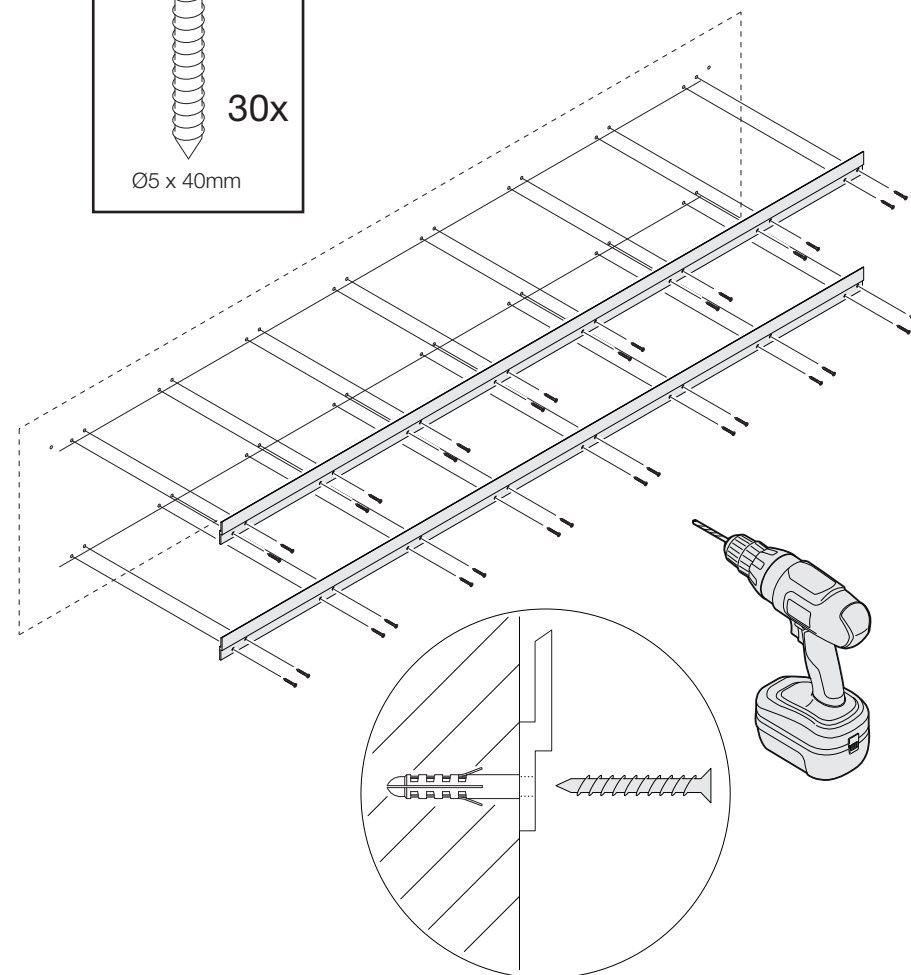
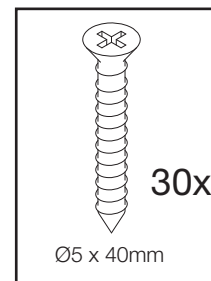



13

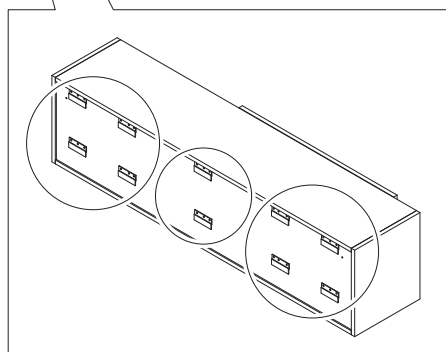
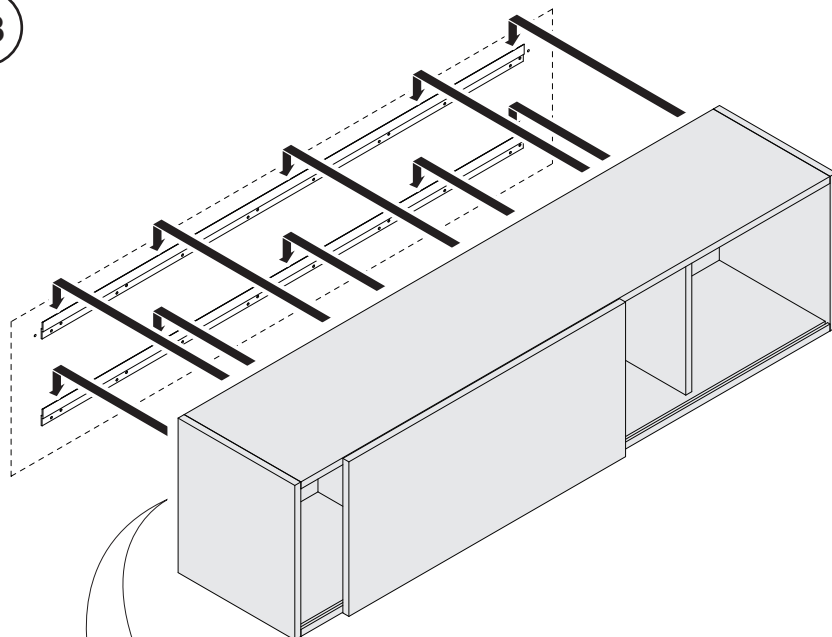

14

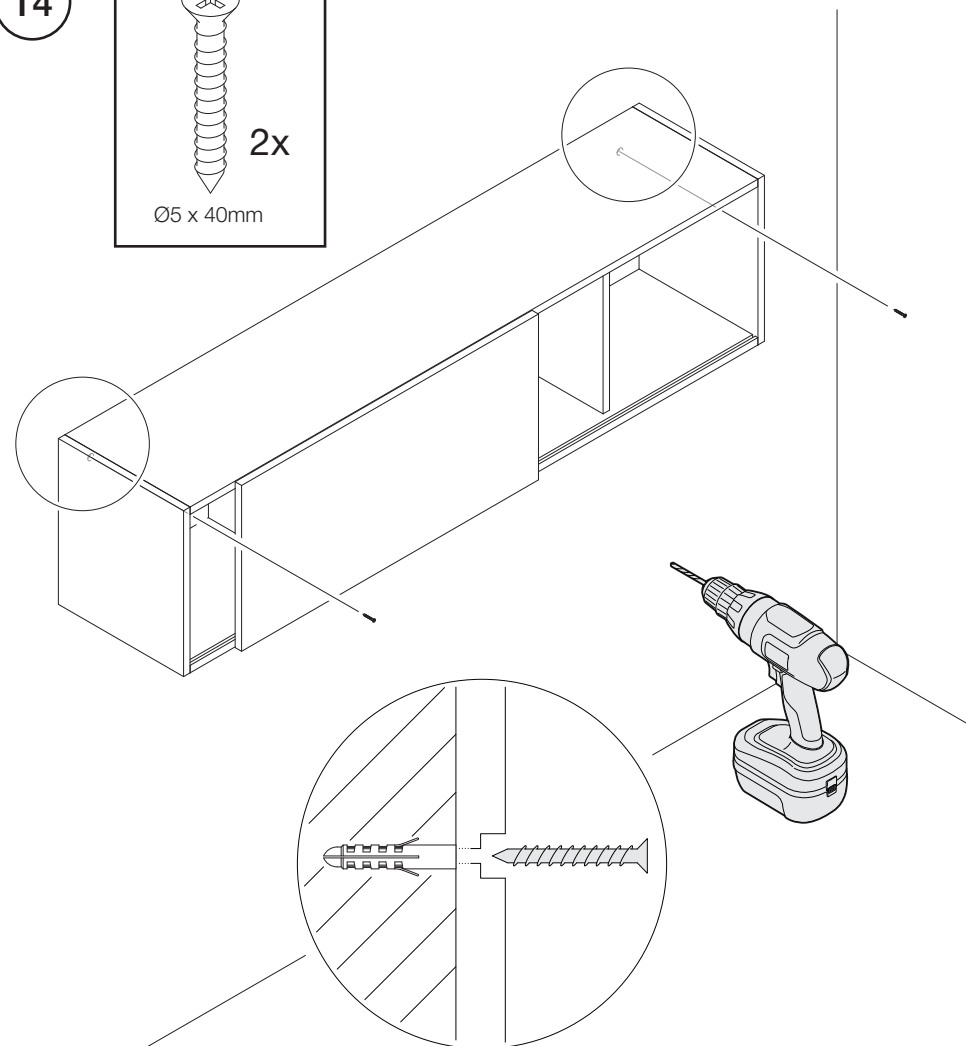
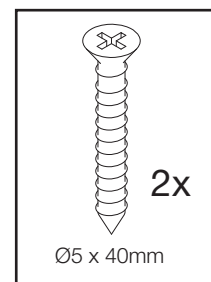

15

