

442 Gesture™ Chair - Back and Can Cover Replacement

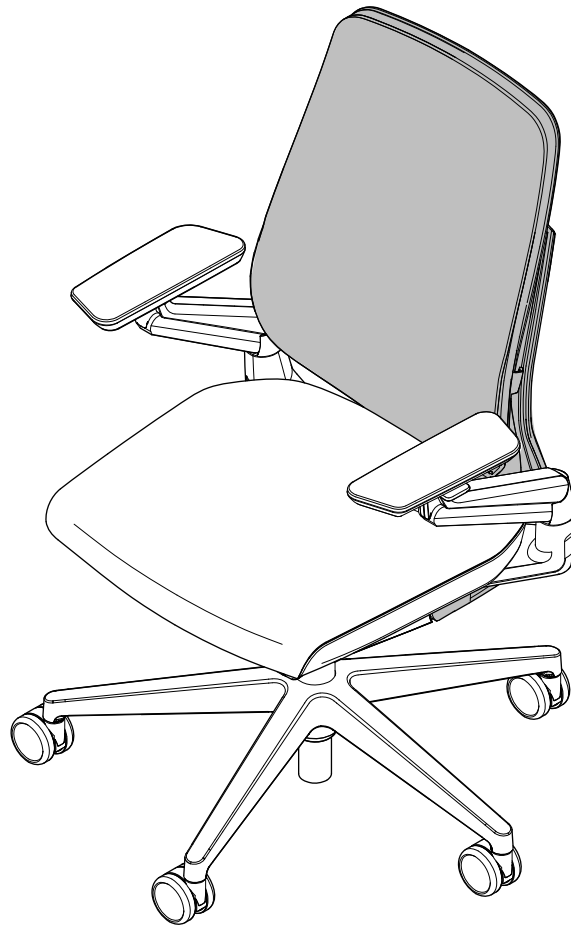

If you have a problem, question, or request, call
your local dealer, or Steelcase Line 1 at
888.STEELCASE (888.783.3522)
for immediate action by people who want to help you.

(Outside the U.S.A., Canada, Mexico, Puerto Rico,
and the U.S. Virgin Islands, call: 1.616.247.2500)

Or visit our website: www.steelcase.com

© 2013 Steelcase Inc.
Grand Rapids, MI 49501
U.S.A.

Printed in U.S.A.

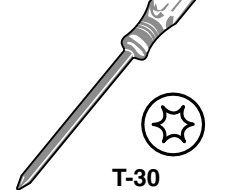
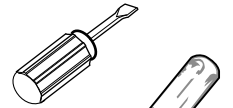
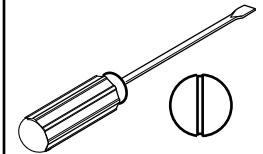
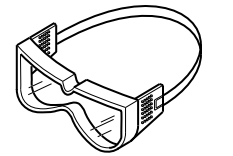

T-30
TORX



Back Release
Tool



Safety Pin

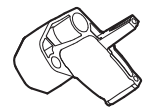

Holding Block

1. Rotate back tension knob counter clock-wise until it stops. Rotate variable back stop lever counter clock-wise until it stops. (*This allows the back to fully recline*).

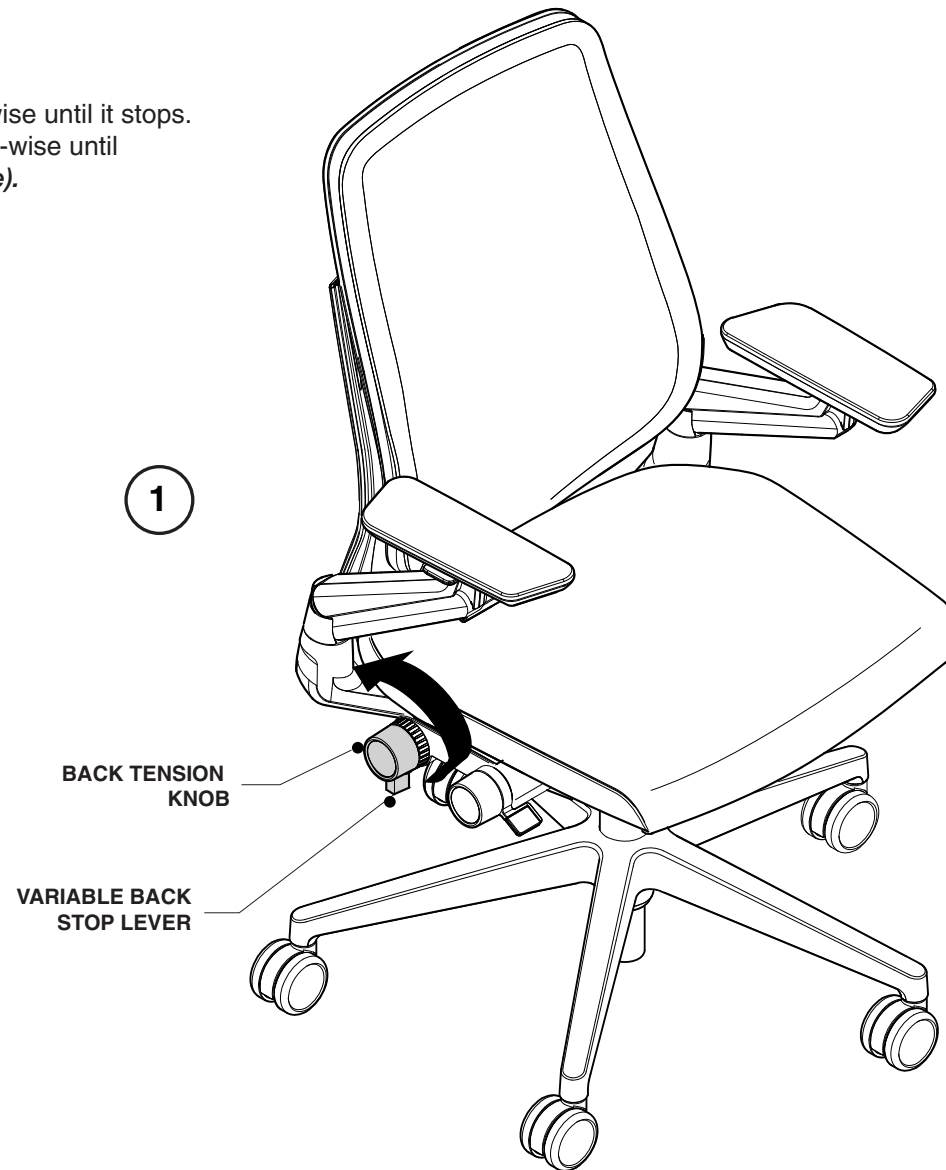

OPTIONAL: FOR STANDARD BACK CUSHIONS

a. Rotate seat depth knob clock-wise to extend seat forward.

b. Slip fingers between cushion and outer back shell in the center of the back on both sides. Lift cushion up and forward to unhook from top of back.

c. Lay cushion down. Detach two (2) rubber bungees from hooks. Set back cushion aside.

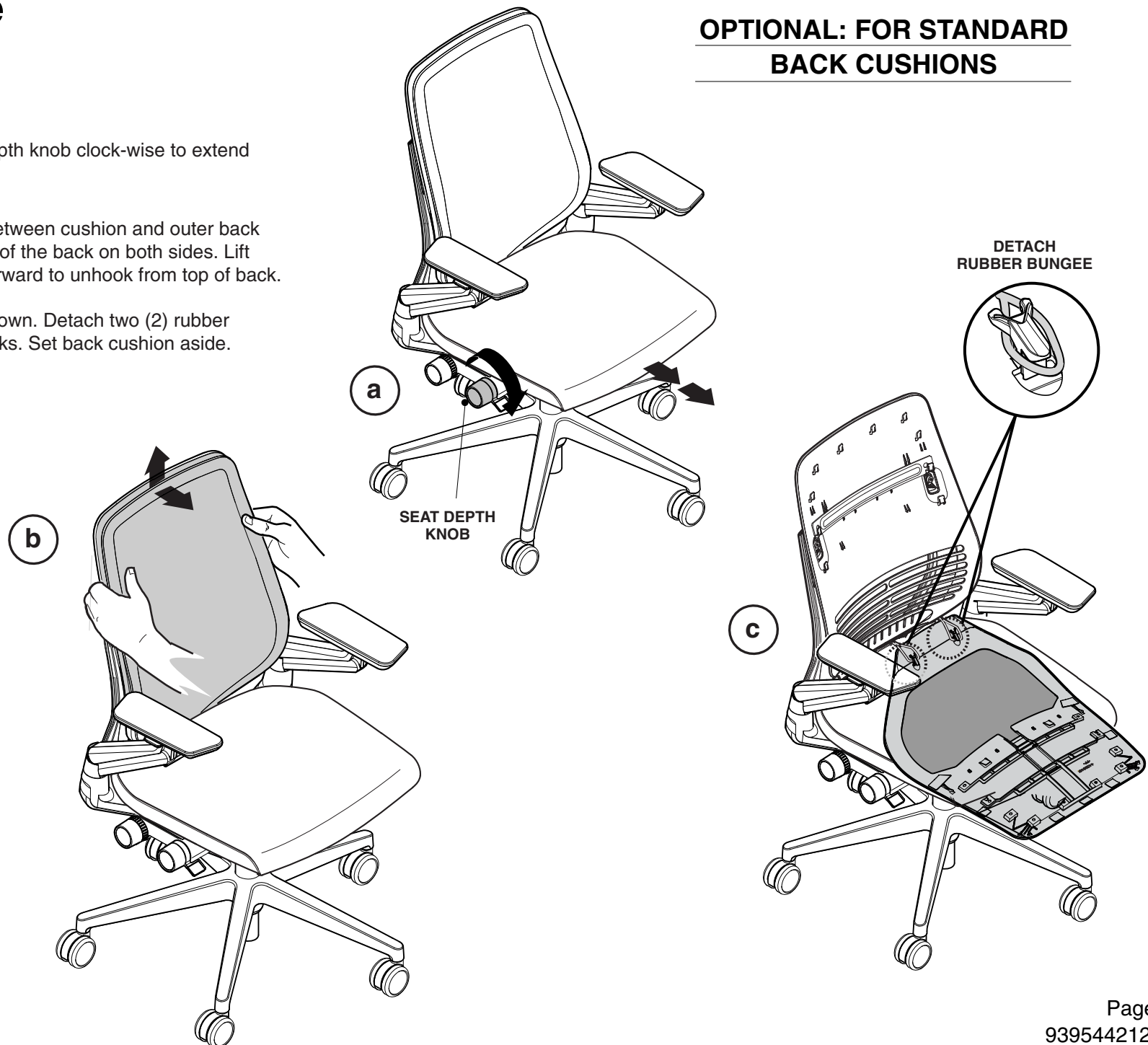

OPTIONAL: FOR WRAP BACK CUSHIONS

a. Rotate seat depth knob clock-wise to extend seat forward.

b. Slip fingers between cushion flap and outer back shell on one side of the back cushion. Pull outward to disengage 'T' clips. Work from one side to the other. Fold flap over cushion face when completed.

c. Slip fingers between cushion and outer back shell in the center of the back on both sides. Lift cushion up and forward to unhook from top of back.

d. Lay cushion down. Detach two (2) rubber bungees from hooks. Set back cushion aside.

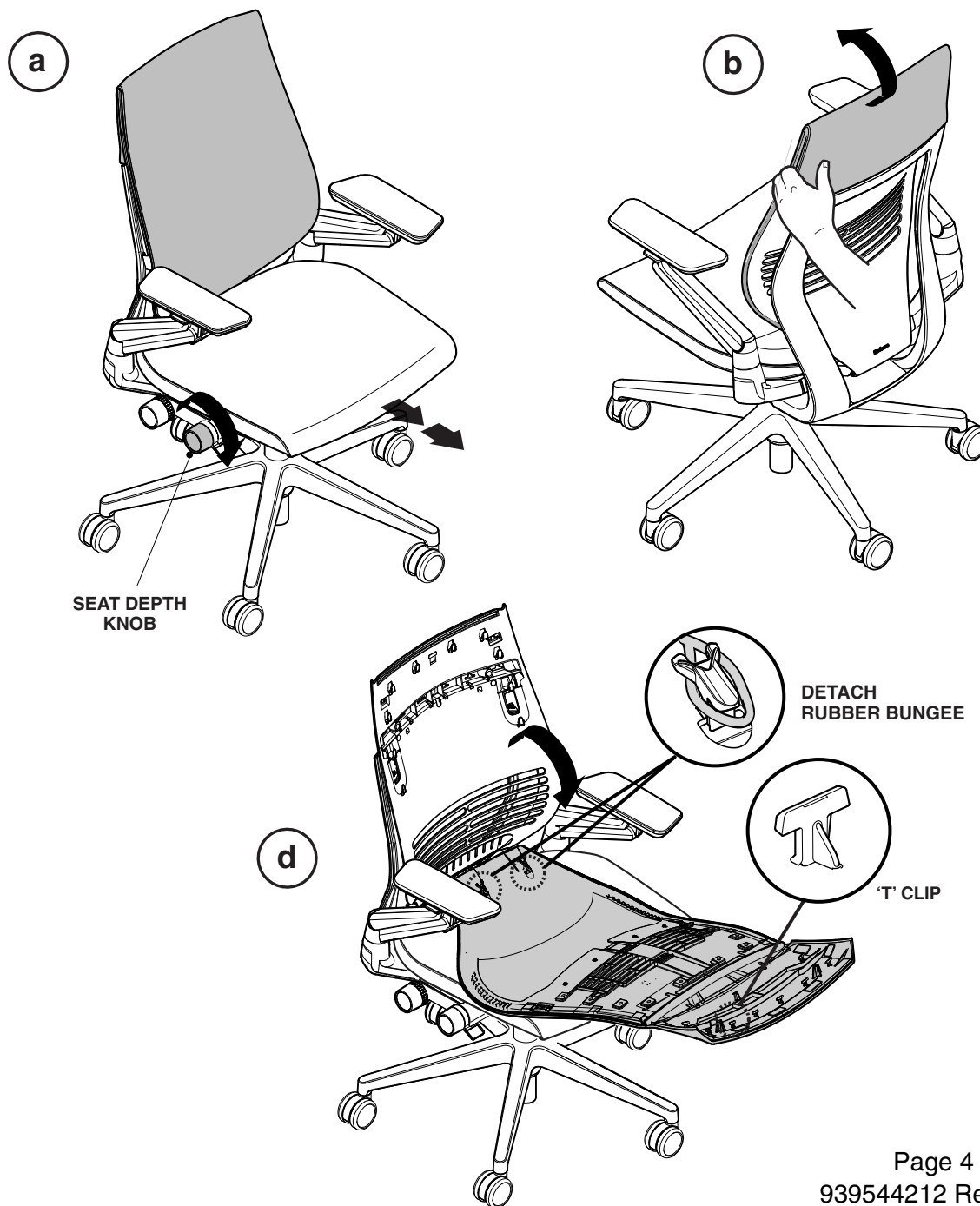

2. Place bent end of back release tool (p/n 442B2100) into slot of back buckle latch. Push down on end of back release tool to pivot bent end up, disengaging back buckle latch (2a). Pull bottom of back out of core equalizer (2b).

3. Position chair on its front and pry down bottom cover to remove.

4. Remove two (2) screws from back frame using a Torx-40 driver.

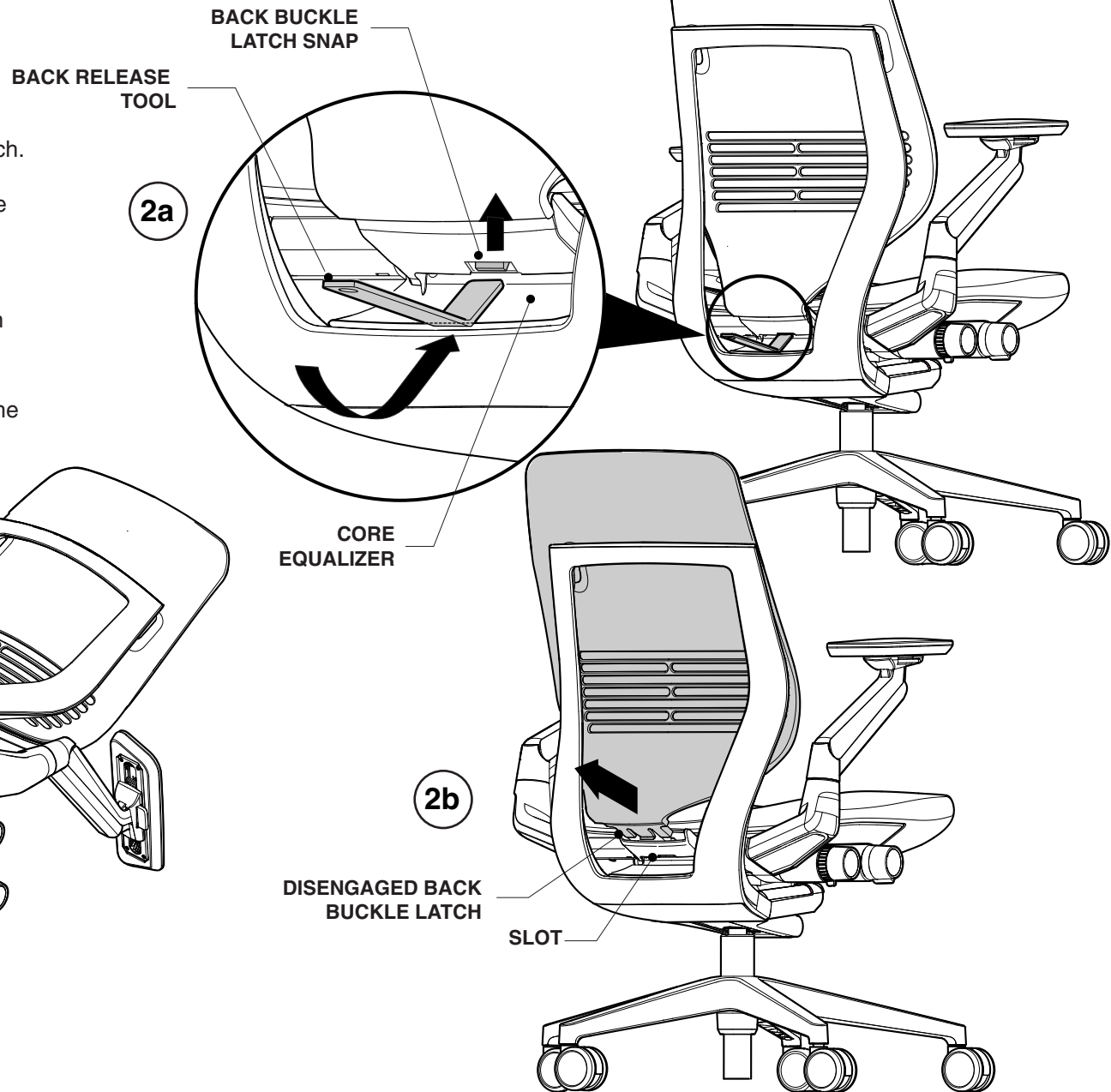

5. Rock the top of the back forward to compress the core equalizer spring fully (5a). Insert holding block (P/N 442B8101) and safety pin (P/N 442B9501) as shown (5b).

6. Remove back assembly by pulling straight out.

7. If you are replacing the can covers, gently pry up back end of can cover using a flat bladed screw-driver. Unhook front end of can cover and slide it off. Repeat for other side. Hook on new can covers and press on from side.

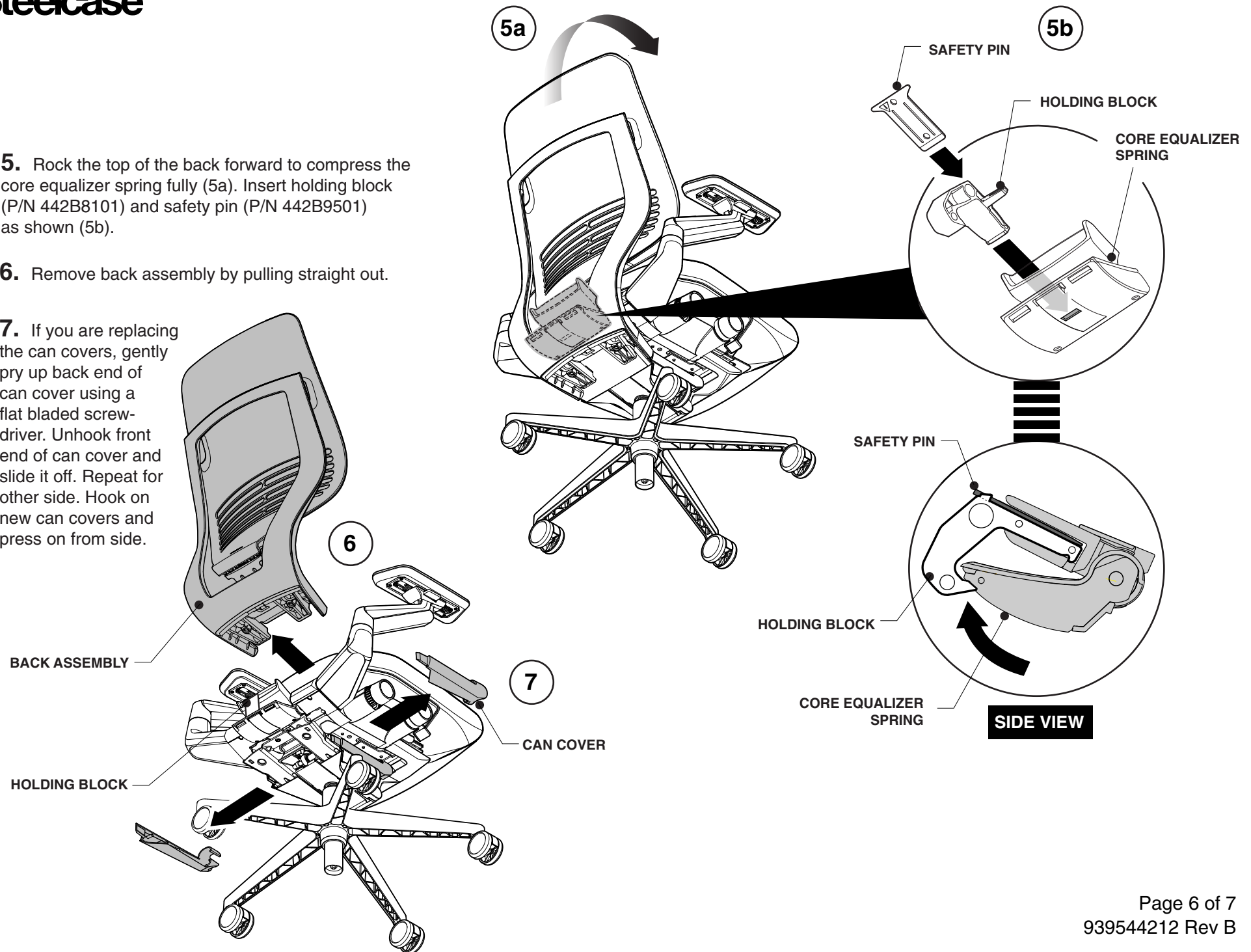

8. Insert new back frame. Feed in from back. Rotate it down into place. Holes should align.

9. Rock back frame forward to compress core equalizer spring. Remove safety pin and holding block. Carefully rock top of back rearward to release tension on spring.

10. Make sure back frame holes align and drive two (2) large back frame screws with T-40 Torx until seated.

11. Replace bottom cover by aligning two (2) hooks in cover into steel holes in mechanism. Slide down to engage snaps.

12. Snap bottom of lower back into back buckle latch.

13. Set chair up and reinstall back cushion to finish.

