

## Side Screen + Table

1. Remove both of the Side Screen's bottom caps.
2. Slide the Screen Brackets into the side slot of the Side Screen as shown. Do the same to the opposite bracket.

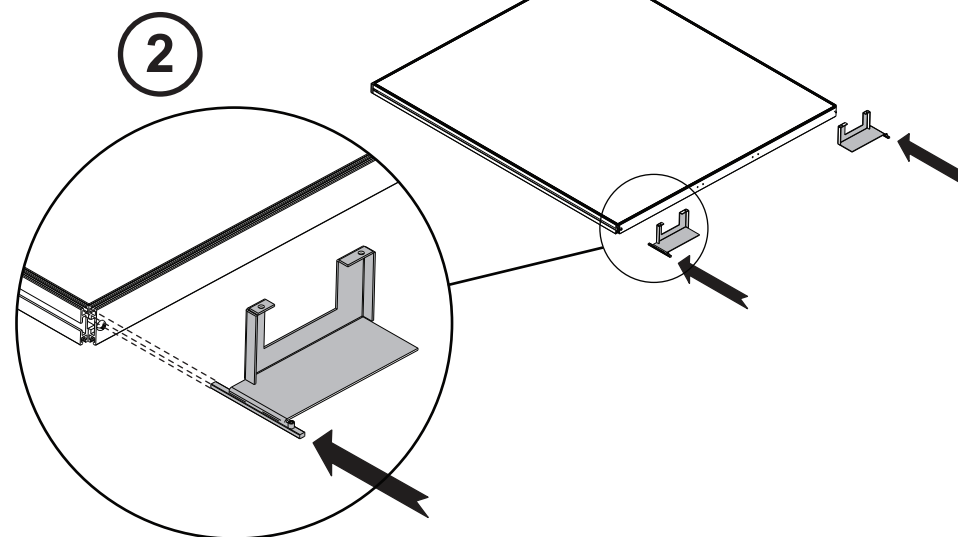
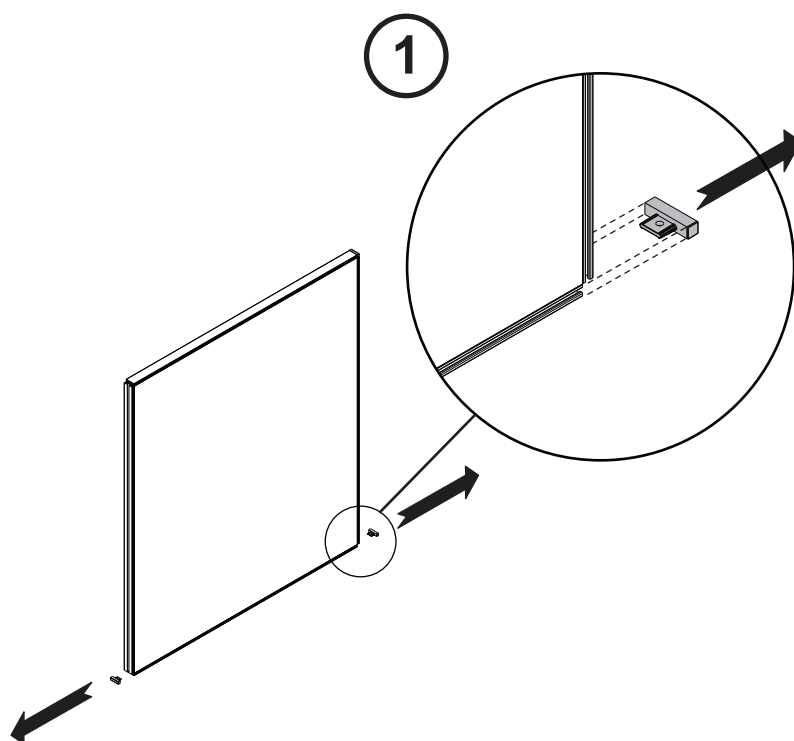
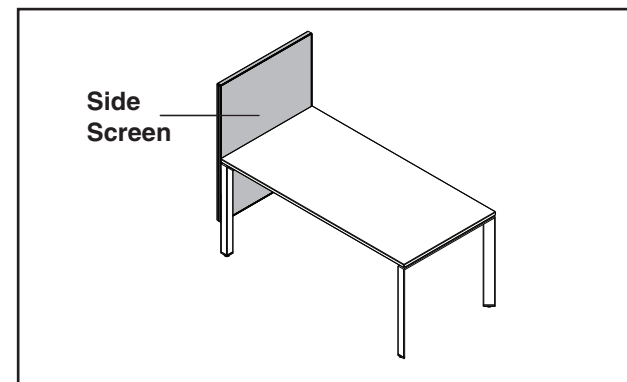

## Side Screen + Table

3. Align the Set Screw to the desired Screen height guide hole. Tighten this screw to lock it to the guide hole. Align the other bracket to the same height and repeat this step.
4. Re-install both bottom caps of the Screen.

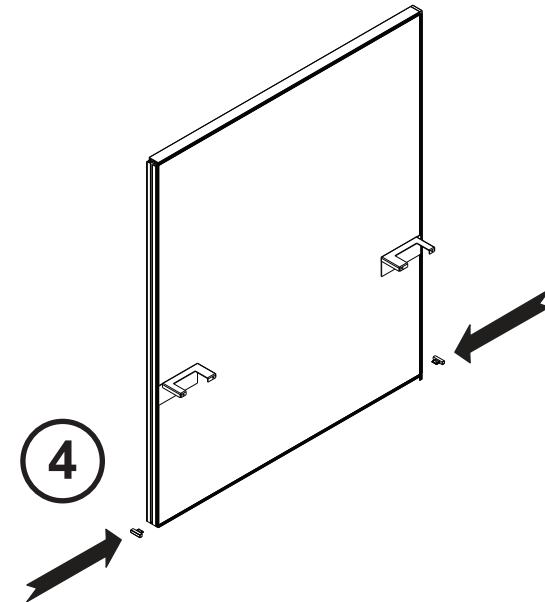
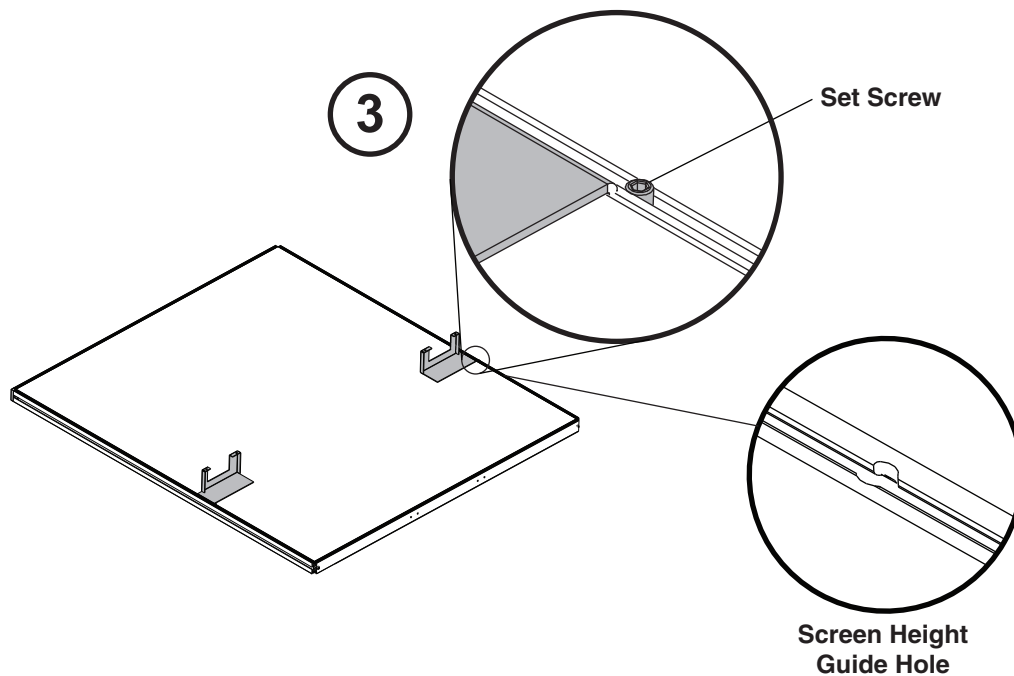

### Screen Height Guide Hole

This hole functions as a guide to determine the overall height of the screen/panel installed to the FrameOne desk.

**Note:**

Lowest Guide Hole = Highest Screen Position

## Side Screen + Table

5. Align the Side Screen to the table.  
Make sure that the Side Screen is flush the table edging.
6. Tighten two M4 screws to the Screen Bracket through the hook plate.
7. Shown is a completed installation of the opposite Screen Bracket.

