

Side Modesty Panel + Table

1. Shown is the side modesty panel installation package.
2. Stick two bumpers on each lower bracket.

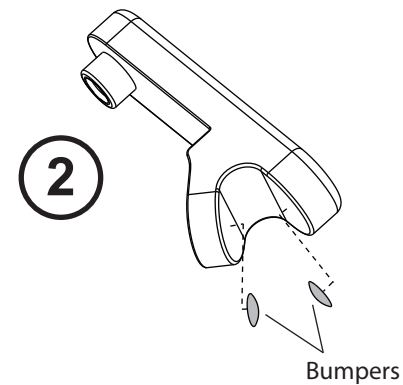
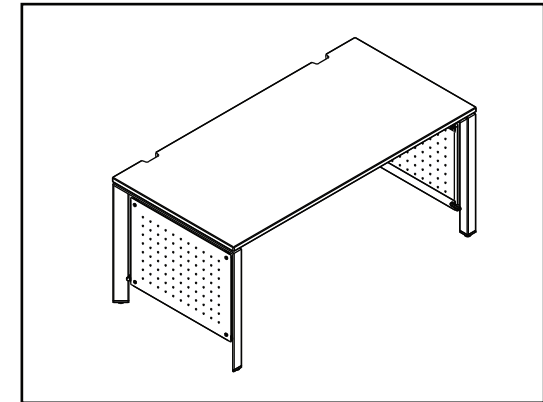
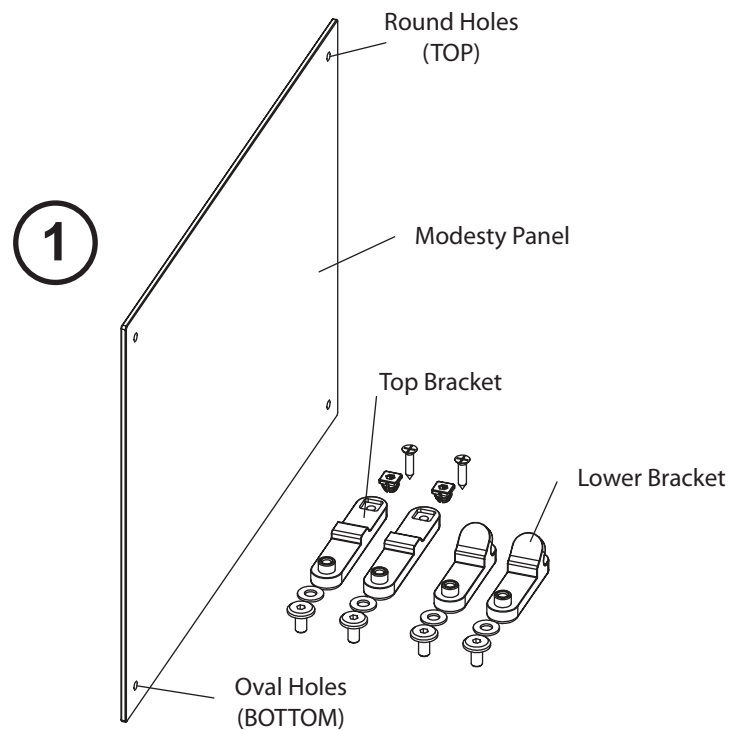

Side Modesty Panel + Table

3. Fix the top bracket to the side modesty panel using an allen key.
Make sure it is installed through the round holes.
4. Fix the lower bracket to the side modesty panel using an allen key.
Make sure it is installed through the oval holes.
Slide the lower brackets to fit in between the table legs.
Fix the the top brackets to the table leg using flat head screws.

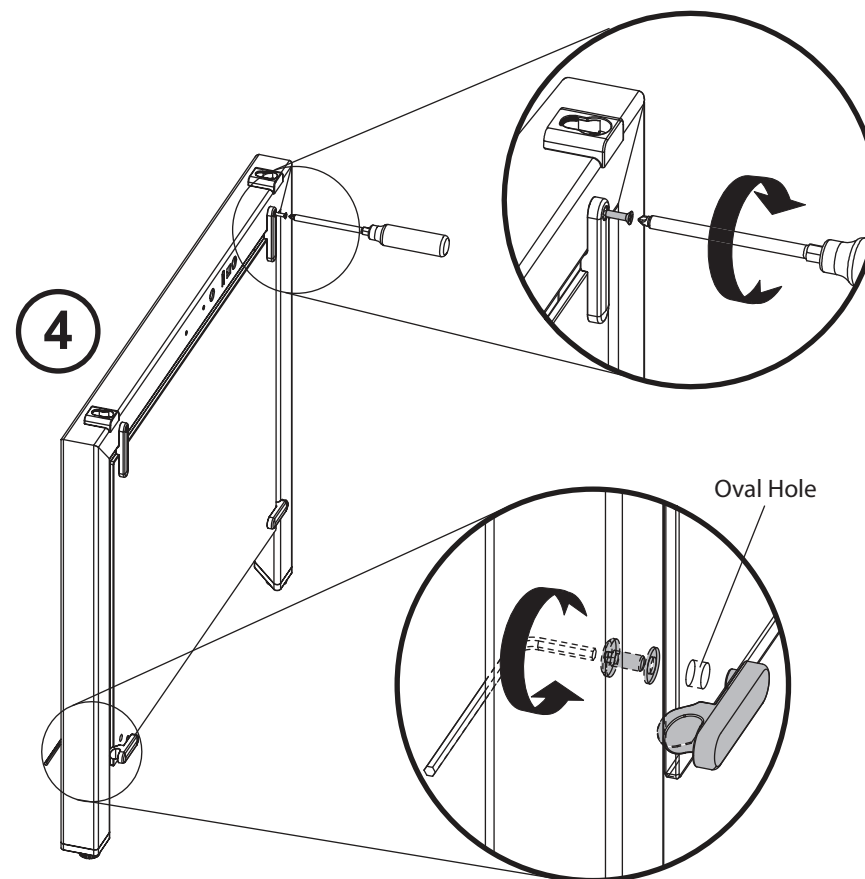
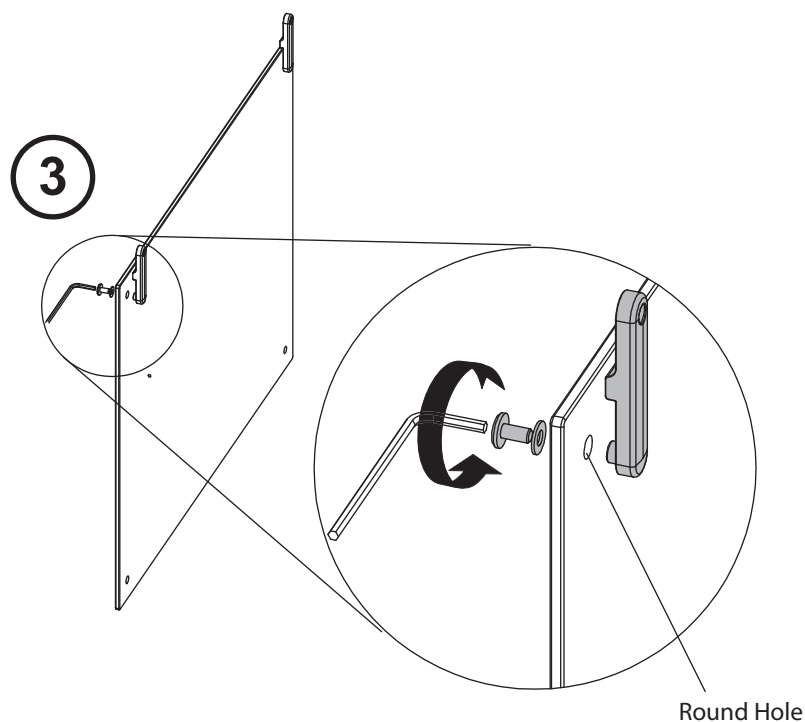

Use RETROFIT BRACKET

- to install Side modesty panel to existing FrameOne leg (Before 10 Aug 2009)
- to install Side modesty panel to FrameOne Crank leg

Side Modesty Panel + Retrofit Bracket

1. Align the side plate to the hole of the leg.
2. Add markings on the Frameone leg by tracing the holes of the side plate.

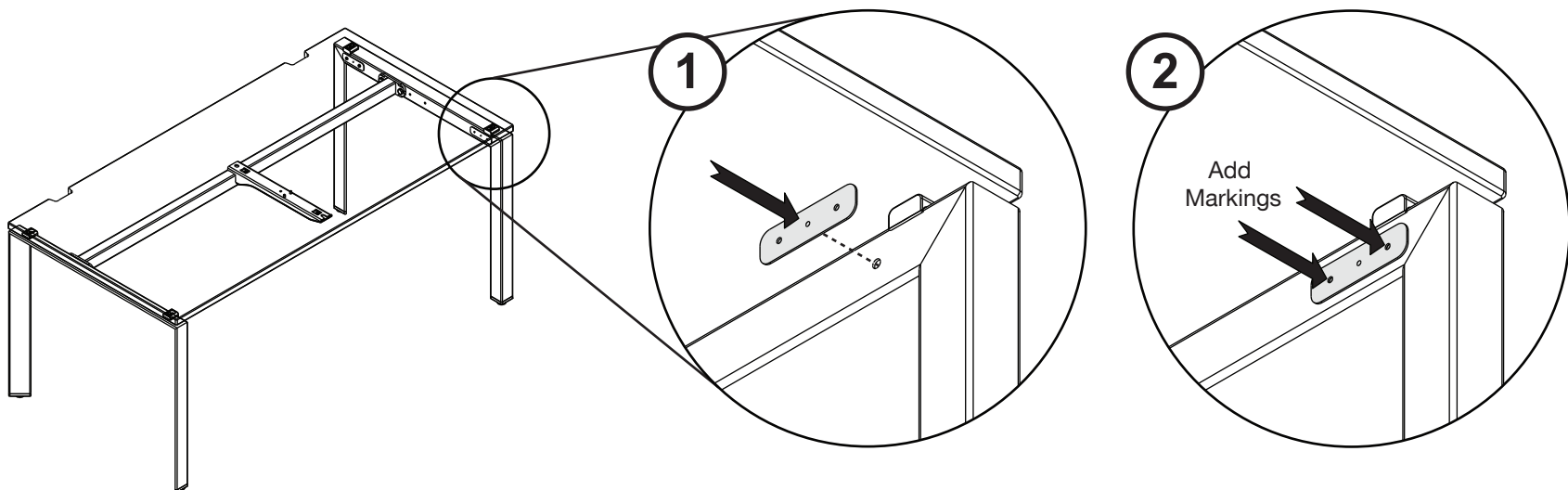
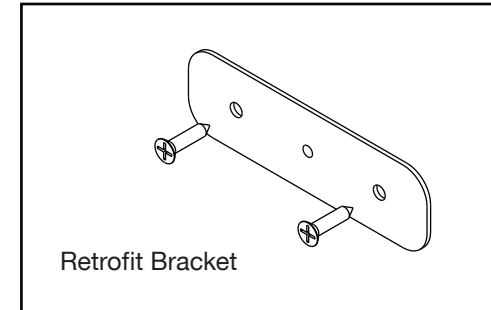

Side Modesty Panel + Retrofit Bracket

3. Drill holes on the marked positions using No. 3 drill bit.
4. Use the M4 tapping bit to make a screw thread to the drilled holes.

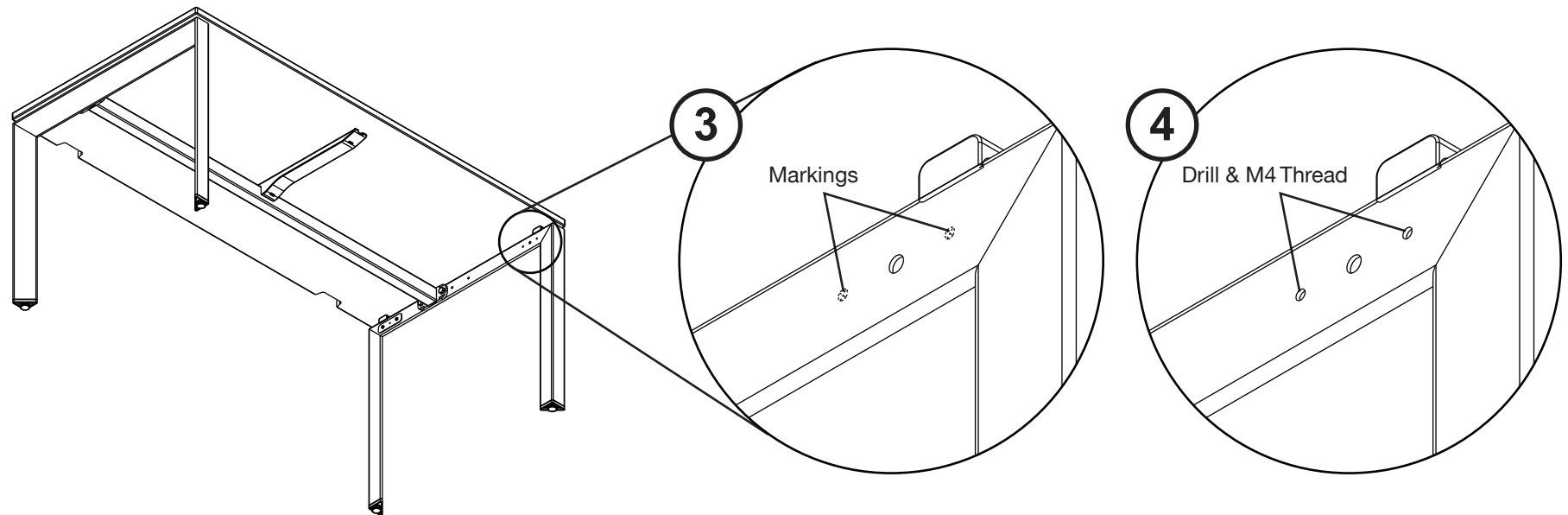

Side Modesty Panel + Retrofit Bracket

5. Insert two (2) M4 tapping screws to the tapped holes through the side plate.
6. Install the Retrofit Bracket on the other end of the Frameone leg by repeating Step 1 to 5.

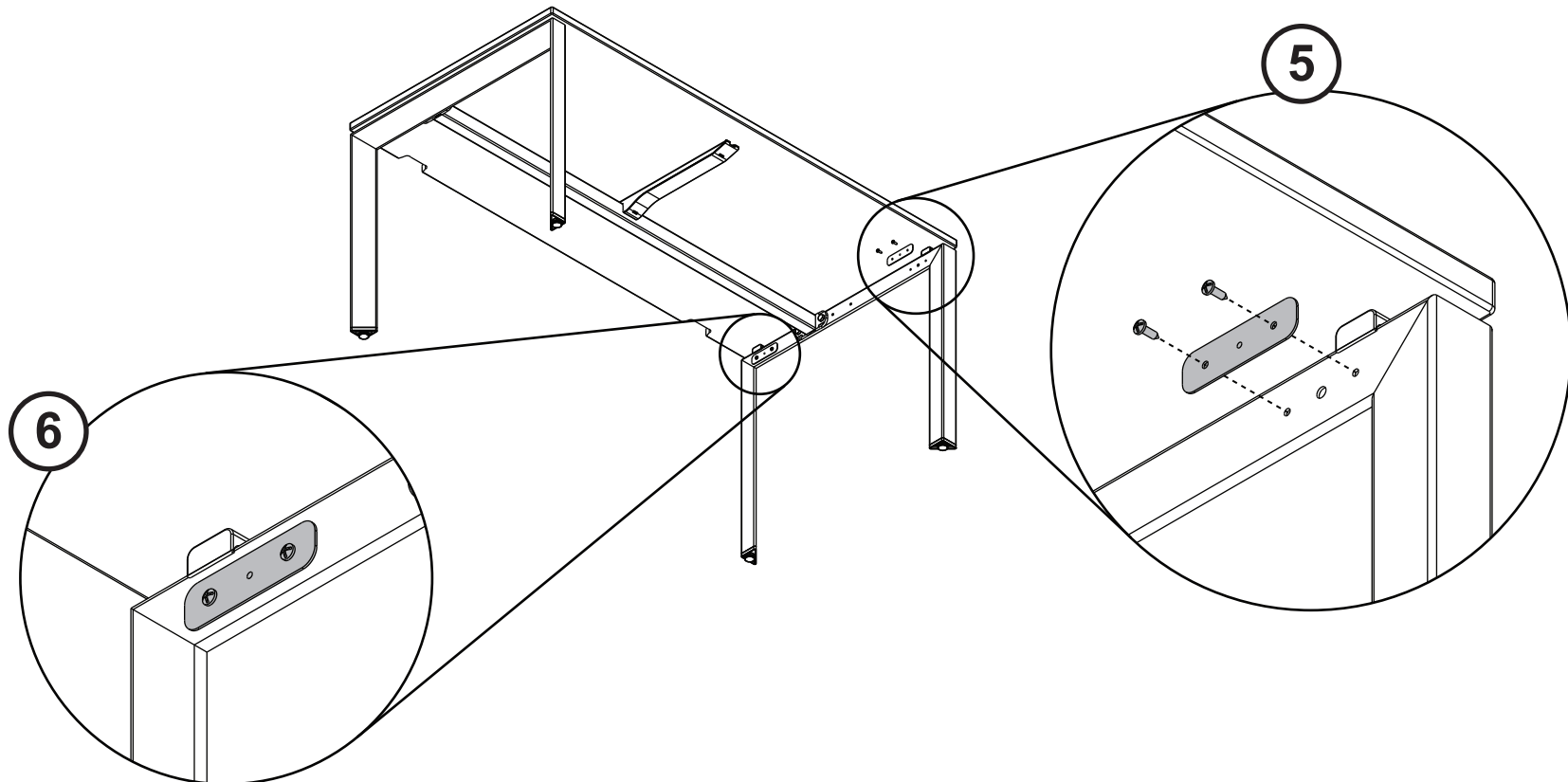

Side Modesty Panel + Table

7. Fix the top bracket to the side modesty panel using an allen key.
Make sure it is installed through the round holes.
8. Insert M4 screws to the tapped holes through the side modesty top hanger as shown.
9. Fix the lower bracket to the side modesty panel using an allen key.
Make sure it is installed through the oval holes.
Slide the lower brackets to fit in between the table legs.

