

FE3 Screen + Functional Rail

1. Position the support block at shown.
Insert the M6x30 screw through the support block to the FE3 Screen
2. Insert the M6x20 set screw through the support block to the FE3 Screen.
Install the support block on the other end of the FE3 Screen by repeating step 1 and 2.

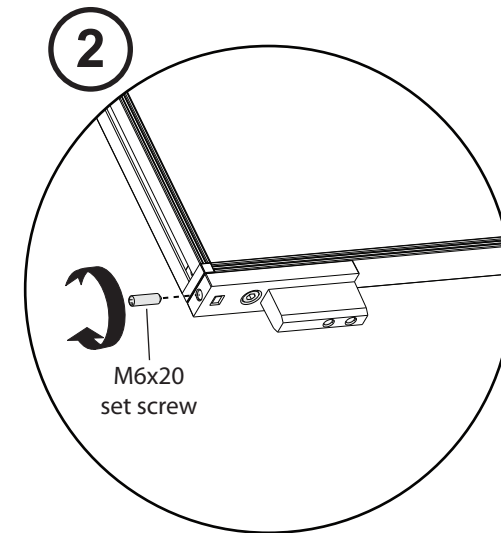
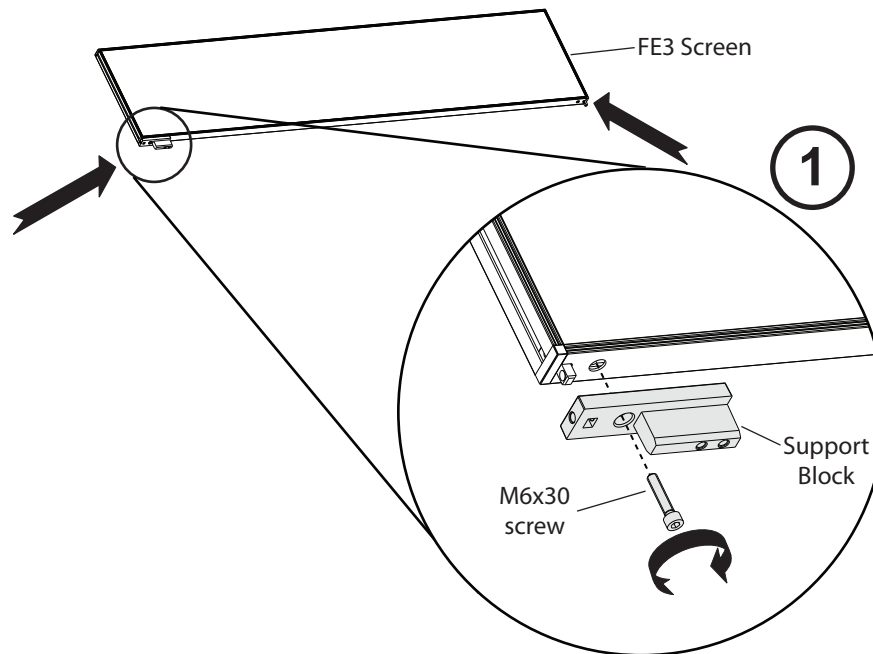
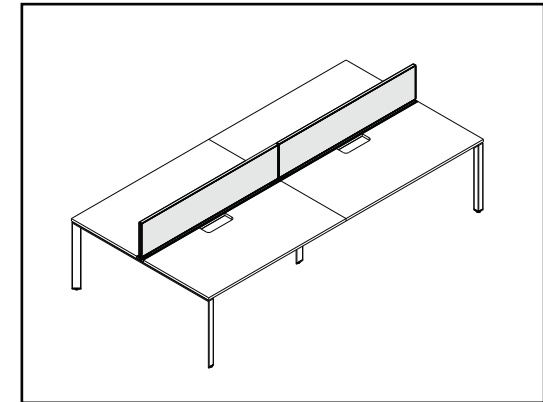

FE3 Screen + Functional Rail

3. Position the FE3 Screen as shown.
The edge of the FE3 Screen & Functional Rail must be align.
4. Insert two M6x30 screws through under the rail to the support block.
Apply to both side of the FE3 Screen's support block.

Repeat step 1 to 4 for each FE3 Screen installation.

