

Deviation from the assembly instructions may result in a risk of fire or electric shock.



To Reduce The Risk of Fire, use E27/E26 12V DC compact fluorescent or LED Light bulb. Light bulb can be used as long as the overall length does not exceed 113mm



To Reduce The Risk of Fire, Immediately remove any debris in the lamp shade/diffuser assembly.



To Prevent Risk of Electrical Shock

1. All electrical installations must be done by qualified personnel in accordance with codes and regulations applicable at the installation site.
1. Before beginning work, ensure that the electrical power has been removed from the circuits that are being connected to or disconnected from.
1. Ensure that circuits to which the lights are connected are properly grounded and are the correct voltage.
1. To prevent wiring damage or abrasion, do not expose wiring to edges of sheet metal or other sharp objects.

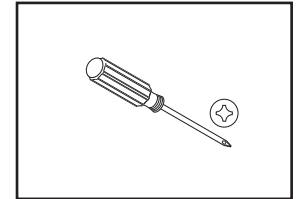

APPLICATION NOTE: Consult your local fire code authorities when planning the use of this product in a building with sprinklers. Some authorities may limit the use of the Big Lamp in close proximity to sprinkler heads due to the large shade being an obstruction in the sprinkler spray pattern.

Important Safety Instructions :

The big lamp equipped with Universal AC input and DC output adaptor with changeable plug face. Never use with an extension cord unless plug can be fully inserted. Do not alter the plug.

BOX #1
Base Assembly

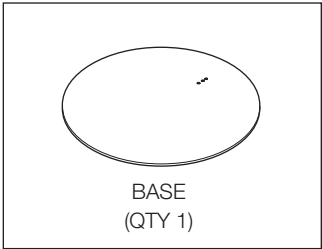

BOX #4
Power Unit

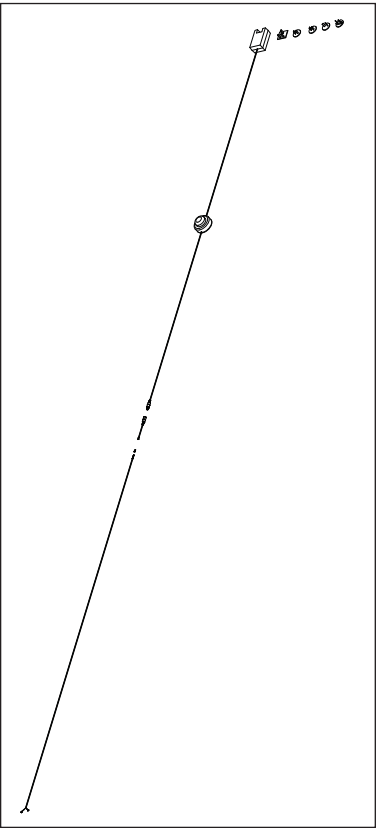

BOX #2
Lamp Upper Section

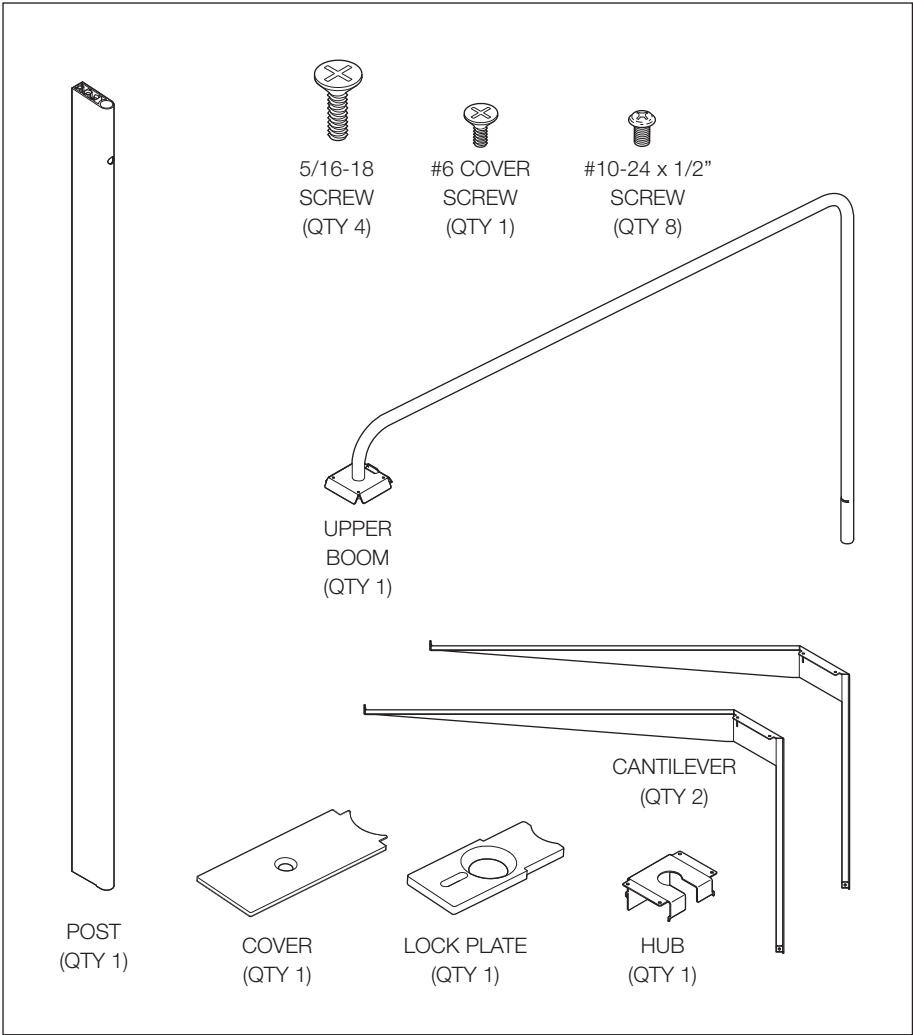

BOX #3
Shade and Diffuser Assemblies

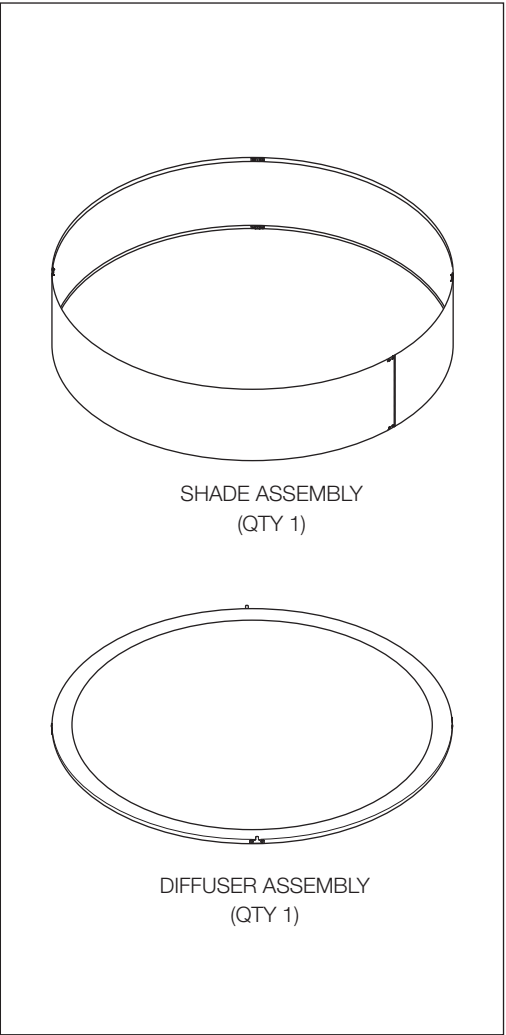

1. Assemble the base to the post using three (3) 5/16 -18 flat head screws. Tighten using a philips screwdriver.
2. Start four (4) #10-24 x 1/2" adjusting screws into the boom plate
3. Feed the cord into the post until the electrical connector is exposed.

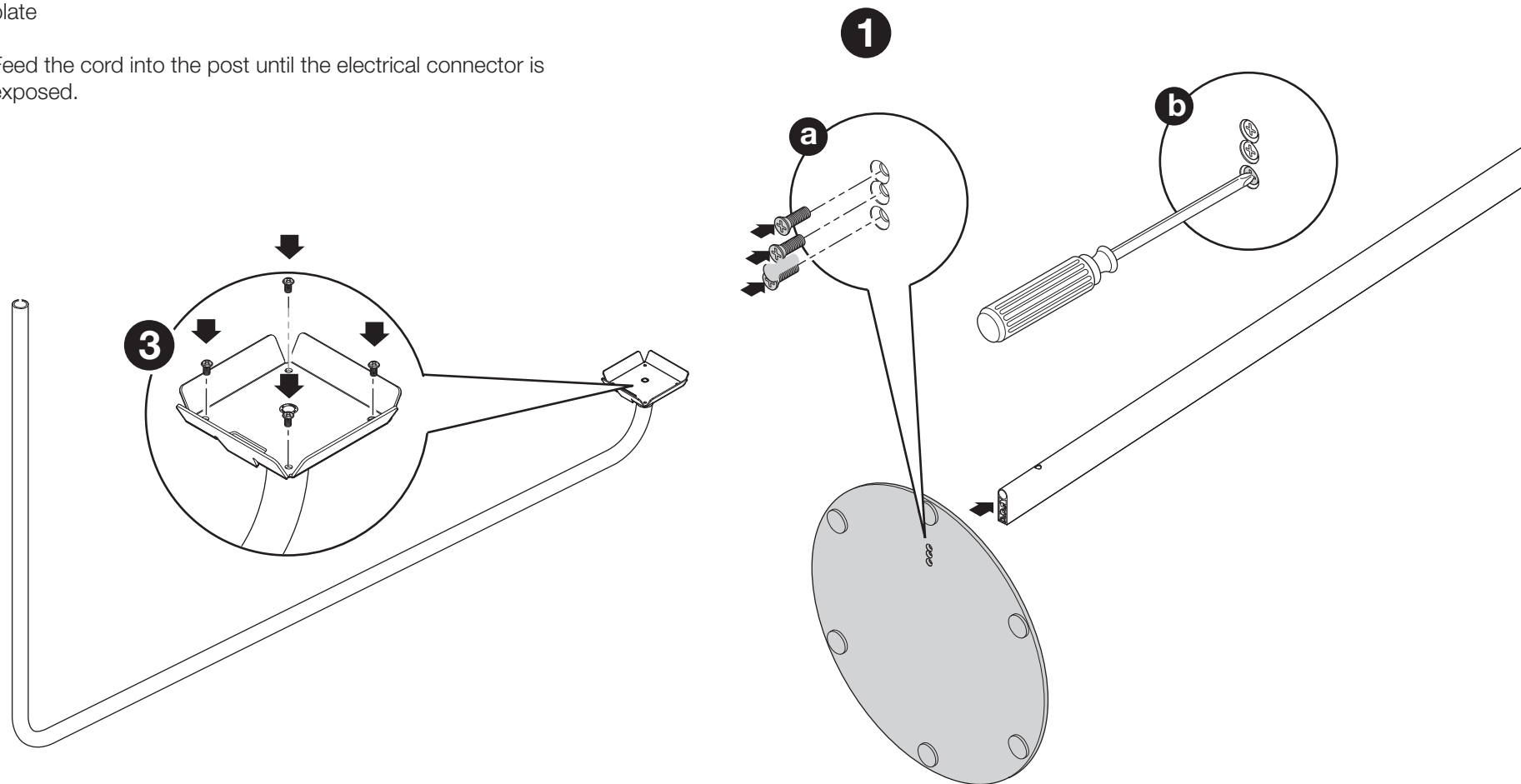

3. Feed the cord into the post until the electrical connector is exposed.

4. Insert the 2-Pin head cable through the Boom hole

5. Connect the 2-Pin head cable with the 2-Pin connector after the cable come out from the boom.

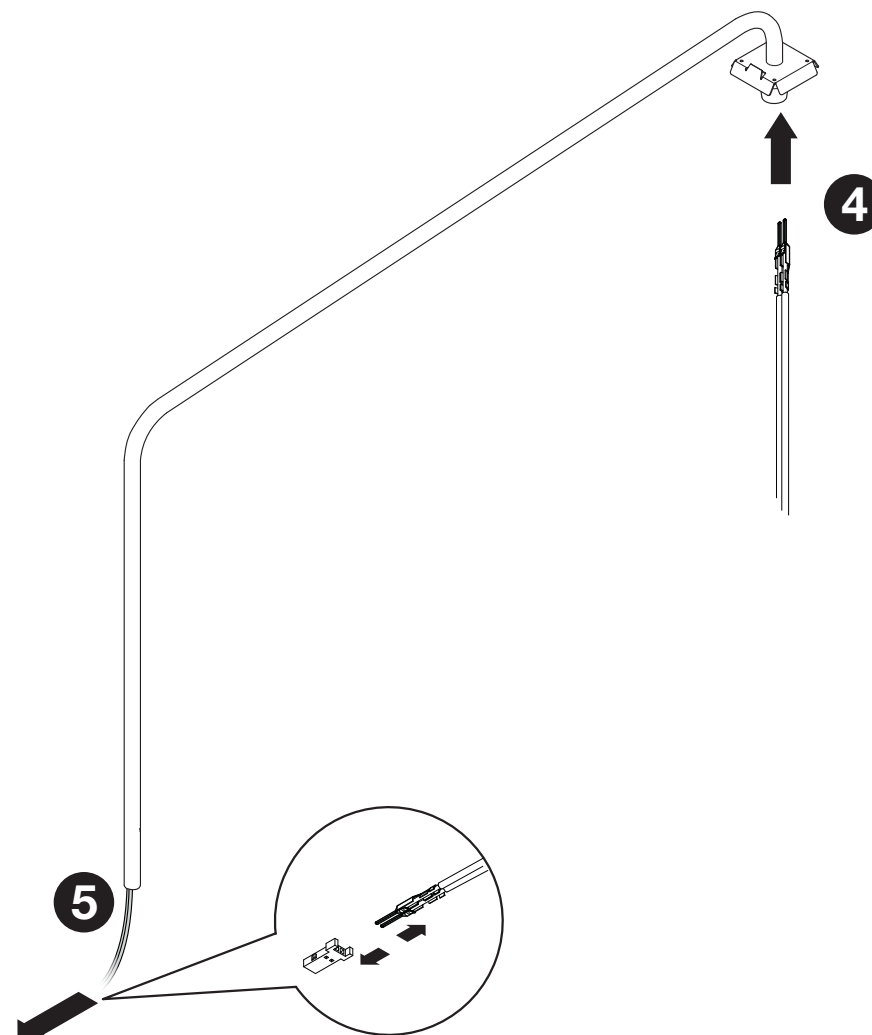
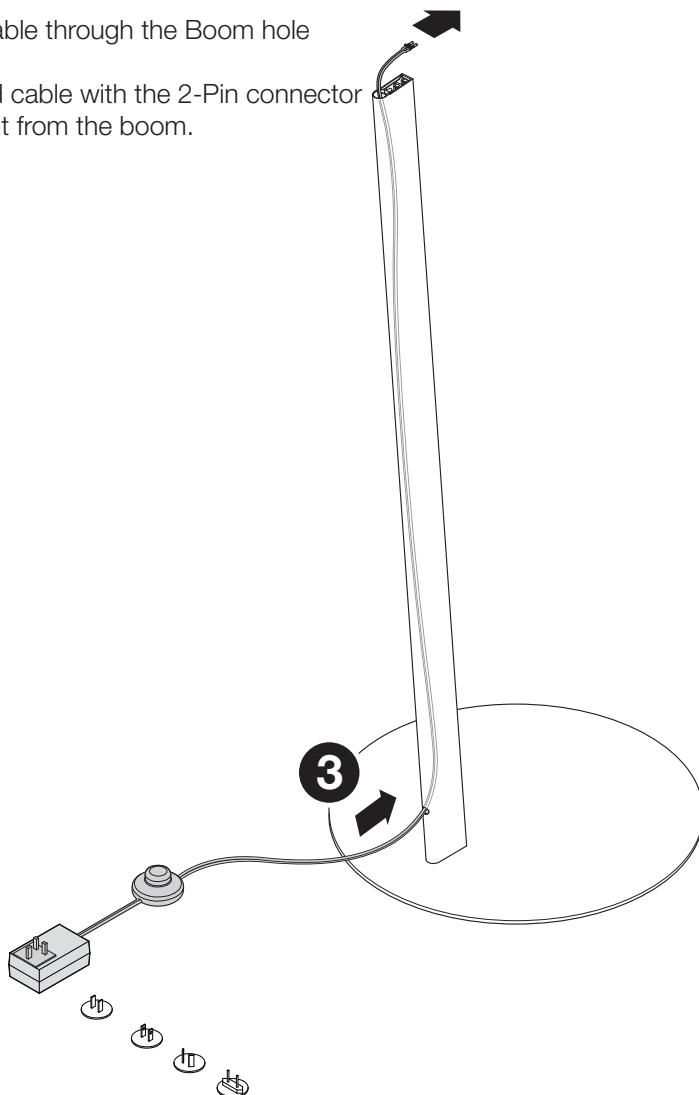

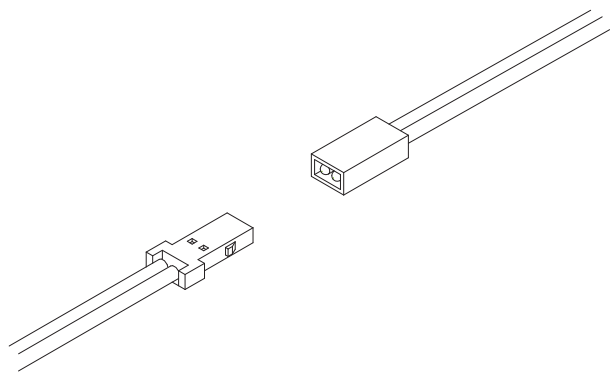

Connect the interconnector cable with the 2-Pin head cable. Make sure it connected properly. Wrap the connector by Insulation Tape

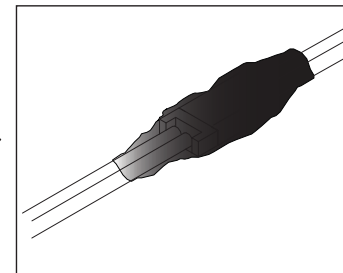
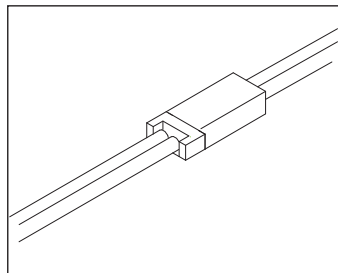

Tighten the insert nut in the hole on the boom. Make sure the fork connector passed through the insert nut.

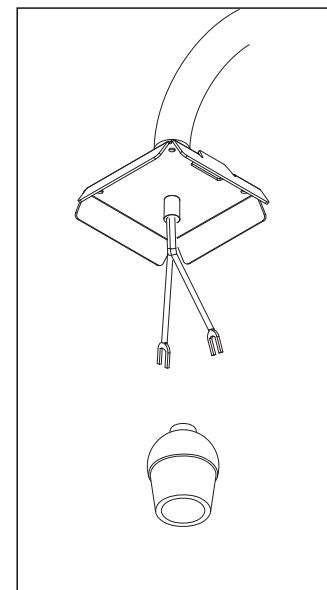
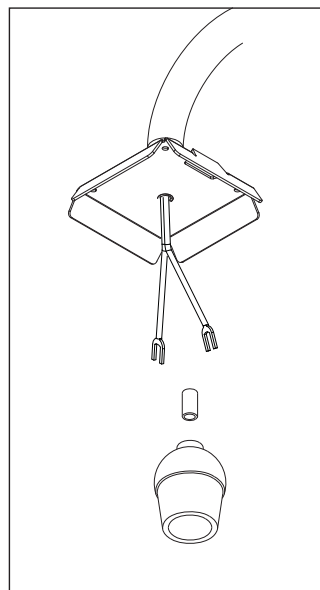

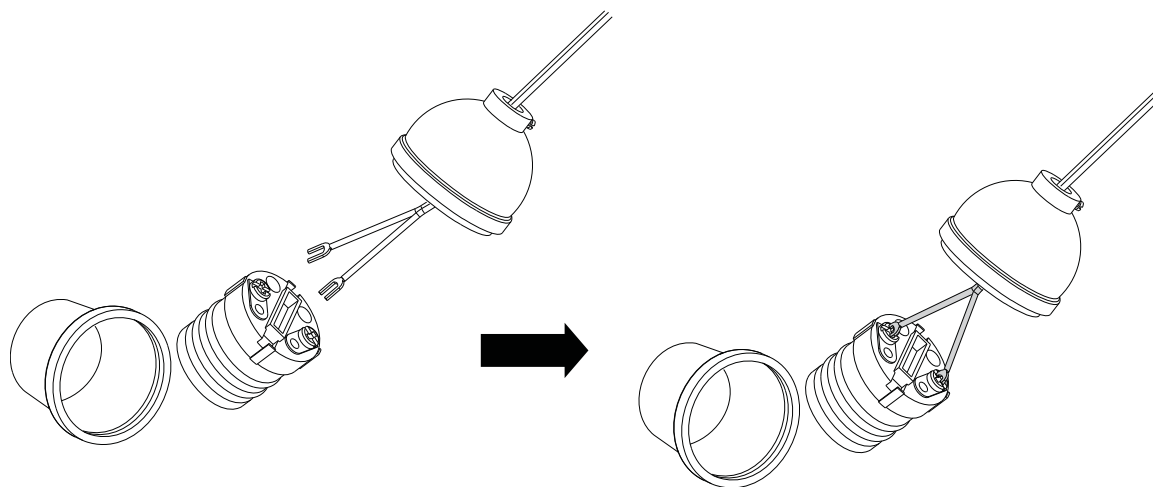

Tighten the fork connector to the lamp holder as per picture shown.

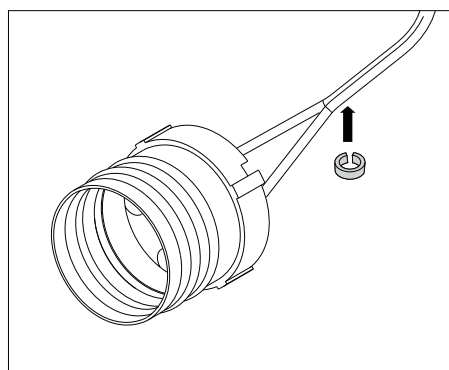

Install the GRIPMASTER strain relief as per picture shown.

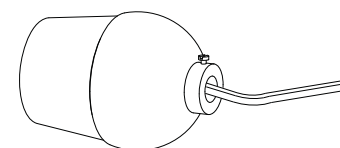
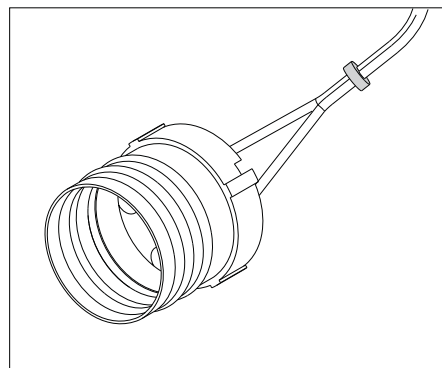

Assemble the Lamp holder housing.

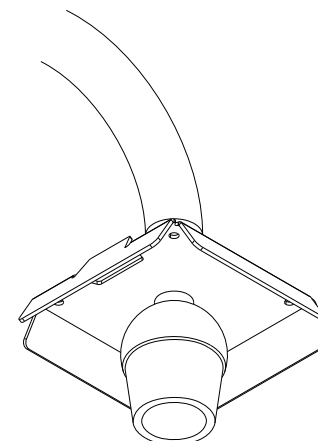

Install the Lamp holder to the Boom.

5. Connect electrical connectors together. Push the connector partially inside the boom tube.

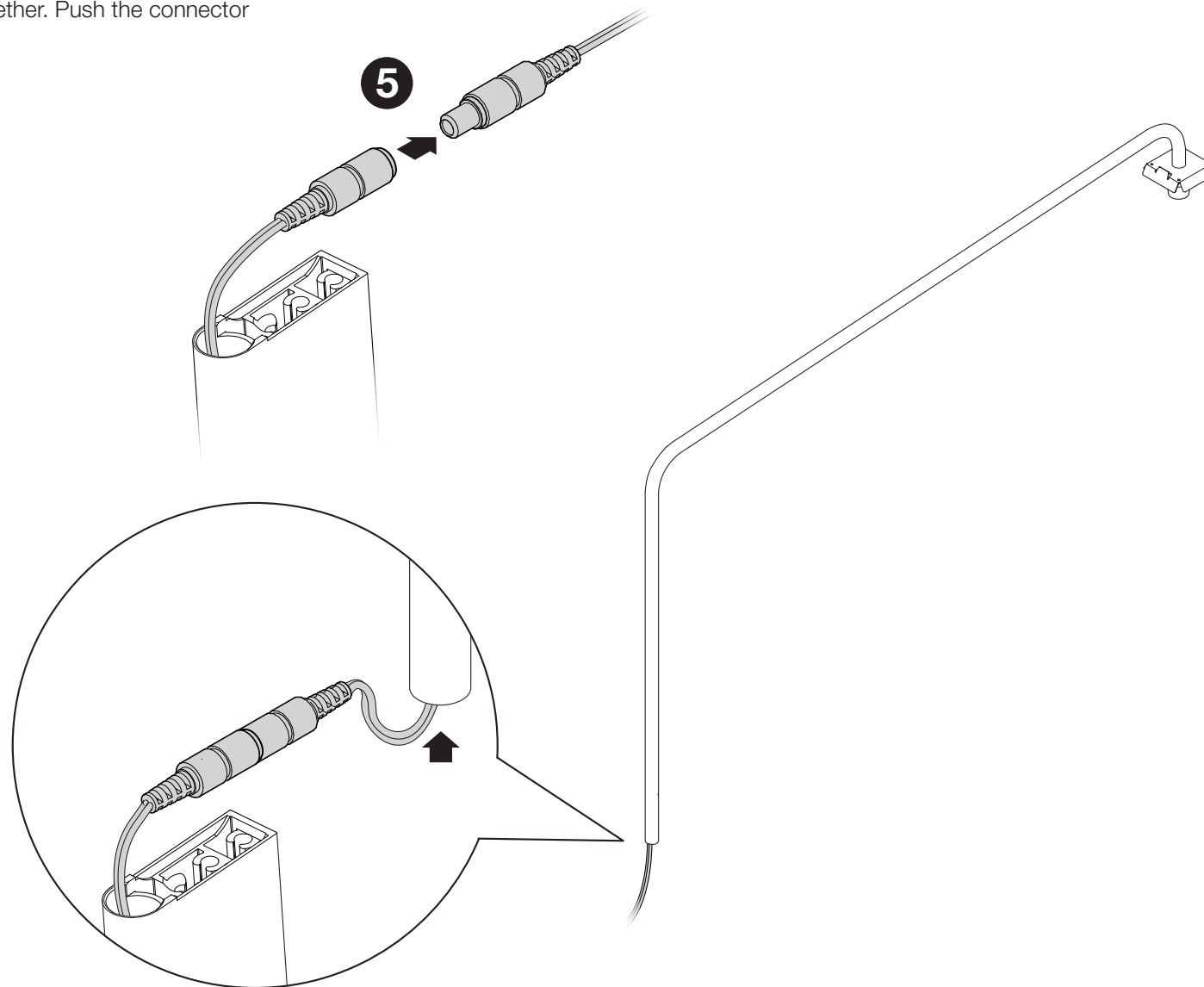

6. Fully insert the boom tube into the post up to the notch in the tube, while allowing excess cord to feed out the base of the lamp.

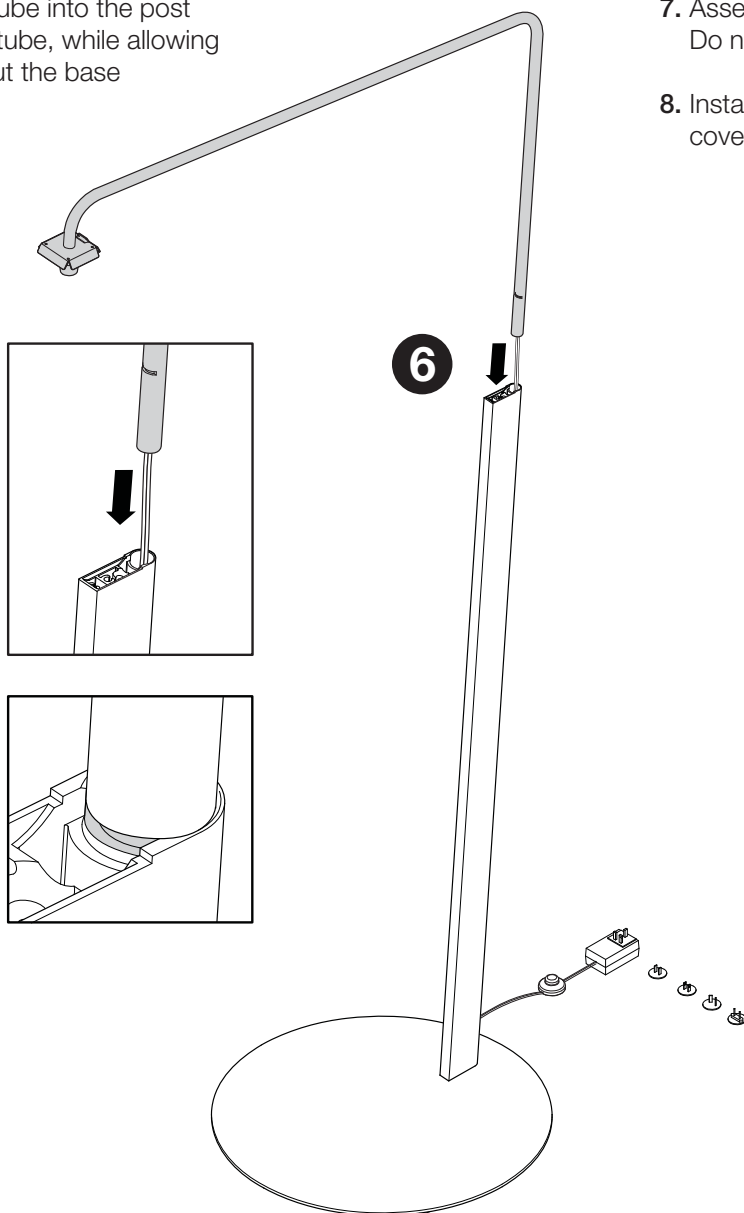

7. Assemble the lock plate into the notch. Insert and tighten one. Do not over tighten.

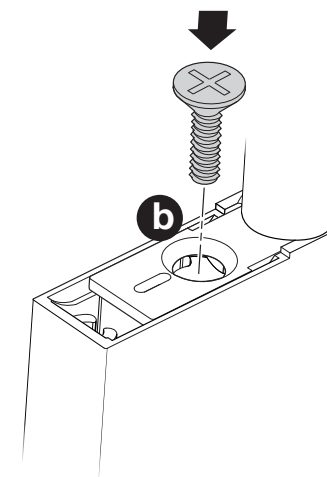
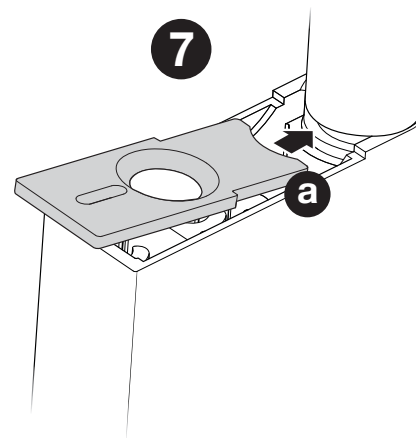

8. Install the cover plate and align it with the post. Install the cover screw.

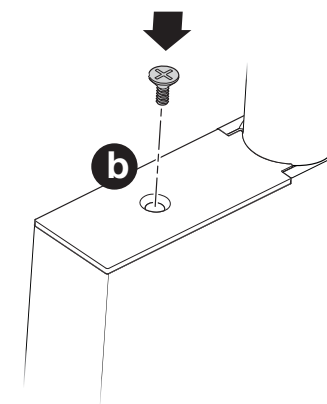
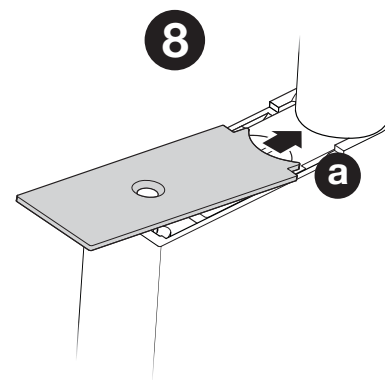

9. Assemble cantilever to hub by placing hooks on bottom of hub into rectangular holes in cantilever and rotating into position. Install and tighten four screws.

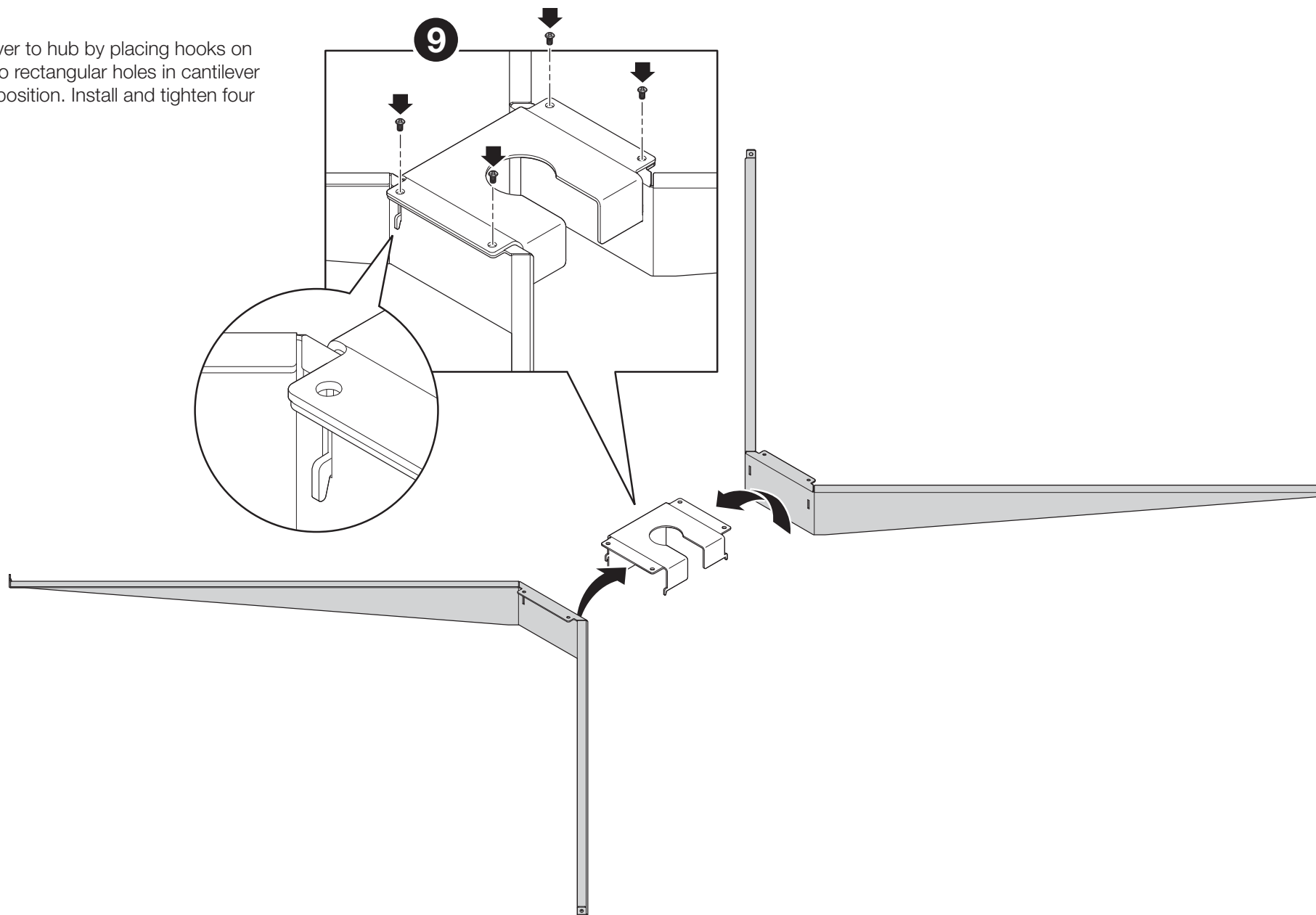

NOTE : The Shade and Diffuser are packaged folded up. Their spring steel support rings can unfold rapidly. Hold them out and away from you and others as you unfold them.

10. Unfold the shade and confirm the slots in the fabric are visible in the top and bottom rings. Roll the rings to make the slots visible if they are not initially visible.

11. Align the seam in the shade with the notch in the cantilever hub assembly.

12. Snap the top ring of the shade to the cantilevers at four locations.

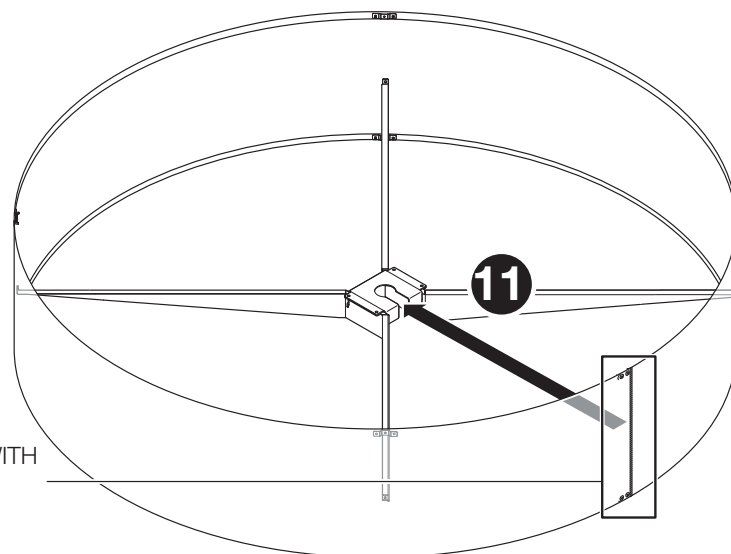
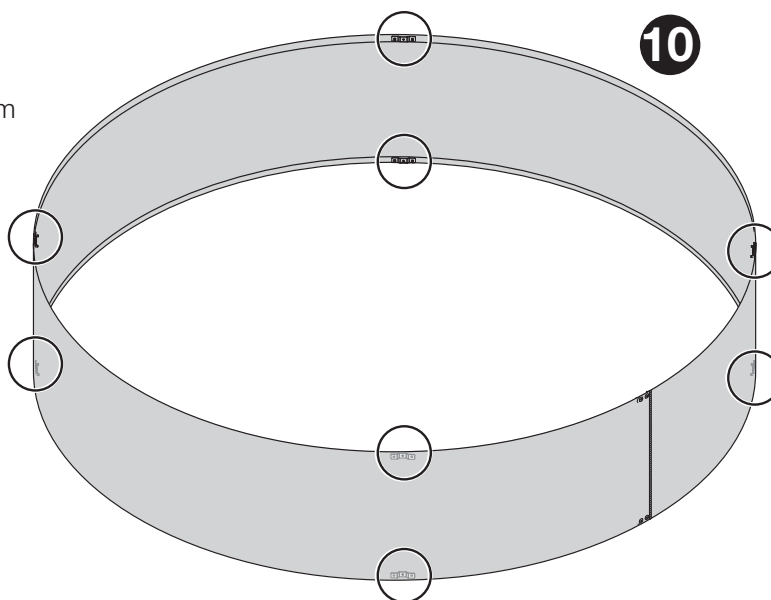

SEAM OF SHADE ALIGNED WITH
THE NOTCH IN CANTILEVER
HUB ASSEMBLY

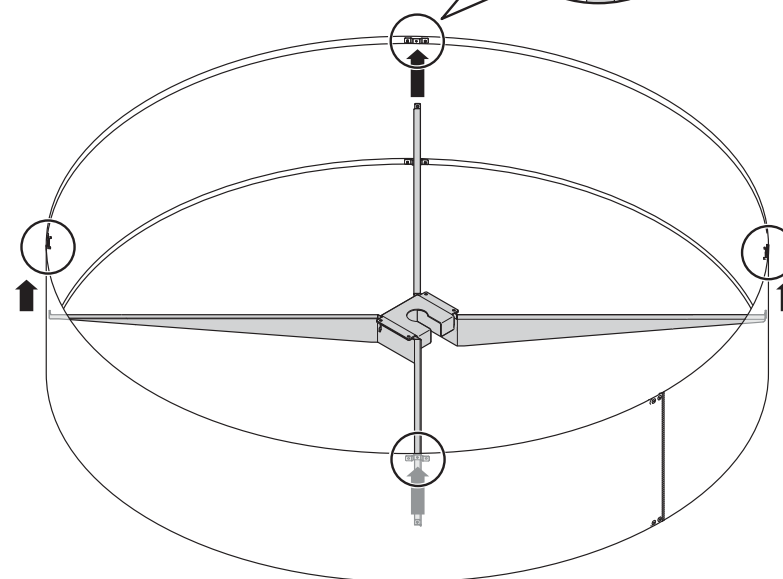
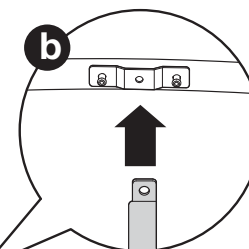
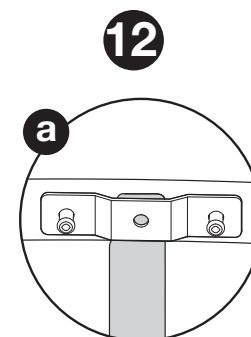

13. Lift the shade/cantilever assembly to align the notch in the cantilever assembly with the boom post. Lower the shade assembly onto the boom post.

14. Adjust the four leveling screws to level the shade assembly

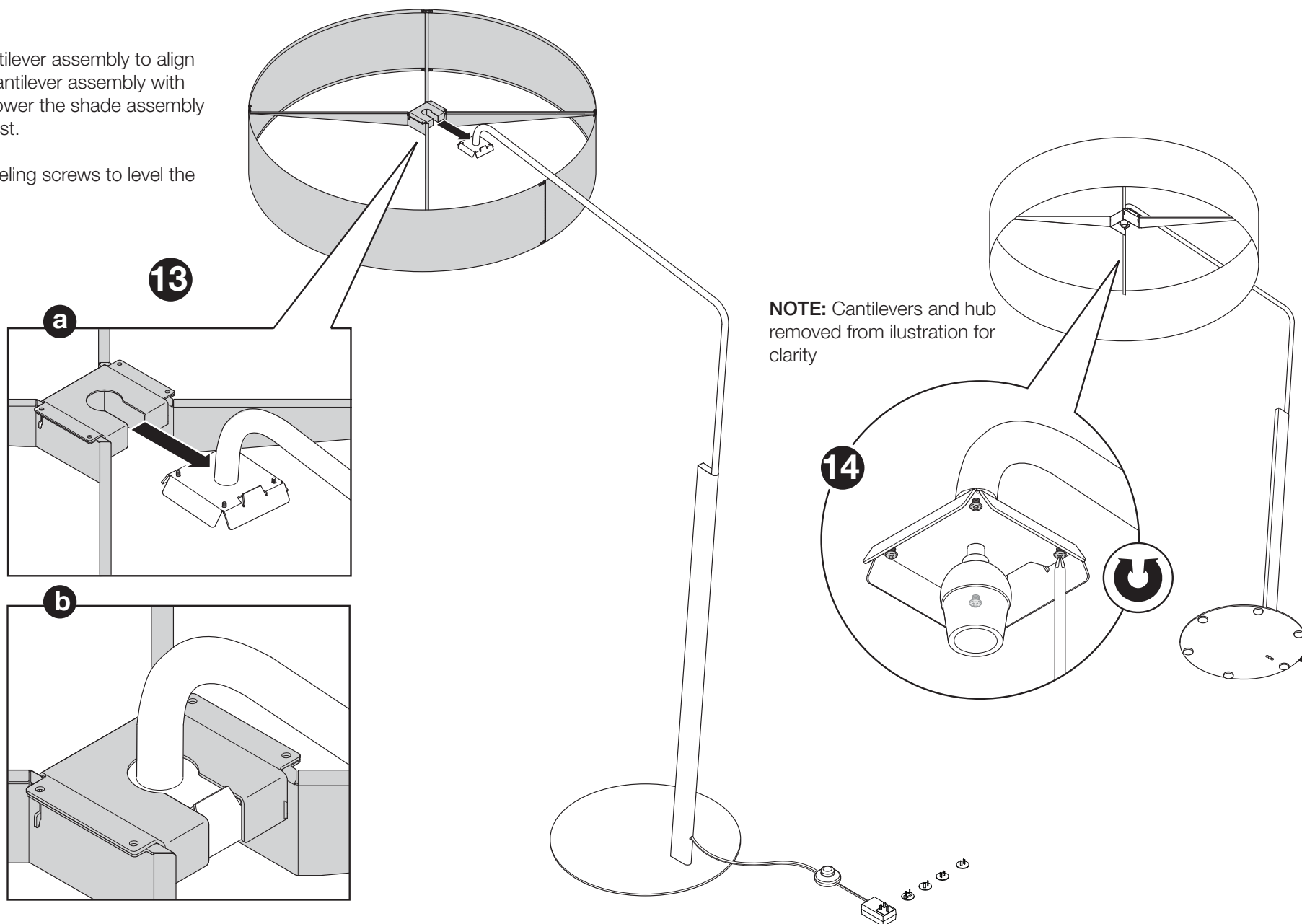

15. E27/E26 12V DC Compact fluorescent or LED light bulb. LED light bulb not provided.

16. Unfold the diffuser and insert the clips in the slots on the bottom ring.

