

Ledge

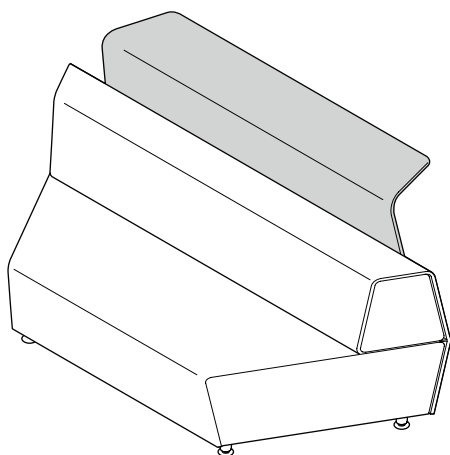

Canopy

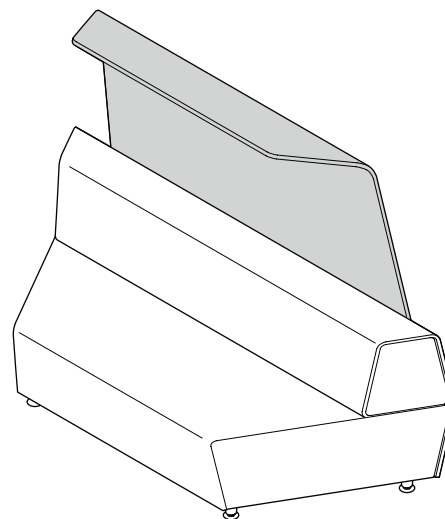

**CAUTION :** Install the necessary counterweight plates as per pages 2 & 3.  
Failure to follow these instructions could result in the lounge tipping over  
and causing personal injuries.

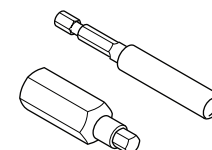
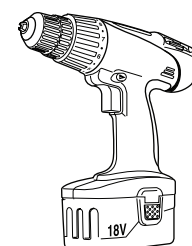

5mm HEX

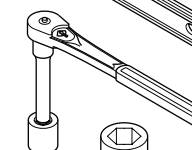
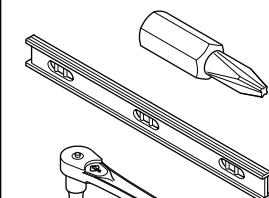

1/2"  
SOCKET

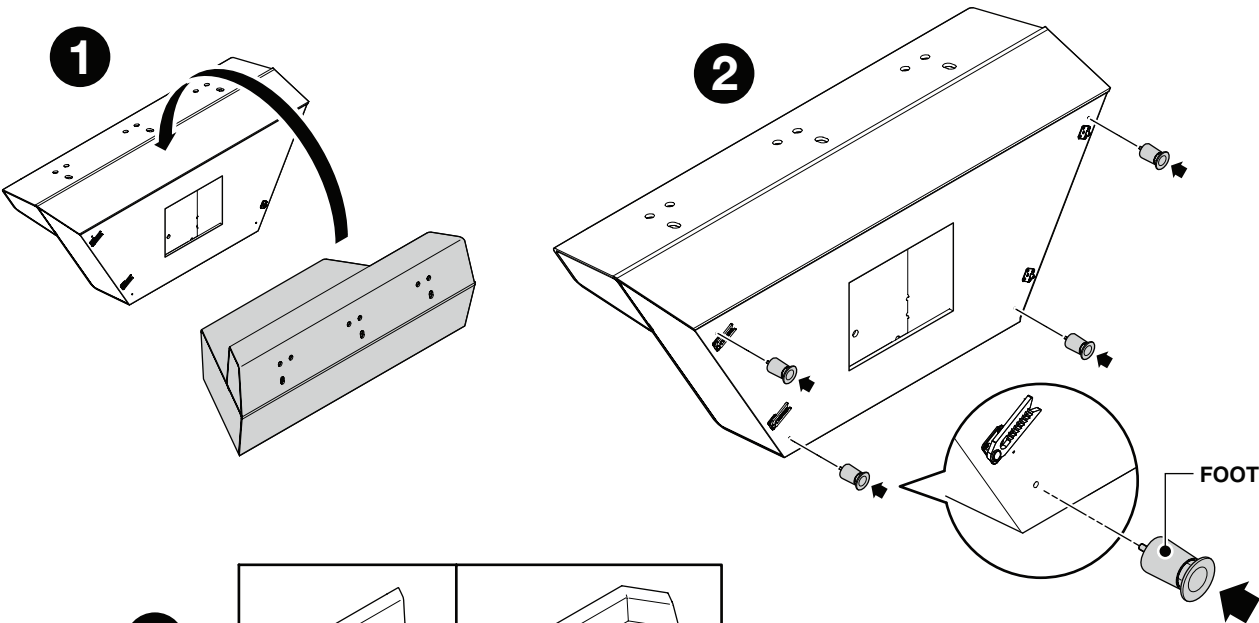

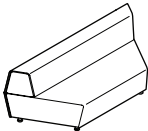
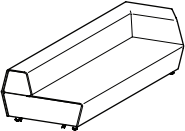
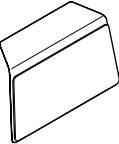
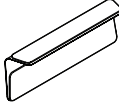
3		
	CENTER UNIT	LH or RH END UNIT
		
	TWO (2) COUNTERWEIGHT PLATES REQUIRED	NO COUNTERWEIGHT PLATES REQUIRED
	FOURTEEN (14) COUNTERWEIGHT PLATES REQUIRED	TWELVE (12) COUNTERWEIGHT PLATES REQUIRED

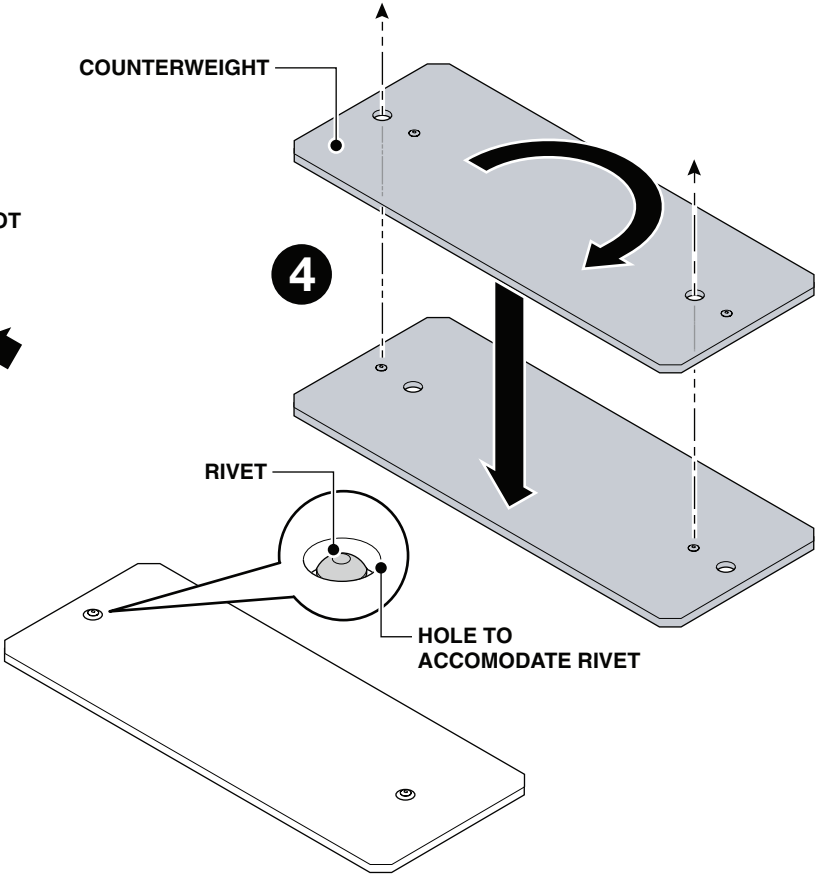

Installing Two (2) Counterweights for Canopy

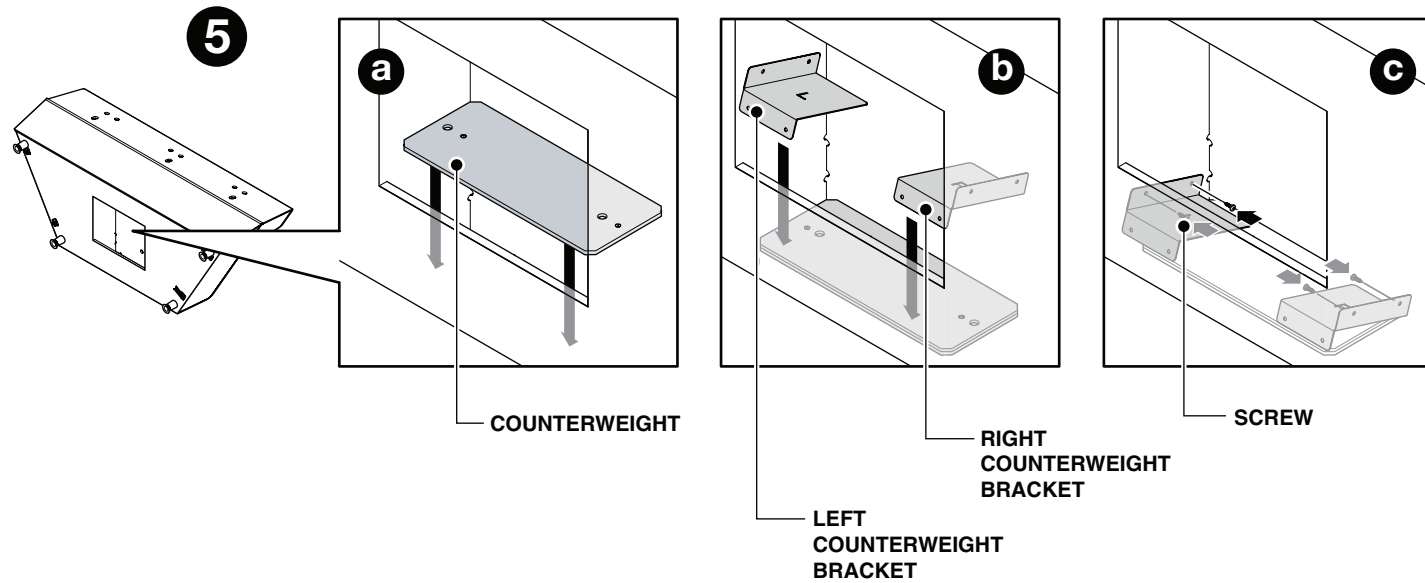

Installing Twelve (12) or Fourteen (14) Counterweights for Ledge

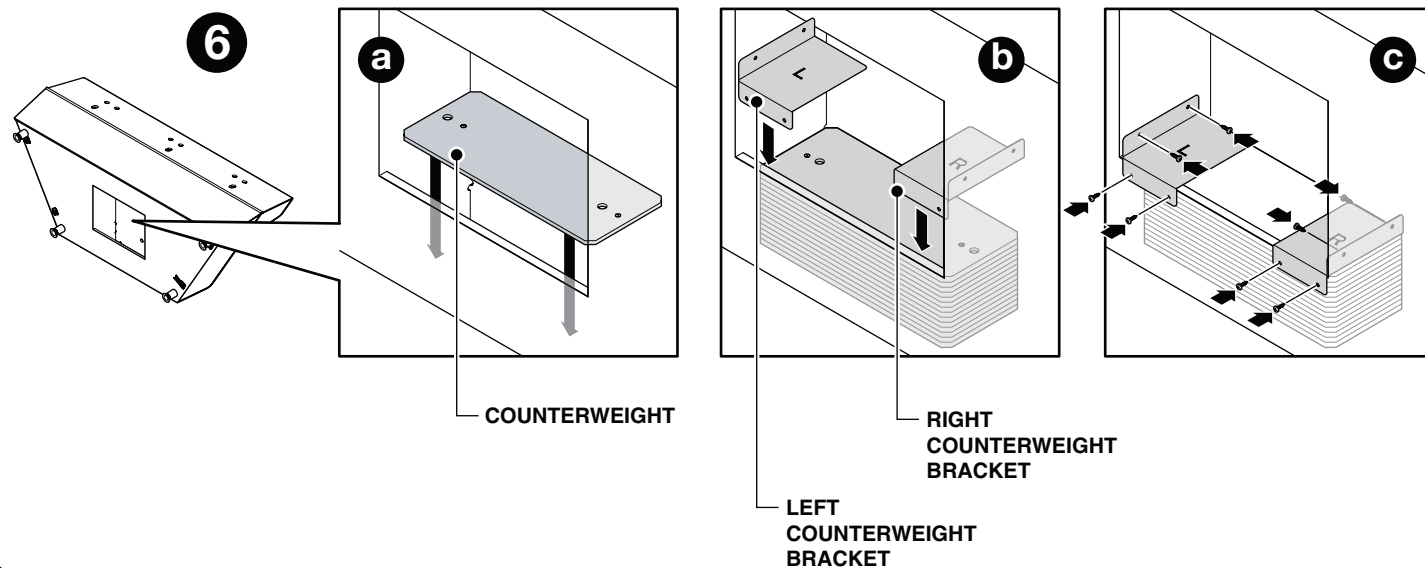

## Ledge

**NOTE :** This installation requires two (2) installers.

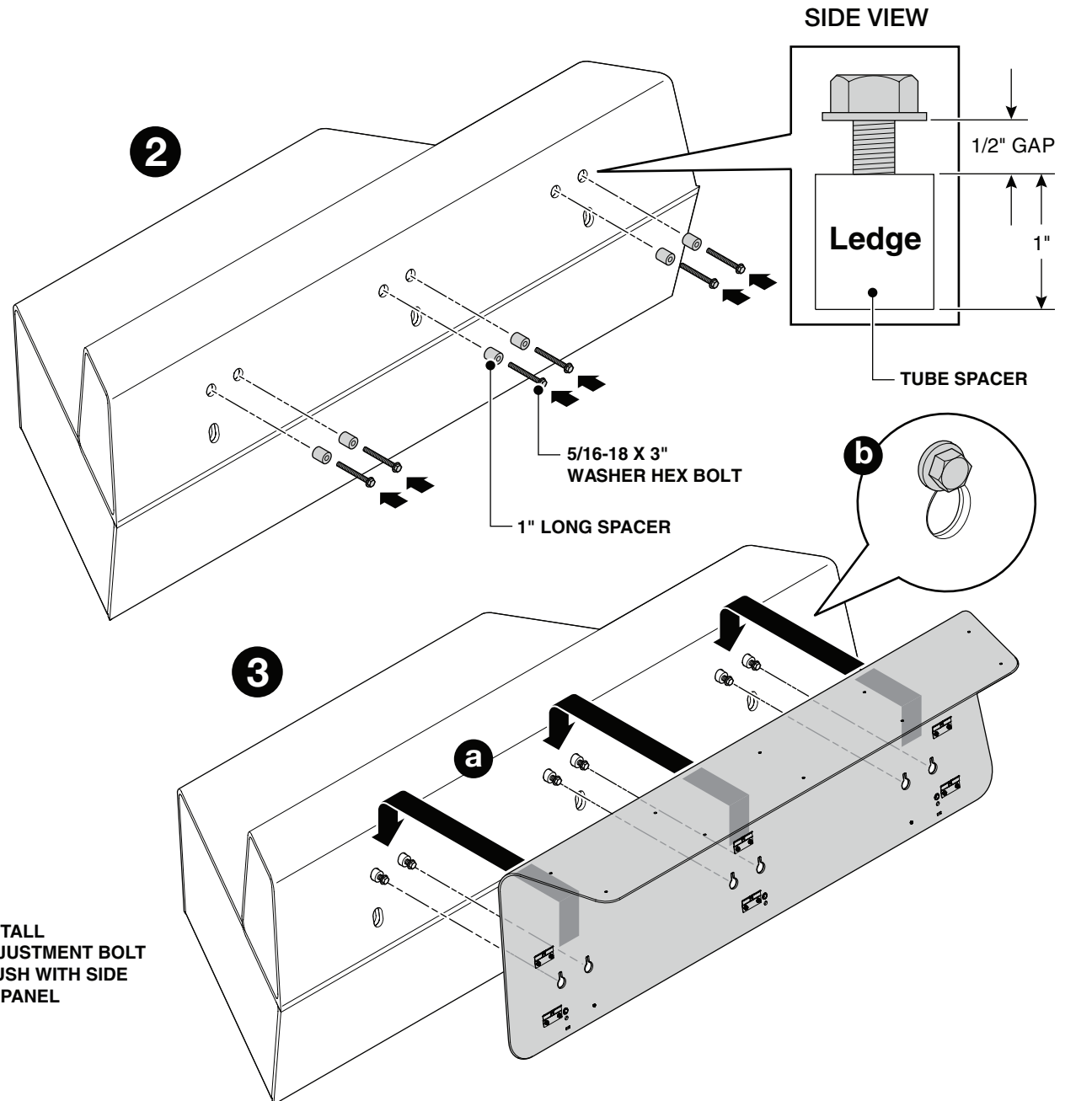
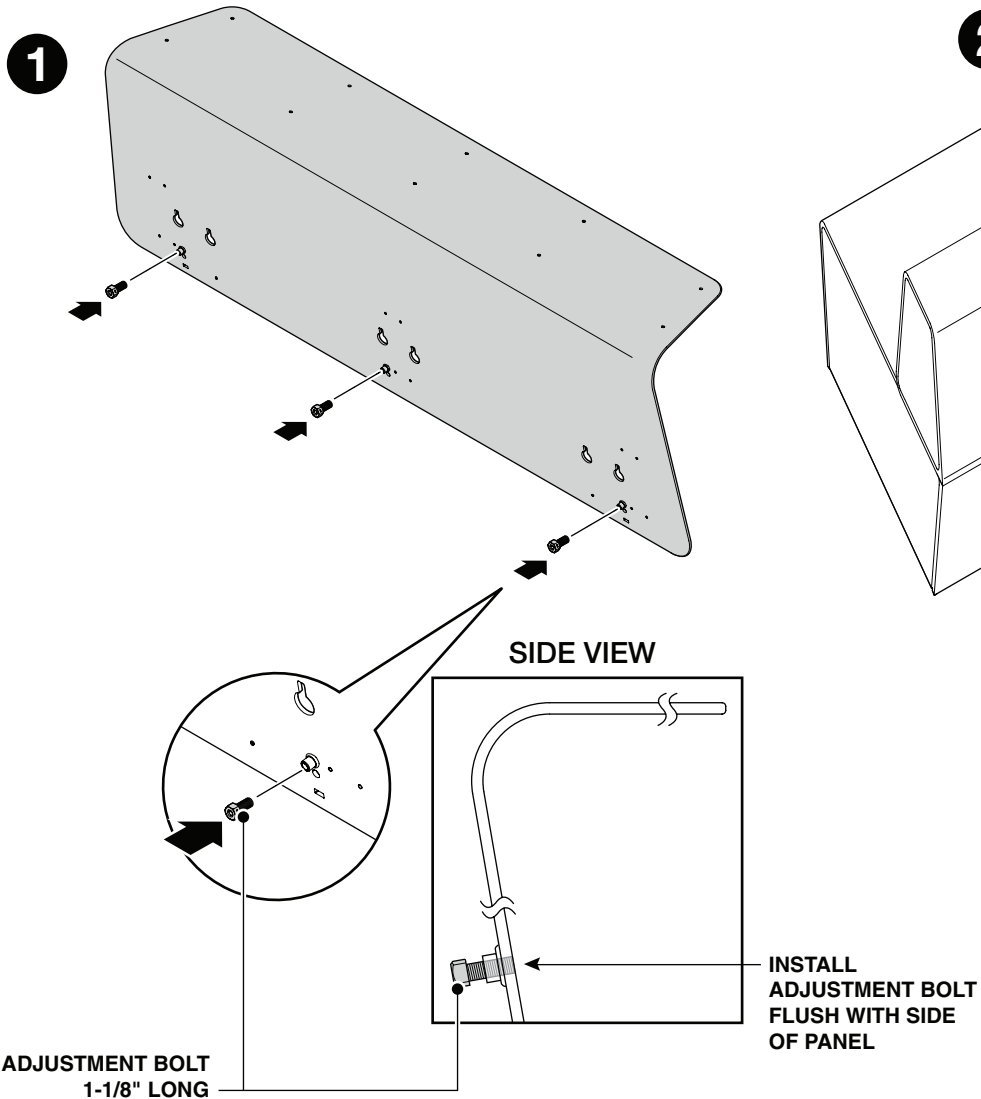

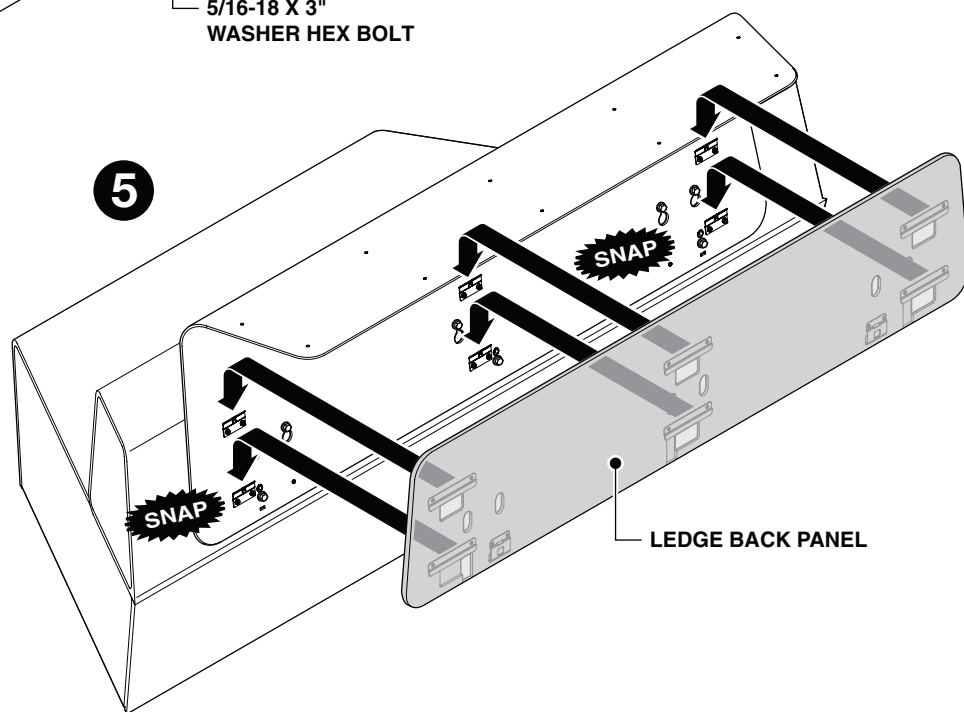
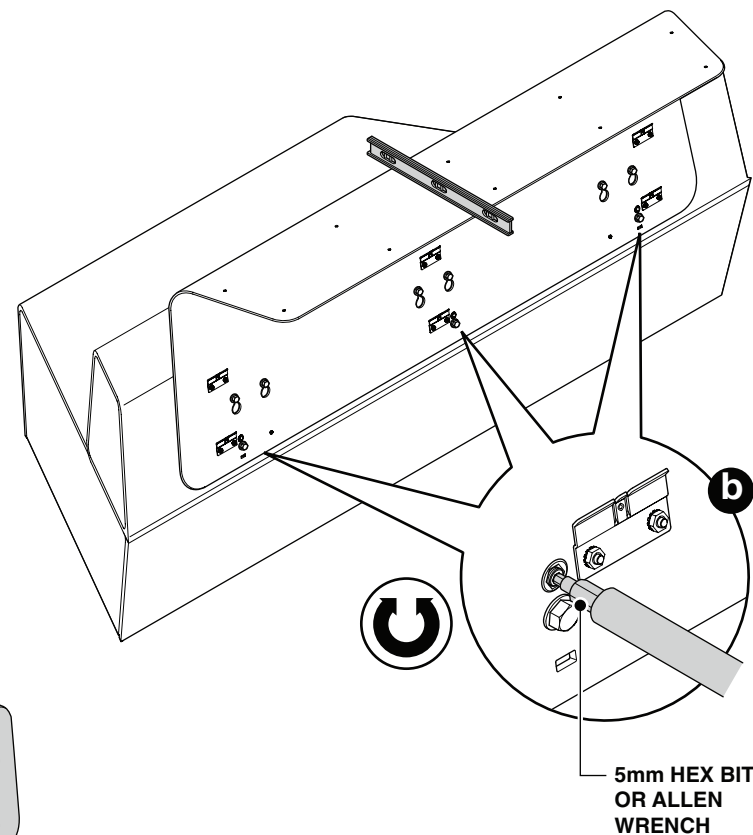
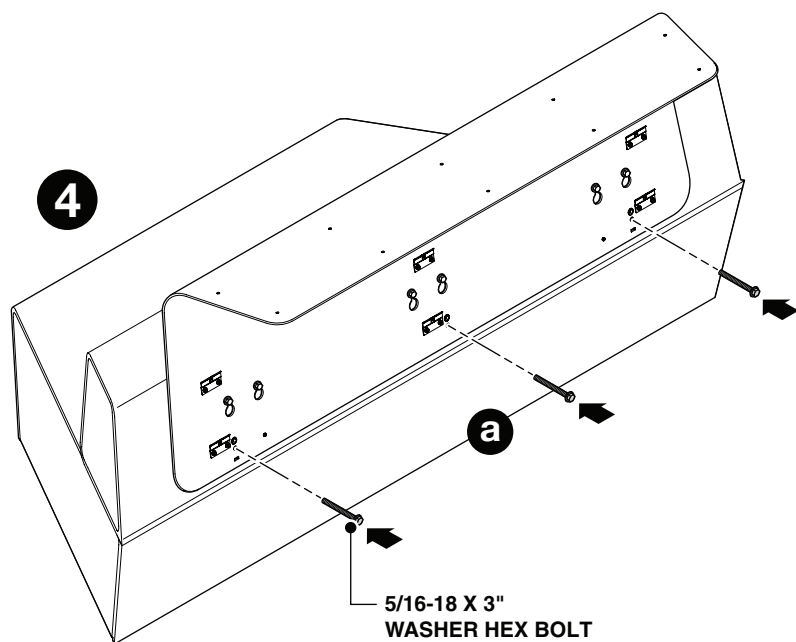

Ledge Worksurface (Optional)

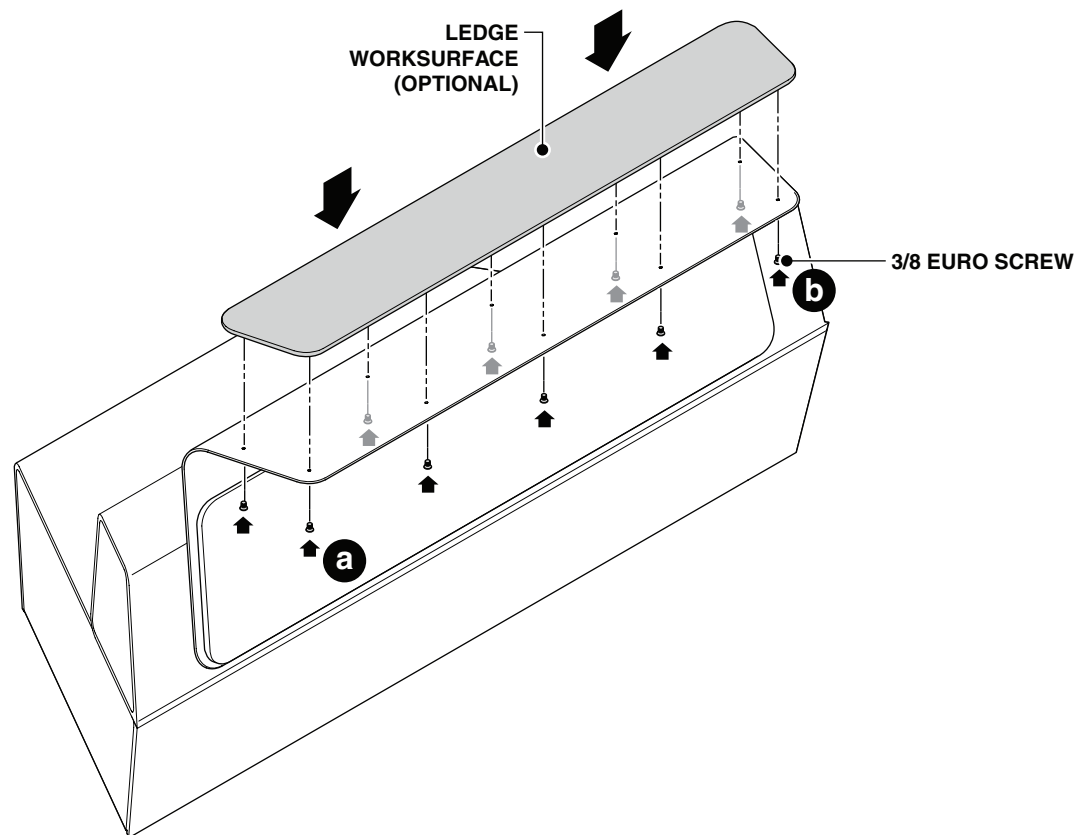

**NOTE :** Do not over-tighten euro screws.

## media:scape Lounge - Canopy and Ledge

## Canopy

**NOTE :** This installation requires two (2) installers.

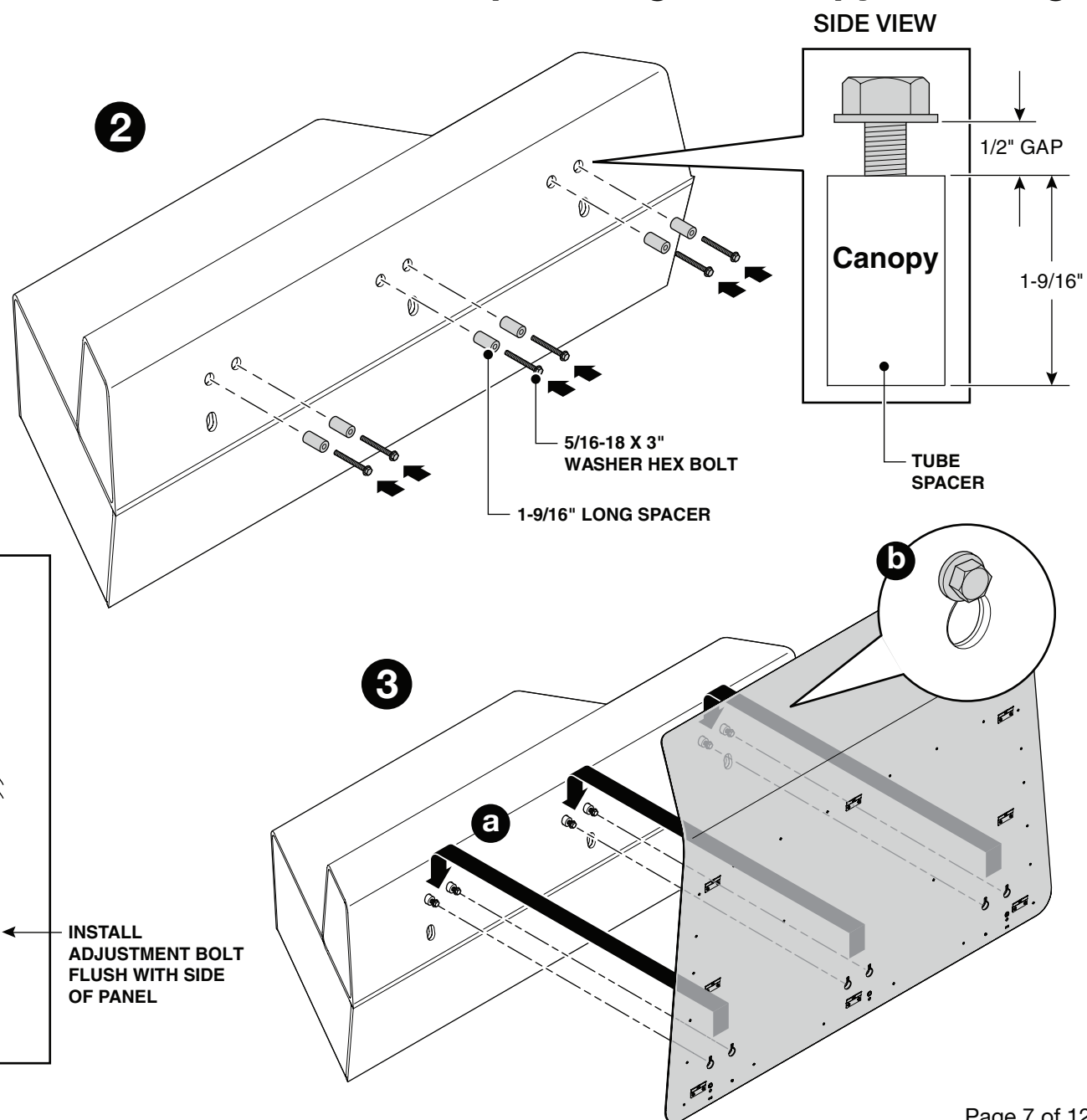
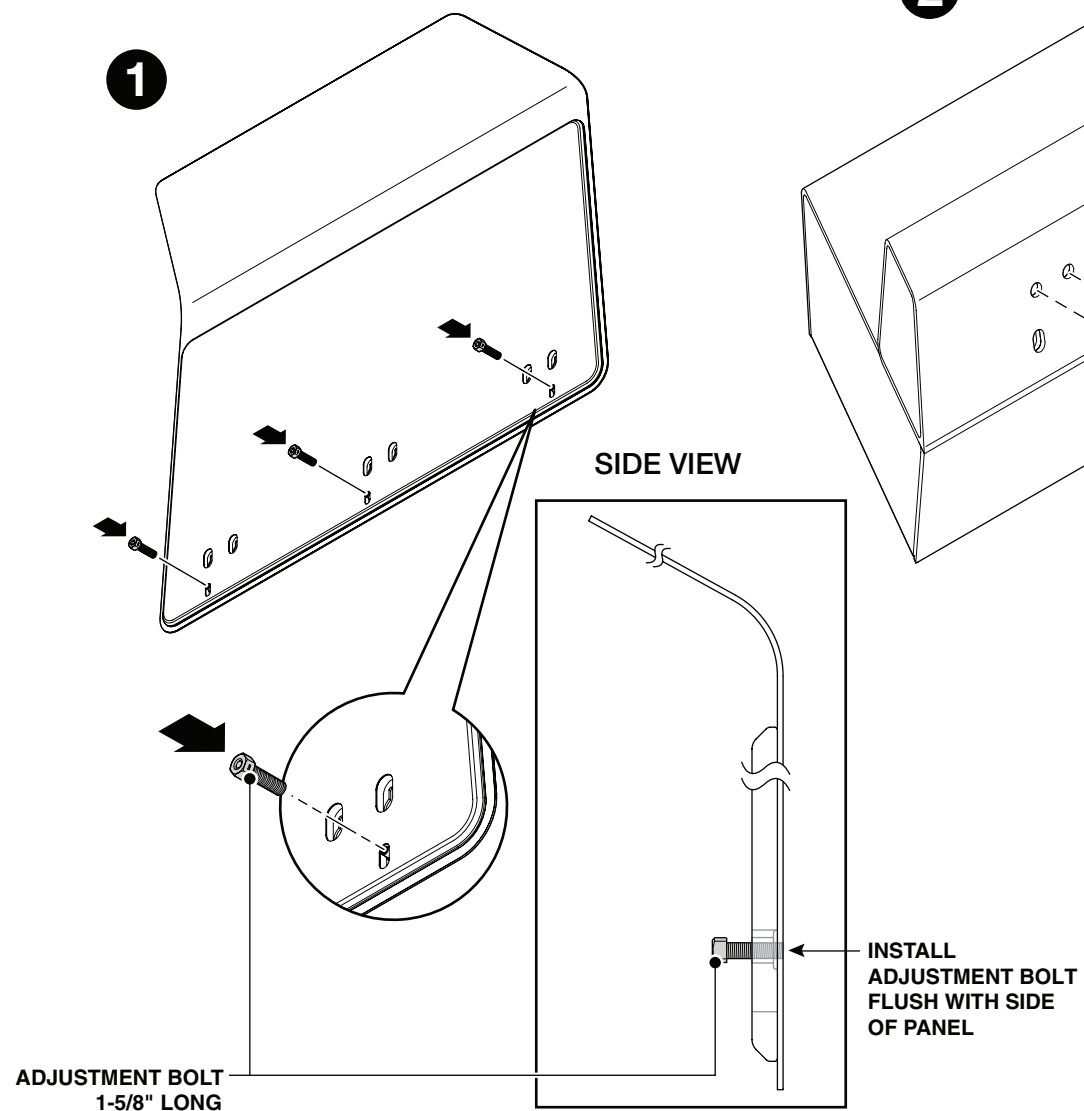

4

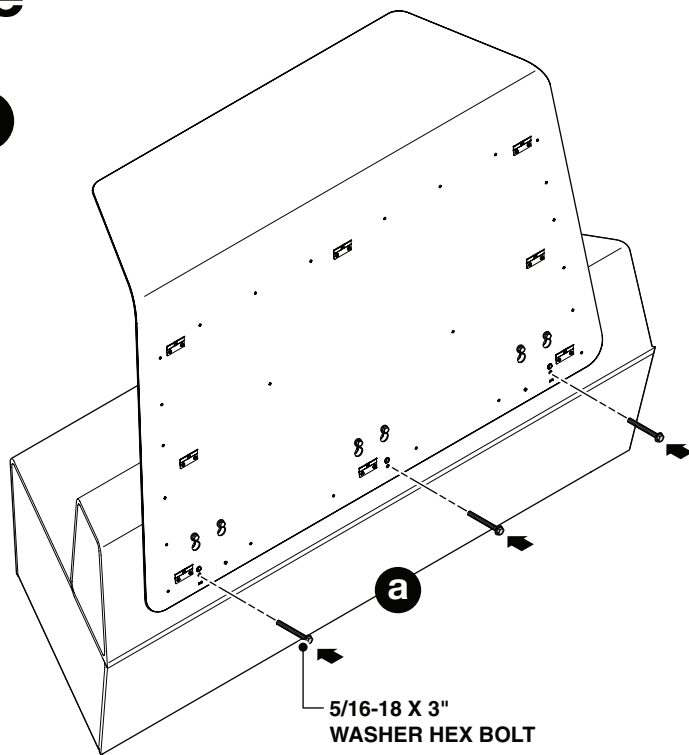

ALIGN

SIDE VIEW

ALIGN

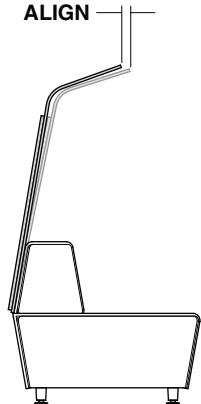

CANOPIES INLINE  
WITH EACH OTHER

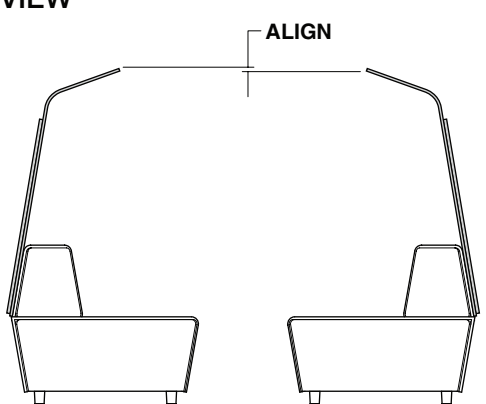

CANOPIES FACE TO FACE-  
WITH EACH OTHER

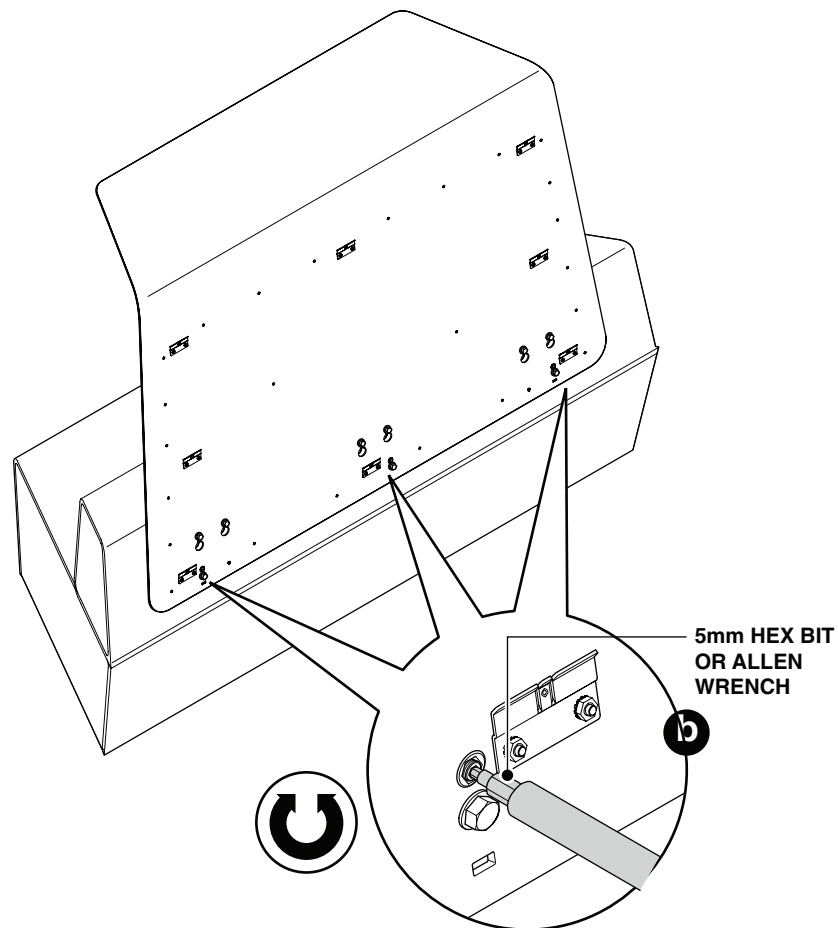



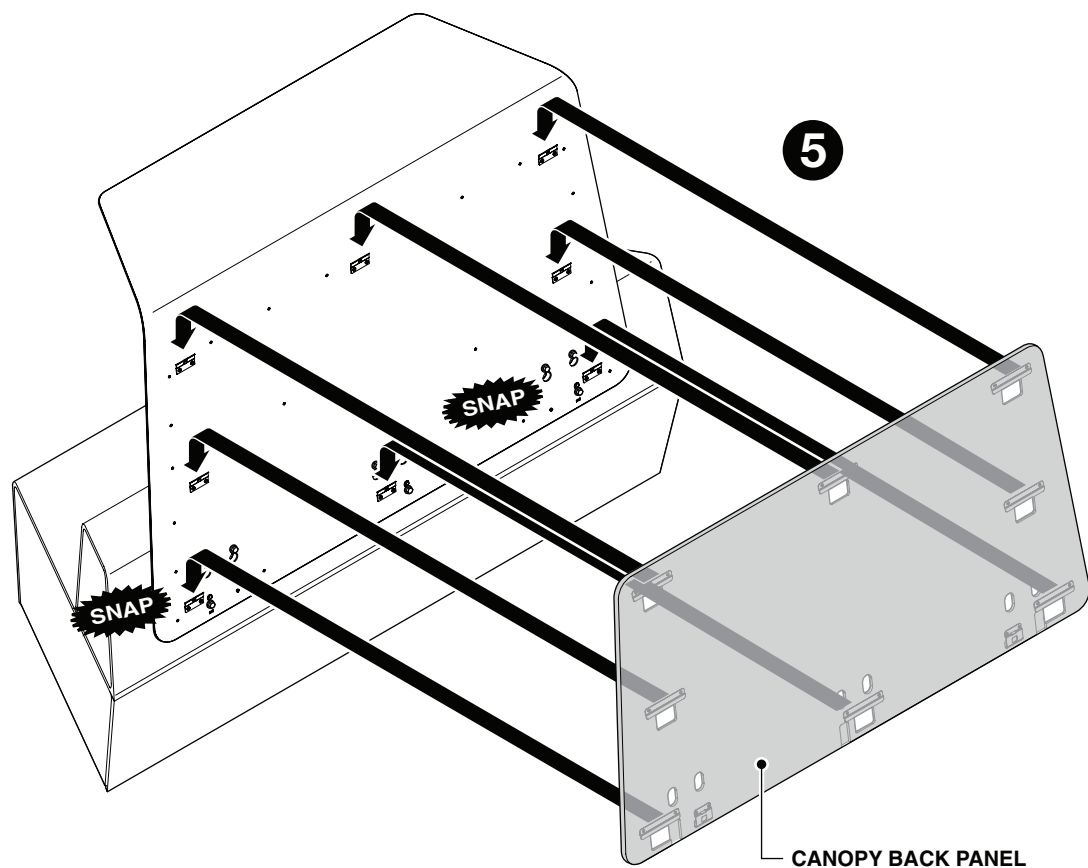

### Removal of Ledge or Canopy Back Panel

**NOTE :** This removal requires two (2) installers.

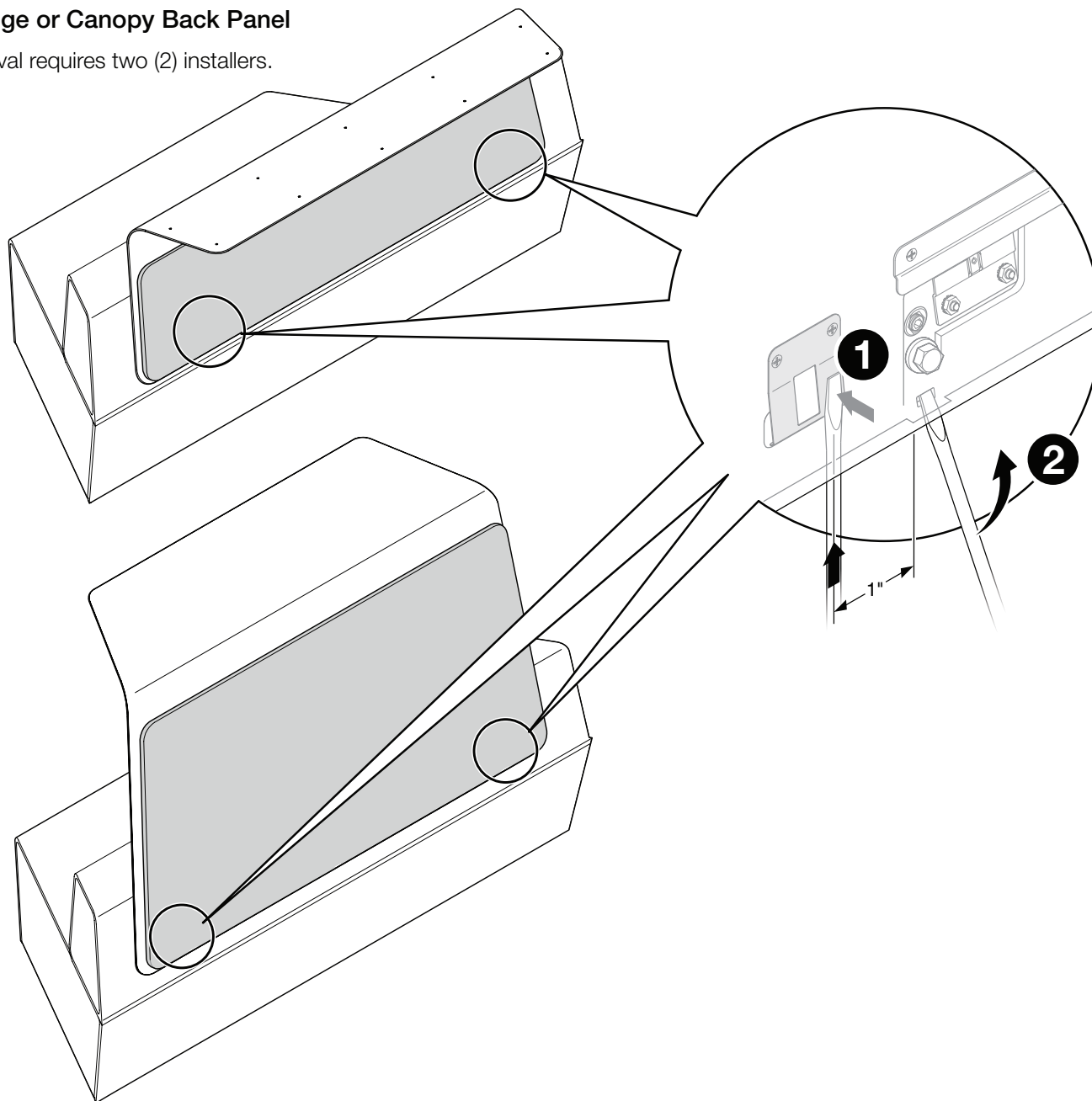

### Modification to an existing lounge

**NOTE :** You will need to cut the holes in the fabric.  
We recommend a hole punch tool that is 1" diameter.  
(McMaster -Carr, Osborne, etc.)

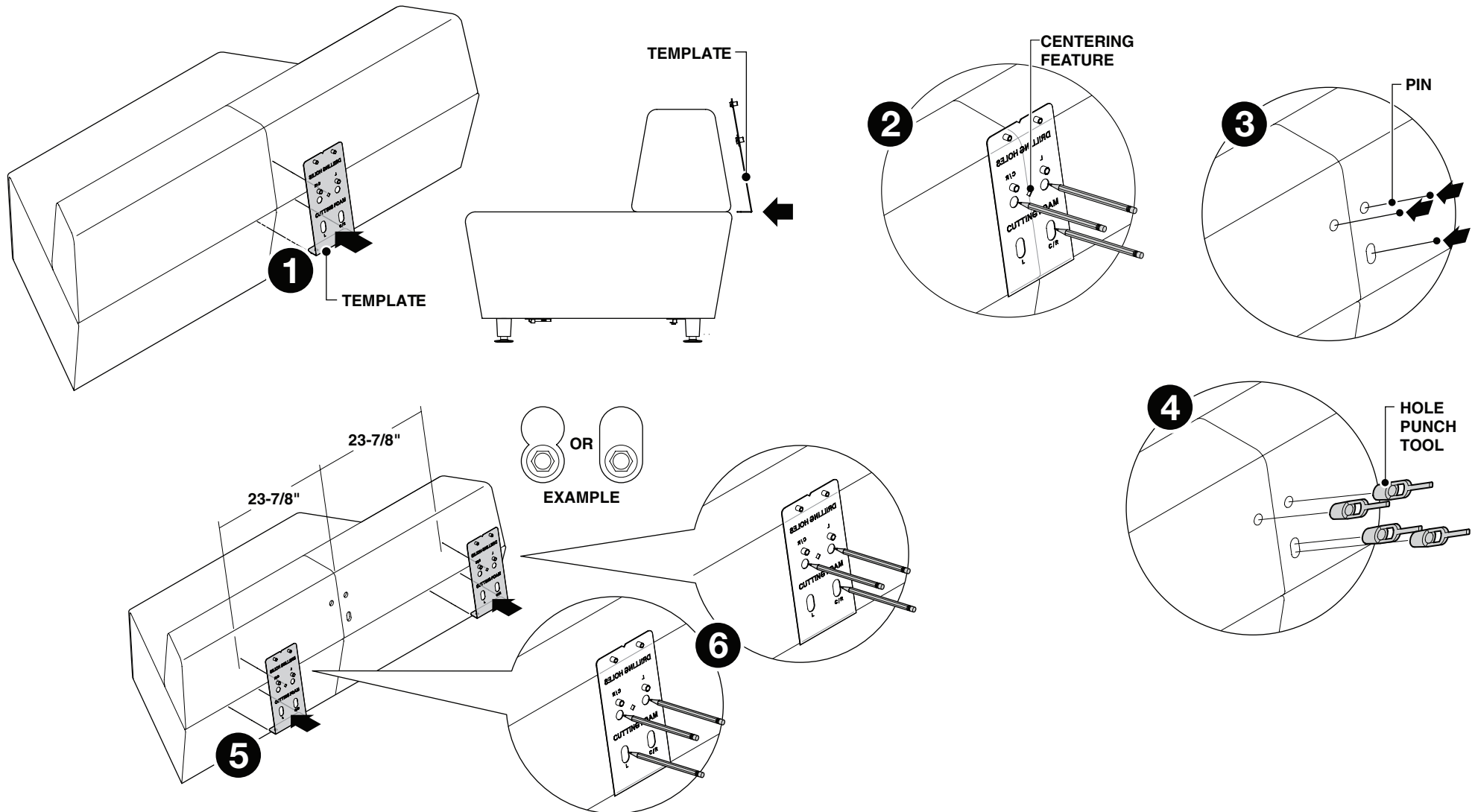

If the existing lounge **DOES NOT** have a threaded insert in the oblong hole location

**NOTE :** You will need to purchase a 7/16" diameter drill bit & a 5/16 hex bit or allen wrench

OBROUND HOLE SHOULD  
LOOK LIKE THIS  
WHEN COMPLETED

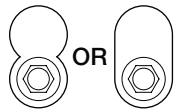

DEPENDING ON THE  
CUTTING METHOD,  
BOTH ARE ACCEPTABLE

