

● ● ● **Government Solutions**

Interconnecting Panels Solutions Answer Systems Furniture

NMSO# E60PQ – 080005/006/PQ

Answer. A great value for the Government of Canada.

We believe a panel system should support any way you work, and give you plenty of options. It should be easy to specify, install, and reconfigure. It should respect the environment as much as the person who sits in it. So we designed Answer to provide the flexibility to create environments that respond to the broadest range of user needs.

Why choose Answer?

From supporting different ways of working and different kinds of technology, to planning, aesthetics, and sustainability you will be hard pressed to find another panel system as hardworking as Answer. Here are just a few...

Planning: Answer's dynamic panel design is the source of its flexibility and simplicity.

Technology: Answer offers an architecturally-rated modular power system that easily connects building interface, system distribution and furniture, with power and data solutions.

Aesthetics: With a broad range of surface materials, segmented and monolithic skins, edge profiles and hardware options you can create any image.

Flexibility: Change panel heights without removing panels. Put stackers on base panels or wheels on furniture. Answer works how you want to work.

Workstyles: Create different levels of privacy or collaboration, different workspaces for different people, places, and processes.

Environment: Answer is the first MBDC Cradle to Cradle^{CM} certified fully powered workstation in the world. It's also SCS Indoor AdvantageTM certified and Gold certified for Indoor Air Quality.



And best of all, for less than \$40,000 you can create an effective and inspiring workplace. Let us show you, through the following planning ideas, how you can get the most value out of your investment. Both now and in the future. Answer is the right solution at the right price for government work environments.

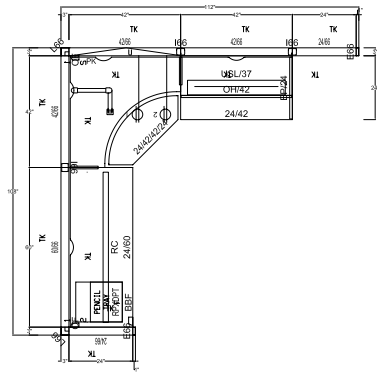
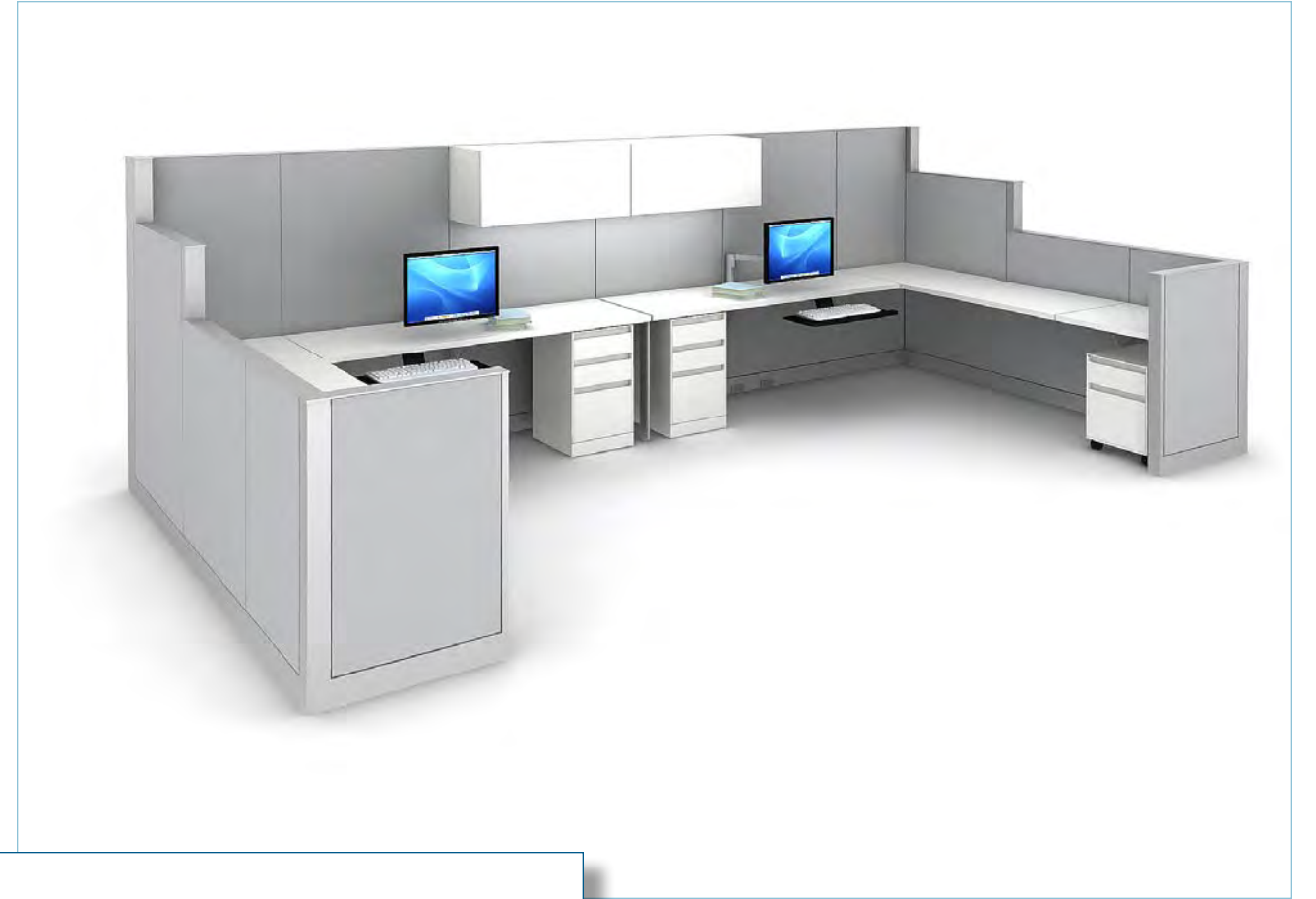
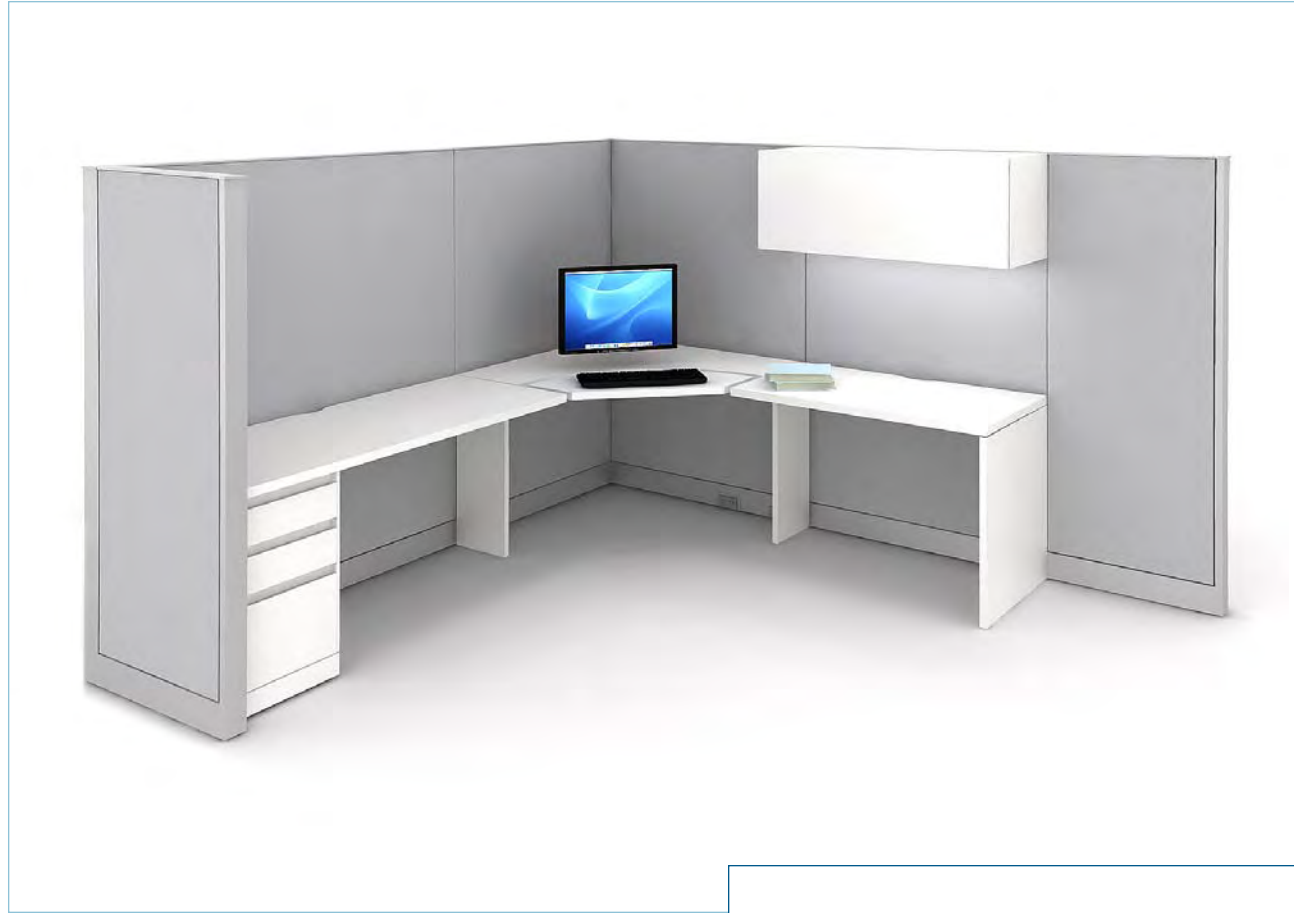

●●● This application of six workstations is available for under \$40,000

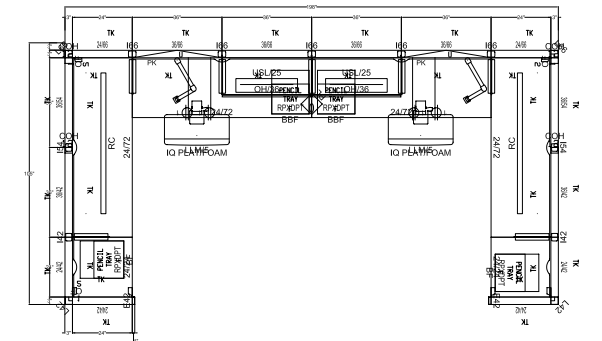

This application of six workstations is available for under \$40,000 ●●●

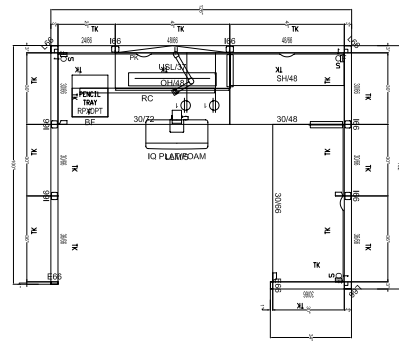
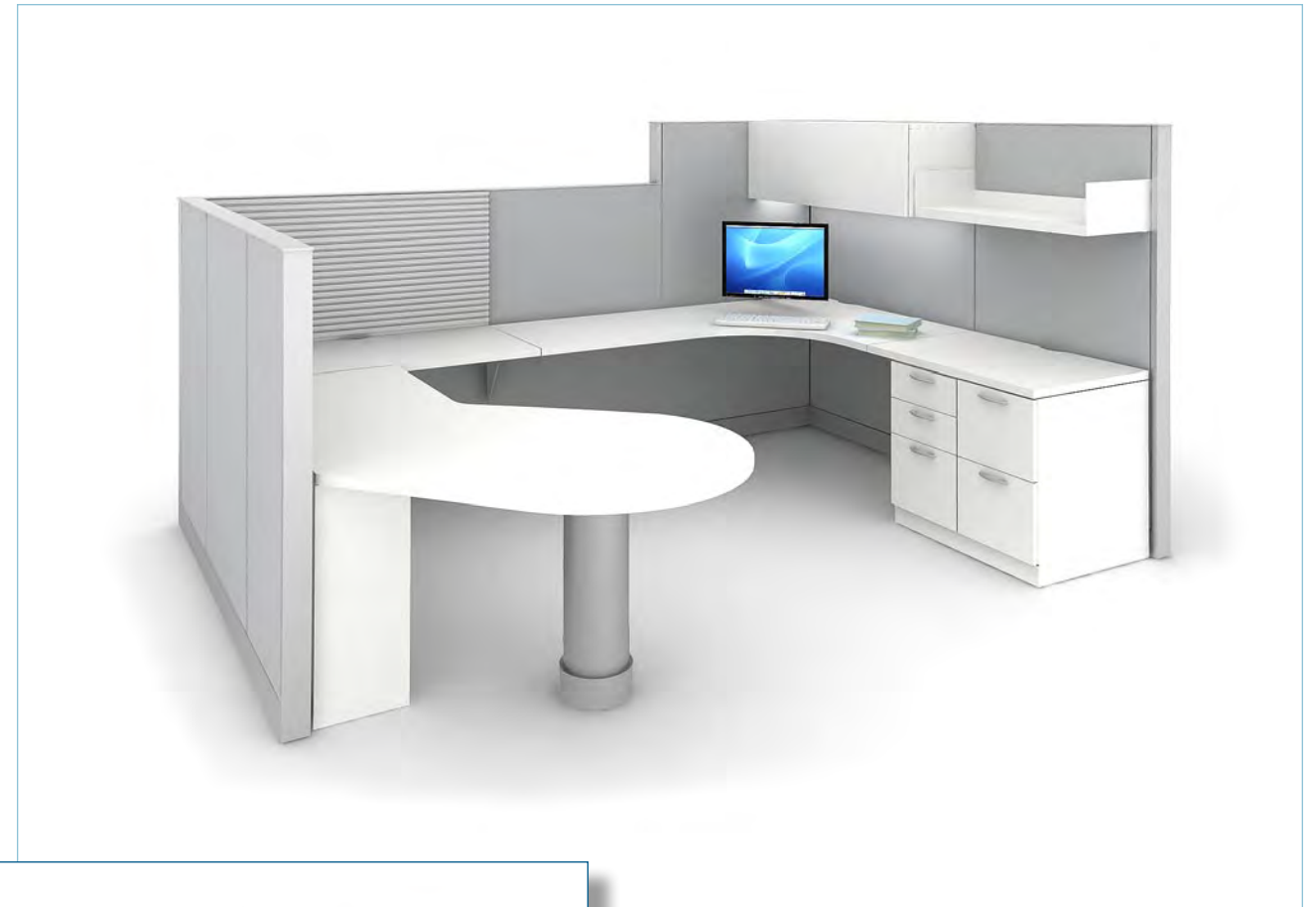

●●● This application of six workstations is available for under \$40,000



This application of four workstations is available for under \$30,000 ●●●

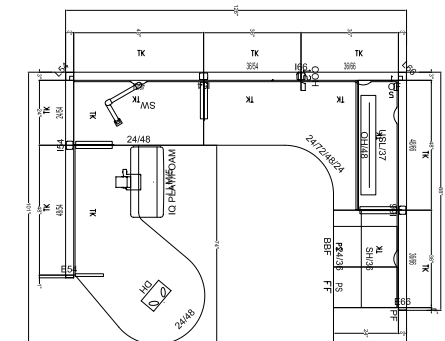

Alternate solution

Option 2 ●●●

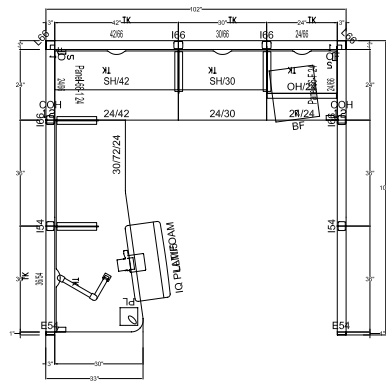

●●● This application of six workstations is available for under \$40,000

Designing for one environment should never be at the expense of another.

Answer. The world's first Cradle to Cradle™ fully powered workstation. One example of our commitment to making business choices that respect the environment.

And that's not all:

- Answer is level™ 2 certified to the BIFMA e3 sustainability standard.
- Answer is SCS Indoor Advantage™ Gold certified for indoor air quality.
- Answer's open-core construction means panel components are easily taken apart and recycled.
- Answer wiring is PVC and halogen free as well as RoHS compliant.

Love how you work.[®]

Steelcase[®]

For more information contact your local Steelcase dealer or call 1.800.268.3172 x2788. Visit us online at steelcase.com.

Item #10-0002705 ©2010 Steelcase Inc. All rights reserved. All specifications subject to change without notice.
Trademarks used herein are the property of Steelcase Inc. or of their respective owners.